

**EMERGENCY SPILL WAY SECTION A-A**

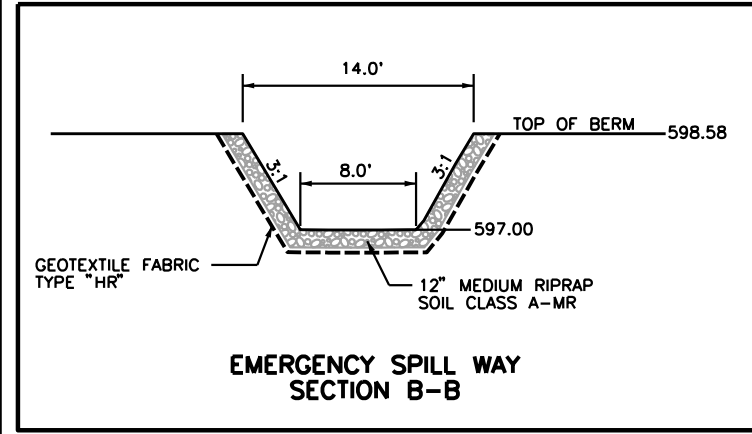

**EMERGENCY SPILL WAY SECTION B-B**

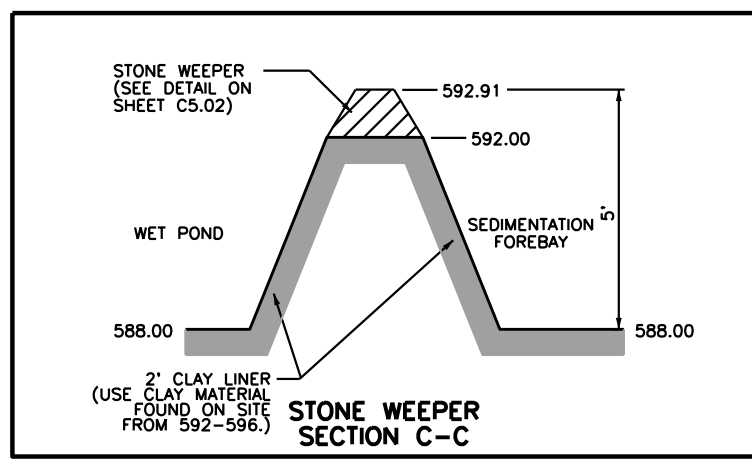
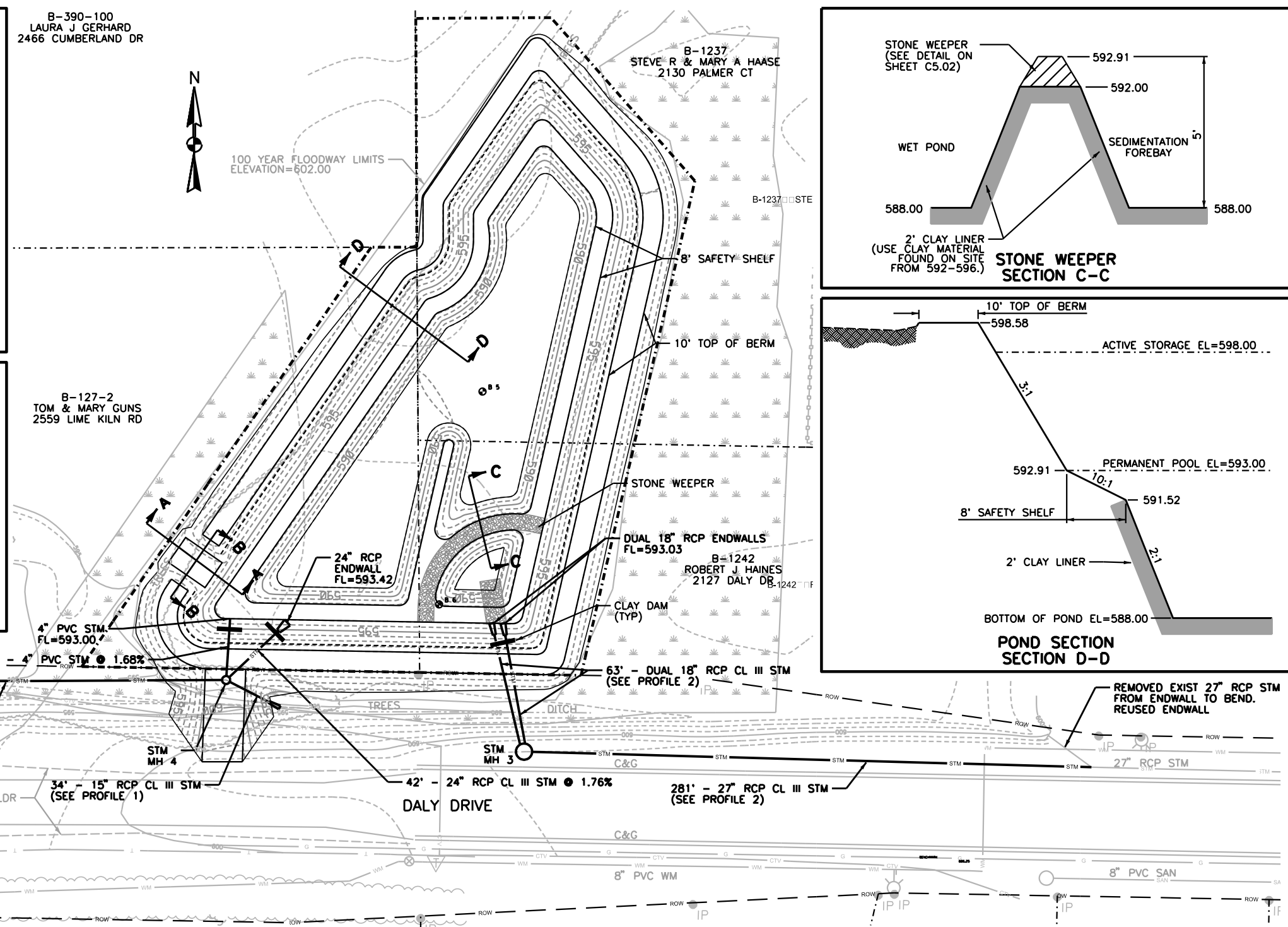

**STONE WEEPER SECTION C-C**

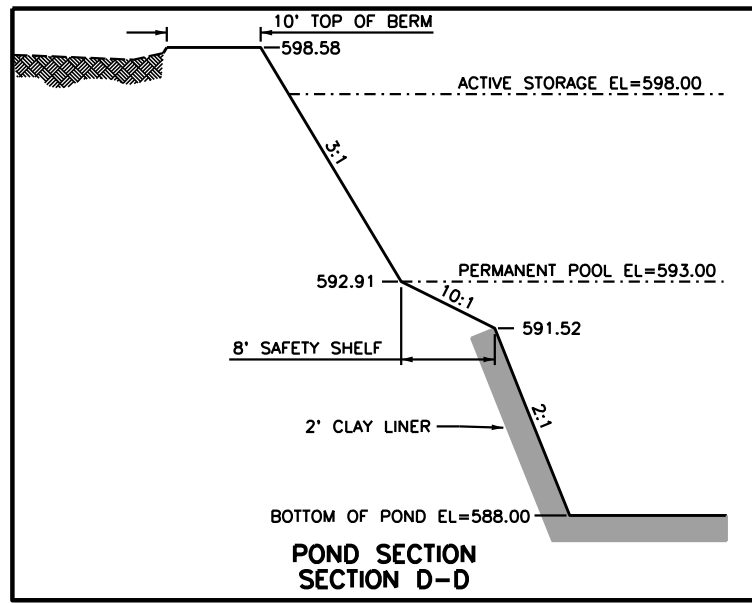

**POND SECTION D-D**

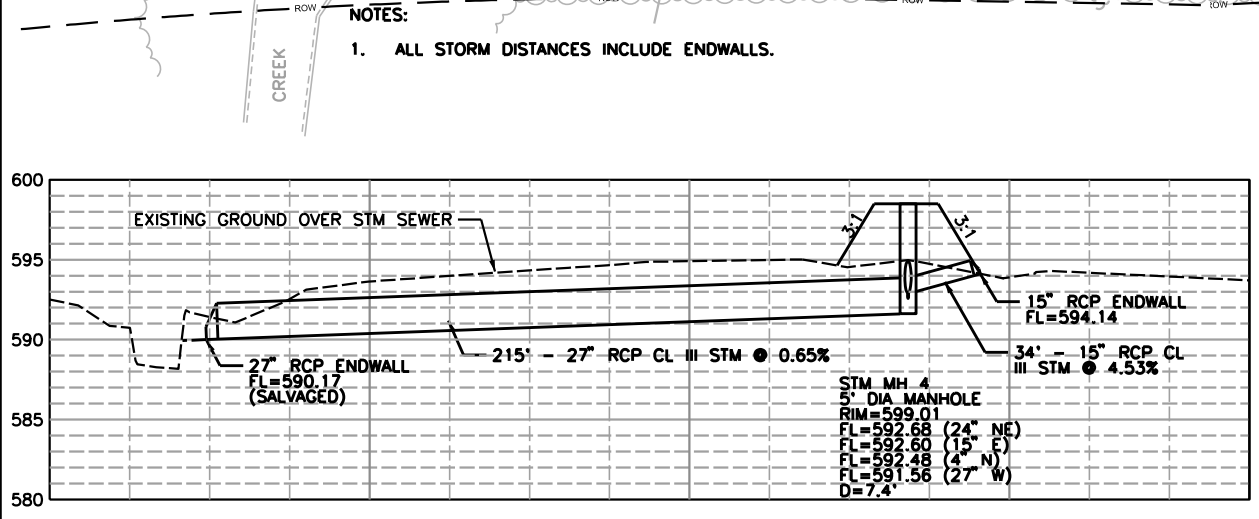

**PROFILE 1**

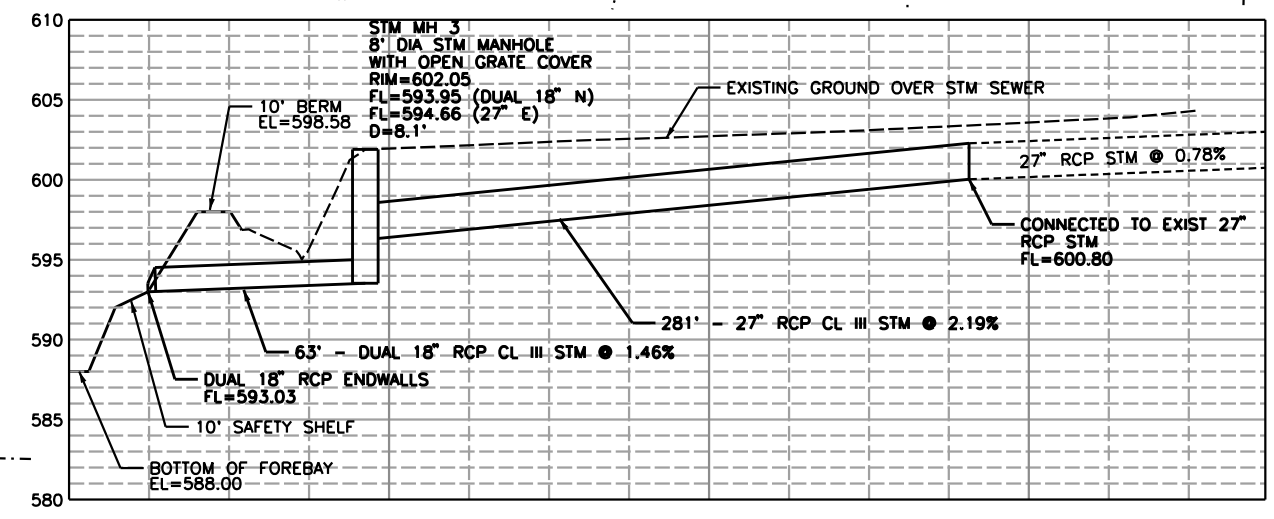

**PROFILE 2**

**NOTES:**  
1. ALL STORM DISTANCES INCLUDE ENDWALLS.

B-390-100  
LAURA J GERHARD  
2466 CUMBERLAND DR

B-127-2  
TOM & MARY GUNS  
2559 LIME KILN RD

B-1237  
STEVE R & MARY A HAASE  
2130 PALMER CT

B-1242  
ROBERT J HAINES  
2127 DALY DR

**Foth**  
Foth Infrastructure & Environment, LLC  
2737 South Ridge Road, Suite 600  
Green Bay, WI 54307-2326  
Phone: 920-497-2326 Fax: 920-497-9516

REUSE OF DOCUMENTS  
THIS DOCUMENT HAS BEEN REPRODUCED FOR ANY SPECIFIC APPLICATION AND NOT BE USED FOR ANY OTHER PROJECT WITHOUT THE WRITTEN APPROVAL OF FOTH INFRASTRUCTURE AND ENVIRONMENT, LLC. UNAPPROVED USE IS THE SOLE RESPONSIBILITY OF THE UNAUTHORIZED USER.

**STORMWATER MANAGEMENT**  
**2010 PONDS**  
CONTRACT C-10  
VILLAGE OF BELLEVUE  
BROWN COUNTY

NO.	DATE	REVISION / ISSUE DESCRIPTION

RECORD DRAWING OF COMPLETED CONSTRUCTION BY  
RECORD DRAWINGS OF COMPLETED CONSTRUCTION  
CONFORMING TO CONTRACTOR AND/OR OWNER'S RECORDS.  
BY: JOE P. DATE: 11/2011

DATE OF PREPARATION		
SURVEYED	BY	DATE
DRAWN	DJY	07/30/10
DESIGNED	MJA1	07/10/10
CHECKED	TMM	07/30/10

**DALY DRIVE**  
**STORM SEWER,**  
**POND**  
**AND**  
**SECTIONS**

HORIZONTAL SCALE:  
0 30 60

PROJECT ID 108020

**C4.03**  
SHEET 5 OF 12