

FEB. -15' 00 (TUE) 14:24 GENERAL

TEL:608 267 2750

P. 003/005

STATE OF WISCONSIN
DEPARTMENT OF NATURAL RESOURCES
GEOGRAPHIC NAMES COUNCIL
BOX 7921
MADISON, WISCONSIN 53707

GEOGRAPHIC NAME PROPOSAL
FORM 2200-124 2-79

DATE
September 21, 2000

RECOMMENDED NAME OF FEATURE
Osprey Lake

COUNTY
Sawyer

OTHER NAMES OR SPELLINGS IN USE
Squaw Lake

BY WHOM
Sawyer County Board of Supervisors

LOCATION OF FEATURE
STREAM

LEAVE BLANK - DEPARTMENT USE ONLY

HEADS: SEC. _____, T. _____ N, R. _____ E/W
ENDS: SEC. 36, T. 41 N, R. 8W E/W
Sec. 31, T 41 N, R 7 W
LAKE, VILLAGE, ETC. Sec. 6, T 40 N, R 7 W
SECS. 1, T. 40N N, R. 8W E/W
SECS. _____, T. _____ N, R. _____ E/W
(OR LOCATE BY LANDMARKS AND ATTACH MAP)

LAT. _____ ° _____ ' _____ " , LONG. _____ ° _____ ' _____ "
LAT. _____ ° _____ ' _____ " , LONG. _____ ° _____ ' _____ "
LAT. _____ ° _____ ' _____ " , LONG. _____ ° _____ ' _____ "
USGS QUAD. _____ NAME _____ INDEX NO. _____

DESCRIPTION OF FEATURE: SIZE (ACRES), LENGTH (MILES) OR POPULATION, ETC.
lake lying in the Town of Hunter, the Town of Round Lake, and the Town of Hayward

REASON FOR THIS PROPOSAL (IDENTIFY PROBLEM AND NEED) (ATTACH SUPPLEMENTARY SHEET IF NECESSARY)
objection of County residents, including Lac Courte Oreilles Tribal Governing Board, to the use of the word squaw. Town of Hunter Board of Supervisors suggested the name Osprey Lake.

ORIGIN AND SIGNIFICANCE OF RECOMMENDED NAME (ATTACH SUPPORTING DOCUMENTS - RESOLUTION, HISTORICAL DATA, ETC.)

I suspect the presence of osprey in the lake. I believe residents on the lake were present at the meeting where the Town of Hunter Board of Supervisors suggested osprey.

NOTE: GUIDELINES FOR NAMES ON REVERSE SIDE. SEND FORM AND INQUIRIES TO ABOVE ADDRESS.

APPLICANT'S SIGNATURE
Kris Mayberry
Kris Mayberry Sawyer County Clerk
STREET OR ROUTE
P.O. Box 273
CITY, STATE, ZIP CODE
Hayward, Wisconsin 54843

AGENCY Sawyer County Board of Supervisors
TELEPHONE NUMBER
715.634.4866

LEAVE BLANK - FOR DEPARTMENT MAP SEARCH AND FIELD INVESTIGATION USE

| NAME OF MAP OR OTHER REFERENCE | DATE OF REF. | NAME GIVEN FEATURE |
|--------------------------------|--------------|--------------------|
| | | |
| | | |
| | | |

PERSONS CONTACTED (NAME, ADDRESS AND OCCUPATIONS)

SPECIAL CONCERNS

FINDINGS AND RECOMMENDATION

NORTHEAST PART BASS LAKE CENTRAL PART HAYWARD T. 40 N.-R. 8 W.



Edina Realty Inc.
www.edinarealty.com
Peter Simpson, GRI
 Broker/Associate
 Web Site: simpsonsells.com

Office: (715) 634-0100, Ext. 422
 Direct: (800) 634-8579
 Home: (715) 945-3141
 Car: (715) 492-7781

Hayward Office
 15775 Highway 27, 54843
 In The Windmill

ANR AREA NORTH REALTY

P.O. Box 747 • County Road "B" East • Hayward, Wisconsin 54843
 Office: (715) 634-3522 • (800) 344-2300 • Fax: (715) 634-5949
 J. Spencer Wiley Boyd Beley Dave Williamson Chuck Quandt

Web Site: <http://haywardtakes.com/areanorth.htm>
 E-Mail: anr@win.bright.net

TOPOGRAPHIC SURVEY

STATE OF WISCONSIN
STATE HIGHWAY COMMISSION
GEOLOGICAL AND NATURAL HISTORY SURVEY

CHIEF LAKE QUADRANGLE
WISCONSIN-SAWYER CO.
7.5 MINUTE SERIES (TOPOGRAPHIC)
NE 4 COUDERAY 15' QUADRANGLE

2776 II SW
(SPIDER LAKE)

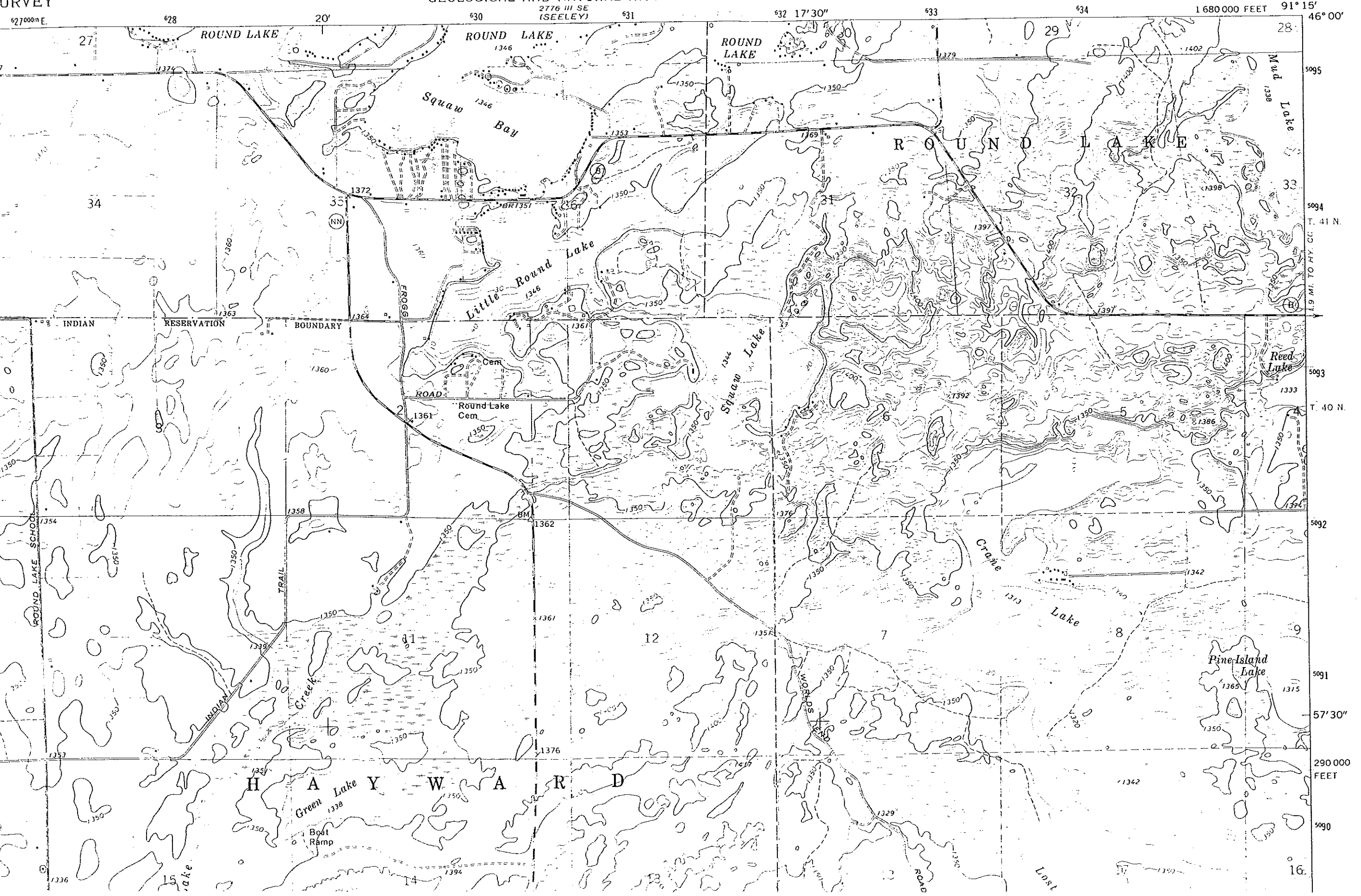

1 680 000 FEET
91° 15'
46° 00'
5095
5094
T. 41 N.
5093
T. 40 N.
5092
5091
57' 30"
290 000 FEET
5090
16.