

# LAKE SURVEY MAP

WISCONSIN CONSERVATION DEPARTMENT  
BIOLOGY DIVISION  
LAKE AND STREAM IMPROVEMENT SECTION

LAKE BOLGER  
SECTION 26-27  
TOWNSHIP 39 N  
RANGE 6 E  
TOWN OF MINOCQUA  
COUNTY ONEIDA

FORM FH17

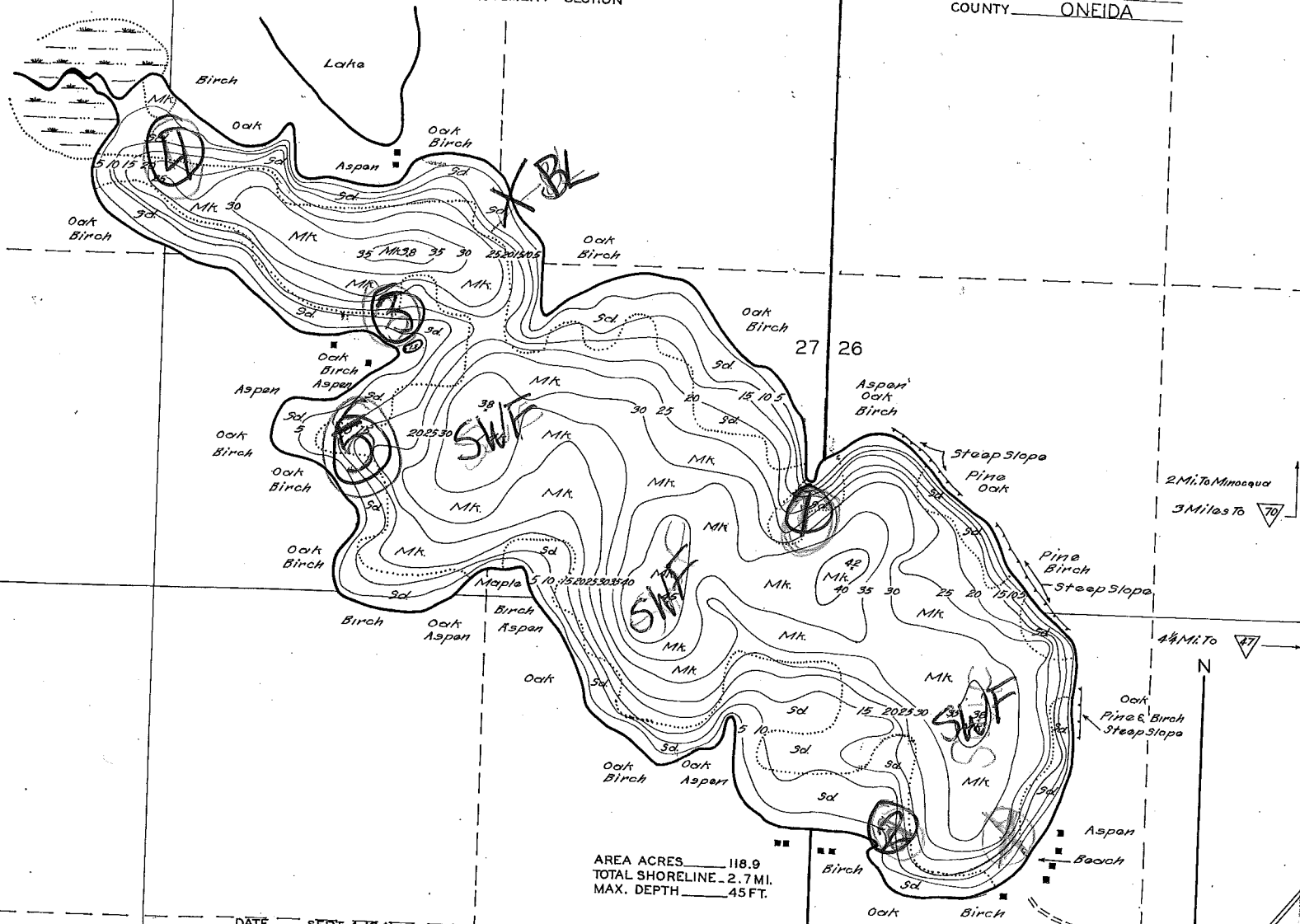

AREA ACRES 118.9  
TOTAL SHORELINE 2.7 MI.  
MAX. DEPTH 45 FT.

DATE SEPT 4 1941  
COMPILED BY \_\_\_\_\_  
TRACED BY W.T.Z. (WPA)  
SOURCE OF INFORMATION  
CAMP BLUE LAKE  
LAKE SURVEY PROJECT FEB 1941

SOUNDINGS AT 150 FT. INTERVALS

DATES OF MAP REVISION

WORK AGENCY C.C.C.

### LAKE IMPROVEMENT RECORD

TYPE	DATE			
○ BRUSH REFUGES				
— SAPLING TANGLES				
□ SPAWNING BOXES				
* MINNOW SPAWNERS				
TOTAL				

SCALE 1 INCH EQUALS 300 FT.

### LEGEND

	WEED BEDS
	ROCKY SHOALS
	SD.SAND
	CLAY
	GR.GRAVEL
	MK.MUCK
	DWELLING
	ABANDONED DWELLING
	RESORT