

Sheet 1 of 2

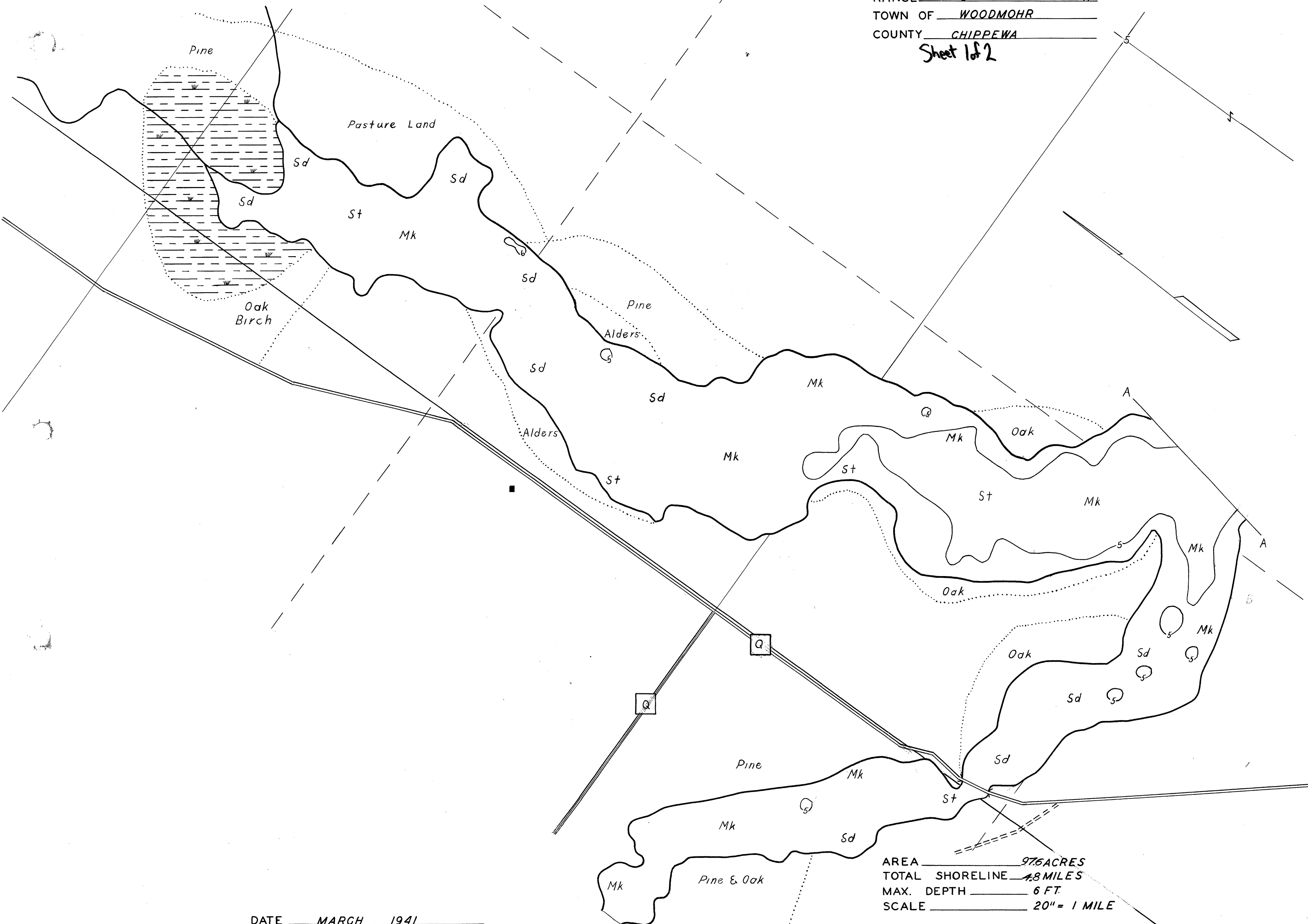

AREA 976 ACRES
 TOTAL SHORELINE 4.8 MILES
 MAX. DEPTH 6 FT.
 SCALE 20" = 1 MILE

DATE MARCH 1941
 COMPILED BY D. SUMMERS
 TRACED BY W.L.L. C.C.C.
 SOURCE OF INFORMATION W.P.A. LAKE SURVEY PROJECT
 SOUNDINGS 74 FT. INTERVAL
 DATES OF MAP REVISION _____
 WORK AGENCY C.C.C.

LAKE IMPROVEMENT RECORD

TYPE	DATE			
⊕ BRUSH REFUGES	_____	_____	_____	_____
⊗ SAPLING TANGLES	_____	_____	_____	_____
□ SPAWNING BOXES	_____	_____	_____	_____
* MINNOW SPAWNERS	_____	_____	_____	_____
TOTAL	_____	_____	_____	_____

- LEGEND
- ⊕ WEED BEDS
 - ⊗ ROCKY SHOALS
 - Sd SAND
 - St SILT
 - Gr GRAVEL
 - Mk MUCK
 - DWELLING
 - ABANDOND DWELLING
 - ▣ RESORT

CHECKED BY
 W.P.S.-E.M.K.
 6-13-41

5
 6 8
 7

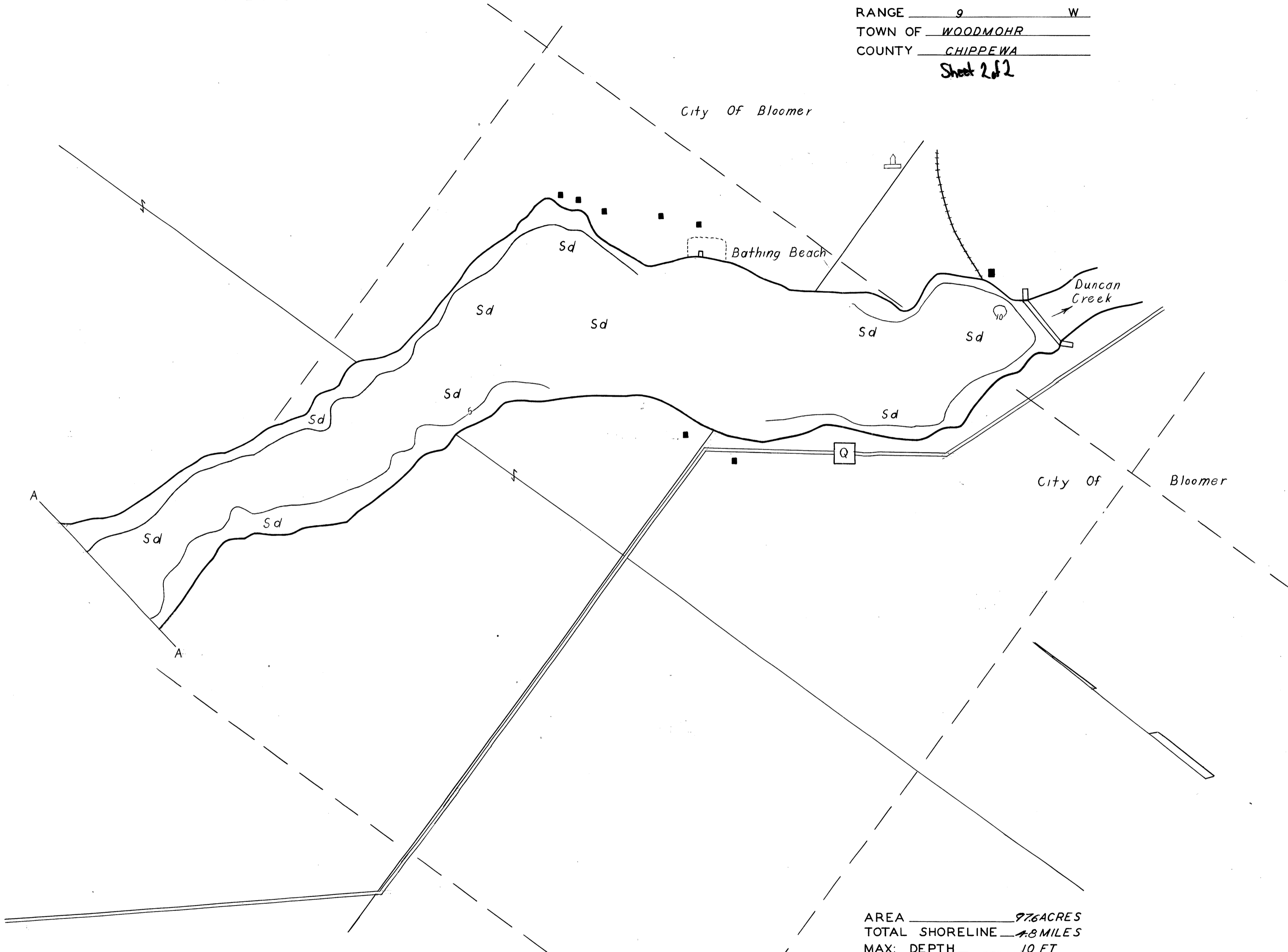

AREA 976 ACRES
 TOTAL SHORELINE 4.8 MILES
 MAX. DEPTH 10 FT
 SCALE 20" = 1"

DATE MARCH 1941
 COMPILED BY D. SUMMERS
 TRACED BY W.L.L. CCC
 SOURCE OF INFORMATION W.P.A. LAKE SURVEY PROJECT
 SOUNDINGS 74 FT. INTERVALS
 DATE OF MAP REVISION _____
 WORK AGENCY CCC

CHECKED BY
 W.P.S.-E.M.W.
 6-13-41

LAKE IMPROVEMENT RECORD

TYPE	DATE			
⊕ BRUSH REFUGES				
ω SAPLING TANGLES				
□ SPAWNING BOXES				
* MINNOW SPAWNERS				
TOTAL				

LEGEND

- ⊕ WEED BED
- ⊛ ROCKY SHOALS
- Sd SAND
- Cl CLAY
- Gr GRAVEL
- Mk MUCK
- DWELLING
- ABANDOND DWELLING
- ▣ RESORT

Source: Wisconsin Department of Natural Resources 608-266-2621
Lake Como – Chippewa County, Wisconsin DNR Lake Map
Date – Mar 1941 - Historical Lake Map - Not for Navigation
A Public Document - Please Identify the Source when using it.

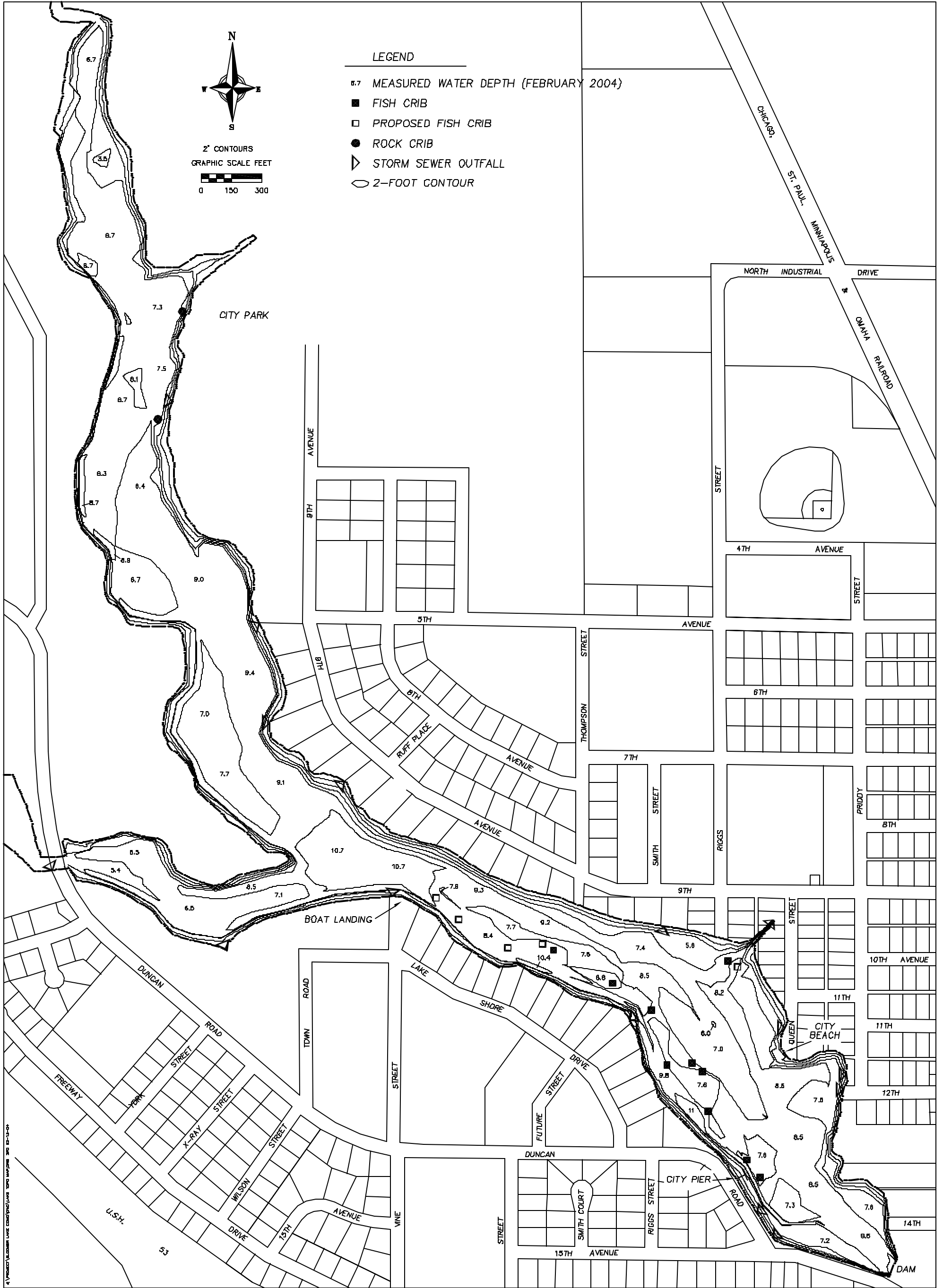

LAKE COMO
BLOOMER, WISCONSIN