

## Rain Garden Plant Quantities - Wallis

		Rain Garden #1				Rain Garden #2			
	Common Name	Scientific Name	Seedlings	3" Pots	4-6" Pots	1 gallon	Seedlings	3" Pots	4-6" Pots
Flowers									
WG	Wild ginger	<i>Asarum canadense</i>		22					
GR	Wild geranium	<i>Geranium</i>		14				21	
BF	Blue flag iris	<i>Iris versicolor</i>							5
BW	Butterfly weed	<i>Asclepias tuberosa</i>			3				
PC	Purple coneflower	<i>Echinacea pupurea</i>		3					
BS	Tall blazing star	<i>Liatris pycnostachya</i>						4	
BL	Blue lobelia	<i>Lobelia siphilitica</i>		2				2	
TH	Turtlehead	<i>Chleone glabra</i>		3				4	
Ferns									
LF	Lady fern	<i>Athyrium filix-femina</i>							2
OF	Ostrich fern	<i>Matteuccia struthiopteris</i>							2
Sedges and Grasses									
PN	Pennsylvania sedge	<i>Carex pensylvanica</i>					20		
FX	Fox Sedge	<i>Carex vulpinoidea</i>						6	
PD	Prairie dropseed	<i>Sporobolus heterolepis</i>		6					
Shrubs									
SB	Snowberry	<i>Symphoricarpos albus</i>				2			
				<b>50</b>	<b>3</b>	<b>2</b>	<b>20</b>	<b>37</b>	<b>9</b>

Plant seedlings with 12" spacing

Plant 3 inch pots with 16" spacing

Plant 6 inch pots with 18" spacing

Plant ferns and shrubs as indicated on plan

Pot sizes can be substituted with spacing indicated

Leanne Wallis  
Rain Garden #1

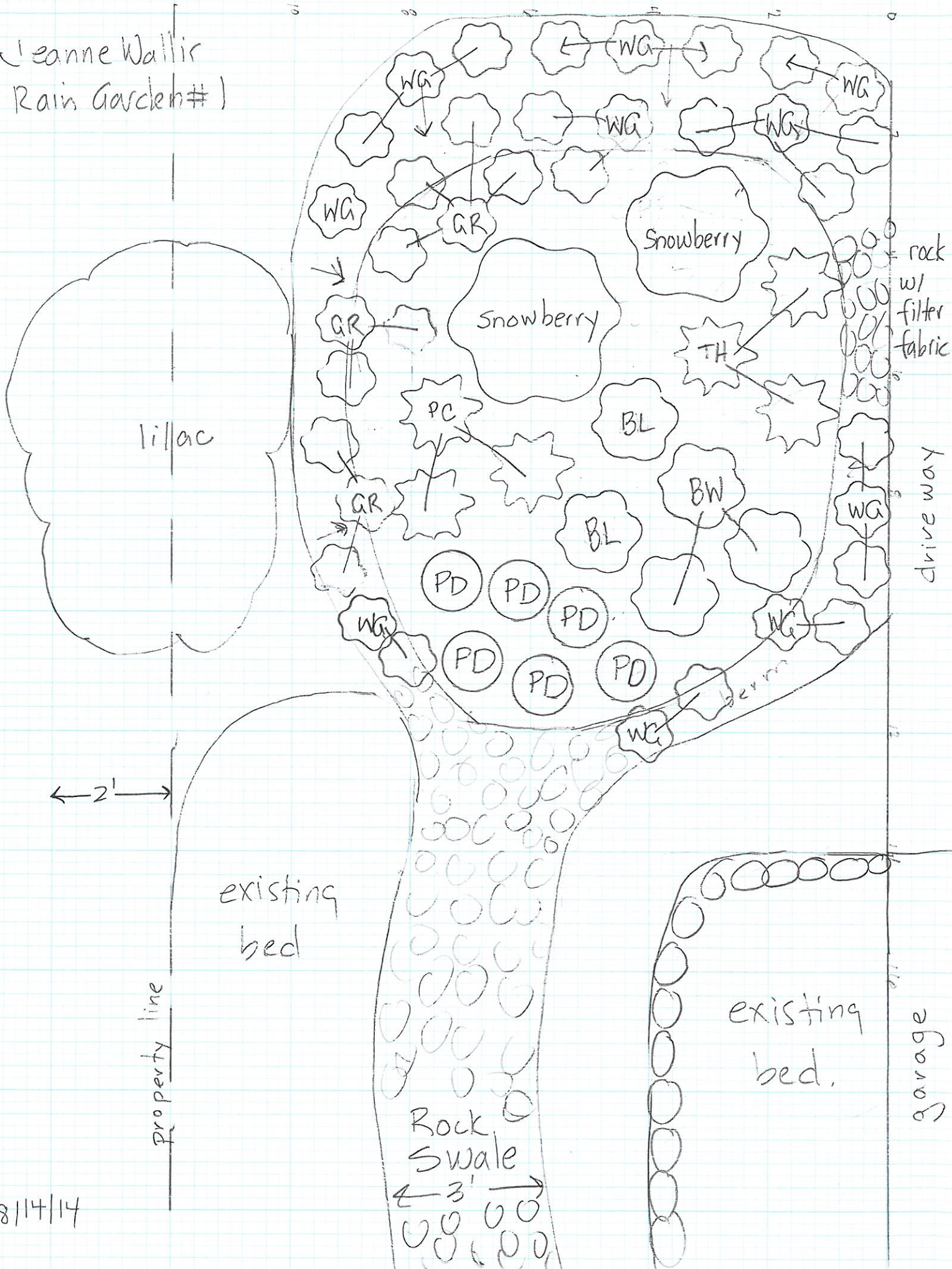

Lilac

Snowberry

Snowberry

PC

BL

BL

BW

PD

PD

PD

PD

PD

PD

existing bed

existing bed

Rock Swale

← 3' →

← 2' →

property line

rock w/ filter fabric

drive way

garage

8/14/14

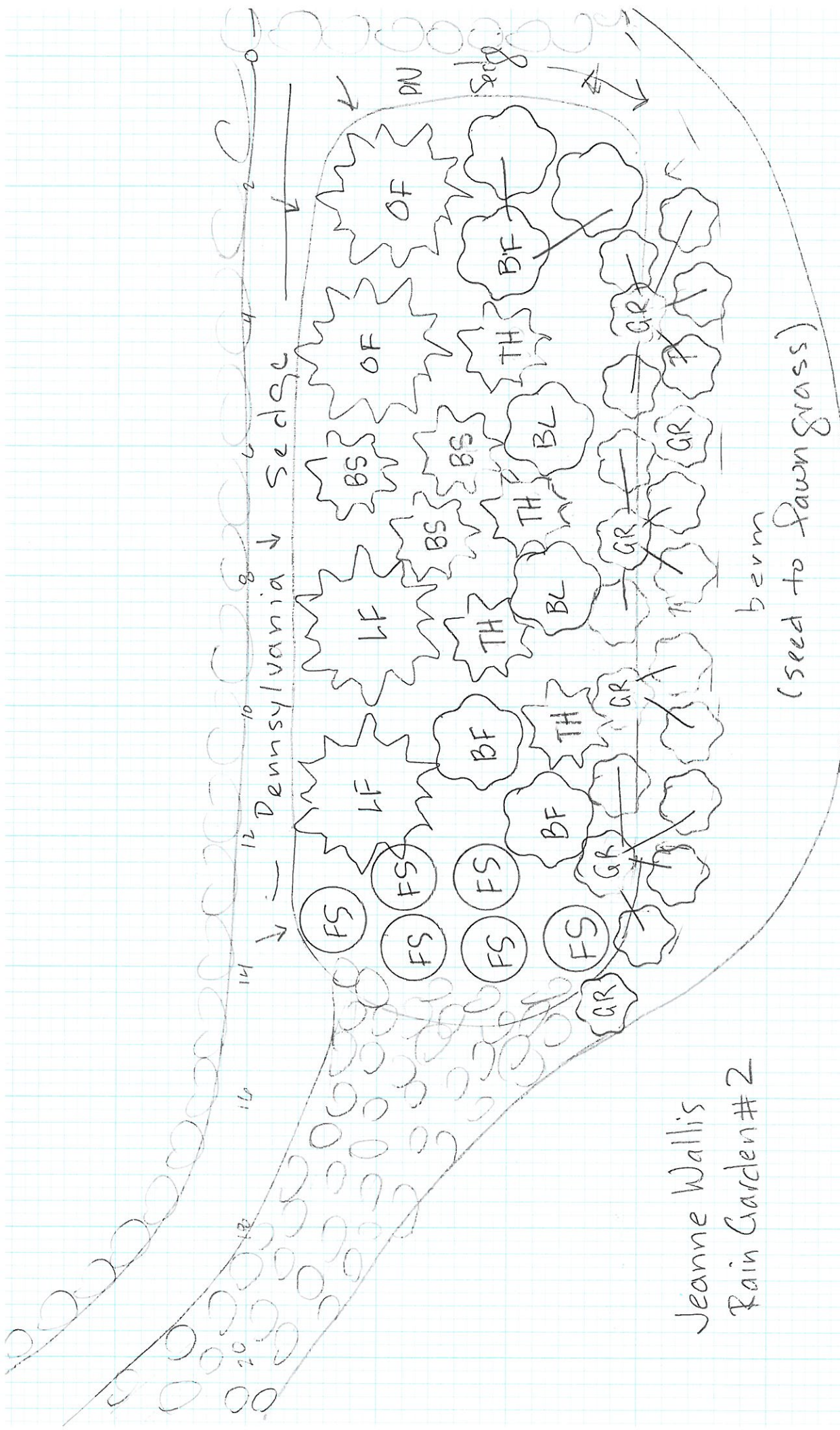

Jeanne Wallis  
Rain Garden #2

← 2' →

8/14/14