

Plant Operations
116 State Street
P. O. Box 167
Neshkoro, WI 54960 USA
Tel: 920-293-4628
Fax: 920-293-8087
Email: nah@nahydro.com



Engineering & Manufacturing
1323 B Everest Avenue
Schofield, WI 54476 USA
Tel: 715-359-0209
Fax: 715-359-1049
Email: schofield@nahydro.com
Web: www.nahydro.com

October 28, 2002

Mr. Jeffrey Scheirer
Northern Region FERC Manager
Wisconsin Department of Natural Resources
P.O. Box 220
875 South 4th Avenue
Park Falls, WI 54552

Ms. Janet Smith
Fish & Wildlife Biologist
U.S. Fish and Wildlife Service
1015 Challenger Court
Green Bay, WI 54311

Re: *Flambeau Crowley Project, No. 2473, Flambeau Hydro, L.L.C.*
Article 410, Purple Loosetrife Inventory

Dear Mr. Scheirer and Ms. Smith:

Attached is a copy of our "Purple Loosetrife Inventory" for 2002. This annual report has been prepared to comply with Article 410 of the project's federal hydropower license.

We invite you to review and comment, but we respectfully request that any written response be provided to us within thirty (30) days from the date of this letter.

Please contact me if you wish discussion or have any questions. Your cooperation is appreciated.

Sincerely,

NORTH AMERICAN HYDRO, Inc.

A handwritten signature in black ink, appearing to read "Loyal Gake".

Loyal Gake, P.E.
Director of Development and
Regulatory Compliance

Attachment

**Flambeau Crowley Project Purple Loosestrife Inventory
August 3, 2002 & August 6, 2002
FERC Project #2473 Article 410**

**Flambeau Hydro, L.L.C.
116 State St.
Neshkoro, WI 54960**

Purple Loosestrife

On August 3 and August 6, 2002, Flambeau Hydro, L.L.C. (FHLLC) performed an inventory of purple loosestrife plants at the Flambeau Crowley Project in Price County, Wisconsin. The method of inventory had not been approved by Federal Energy Regulatory Commission (FERC) at the time of the survey. In lieu of an approved plan, the following method was used:

While Purple Loosestrife is blooming in mid July to early August, the inventory should be conducted using a boat to survey the impoundment above the dam within the Project Boundary and on foot or by boat below the dam within the Project Boundary. County wetland maps may be used to determine other areas where Purple Loosestrife could be found on lands owned by FHLLC within the Project Boundary. Lands owned by FHLLC within the Project Boundary will be surveyed on foot. A pair of binoculars should be used to search for the purple flowered spikes of the plant. When plants are located, the person(s) inventorying should get close enough to make a positive identification without disturbing the plants or the immediate area around the plants as this could cause them to spread. A GPS receiver will be used to establish a GPS coordinate for the location of the plants. If it is not possible to get close enough to establish an accurate location, an approximate location will be established with reference to an established GPS coordinate. The plants should be inventoried by marking and numbering the location on a Project map along with notes approximating size of plants, stand area, percent cover, stem density, plant density, and location with reference to established GPS coordinates. Photos and/or videotape will be taken of the largest occurrences.

Example:

#1 6' tall plants; 4' X 20'; 30% cover; 4 – 5 stems per plant; 4 plants; on shoreline N45° 56.183' W90° 26.748'; no photo

#2 5' - 7' tall plants; 10' X 10'; 25% cover; 4 – 5 stems per plant; 10 plants; in marsh ~50 feet bearing 25° from N45° 56.256' W90° 26.710'; photo No. 1

The area to be inventoried shall be the shoreline of the impoundment to elevation 1428 feet NGVD and lands owned by FHLLC within the Project Boundary as indicated on the Project Map 1, dated November 1991, included in Exhibit G of Flambeau Paper Corp. Application For A Subsequent License for the Crowley Hydroelectric Project FERC Project #2473.

General Observations:

The Flambeau Crowley Project Boundary was divided into three different areas; *the impoundment* (from approximately 500 feet downstream of the Pixley dam to the Crowley dam), *FHLLC owned property within the project boundary* (FHLLC owned property adjacent to the dam and powerhouse), and *the tailrace* (from the dam and powerhouse to approximately 500 feet downstream of the dam).

The tailrace was surveyed by boat and no purple loosestrife plants were observed.

The FHLLC owned property within the project boundary was surveyed on foot and no purple loosestrife plants were observed.

The impoundment was surveyed by boat and a single plant was found on a bog in a stump field in the river east of the 6-mile boat landing. A number of purple loosestrife plants were also found on the HWY 70 causeway just east of the 6-mile boat landing. The causeway was then surveyed on foot. All observed occurrences of purple loosestrife plants were inventoried and have been noted on the survey sheet(s) and map(s) at the end of this report. FHLLC personnel removed the seed heads of all these occurrences of purple loosestrife plants to reduce propagation.

During the inventory, an 8mm camcorder and digital camera were used to document new occurrences of purple loosestrife as noted in the survey comments at the end of this report.

LAKE SURVEY MAP

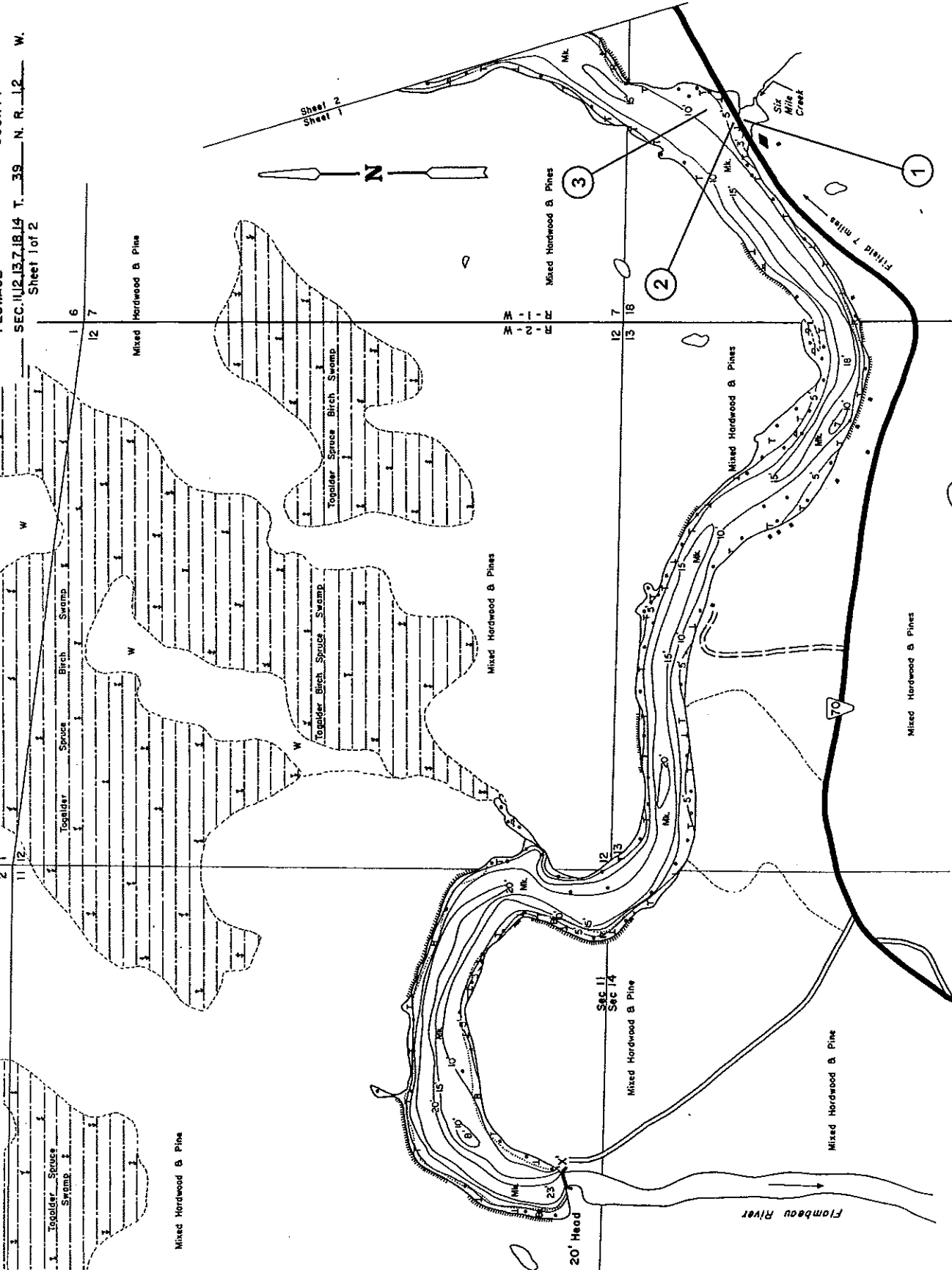

LAKE SURVEY MAP

CROWLEY
FLOWAGE
COUNTY
SEC. 5, 6, 7, 8 T. 39 N. R. 1 W.
Sheet 2 of 2

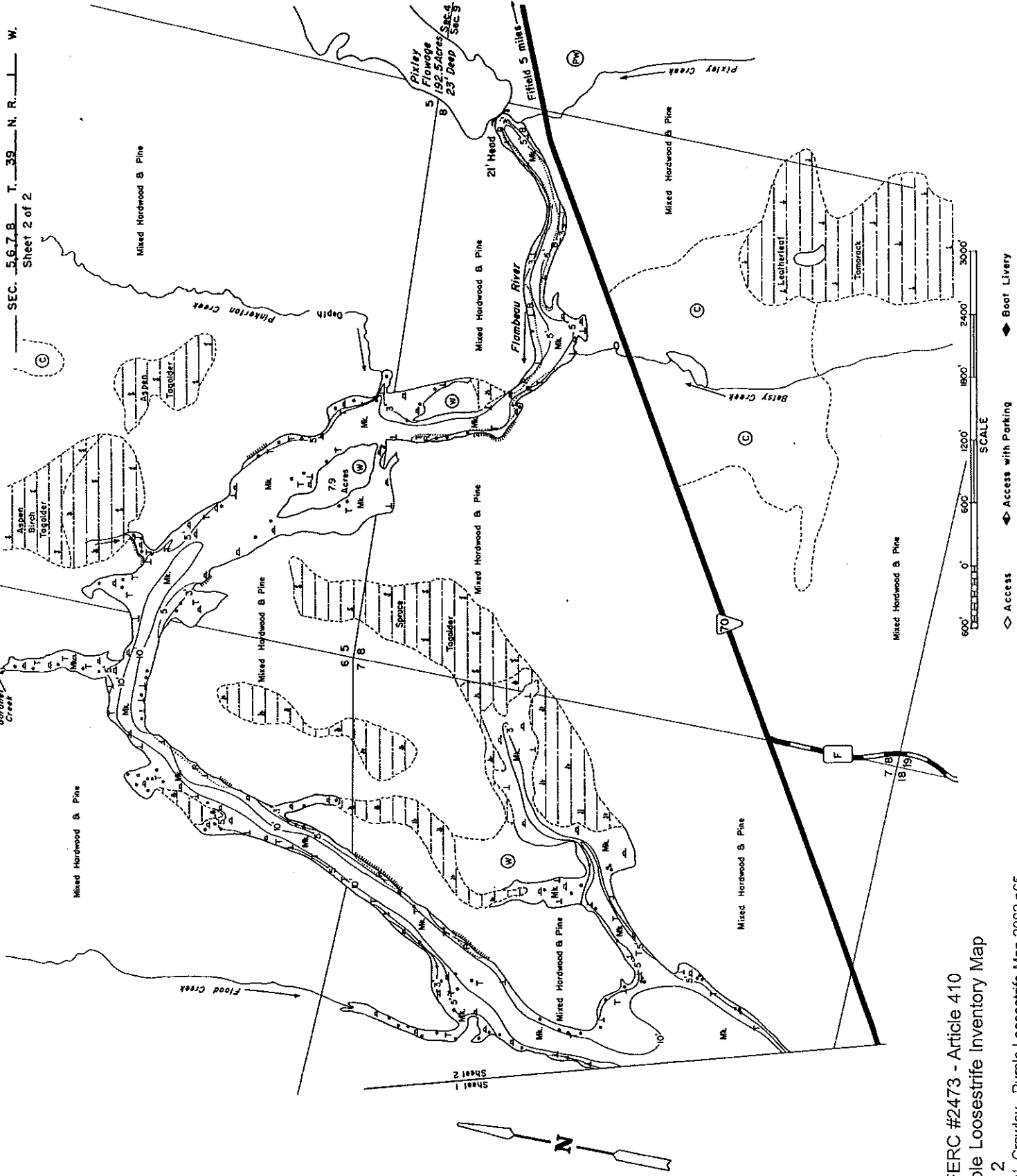

Purple Loosestrife Survey

Project: Flambeau Crowley #2473

Datum:

WGS 84

Date: 8/2/02, 8/5/02, & 8/29/02

Page:

1 of 1

Crew: RAL & SRL

Sighting #	GPS point	Latitude	Longitude	Plant Height	Stand Area	Comments
1	209 - 215	N45°51.816' - N45°51.850'	W90°32.859' - W90°32.786'	3' - 5'	~375' x 8'	Located between GPS points 209 and 215 on the south side of the causeway formed by HWY 70 just east of the 6-mile boat landing. There are ~35 plants spread out over a 375 foot long area. The largest concentration is about 25 plants and the rest are individual plants. Plants appear to have ~2 - 10 stems per plant. All seed heads were harvested in August 2002 to prevent propagation. Contact has been made with the Wisconsin Department of Transportation to discuss control methods in 2003. This occurrence recorded on digital photos and video tape in 2002.
2	216 - 217	N45°51.857' - N45°51.853'	W90°32.806' - W90°32.814'	3' - 6'	~45' x 4'	Located between GPS points 216 and 217 on the north side of the causeway formed by HWY 70 just east of the 6-mile boat landing. There are 3 plants spread out over a 45 foot long area. They are all individual plants. Plants appear to have ~2 - 10 stems per plant. All seed heads were harvested in August 2002 to prevent propagation. Contact has been made with the Wisconsin Department of Transportation to discuss control methods in 2003. This occurrence recorded on digital photos in 2002.
3	208	N45°51.926'	W90°32.788'	4' - 5'	~2' x 2'	Located on a bog in a stump field in the river east of the 6-mile boat landing. There is one plant. Plant appears to have ~2 - 3 stems per plant. All seed heads were harvested in August 2002 to prevent propagation. This occurrence recorded on digital photos in 2002.