



North American Hydro Holdings, Inc. — Plant Operations:
116 State Street, P.O. Box 167, Neeshkoro, WI 54960 USA
Tel 920-293-4628 Fax 920-293-6087 Email nah@nahydro.com Web www.nahydro.com

Engineering & Manufacturing:
1323 B Everest Avenue, Schofield, WI 54478 USA
Tel 715-359-0209 Fax 715-359-1049 Email schofield@nahydro.com Web www.nahydro.com

February 18, 2005

The Secretary
Federal Energy Regulatory Commission
888 First Street, NE
Washington, DC 20426

ORIGINAL

-034

RECEIVED
FEB 24 10 23 31
FEDERAL ENERGY
REGULATORY
COMMISSION

**Re: Oconto Falls Upper, Project No. 2523, N.E.W. Hydro, Inc.
Submittal of Purple Loosestrife/Eurasian Watermilfoil Inventory for Year 2003**

Dear Secretary:

Please find enclosed an original and 8 copies of the Oconto Falls Upper, Project No. 2523 Purple Loosestrife Inventory/Eurasian Waermilfoil Inventory for 2003. Our records show that this report has not been filed with the FERC. In 2004, this report was sent to the Wisconsin Department of Natural Resources (WIDNR) and the US Fish and Wildlife Service (USFWS) for comment. No comments were received from the WIDNR or the USFWS.

If you have any questions regarding this submission, please contact Mr. Richard Loeffler at 920-293-4628 ext. 18.

Sincerely,
NORTH AMERICAN HYDRO, INC.

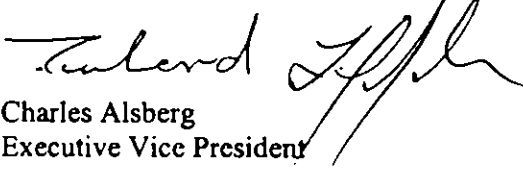
FOR Charles Alsberg
Executive Vice President

Cc: FERC – CRO
Encl.: 1 original & 8 copies

05-02-23 RAL OFUP 2003 loosestrife survey to FERC.doc

**Oconto Falls Upper Project Purple Loosestrife & Eurasian Watermilfoil Inventory
August 24 & August 25, 2003
FERC Project #2523 Article 407**

**NEW Hydro, Inc.
116 State St.
Neshkoro, WI 54960**

Purple Loosestrife

On August 24, 2003 and August 25, 2003, NEW Hydro, Inc. (NEW) performed an inventory of purple loosestrife plants at the Oconto Falls Upper Project in Oconto County, Wisconsin. The method of inventory as approved and modified by Federal Energy Regulatory Commission (FERC) Order of November 19, 1999 was defined as follows:

After Purple Loosestrife has bloomed in mid July to early August, the inventory should be conducted using a boat to survey the impoundment above the dam and on foot or by boat below the dam. County wetland maps will be used to determine other areas where Purple Loosestrife could be found on lands owned by NEW within the Project Boundary. These areas will be surveyed on foot. A pair of binoculars should be used to search for the purple flowered spikes of the plant. When plants are located, the person(s) inventorying should get close enough to make a positive identification without disturbing the plants or the immediate area around the plants as this could cause them to spread. A GPS receiver will be used to establish a GPS coordinate for the location of the plants. If it is not possible to get close enough to establish an accurate location, an approximate location will be established with reference to an established GPS coordinate. The plant should be inventoried by marking and numbering the location on a lake map along with notes approximating size of plants, stand area, percent cover, stem density, plant density, and location with reference to established GPS coordinates. Photos and/or videotape will be taken of the largest occurrences.

Example:

#1 6' tall plants; 4' X 20'; 30% cover; 4 – 5 stems per plant; 4 plants; on shoreline N44° 52.9092' E88° 10.0000'; no photo

#2 5' - 7' tall plants; 10' X 10'; 25% cover; 4 – 5 stems per plant; in marsh 50 feet bearing 25° from N44° 52.5092' E88° 10.0000'; photo No. 1

The area to be inventoried shall be the shoreline and lands owned by NEW within the Project Boundary as indicated on the Project Boundary map included

as Exhibit G of NEW Hydro, Inc. Application For New License for the Oconto Falls Hydroelectric Project FERC Project #2523. The Project Boundary is shown as the water and shoreline of the impoundment from approximately 6000' upstream of the State Highway 32 bridge to approximately 500' downstream of the Project dam.

General Observations:

For purple loosestrife, the Oconto Falls Upper Project Boundary was divided into four distinctly different areas; the tailrace (from the dam to 500' immediately downstream of the dam on the east end of the impoundment), the main basin (from the dam to 2 miles upstream of the dam where the river narrows), the headwaters (from 2 miles upstream of the dam where the river narrows to the western point of the project boundary ~6,000 feet upstream of the Highway 32 bridge), and outlying project owned lands.

The tailrace was surveyed on foot and was found to contain no visible purple loosestrife plants.

The main basin was surveyed by boat and was found to contain no visible purple loosestrife plants.

The headwaters were surveyed by boat. Five occurrences of purple loosestrife plants were observed in this area and are noted on the lake map and survey comments at the end of this report. One of these occurrences appears to be on project owned land and is so noted. Sighting #1 (located on project owned land) was observed in 2000, 2001, 2002, and 2003 and appears not to have spread. In 2002 seed heads on three of the plants nearest the main river were removed, bagged, and burned to reduce possibility of spreading. In 2003, a permit to spray this sighting with an herbicide was acquired from the Wisconsin Department of Natural Resources and These plants were sprayed on August 24, 2003. On August 25, 2003 (more than 24 hours later) a number of the plants showed signs of stress. Sighting #2 was observed in 2000, 2001, 2002, and 2003 and appears not to have spread. In 2003, the seed heads on all these plants were removed, bagged, and burned to reduce the possibility of spreading. Sighting #3 was observed in 2001, 2002, and 2003 and appears not to have spread. In 2002 and 2003 seed heads on all of these plants were removed, bagged, and burned to reduce possibility of spreading. Sighting #4 was observed, pulled, and burned in 2001 and was no longer present in 2002 or 2003. Sighting #5 was observed in 2002 and 2003 and appears not to have spread. Sighting #6 was observed in 2002 and 2003 and appears not to have spread. In 2002 and 2003, seed heads on all of these plants were removed, bagged, and burned to reduce possibility of spreading.

The outlying project owned lands were first researched using aerial wetland maps to determine the areas conducive to purple loosestrife growth. These areas were then surveyed on foot and were found to contain no visible purple loosestrife plants.

During the inventory, an 8mm camcorder was used to document new occurrences of purple loosestrife as noted in the survey comments at the end of this report.

Eurasian Watermilfoil

On August 24, 2003 and August 25, 2003, NEW Hydro, Inc. performed an inventory of Eurasian watermilfoil plants at the Oconto Falls Upper Project in Oconto County, Wisconsin. The method of inventory as approved and modified by FERC Order of November 19, 1999 was defined as follows:

After Eurasian watermilfoil has developed in mid July to early August, the inventory should be conducted by boating transects in the impoundment above and below the dam. Number and locations of transects will be determined at the time of the first inventory and appropriately marked on the inventory lake map. A GPS receiver will be used to establish GPS coordinates for the beginning and endpoints of the transects. The person(s) inventorying should visually search areas with depths of 12 feet or less for the dense mats of the plants on and below the water surface. When plants are located, the person(s) inventorying should get close enough to make a positive identification without disturbing the plants or the immediate area around the plants as this could cause them to spread. If necessary, a sample may be taken for identification later. The plant should be inventoried by marking and numbering the location on a lake map along with notes approximating area that they cover, perimeter of bed, mat density, overall mat thickness, and location with reference to the GPS coordinates. Photos and/or videotape will be taken of the largest occurrences.

Example:

#1 40' X 20'; 3' depth; perimeter N44° 52.8925' E88° 10.0000' N44° 52.8860' E88° 10.0000', N44° 52.8860' E88° 09.9953', N44° 52.8925' E88° 09.9953'; 50% density; 3' thick; no photo

#2 8' X 10'; 10' depth; N44° 52.9008' E88° 10.0000', N44° 52.8995' E88° 10.0000', N44° 52.8995' E88° 09.9980', N44° 52.9008' E88° 09.9980'; 25% density; 8' thick; photo No. 1

The area to be inventoried shall be that within the Project Boundary as indicated on the Project Boundary map included as Exhibit G of NEW Hydro,

Inc. Application For New License for the Oconto Falls Hydroelectric Project
FERC Project #2523. The project boundary is shown as the water and
shoreline of the impoundment from approximately 6000' upstream of the State
Highway 32 bridge to approximately 500' downstream of the Project dam.

General Observations:

For Eurasian watermilfoil, the Oconto Falls Upper Project Boundary was divided into three distinctly different areas; the tailrace (from the dam to 500' immediately downstream of the dam on the east end of the impoundment), the main basin (from the dam to 2 miles upstream of the dam where the river narrows), and the headwaters (from 2 miles upstream of the dam where the river narrows to the western point of the project boundary ~6,000 feet upstream of the Highway 32 bridge).

Water clarity at the Project at the time of the survey was limited to 1' – 3'. It was determined at that time to use a 14" wide garden rake with a 5.5' handle for shallow areas and a 14" wide garden rake attached to an 18' aluminum pole for deeper areas. In the past, a throw rake (garden rake with a rope attached) was used to retrieve weed samples, but the 18' handle gives better control and cuts down on sampling time. For 2000 and 2001 surveys, no weed growth of any kind was retrieved from waters deeper than 10', so sampling at the 15' depth was discontinued.

The *main basin* was inventoried first followed by the *headwaters* and, finally, the *tailrace*.

The tailrace was surveyed visually and with the use of a rake mounted on an 18' aluminum pole. No Eurasian watermilfoil plants were found.

The main basin was surveyed visually and with the use of a 14" wide garden rake with a 5.5' handle for shallow areas and a 14" wide garden rake attached to an 18' aluminum pole for deeper areas. Eight transects were established in 2000 in this area with sample points at 1.5', 5', and 10' depths. Each sample point of each transect was an 8' circle divided into quadrants. Each quadrant was sampled using one of the rakes. If the teeth of the rake contained less than 50% Eurasian watermilfoil, a rating of 1 was assigned, and if 50% or more, a rating of 2 was assigned. In addition, areas of weed growth were visually searched while skirting the perimeter of weed beds and shoreline.

No weed samples of any kind were detected at the 10' depth. On the sampling date, boat traffic was heavy and observations of floating segments of Eurasian watermilfoil were common. Special attention was paid to each of the boat landings.

At the northeast boat landing near the hydroelectric plant, ~30 – 40 Eurasian watermilfoil plants were found growing from the bottom near the landing and docks along with ~5 – 10 floating strands. This appeared to be about the same as in 2002.

This occurrence was not considered a "mat" since the plants were spread far apart, but may attain "mat" status in the future. No Eurasian watermilfoil was observed on the apron of the landing.

The north boat landing immediately east of the north swimming beach had no floating strands of Eurasian watermilfoil near the landing with no plants appearing to be growing from the bottom. There appeared to be ~5 – 6 strands of Eurasian Watermilfoil on the apron of the landing.

The boat landing at the West Park is within mat #5 and Eurasian watermilfoil plants were found floating around the landing and dock and was mixed in with other weeds on the apron of the landing.

No Eurasian watermilfoil was detected at sampling locations with depths greater than 5'. Those occurrences at 5' depth and less were easily identified without the use of dredging techniques as the plants had grown to the surface and most had reddish tops.

In past years, some sampling points did not yield any Eurasian watermilfoil plants, although there may have been some plants floating on the surface and/or growing from the bottom within 25' of the sampling point. In 2002, a column was added to the survey sheet at the end of this report to show these observations.

Seven mats containing Eurasian watermilfoil were identified within the project boundary of which mat #1, #2, #3, and #4 were first identified in the 2000, mat #5 was first identified in 2001, and mat #6 and #7 are first identified in 2003. All seven mats were discovered using the visual search method. All of these mats were interspersed with other types of plants and all of the mats had Eurasian watermilfoil densities as noted in the survey comments at the end of this report. Mats #1 and #2 appear to have remained the same size, but have decreased in density since 2002. Mat #3 appears to have remained the same size and density since 2002. Mat #4 expanded in size but appears to have the same density as in 2002. Mat #5 has remained the same size, but has increased in density since 2002. Mat #6 was first noted in the 2002 report as numbers of Eurasian watermilfoil plants discovered in the shallow waters surrounding the island on the south side of the main basin (between transects #1 and #2). This occurrence was not considered a "mat" at that time since the plants were spread far apart. Now plants have reached a density to be considered "mat" status.

The headwaters were surveyed visually and with the use of a 14" wide garden rake with a 5.5' handle. No Eurasian watermilfoil plants were found.

Purple Loosestrife Survey

Project: Oconto Falls Upper #2523
Date: 8/24/2003 & 8/25/2003
Crew: RAL & CTM

Datum: WGS 84
Page: 1 of 2

Sighting #	GPS point	Latitude	Longitude	Plant Height	Stand Area	Comments
1	66	N44°53.0397'	W088°13.7630'	4' - 6'	~50' x 20'	Located ~30 yards bearing 0° (north) of GPS point on the north side of a marshy slough. Appears to be on a snowmobile trail, as snowmobile trail signs are on either side of slough opening into the river channel. ~30 - 50 plants with 1 - 10 stems per plant. The plants cover ~20% - 30% of the stand area. There is also one 4' tall single stem plant located ~10 yards, one 4' tall single stem plant located ~20 yards, and three 4' - 6' tall 1 - 5 stems per plant located ~50 yards all bearing 270° (west) of the GPS point on the west side of the slough. These plants are all located on project owned lands. This occurrence recorded on video tape in 2000. Seed heads of 3 plants nearest main river channel removed in 2002 and sprayed with herbicide in 2003.
2	67	N44°52.8626'	W088°14.9756'	4' - 6'	~10' x 10'	Located ~30 yards south of GPS point on the south side of a marshy slough located directly west of the HWY 32 wayside boat landing. ~5 plants with 5 - 15 stems per plant. The plants cover ~75% of the Stand Area. This occurrence recorded on video tape in 2000.
3	78	N44°53.012'	W088°13.614'	4' - 6'	2 plants	Located ~10 yards north of GPS point on the north side of the river. 2 plants are ~5 yards apart with 2 - 5 stems per plant. This occurrence recorded on video tape in 2001. Seed heads removed in 2002 and 2003.
4	79	N44°52.943'	W088°14.809'	5'	1 plant	Located near the waters edge on the northeast side of the HWY 32 bridge. This plant was pulled and disposed in 2001 and was not present in 2002 or 2003. This occurrence recorded on video tape in 2001.

Purple Loosestrife Survey

Project: Oconto Falls Upper #2523
Date: 8/24/2003 & 8/25/2003
Crew: RAL & CTM

Datum: WGS 84
Page: 2 of 2

Sighting #	GPS point	Latitude	Longitude	Plant Height	Stand Area	Comments
5	178	N44°53.029'	W088°13.524'	4' - 6'	3 plants	Located on the edge of the far side of a slough ~30 yards - 60 yards northwest of the waypoint. Two of the plants are on either side of a stand of cattails. The third plant is located ~30 yards to the east of these plants. All plants have 3 - 8 stems per plant. This occurrence was recorded on video tape in 2002.
6	179	N44°52.895'	W088°12.805'	4' - 5'	2 plants	Located ~10' due north of the waypoint on the bank. One plant had 3 stems and the other had 7 stems. Seed heads removed in 2002 and 2003. This occurrence was recorded on video tape in 2002.

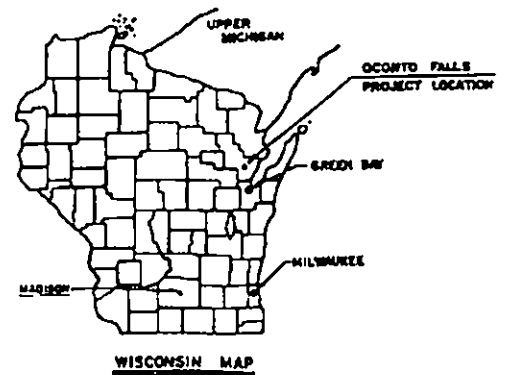
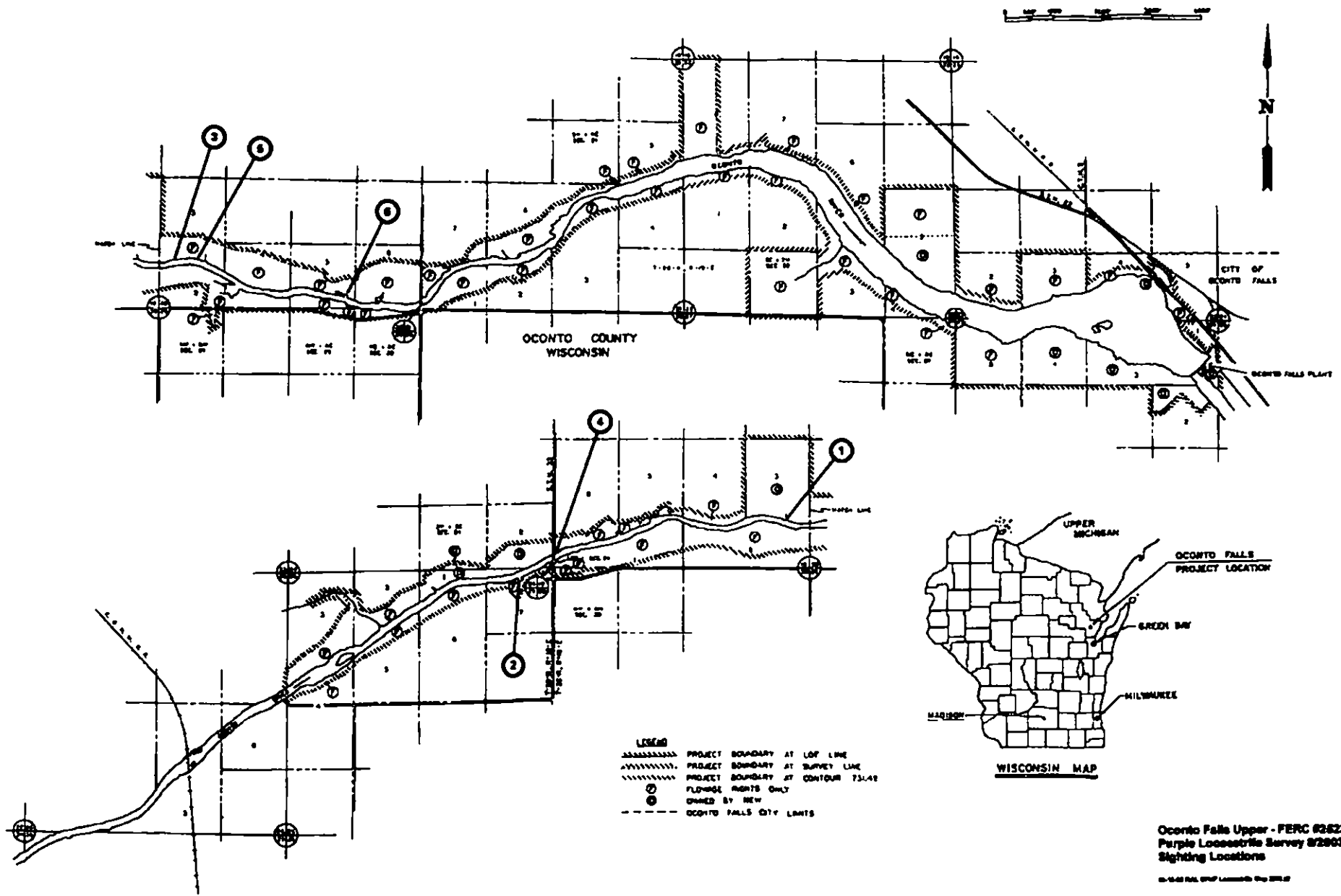

LEGEND

- PROJECT BOUNDARY AT LOF LINE
- PROJECT BOUNDARY AT SURVEY LINE
- PROJECT BOUNDARY AT CONTOUR 731.42
- ② FLOODAGE RIGHTS ONLY OWNED BY NEW
- - - - - OCONTO FALLS CITY LIMITS

Oconto Falls Upper - FERC #2623
 Purple Locestrife Survey #2863
 Sighting Locations
 © 1999 P&L GROUP, L.L.C. Map 2001.02

Eurasian Watermilfoil Survey - Transects

03-10-28 RAL OFSU 2003 Milfoil Survey form.xls

Project: Oconto Falls Upper #2523
Date: 8/25/2003
Crew: RAL & CTM

Datum: WGS 84
Page: 1 of 1

Eurasian watermilfoil growing from bottom within 25' of sample point = #
 Eurasian watermilfoil floating within 25' of sample point = *

1<50% 1<50% 1<50% 1<50%
 2≥50% 2≥50% 2≥50% 2≥50%

Transect #	Depth	GPS point	Latitude	Longitude	Quad 1	Quad 2	Quad 3	Quad 4	Rating	Within 25'
1	1.5	9	N44°52.7195'	W088°09.4319'	0	0	0	0	0	
	5	10	N44°52.7343'	W088°09.4323'	0	0	0	0	0	#
	10	11	N44°52.7684'	W088°09.4185'	0	0	0	0	0	
2	1.5	13	N44°52.6616'	W088°09.2612'	0	0	0	0	0	
	5	14	N44°52.7357'	W088°09.2024'	1	1	1	1	4	#*
	10	15	N44°52.7716'	W088°09.1844'	0	0	0	0	0	
3	1.5	17	N44°52.6085'	W088°09.1567'	0	0	0	1	1	*
	5	18	N44°52.6269'	W088°09.1521'	0	0	0	0	0	
	10	19	N44°52.6540'	W088°09.1324'	0	0	0	0	0	*
	5	20	N44°52.6842'	W088°09.1117'	0	0	0	0	0	
	10	21	N44°52.7166'	W088°09.0910'	0	0	0	0	0	
4	1.5	23	N44°52.5970'	W088°09.0412'	0	0	0	0	0	*
	5	24	N44°52.6102'	W088°09.0244'	0	0	0	0	0	
	10	25	N44°52.6183'	W088°08.9994'	0	0	0	0	0	
5	1.5	27	N44°52.8430'	W088°09.0258'	0	0	0	1	1	#*
	5	28	N44°52.8408'	W088°09.0274'	0	1	0	0	1	#*
	10	29	N44°52.8383'	W088°09.0359'	0	0	0	0	0	
6	1.5	37	N44°52.8919'	W088°09.2443'	0	0	0	0	0	#
	5	38	N44°52.8890'	W088°09.2434'	0	0	0	0	0	*
	10	39	N44°52.8808'	W088°09.2402'	0	0	0	0	0	
7	1.5	41	N44°52.8450'	W088°09.4266'	0	0	1	0	1	#
	5	42	N44°52.8420'	W088°09.4280'	0	0	0	0	0	#
	10	43	N44°52.8376'	W088°09.4237'	0	0	0	0	0	
8	1.5	45	N44°52.7965'	W088°09.6999'	0	1	1	1	3	#
	5	46	N44°52.7952'	W088°09.6999'	0	0	0	0	0	#*
	10	47	N44°52.7887'	W088°09.6960'	0	0	0	0	0	

LAKE SURVEY MAP

OCONTO FALLS
LAKE POND
COUNTY
SEC. 22, 23, 26 T. 28 N. R. 19 E.

STATE OF WISCONSIN
DEPARTMENT OF NATURAL RESOURCES

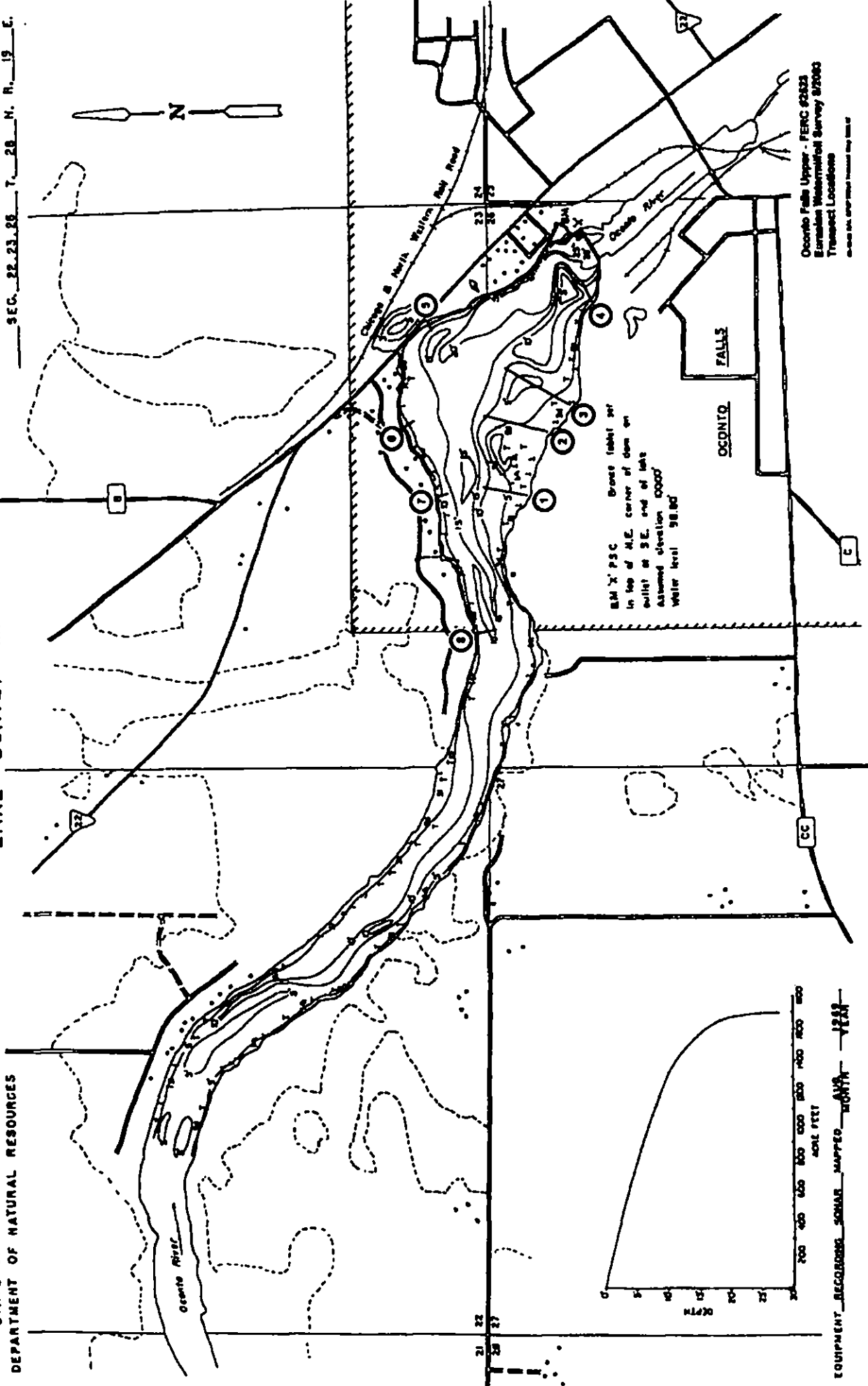
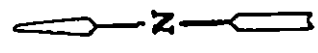

B.M. 'X' P.S.C. Brass (aluminum) set
in top of N.E. corner of dam on
outlet at S.E. end of lake
Assumed elevation 1000.0'
Water level 98.80'

Oconto Falls Upper - FERC #2323
Bumke Waterfall Survey 8/2003
Transect Locations
© 2003 USGS/ARL/USDA/USFWS/USDA/USFWS

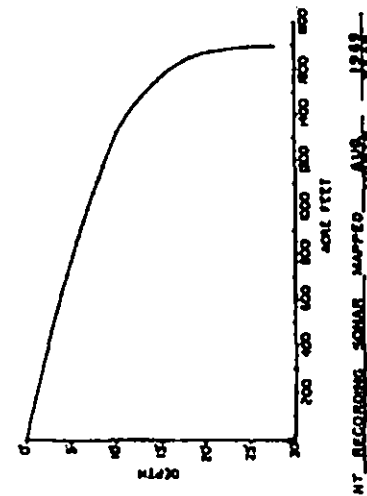

EQUIPMENT RECORDING SONAR MAPPED DATA YEAR

Eurasian Watermilfoil Survey - Mat Descriptions

Project: Oconto Falls Upper #2523 Datum: WGS 84
 Date: 8/25/2003 Page: 1 of 3
 Crew: RAL & CTM

Mat #	Depth	GPS point	Latitude	Longitude	Comments
1	0' - 5'	31	N44°52.7679'	W088°08.9863'	Located from immediately on the east side of the swimming beach to boat launch docks to the east. Mat extends from shore to ~20' out from shore. Mat is interspersed with other weeds. Total Mat density is ~30% - 50% of which ~10% - 20% is Eurasian Watermilfoil.
		32	N44°52.7729'	W088°08.9940'	
		33	N44°52.7892'	W088°09.0109'	
2	0' - 5'	34	N44°52.8133'	W088°09.0233'	Located from immediately on the west side of the swimming beach to where HWY 22 meets the lakeshore to the east. Mat extends from shore to ~20' out from shore. Mat is interspersed with other weeds. Total Mat density is ~30% - 50% of which ~10% - 20% is Eurasian Watermilfoil.
		35	N44°52.8286'	W088°09.0265'	
		36	N44°52.8437'	W088°09.0283'	
3	0' - 5'	180	N44°52.837'	W88°09.914'	Located on north shore ~550 yards upstream from the boat landing in the park on the south side of the impoundment in Oconto Falls. Mat is ~30' - 50' wide and runs parallel to shore in the 2' - 5' depth range. Mat is interspersed with other weeds. Total Mat density is ~30% - 60% of which ~50% - 75% is Eurasian Watermilfoil.
		181	N44°52.843'	W88°09.959'	
		49	N44°52.8465'	W088°09.9786'	
		50	N44°52.8541'	W088°10.0106'	
		51	N44°52.8613'	W088°10.0369'	
		52	N44°52.8675'	W088°10.0597'	
		53	N44°52.8805'	W088°10.0931'	
		54	N44°52.8952'	W088°10.1251'	
		55	N44°52.9184'	W088°10.1610'	
		56	N44°52.9358'	W088°10.1870'	
		182	N44°52.964'	W88°10.217'	
		183	N44°52.984'	W88°10.230'	
		184	N44°53.030'	W88°10.300'	
185	N44°53.094'	W88°10.386'			

Eurasian Watermilfoil Survey - Mat Descriptions

Project: Oconto Falls Upper #2523 **Datum:** WGS 84
Date: 8/25/2003 **Page:** 2 of 3
Crew: RAL & CTM

Mat #	Depth	GPS point	Latitude	Longitude	Comments
4	4' -5'	57	N44°53.0944'	W088°10.4541'	Located in center of river ~1400 yards upstream from the West Side Park boat landing on the south side of the impoundment in Oconto Falls. Mat is ~2050' x ~200' and is in the center of the river. Mat is interspersed with other weeds. Total Mat density is ~75% - 80% of which ~30% - 50% is Eurasian Watermilfoil.
		58	N44°53.1284'	W088°10.4607'	
		59	N44°53.1601'	W088°10.4738'	
		60	N44°53.2086'	W088°10.5103'	
		62	N44°53.1968'	W088°10.5389'	
		63	N44°53.1701'	W088°10.5475'	
		64	N44°53.1220'	W088°10.5007'	
		65	N44°53.1081'	W088°10.4868'	
		249	N44°53.233'	W88°10.533'	
		250	N44°53.256'	W88°10.555'	
		251	N44°53.277'	W88°10.585'	
5	0' - 5'	71	N44°52.756'	W088°09.898'	Located from ~50' downstream (east) of the boat landing at the West Side Park on the south side of the impoundment in Oconto Falls to ~1100' upstream (west) of the boat landing. Eurasian Watermilfoil mat is formed on the outside edge of an existing mat of submergent weed growth in the 3' - 6' depth range. Mat is interspersed with other weeds. Total Mat density is ~50% - 75% of which ~15% - 30% is Eurasian Watermilfoil. This mat was recorded on video tape in 2001.
		72	N44°52.743'	W088°09.859'	
		73	N44°52.735'	W088°09.810'	
		74	N44°52.720'	W088°09.750'	
		75	N44°52.715'	W088°09.702'	
		76	N44°52.723'	W088°09.673'	
		77	N44°52.728'	W088°09.643'	

Eurasian Watermilfoil Survey - Mat Descriptions

Project: Oconto Falls Upper #2523 Datum: WGS 84
 Date: 8/25/2003 Page: 3 of 3
 Crew: RAL & CTM

Mat #	Depth	GPS point	Latitude	Longitude	Comments
6	2' -5'	238	N44°52.761'	W88°09.256'	Located in east of the island in the impoundment ~600 yards east of the West Side Park boat landing on the south side of the impoundment in Oconto Falls. Mat is ~1050' x ~200' interspersed with other weeds. Total Mat density is ~50% - 75% of which ~30% - 50% is Eurasian Watermilfoil.
		239	N44°52.749'	W88°09.217'	
		240	N44°52.730	W88°09.185'	
		241	N44°52.698'	W88°09.167'	
		242	N44°52.699'	W88°09.189'	
		243	N44°52.701'	W88°09.205'	
		244	N44°52.684'	W88°09.222'	
		245	N44°52.670'	W88°09.205'	
		246	N44°52.645'	W88°09.178'	
		247	N44°52.613'	W88°09.137'	
7	0' - 5'	254	N44°53.042'	W88°10.468'	Located ~1250 yards upstream from the West Side Park boat landing on the south side of the impoundment in Oconto Falls. Mat is ~375' x ~40' and is interspersed with other weeds. Total Mat density is ~30% - 50% of which ~30% - 50% is Eurasian Watermilfoil.
		255	N44°53.007'	W88°10.425'	
		256	N44°52.996'	W88°10.411'	

LAKE SURVEY MAP

OCONTO FALLS
LAKE POND
OCONTO COUNTY
SEC. 22, 23, 26 T. 28 N. R. 19 E.

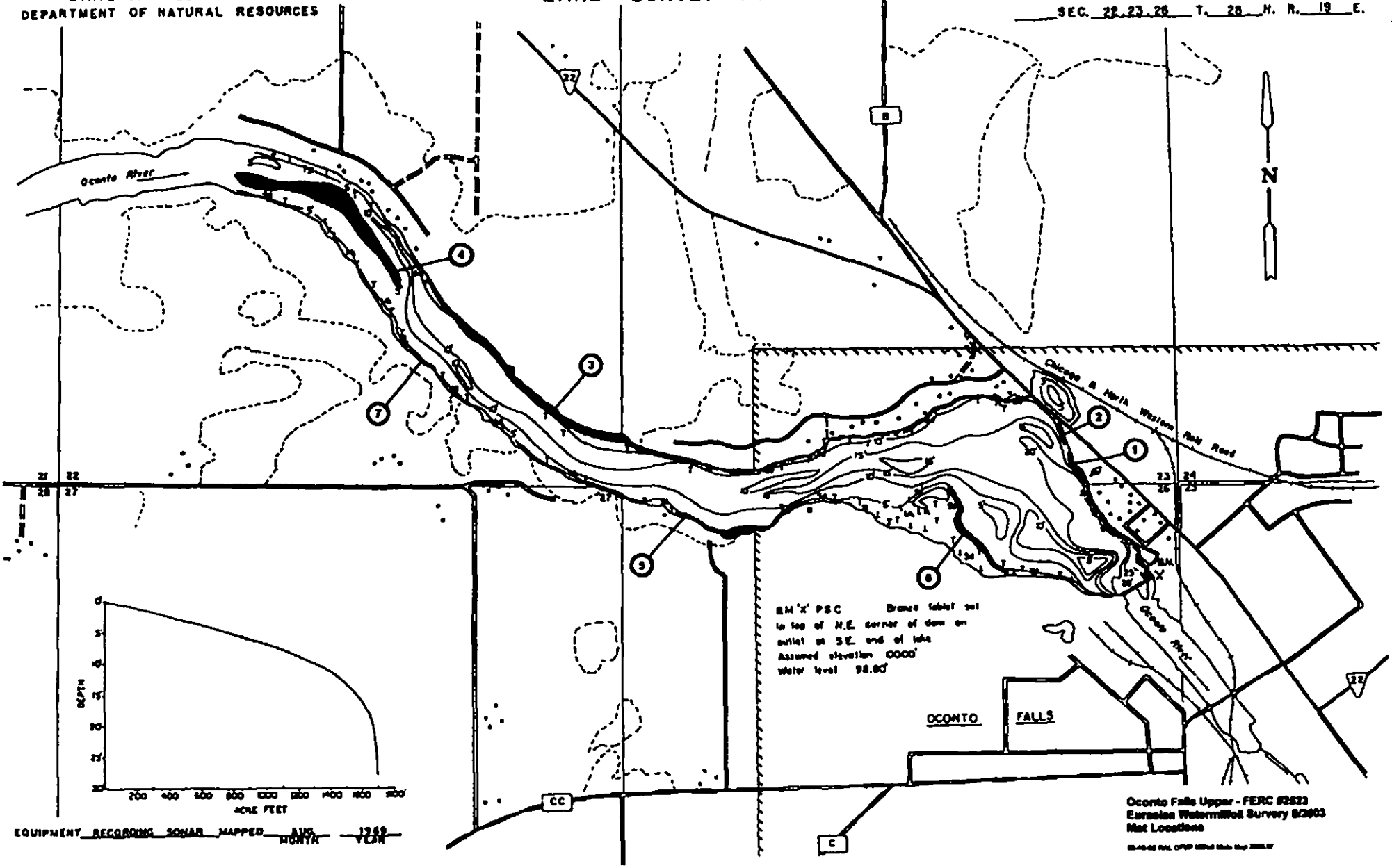

EQUIPMENT RECORDING SONAR MAPPED AUG 1989
MONTH YEAR

Oconto Falls Upper - FERC 82823
Eurasian Watermill/Well Survey 82803
Map Locations

04-05-03 Del. OGP 8804 10/04 10/04 10/04



North American Hydro Holdings, Inc. — Plant Operations:
118 State Street, P.O. Box 167, Nashboro, WI 54980 USA
Tel 920-293-4628 Fax 920-293-0057 Email nash@nahydro.com Web www.nahydro.com

Engineering & Manufacturing:
1283 B Sunset Avenue, Schofield, WI 54478 USA
Tel 715-826-0808 Fax 715-826-1048 Email ashfield@nahydro.com Web www.nahydro.com

March 22, 2004

Mr. Tom Meronek
Regional FERC Coordinator
Wisconsin Department of Natural Resources
P.O. Box 208, 101 Ogden Road
Peshtigo, WI 54157

Ms. Janet Smith
Field Supervisor
U.S. Fish and Wildlife Service
2661 Scott Tower Drive
New Franken, WI 54229

**Re: Oconto Falls (Upper) Project, No. 2523, N.E.W. Hydro, Inc.
Article 407, Purple Loosestrife & Eurasian Watermilfoil Inventory**

Dear Mr. Meronek and Ms. Smith:

Attached is a copy of the N.E.W. Hydro, Inc. "Purple Loosestrife & Eurasian Watermilfoil Inventory" for 2003. This annual report has been prepared to comply with Article 407 of the project's federal hydropower license.

We invite you to review and comment, but we respectfully request that any written response be provided to us within thirty (30) days from the date of this letter.

Please contact me at 920-293-4628 ext. 18 if you wish to discuss this or have any questions. Your cooperation is appreciated.

Sincerely,
NORTH AMERICAN HYDRO, Inc.

Rick Loeffler
Compliance Assistant

Attachment