

ORIGINAL



North American Hydro Holdings, Inc. — Plant Operations:  
116 State Street, P.O. Box 187, Nashboro, WI 54980 USA  
Tel 920-399-4888 Fax 920-299-9087 Email nah@nahydro.com Web www.nahydro.com  
  
Engineering & Manufacturing:  
1325 S Everest Avenue, Schaffeld, WI 84478 USA  
Tel 715-388-0808 Fax 715-388-1048 Email schaffeld@nahydro.com Web www.nahydro.com

February 15, 2005

The Secretary  
Federal Energy Regulatory Commission  
888 First Street, NE  
Washington, DC 20426

FILED  
OFFICE OF THE  
SECRETARY  
2005 FEB 22 P 2:31  
FEDERAL ENERGY  
REGULATORY COMMISSION

Re: *Flambeau Upper, Project No. 2640, Flambeau Hydro LLC*  
*Article 412, Purple Loosetrife Inventory*

Dear Secretary:

Please find enclosed an original and 8 copies of the Flambeau Upper, Project No. 2640 Purple Loosetrife Inventory for 2004. On December 23, 2004, copies of the inventory were sent to the Wisconsin Department of Natural Resources (WIDNR) and the US Fish & Wildlife Service (USFWS) for comment. No comments were received from the WIDNR or the USFWS.

If you have any questions regarding this submission, please contact Mr. Richard Loeffler at 920-293-4628 ext. 18.

Sincerely,  
NORTH AMERICAN HYDRO, INC.

*Richard Loeffler*  
FOR Charles Alsberg  
Executive Vice President

Cc: FERC - CRO  
Encl.: 1 original & 8 copies

05-02-15 RAL FLUP 2004 loosetrife survey to FERC.doc

## **Flambeau Upper Project Purple Loosestrife Inventory**

**August 18 & 19, 2004**

**FERC Project #2640 Article 412**

**Flambeau Hydro, L.L.C.**

**116 State St.**

**Neshkoro, WI 54960**

### *Purple Loosestrife*

On August 18 & 19, 2004, Flambeau Hydro, L.L.C. (FHLLC) performed an inventory of purple loosestrife plants at the Flambeau Upper Project in Price County, Wisconsin. The method of inventory as approved and modified by Federal Energy Regulatory Commission (FERC) Order of June 18, 2003 was defined as follows:

While Purple Loosestrife is blooming in mid July to early August, the inventory should be conducted using a boat to survey the impoundment above the dam within the Project Boundary and on foot or by boat below the dam within the Project Boundary. County wetland maps may be used to determine other areas where Purple Loosestrife could be found on lands owned by FHLLC within the Project Boundary. Lands owned by FHLLC within the Project Boundary will be surveyed on foot. A pair of binoculars should be used to search for the purple flowered spikes of the plant. When plants are located, the person(s) inventorying should get close enough to make a positive identification without disturbing the plants or the immediate area around the plants as this could cause them to spread. A GPS receiver will be used to establish a GPS coordinate for the location of the plants. If it is not possible to get close enough to establish an accurate location, an approximate location will be established with reference to an established GPS coordinate. The plants should be inventoried by marking and numbering the location on a Project map along with notes approximating size of plants, stand area, percent cover, stem density, plant density, and location with reference to established GPS coordinates. Photos and/or videotape will be taken of the largest occurrences.

#### **Example:**

#1 6' tall plants; 4' X 20'; 30% cover; 4 – 5 stems per plant; 4 plants; on shoreline N45° 56.183' W90° 26.748'; no photo

#2 5' - 7' tall plants; 10' X 10'; 25% cover; 4 – 5 stems per plant; 10 plants; in marsh ~50 feet bearing 25° from N45° 56.256' W90° 26.710'; photo No. 1

The area to be inventoried shall be the shoreline of the impoundment to elevation 1487.4 feet NGVD and lands owned by FHLLC within the Project

Boundary as indicated on the Project Maps 1 & 2, dated November 1991, included in Exhibit G of Flambeau Paper Corp. Application For A Subsequent License for the Upper Hydroelectric Project FERC Project #2640.

#### General Observations:

The Flambeau Upper Project Boundary was divided into three different areas; *the impoundment* (from just downstream of the last rapids before the impoundment to the dam), *the power canal/bypassed reach* (the power canal from the dam to the powerhouse, and the bypassed reach area from the dam to the single lane service bridge just upstream of the HWY 182 bridge), and *the tailrace* (from the single lane service bridge just upstream of the HWY 182 bridge to the HWY 182 bridge).

*The tailrace* was surveyed by boat and no purple loosestrife plants were observed.

*The power canal/bypassed reach* was surveyed on foot and no purple loosestrife plants were observed.

*The impoundment* was surveyed by boat. One suspected occurrence of purple loosestrife plants was observed in this area and is noted on the lake map and survey comments at the end of this report. In 2002, the landowner was sent an informational brochure published by the WDNR and was encouraged to contact the WDNR for identification and control procedures. During the 2003 inventory, specimens from these plants were taken to the Wisconsin Department of Natural Resource Service Center in Wautoma, Wisconsin for identification. Analysis revealed that the plants are winged loosestrife (*Lythrum alatum*) and not purple loosestrife (*Lythrum salicaria*). In 2004, the owner removed these plants. No purple loosestrife plants were observed in the impoundment.

During the inventory, an 8mm camcorder was used to document new occurrences of purple loosestrife as noted in the survey comments at the end of this report.



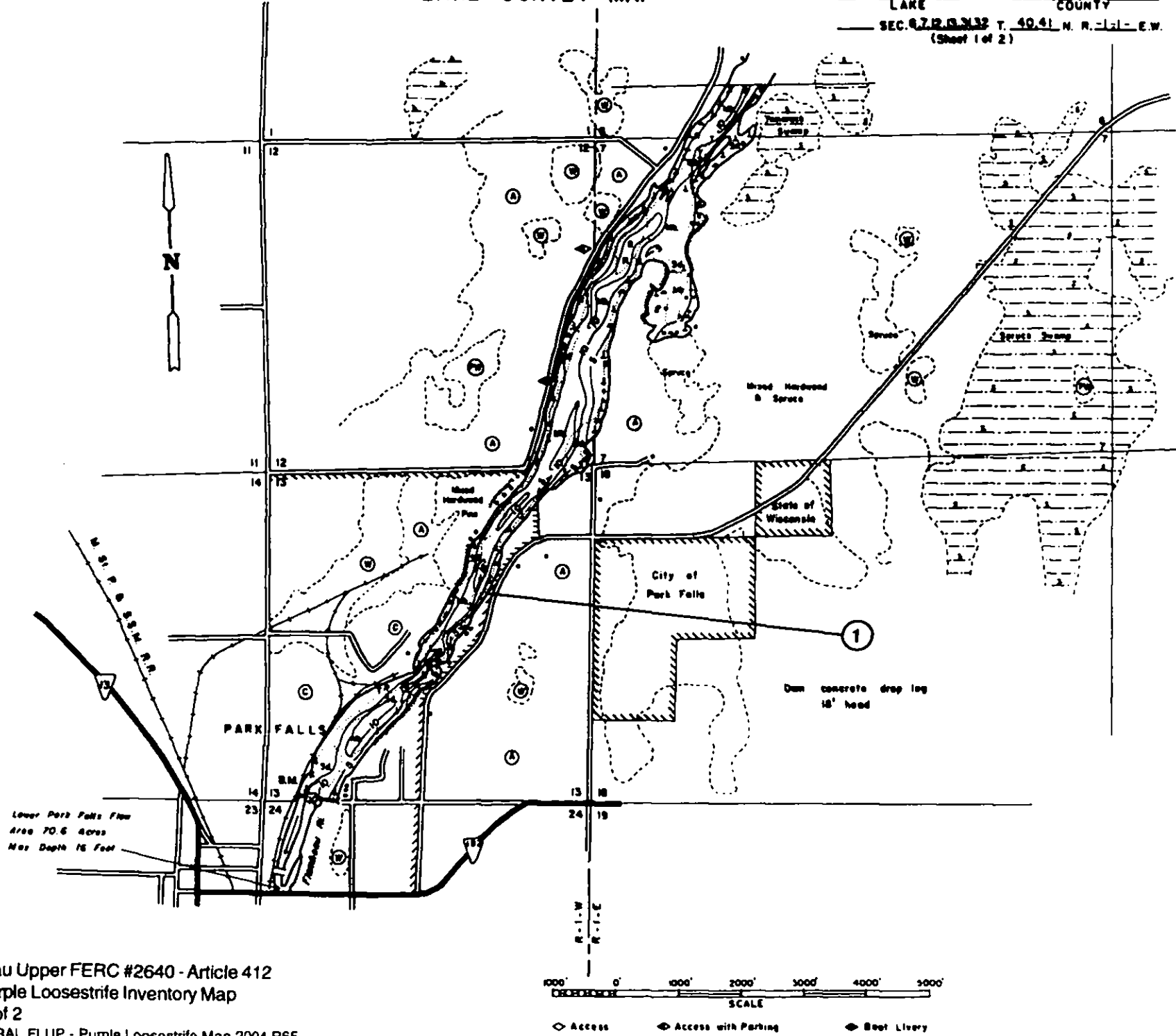

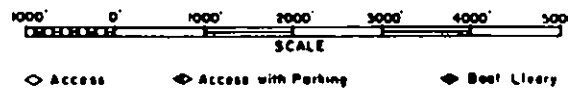
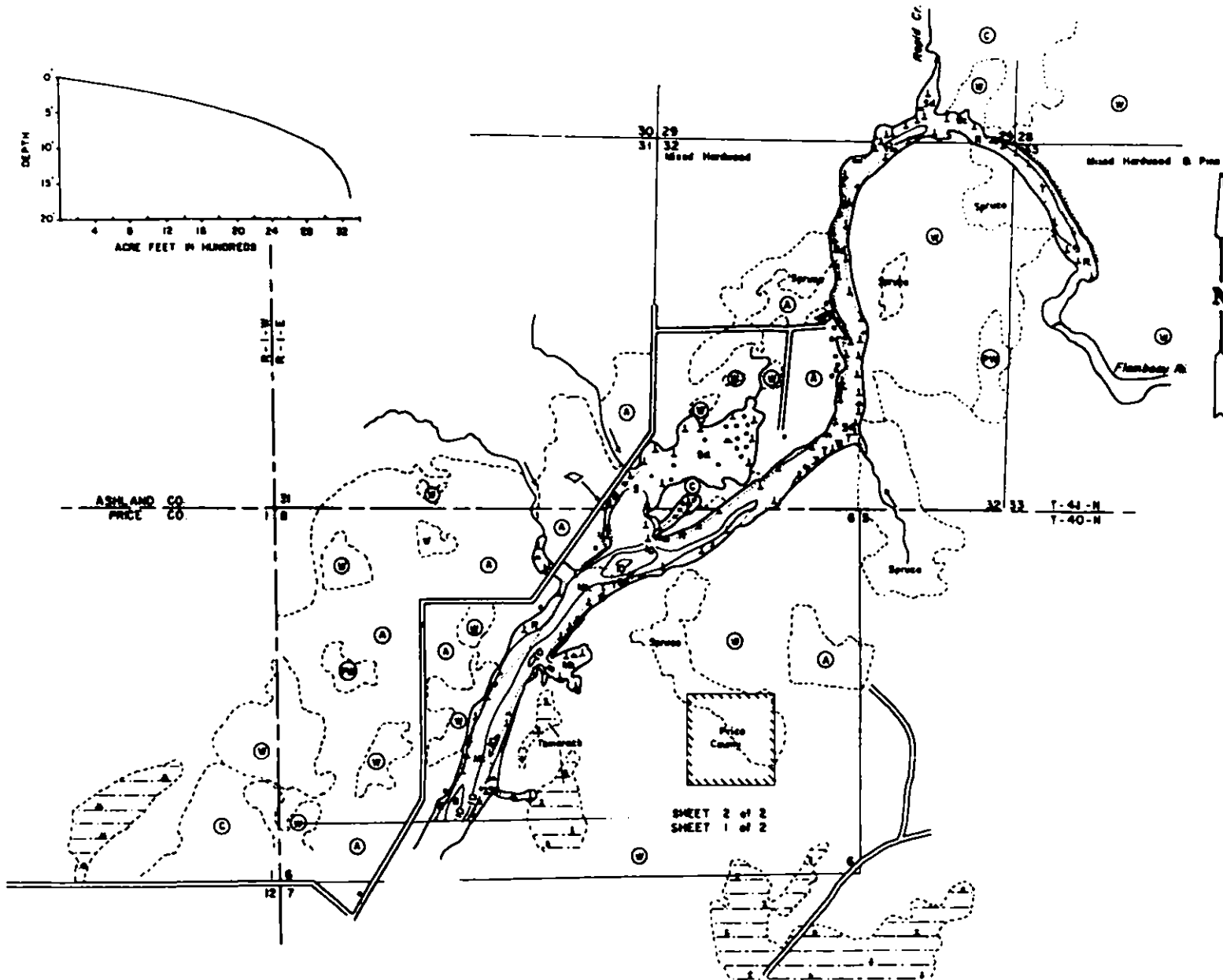

◇ Access    ◇ Access with Parking    ◇ Boat Livery



North American Hydro Holdings, Inc. — Plant Operations:  
116 State Street, P.O. Box 167, Nashviro, WI 54960 USA  
Tel 920-293-4628 Fax 920-293-8087 Email nash@nahydro.com Web www.nahydro.com  
  
Engineering & Manufacturing:  
1328 B Everest Avenue, Schofield, WI 54476 USA  
Tel 715-358-0208 Fax 715-358-1049 Email achoffeld@nahydro.com Web www.nahydro.com

December 23, 2004

Mr. Jeffrey Scheirer  
Northern Region FERC Manager  
Wisconsin Department of Natural Resources  
875 South 4<sup>th</sup> Avenue  
Park Falls, WI 54552

Ms. Janet Smith  
Fish & Wildlife Biologist  
U.S. Fish and Wildlife Service  
266 I Scott Tower Drive  
New Franken, WI 54229

**Re: Flambeau Upper Project, No. 2640, Flambeau Hydro, L.L.C.  
Article 412, Purple Loosetrife Inventory**

Dear Mr. Scheirer and Ms. Smith:

Attached is a copy of our "Purple Loosetrife Inventory" for 2004. This annual report has been prepared to comply with Article 412 of the project's federal hydropower license.

We invite you to review and comment, but we respectfully request that any written response be provided to us within thirty (30) days from the date of this letter.

Please contact me at 920-293-4628 extension 18 if you wish discussion or have any questions. Your cooperation is appreciated.

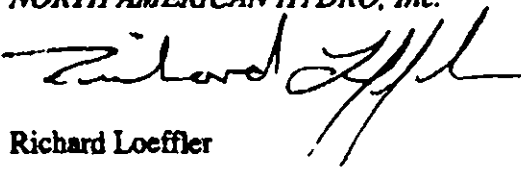
Sincerely,  
NORTH AMERICAN HYDRO, Inc.  
  
Richard Loeffler

Attachment