

## CORRESPONDENCE/MEMORANDUM

Date: August 23, 1979

File Ref: 3600

To: District Director - Green Bay

From: [REDACTED] L.S.M.

Subject: Boom Shocker Survey - Shioc River, Outagamie County - July, 1978

The Shioc River flows from Shawano County through north central Outagamie County (19 miles) entering the Wolf River at Shiocton. Portions of the Shioc in Outagamie County were surveyed by boomshocker on July 11 and 12, 1978.

Public access is limited to seven road crossings with no improved boat landings. Recreational craft are restricted to a carry-in type.

With the aid of a 4-wheel drive vehicle and permission of the private landowners, it was possible to launch the shocker at two locations. The width (40 feet) and depth (2-6 feet) of the Shioc River were adequate to support the boomshocker. The only limiting factor were groups of fallen trees, as the most of the shoreline was lined by swamp hardwoods.

The lower reaches of the Shioc River receive occasional spring runs of walleye and white bass. However, little has been reported on the resident fish populations.

Results of the July shocker survey indicate a marginal warmwater fishery, consisting of an occasional northern pike or bullhead. (Refer to length-frequency sheet).

A lack of gamefish in the lower Shioc River is probably due to poor summer water supply combined with the sluggish flow resulting from the low gradient (6 foot drop over the lower 10 miles). Much of the watershed has been cleared for cropland (cash crops, dairy farms, etc.). Apparently, any precipitation received by the watershed is quickly released to the stream resulting in extreme fluctuation in the water level which has been reported in the Water Resources Booklet of Outagamie County. During periods of low precipitation, stream flow reaches critically low levels putting stress on resident fish.

At the present time, there are no feasible management recommendations (habitat improvement, stocking, etc.) for this section of the Shioc River. The only fishery of significance is that provided by the occasional spring runs of gamefish from the Wolf River.

Future changes of the land use practices in the watershed may result in a more stable stream flow improving the conditions for resident fish populations. Any improvements in the Shioc River would also have a positive impact on the lower Wolf River.

LSM:aep

10/10/10



# Shiok River OUTAGAMIE COUNTY

T. 24 N.

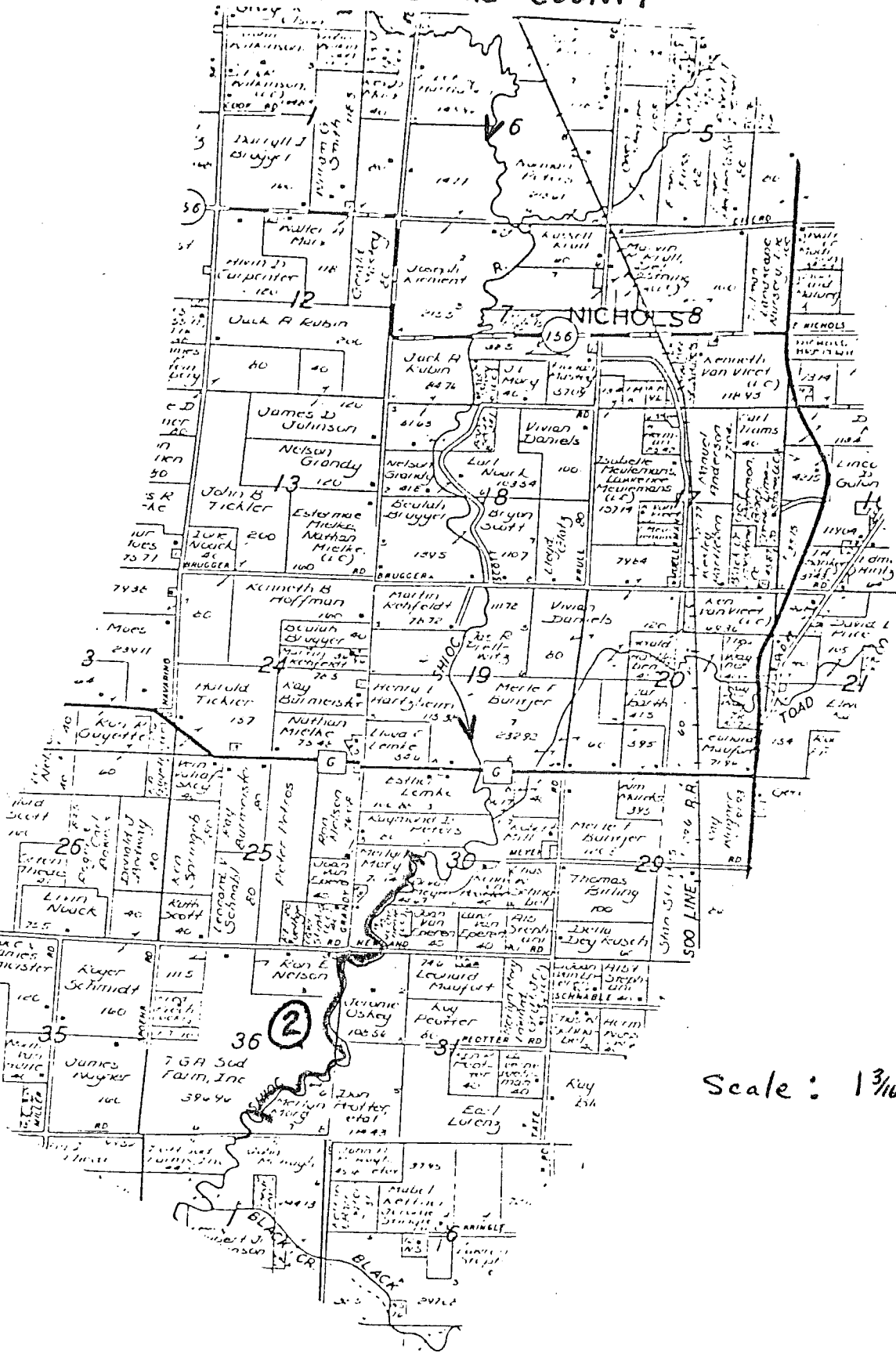

Scale:  $1\frac{3}{16}'' = 1 \text{ mile}$

T. 23 N.

R. 16 E.    1    R. 17 E.

NAME FISH LENGTH FREQUENCY  
FORM 3600-65

DEPARTMENT OF NATURAL RESOURCES

Station #2

Location: Newland Road

UNTY Outagamie	WATERS Shioc River	DATE July 12, 1978	GEAR Boomshocker AC,
-------------------	-----------------------	-----------------------	-------------------------

Size Range	SPECIES				Size Range	SPECIES
	Northern pike	Black bullhead	White sucker	Golden shiner		
0- 3.4		1		1	27.0-27.4	Station Low
5- 3.9		6		1	27.5-27.9	2 mile
0- 4.4		3		1	28.0-28.4	Water Cole
5- 4.9		1			28.5-28.9	
0- 5.4		1			29.0-29.4	Dark Bru
5- 5.9					29.5-29.9	
0- 6.4					30.0-30.4	
5- 6.9					30.5-30.9	Bank Veget
0- 7.4		1			31.0-31.4	
5- 7.9					31.5-31.9	Sawamp H
0- 8.4		1	1		32.0-32.4	1 Pe
5- 8.9					32.5-32.9	
0- 9.4					33.0-33.4	
5- 9.9			1		33.5-33.9	
0-10.4					34.0-34.4	
5-10.9					34.5-34.9	
0-11.4					35.0-35.4	
5-11.9					35.5-35.9	
0-12.4					36.0-36.4	
5-12.9	1				36.5-36.9	
0-13.4					37.0-37.4	
5-13.9					37.5-37.9	
0-14.4					38.0-38.4	
5-14.9					38.5-38.9	
0-15.4					39.0-39.4	
5-15.9					39.5-39.9	
0-16.4					40.0-40.4	
5-16.9					40.5-40.9	
0-17.4					41.0-41.4	
5-17.9					41.5-41.9	
0-18.4					42.0-42.4	
5-18.9					42.5-42.9	
0-19.4					43.0-43.4	
5-19.9					43.5-43.9	
0-20.4					44.0-44.4	
5-20.9					44.5-44.9	
0-21.4					45.0-45.4	
5-21.9					45.5-45.9	
0-22.4					46.0-46.4	
5-22.9					46.5-46.9	
0-23.4					47.0-47.4	
5-23.9					47.5-47.9	
0-24.4					48.0-48.4	
5-24.9					48.5-48.9	
0-25.4					49.0-49.4	
5-25.9					49.5-49.9	
0-26.4						
5-26.9						
Total	1	14	2	3		

observed young-of-year fish - 4 to 1/2" long

GAME FISH LENGTH FREQUENCY  
FORM 3600-65

DEPARTMENT OF NATURAL RESOURCES

Station #1

COUNTY	WATERS	DATE	GEAR	
Outagamie	Shioc River (Hwy. 'P')	July 11, 1978	Boomshocker AC	
Size Range	SPECIES		Size Range	SPECIES
3.0- 3.4	Carp	Bluegill	Station Length: 2 miles	27.0-27.4
3.5- 3.9			Water Color:	27.5-27.9
4.0- 4.4			Stain Dark Br.	28.0-28.4
4.5- 4.9			Stream width:	28.5-28.9
5.0- 5.4			50-100 feet	29.0-29.4
5.5- 5.9		1 (Dead)	Stream Depth:	29.5-29.9
6.0- 6.4			3-8 feet	30.0-30.4
6.5- 6.9			(~2' above norm)	30.5-30.9
7.0- 7.4			Bank Vegetation:	31.0-31.4
7.5- 7.9			Savamp Hardwood	31.5-31.9
8.0- 8.4			Observations:	32.0-32.4
8.5- 8.9			Stream flow so slow, it was impossible to determine which direction water was running.	32.5-32.9
9.0- 9.4				33.0-33.4
9.5- 9.9				33.5-33.9
10.0-10.4				34.0-34.4
10.5-10.9				34.5-34.9
11.0-11.4				35.0-35.4
11.5-11.9				35.5-35.9
12.0-12.4				36.0-36.4
12.5-12.9				36.5-36.9
13.0-13.4				37.0-37.4
13.5-13.9				37.5-37.9
14.0-14.4				38.0-38.4
14.5-14.9				38.5-38.9
15.0-15.4				39.0-39.4
15.5-15.9				39.5-39.9
16.0-16.4				40.0-40.4
16.5-16.9				40.5-40.9
17.0-17.4				41.0-41.4
17.5-17.9				41.5-41.9
18.0-18.4				42.0-42.4
18.5-18.9				42.5-42.9
19.0-19.4				43.0-43.4
19.5-19.9				43.5-43.9
20.0-20.4				44.0-44.4
20.5-20.9				44.5-44.9
21.0-21.4				45.0-45.4
21.5-21.9				45.5-45.9
22.0-22.4				46.0-46.4
22.5-22.9				46.5-46.9
23.0-23.4				47.0-47.4
23.5-23.9				47.5-47.9
24.0-24.4				48.0-48.4
24.5-24.9				48.5-48.9
25.0-25.4				49.0-49.4
25.5-25.9				49.5-49.9
26.0-26.4				
26.5-26.9				
Total	1			

Observed school of fry (1/4"), probably carp.