

Domtar
Nekoosa Mill
301 Point Basse Avenue
Nekoosa, WI 54457-1422
Tel.: (715) 886-7111



FILED
SECRETARY OF THE
COMMISSION

2012 SEP -4 P 1: 28

FEDERAL ENERGY
REGULATORY COMMISSION

August 29, 2012

Ms. Louise Clemency
U.S. Fish & Wildlife Service
Green Bay Field Office
2661 Scott Tower Drive
New Franken, WI 54229

Ms. Cheryl Laatsch, FERC Coordinator
Wisconsin Department of Natural Resources
N7725 Highway 28
Horicon, WI 53032

ORIGINAL

Dear Ms. Clemency and Ms. Laatsch:

Subject: Domtar Wisconsin Dam Corp.
FERC Projects 2255, 2291 and 2292
Centralia, Port Edwards, and Nekoosa Projects
Purple Loosestrife Monitoring Report for 2012

Attached is a report for purple loosestrife monitoring as required by Article 408 for projects 2255 and 2291, and by Article 407 for project 2292. A single report for the three projects has been prepared.

The survey was performed substantially as described in the plan submitted to the FERC Secretary on January 13, 1997, and as approved by FERC on July 16, 1997. The 2012 survey was performed during August as described in the report.

If there are any questions, please feel free to contact me at (715) 886-7711.

Sincerely,

David S. Ulrich, Superintendent
Environmental Services

DSU:kd

cc: Mr. John A. Zygaj, P.E. Regional Engineer, Federal Energy Regulatory Commission,
Chicago Regional Office, 230 South Dearborn Street, Chicago, IL 60604

✓ Secretary, Federal Energy Regulatory Commission, 888 First Street, N.E.,
Mail Code DHAC, PJ-12.3, Washington, D.C. 20426

**PURPLE LOOSESTRIFE MONITORING SURVEY FOR 2012
DOMTAR WISCONSIN DAM CORP.
301 Point Basse Avenue
Nekoosa, Wisconsin 54457**

**By
Dan Cummins
Cummins Environmental, LLC**

**FERC Projects
Centralia Dam – No. 2252
Port Edwards Dam – No. 2291
Nekoosa Dam – No. 2292**

BACKGROUND

During August 2012, Cummins Environmental, LLC, conducted the annual purple loosestrife survey of project lands. Observations were made from the shoreline along the Wisconsin River throughout Domtar's FERC permitted property.

Surveys have been conducted annually since 1997. As part of this report, purple loosestrife observed in 2012 will be compared to that observed in 2011.

DESCRIPTION OF THE PURPLE LOOSESTRIFE POPULATIONS IN 2012

Figure 1a

The project area represented on this figure saw an increase in the number of purple loosestrife. The overall distribution of the loosestrife has also increased with plants appearing on both banks and on most of the islands and rocky outcrops. Between the Jackson and Grand Avenue bridges the purple loosestrife along the shoreline have flourished. Further downstream toward Belle Island there are significant accumulations of plants on rocky outcrops. Downstream of the Riverview Expressway bridge purple loosestrife continue to appear along the west shoreline.

Figure 1b

In the vicinity of the city parks along the west bank purple loosestrife continue to appear, but in slightly smaller numbers. At Boles Creek however, there is a large accumulation of plants along the west bank just downstream of the creek mouth. Purple loosestrife continue to appear on the rocky outcrops immediately upstream of the Centralia Dam. At and immediately below the Centralia Dam there has been an increase in the number and distribution of purple loosestrife.

Figure 1c

The power line easement for the Centralia Dam continues to be free of purple loosestrife.

Figure 2a

The Port Edwards portion of the survey area has also seen an increase in the number and distribution of purple loosestrife. The increase of purple loosestrife is significant at the Port Edwards Dam. This increase is especially notable on the upstream rock and wood structures. The purple loosestrife at the Port Edwards dam are generally small and have not developed into the large clumps of large plants seen elsewhere. Purple loosestrife have increased in number and affected area downstream of the dam and along the western boundary of the reservoir for the powerhouse.

Figure 3a

This segment of project property has seen a decrease in the number of purple loosestrife with the exception of the areas adjacent to Highway 73 upstream of Moccasin Creek. At this location, the area is heavily vegetated from Highway 73 to the shoreline. However, the loosestrife appear throughout the area in large numbers. Also of note is a 20+ loosestrife accumulation on the downstream tip of an island opposite where Harvey Creek enters the Wisconsin River.

Figure 3b

Purple loosestrife have increased slightly in this river segment. Downstream of the Nekoosa Dam and near the downstream boundary of project lands, the purple loosestrife have spread across a larger area than previously seen.

CONCLUSIONS

The purple loosestrife population has increased throughout the three project areas. In general the loosestrife have also been distributed over a wider area. There is no readily apparent explanation for the increase in numbers or distribution of the loosestrife. In late 2010 and early 2011 there were record flooding events on the Wisconsin River. In late 2011 and so far in 2012, central Wisconsin has experienced near record low precipitation. The lack of seasonal flooding or possibly the lack of water elevation changes due to rain events could be playing a role in the increase and distribution of the loosestrife.

Dan Cummins
Cummins Environmental, LLC
1451 Rounds Round
Wisconsin Rapids, Wisconsin 54494
715-423-8930

AUTOCAD
 RELEASE 10.0
 PLOT SCALE: 1"=400'
 HY. LINC. NO. 13752-CUUU-59041

20120904-0013 FERC (Unofficial)

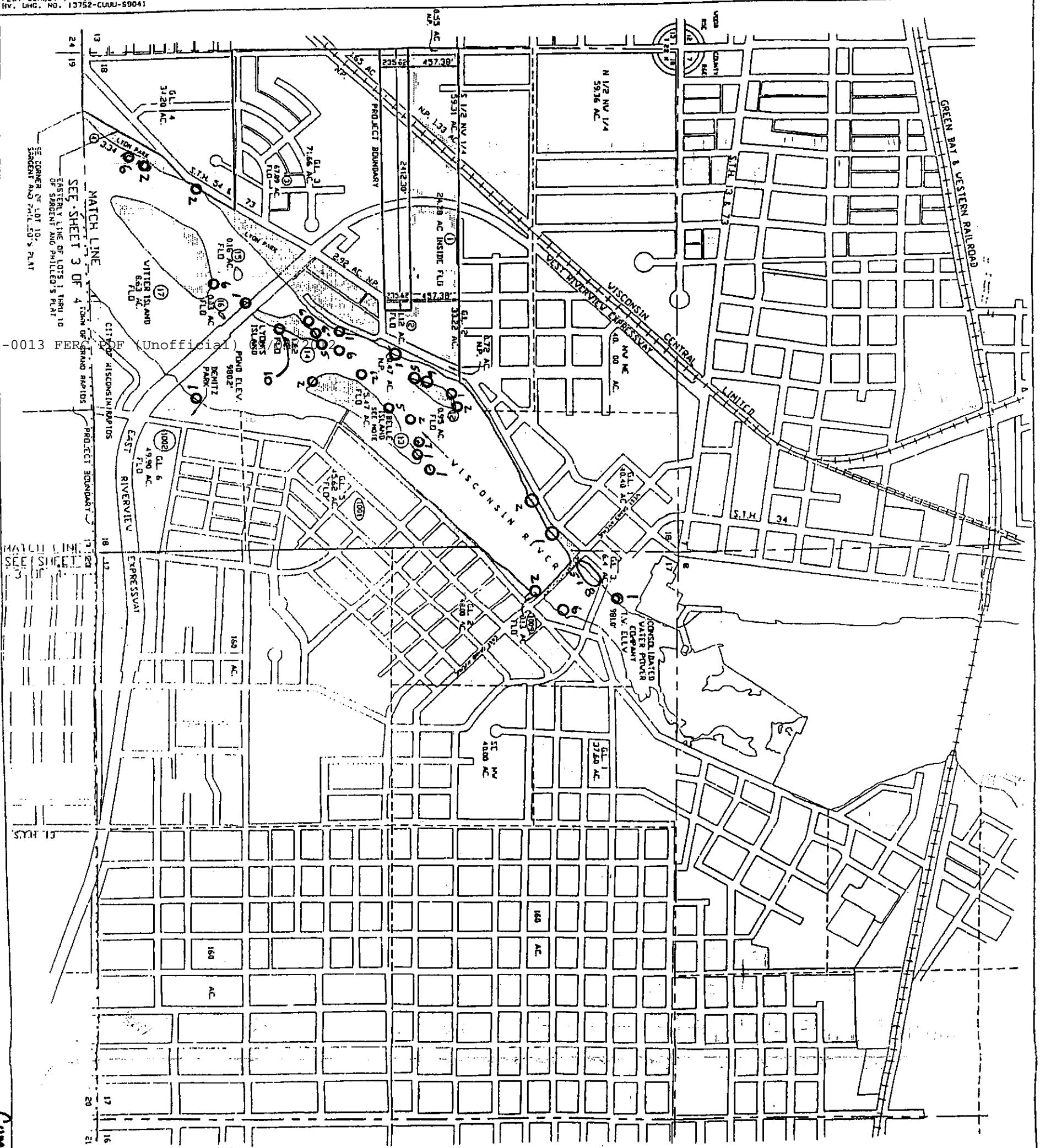

CUMMINS ENVIRONMENTAL, LLC

NEKOOSA PAPERS INC.
 PORT EDWARDS, WISCONSIN
 CENTRAL IA HYDROELECTRIC PROJECT
 EXHIBIT 3
 PROJECT MAP

100' 200' 400' 800'
 1"=400'

AUGUST 24, 1990 FERC LICENSE NO. 22551 SHEET G-2

2012 PURPLE LOOSESTRIFE SURVEY

NOTE: VITTER ISLAND IS CLAIMED BY THE UNITED STATES AND ADMINISTERED BY THE BUREAU OF LAND MANAGEMENT. THIS CLAIM IS SHOWN.

THIS DRAWING IS A PART OF THE APPLICATION FOR LICENSE MADE BY THE UNDERSIGNED THIS 13TH DAY OF AUGUST 1991.

FLOWAGE RIGHTS
 PARCEL NO.

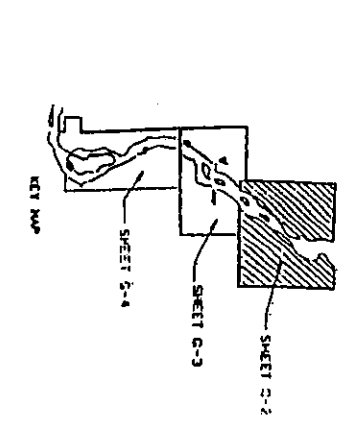

VARIATION 3°16' EAST
 OCTOBER 12, 1933

COUNTY: MOOD
 STATE: WISCONSIN

Figure 1a

8/2012
 DOC

AUTOCAD
RELEASE 10.0
PLOT SCALE: 1"=400'
BY: DHD, NO. 13752-CUUU-59042

NOTE 11:
COMMENCING AT THE NORTHEAST CORNER OF SECTION 24, T22N, R2E,
THENCE SOUTH ALONG THE EAST SIDE OF SECTION 24 TO THE
INTERSECTION WITH THE NORTH-SOUTH LINE OF THE
MICHIGAN STATE TRUNK HIGHWAY 54 AND TO POINT A.

20120904-0013 FERC PDF (Unofficial) 09/04/2012

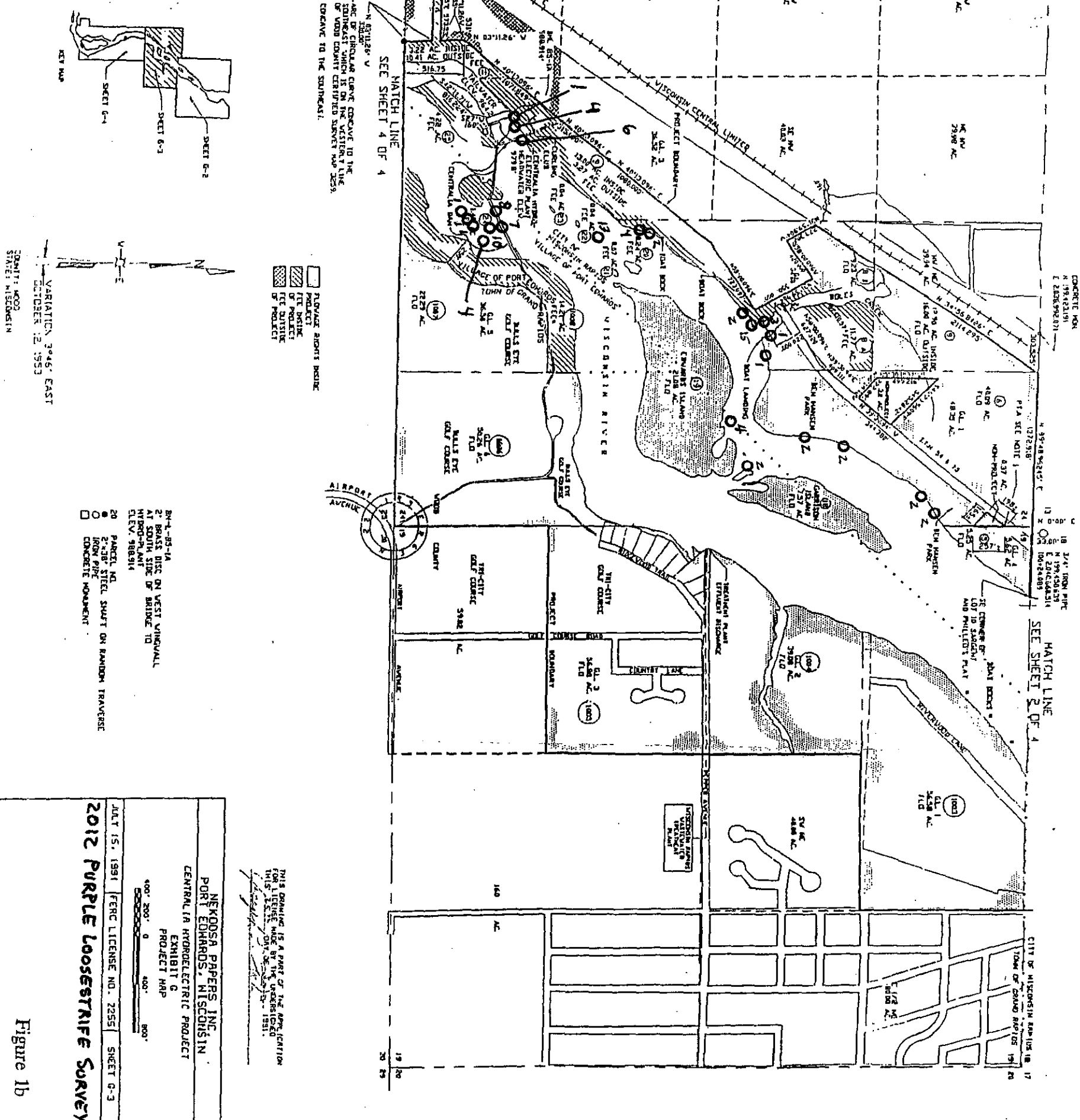

COMMUNIS ENVIRONMENTAL, LLC
8/2012
DHC

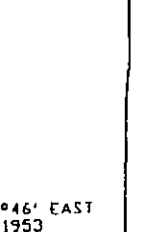
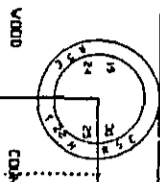

AUTOCAD
RELEASE 10.0
PLOT SCALE: 1"=400'
BY: DMC. NO. 13752-CUUU-58043

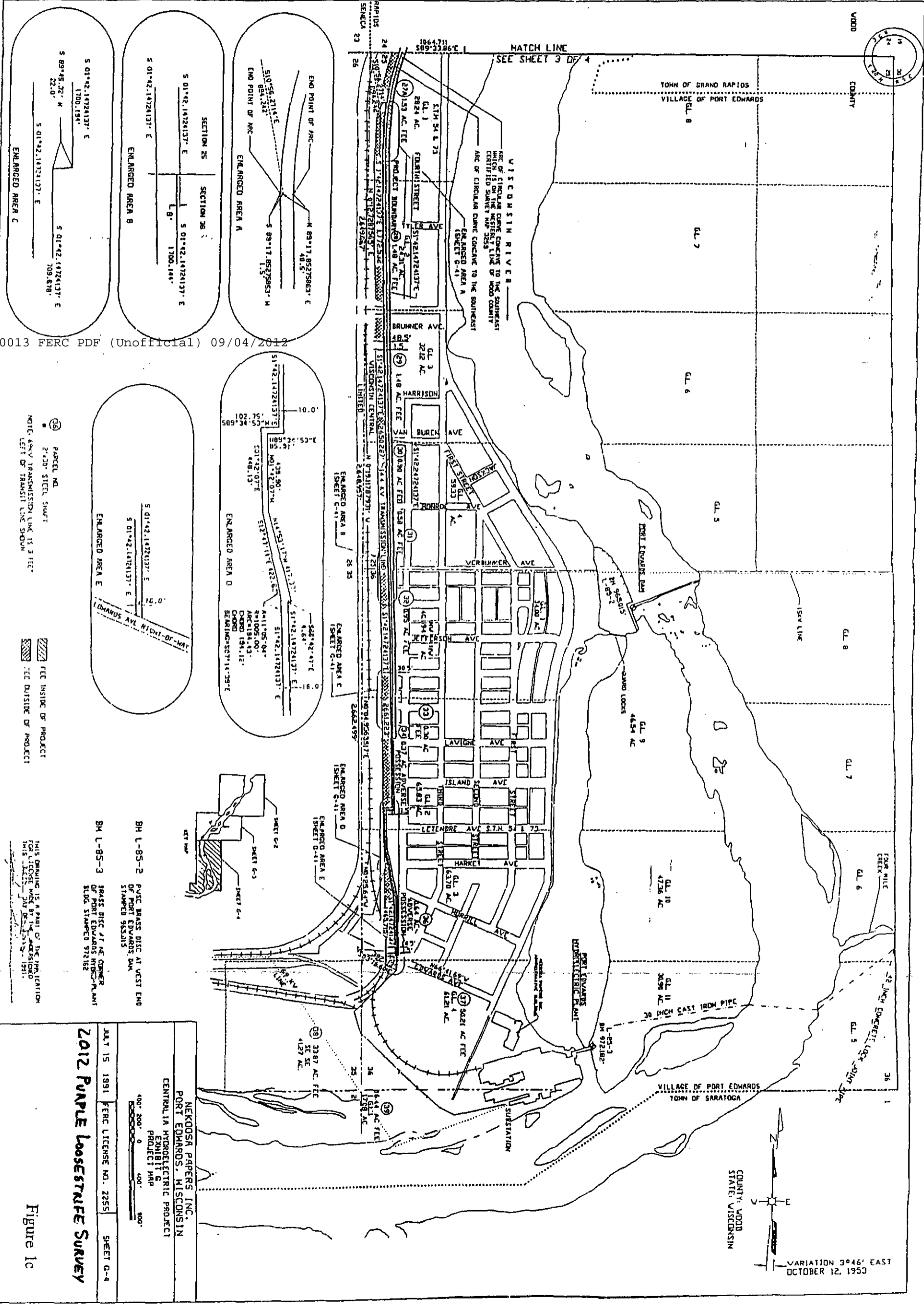

20120904-0013 FERC PDF (Unofficial) 09/04/2012

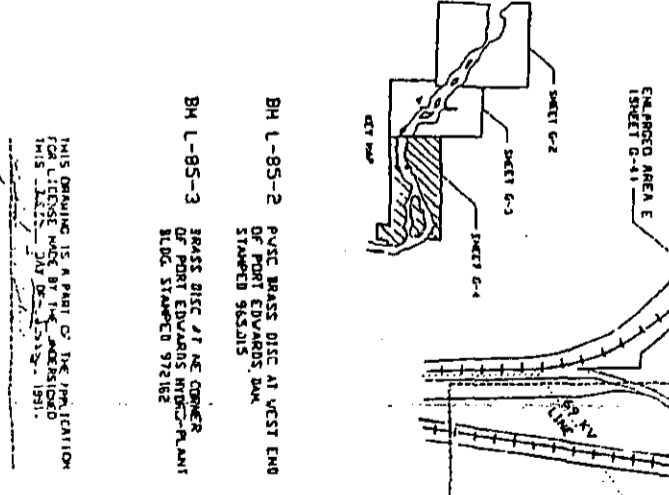
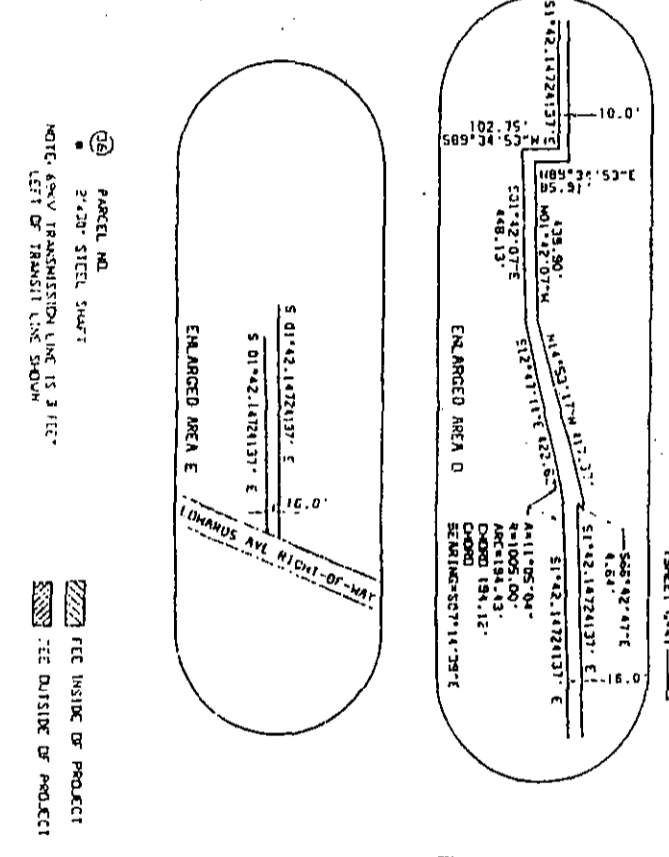
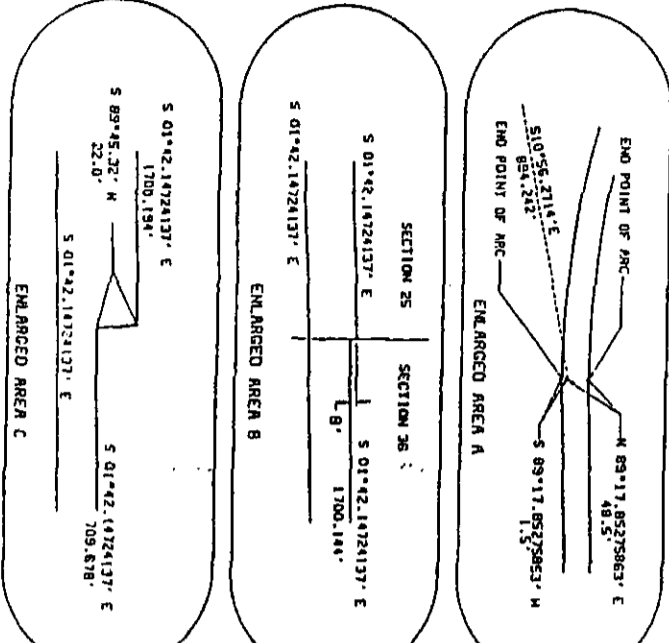

CUMMINS ENVIRONMENTAL, LLC
8/2012
Doc

AUTOCAD
RELEASE 10.0
PLOT SCALE: 1"=400'
BY: DHG. NO. 13752-CUUU-SB045

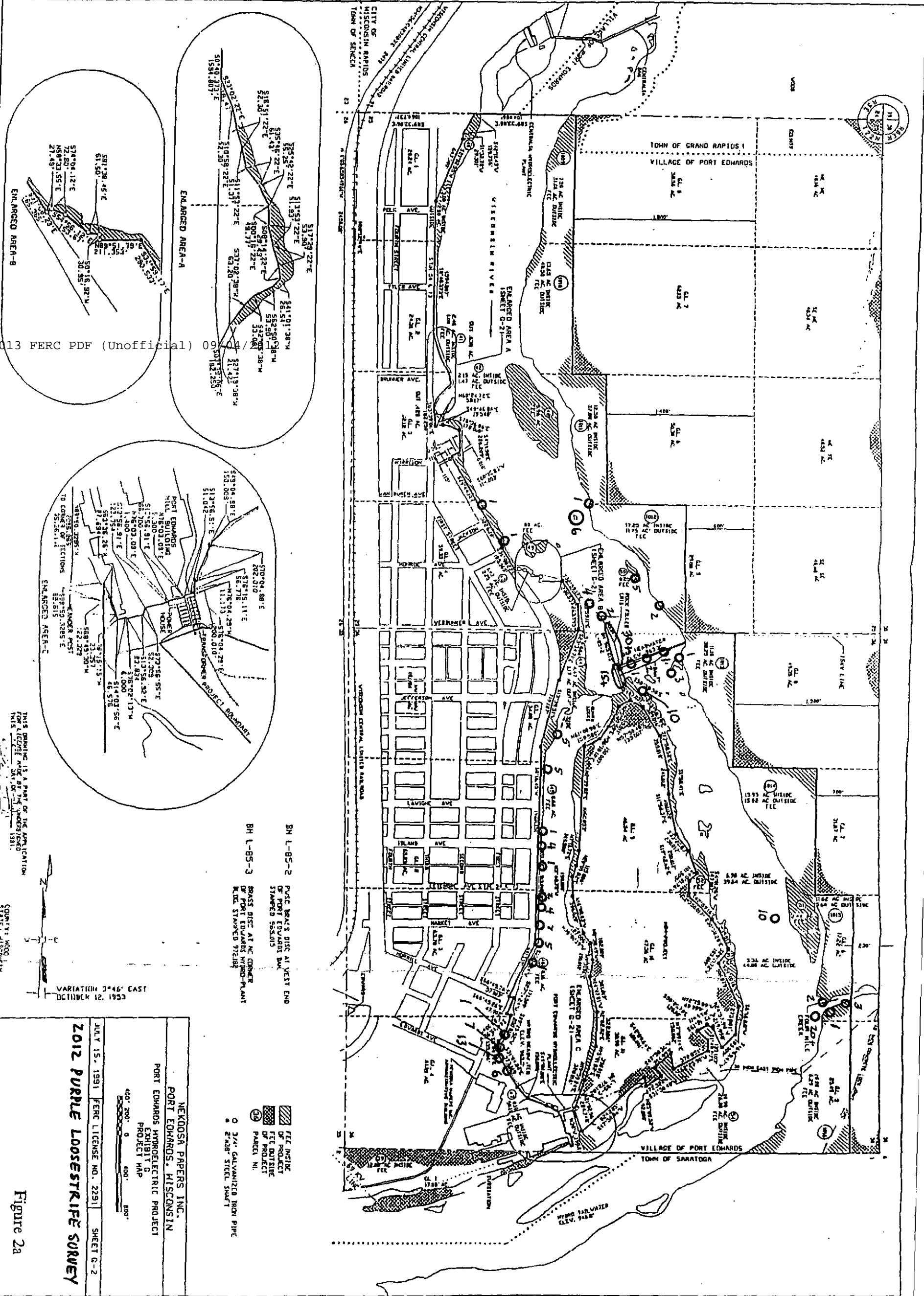

20120904-0013 FERC PDF (Unofficial) 09

CUMMINS ENVIRONMENTAL LLC

8/2012

DBZ

20120904-0013 FERC PDF (Unofficial) 09/04/2012

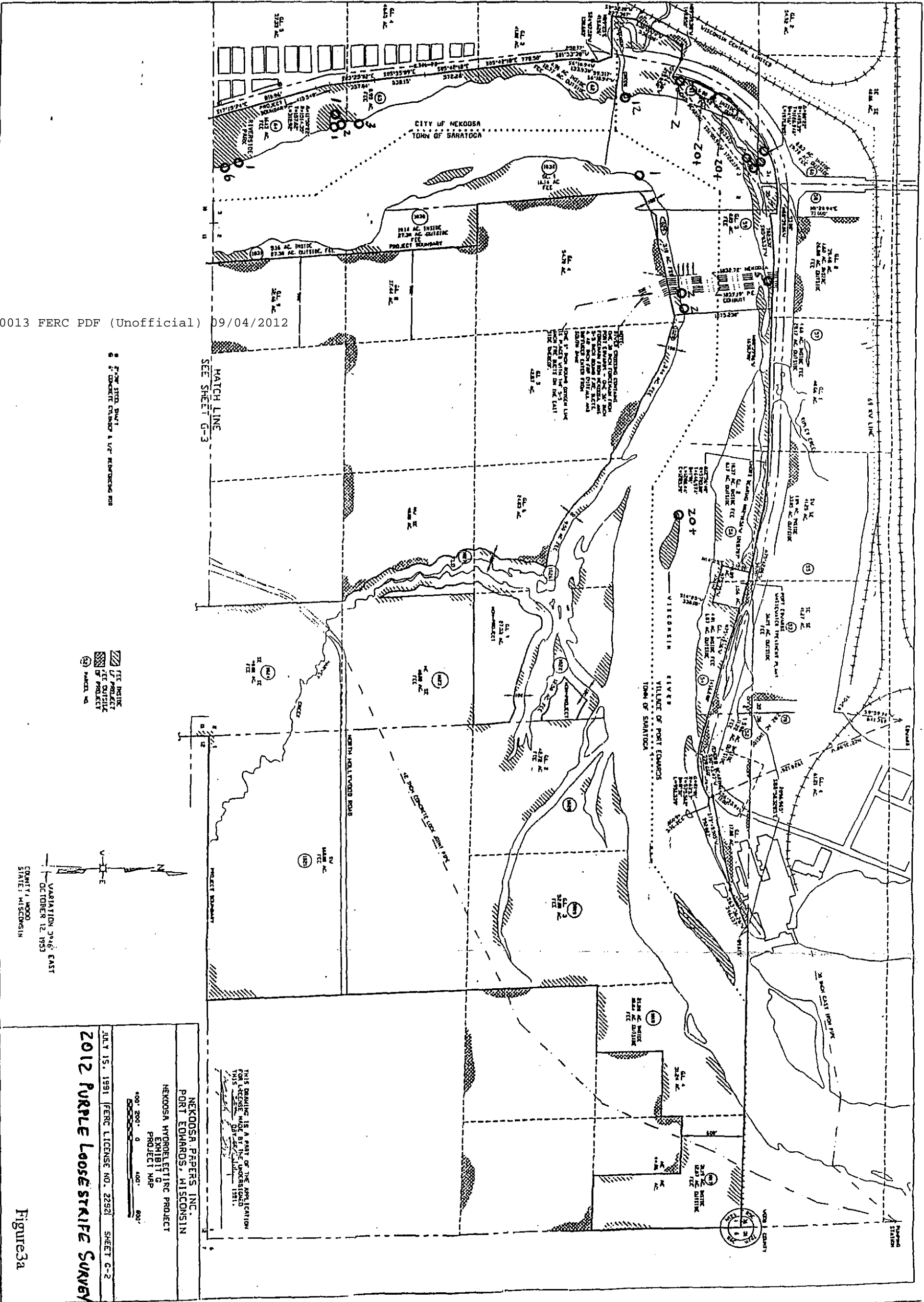

8" X 11" GRID, 20' BY 20'
 8" X 11" GRID, 20' BY 20'
 8" X 11" GRID, 20' BY 20'

100 AC INSIDE
 100 AC INSIDE
 100 AC INSIDE

VARIATION 394.6 EAST
 OCTOBER 12, 1953
 COUNTY, WOOD
 STATE, WISCONSIN

NEKOOSA PAPERS INC.
 PORT EDWARDS, WISCONSIN
 NEKOOSA HYDROELECTRIC PROJECT
 EXHIBIT D
 PROJECT MAP
 JULY 15, 1991 FERC LICENSE NO. 2292 SHEET G-2
 2012 PURPLE LOOSE STRIFE SURVEY

CUMMINS ENVIRONMENTAL, LLC

Figure 3a

8/2012 Doc

AUTOCAD
 RELEASE 10.0
 PLOT SCALE: 1"=400'
 BY: DMC, NO. 13752-CUUV-59048

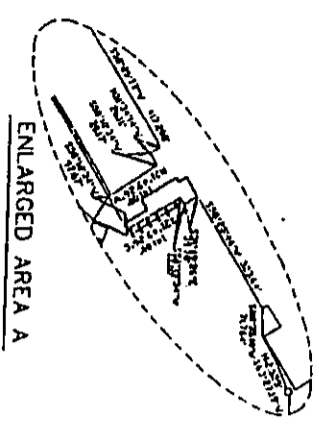

20120904-0013 FERC PDF (Unofficial) 09/04/2012

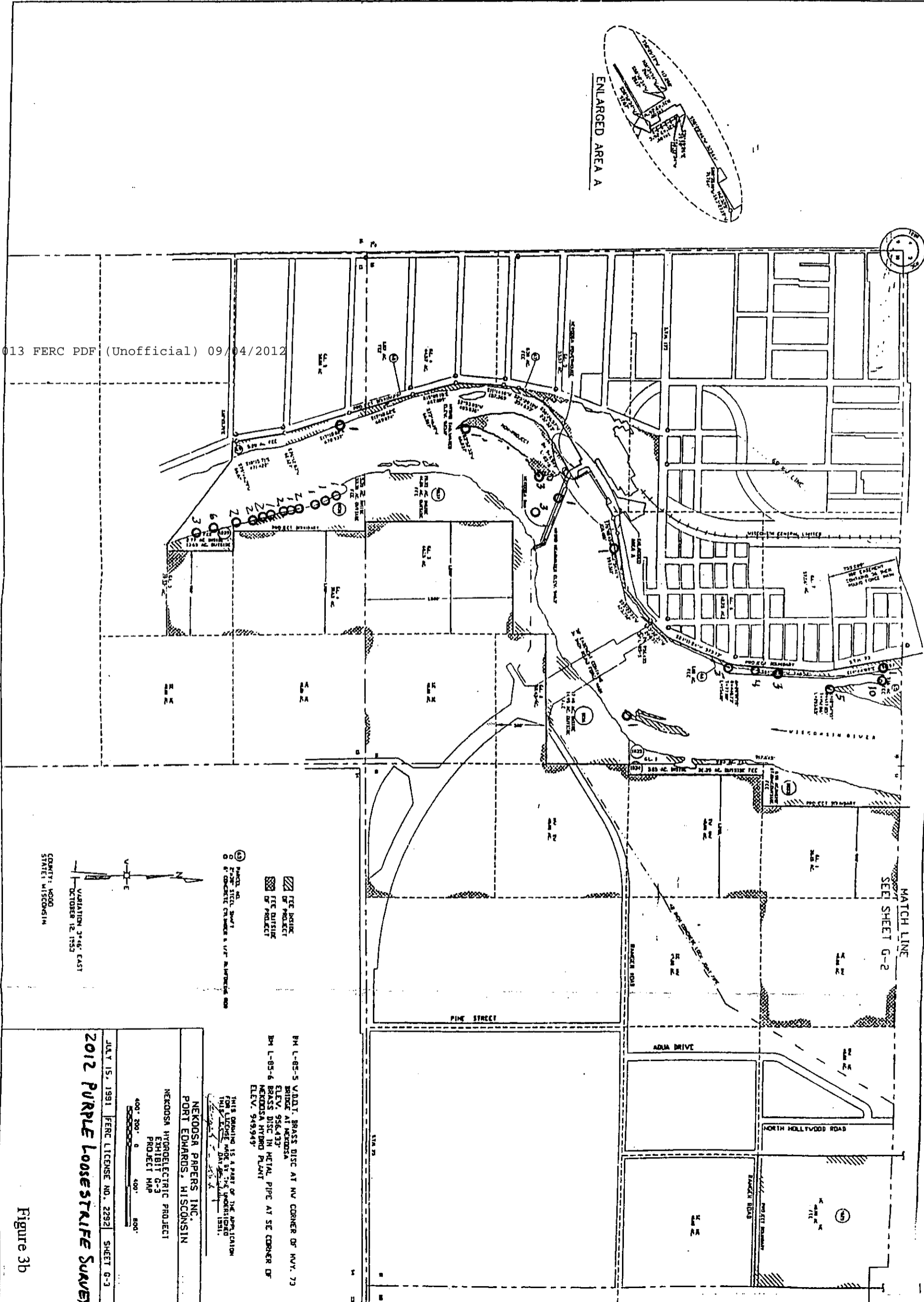

(3) PAPER AND
 0" 2" SCALE STICK SURVEY
 0" 4" CONCRETE CORNER & V.P. SURVEYED 2008

[Hatched pattern] FIC BOUNDARY
 [Dashed line] FIC EASEMENT
 [Solid line] FIC PROJECT

COUNTY: WOOD
 STATE: WISCONSIN
 VARIATION 29'46" EAST
 OCTOBER 12, 1952

JULY 15, 1991 FERC LICENSE NO. 2292 SHEET G-3
2012 PURPLE LOOSESTRIKE SURVEY

NEKODSA PAPERS, INC.
 PORT EDWARDS, WISCONSIN
 NEKODSA HYDROELECTRIC PROJECT
 EXHIBIT G-3
 PROJECT MAP
 400' 200' 0 400' 800'

BM L-85-5 VADDT BRASS DISC AT NW CORNER OF HWY. 73
 ELEV. 926.437
 BM L-85-6 BRASS DISC IN METAL PIPE AT SE CORNER OF
 NEKODSA HYDRO PLANT
 ELEV. 945.949

THIS DRAWING IS A PART OF THE APPLICATION
 FOR LICENSE MADE BY THE UNDERSIGNED
 ON DATE 07/15/91

Figure 3b

CUMMINS ENVIRONMENTAL, LLC
 8/2012
 DOC

Document Content(s)

13058332.tif.....1-9