

LAKE SURVEY MAP

WILD RICE LAKE
VILAS COUNTY
SEC. 1,6,31 T. 41 N. R. 5,6 E.

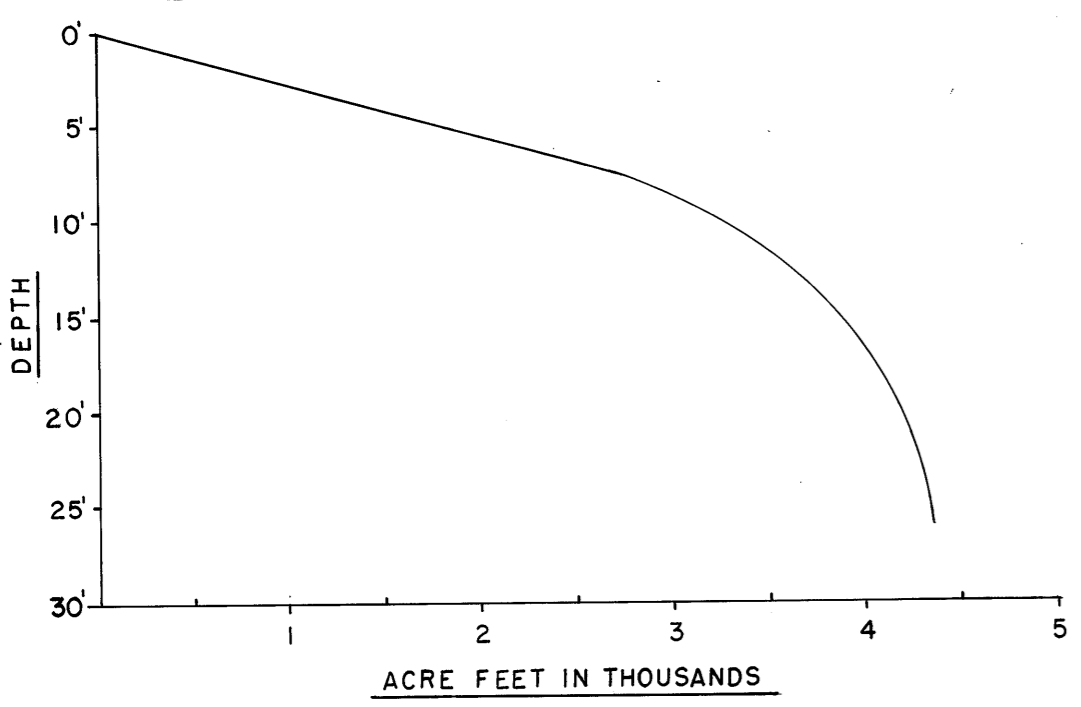
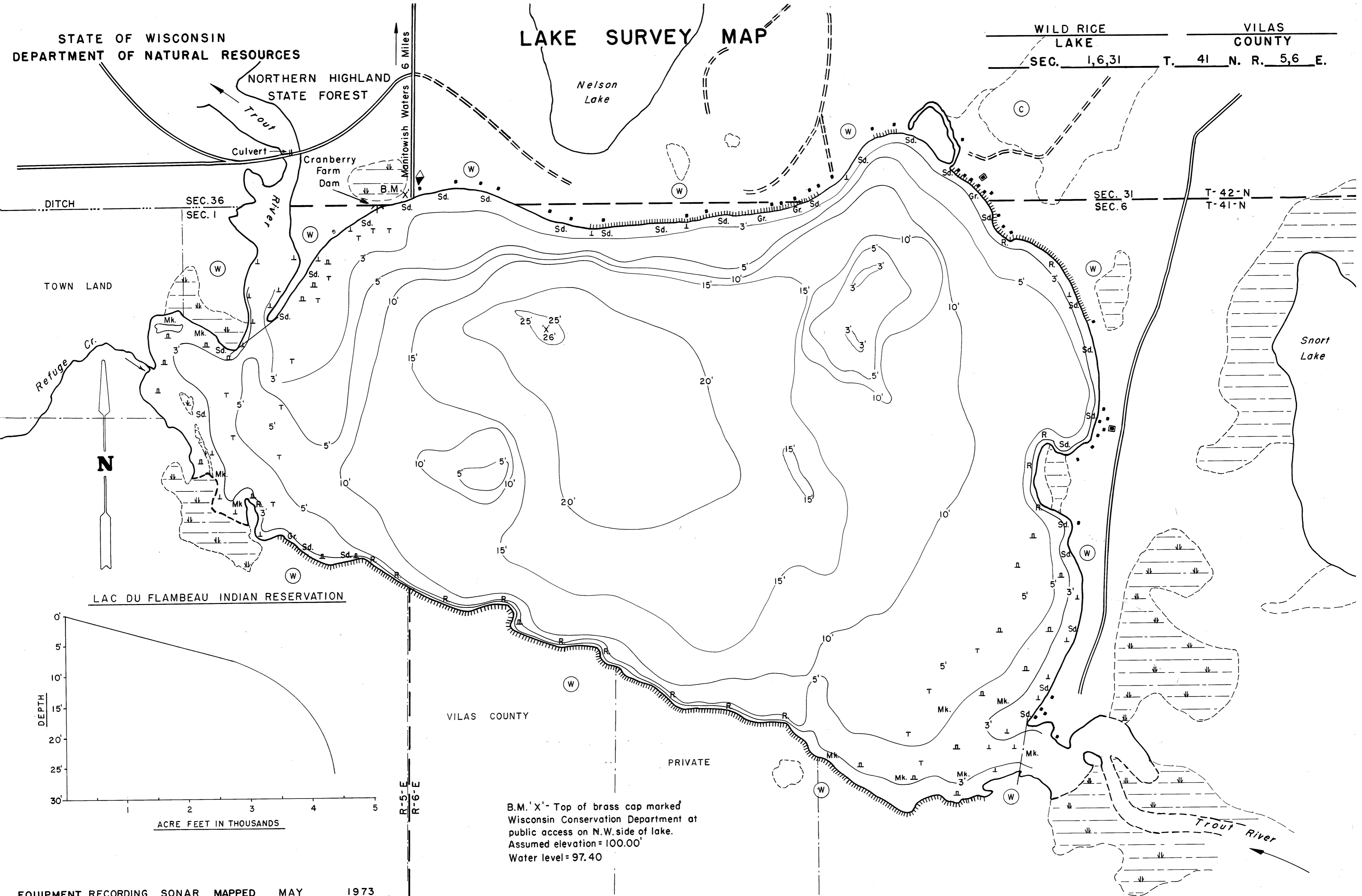

B.M. 'X' - Top of brass cap marked Wisconsin Conservation Department at public access on N.W. side of lake. Assumed elevation = 100.00' Water level = 97.40

EQUIPMENT RECORDING SONAR MAPPED MAY 1973

- | TOPOGRAPHIC SYMBOLS | | LAKE BOTTOM SYMBOLS | |
|-----------------------|---------------------------|---------------------|-----------------------------|
| (B) Brush | Steep slope | P. Peat | B Boulders |
| (PW) Partially wooded | ~ Indefinite shoreline | Mk. Muck | o Stumps & Snags |
| (W) Wooded | ~ Marsh | C. Clay | ⊙ Rock danger to navigation |
| (C) Cleared | ~ Spring | M. Marl | T Submergent vegetation |
| (P) Pastured | ~ Intermittent stream | Sd. Sand | ⊥ Emergent vegetation |
| (A) Agricultural | ~ Permanent inlet | St. Silt | ⊎ Floating vegetation |
| B.M. Bench Mark | ~ Permanent outlet | Gr. Gravel | ⊕ Brush shelters |
| ■ Dwelling | ~ Dam | R. Rubble | |
| □ Resort | ~ D.N.R. State owned land | Br. Bedrock | |
| ⊠ Camp | | | |

SPECIES OF FISH	Abundance		
	Abundant	Common	Present
Muskie		X	
N. Pike	X	X	
Walleye	X	X	
L. M. Bass			X
S. M. Bass			X
Panfish	X		
Trout			

WATER AREA 379.15 ACRES
 UNDER 3 FT. 9.99 %
 OVER 20 FT. 9.93 %
 MAX. DEPTH 26 FEET.
 TOTAL ALK. 37 P.P.M.
 VOLUME 4328.71 ACRE FT.
 MAIN SHORELINE 3.71 MI.
 ISLAND SHORELINE 0 MI.



◆ Access ◆ Access with Parking ◆ Boat Livery
 Drawn by: G. Thuesen
 Field work by: J. Smith

Source: Wisconsin Department of Natural Resources 608-266-2621
Wild Rice Lake – Vilas County, Wisconsin DNR Lake Map
Date – May 1973 - Historical Lake Map - Not for Navigation
A Public Document - Please Identify the Source when using it.