

Exhibit A

WISCONSIN DEPARTMENT OF NATURAL RESOURCES
Northern Highland-American Legion State Forest

Bid Prospectus

Herbicide/Mechanical Site-Prep - 2018

186 Acres

<u>SITE</u>	<u>FOREST</u>	<u>CMP/ST</u>	<u>DESCRIPTION</u>	<u>ACRES</u>	<u>CHEMICAL</u>
1. Gravel Pit Salvage	ALSF	21/22	T39N-R7E, Sec 36	5	A,C,O
2. Horse Trail Pine	ALSF	11/12	T39N-R8E, Sec 1	21	A,C,O
3. Jenny Barns	ALSF	87/7	T38N-R8E, Sec 13 T38N-R9E, Sec 18	36	A,C,O
4. Clear Lake Island	NHSF	235/10	T42N-R5E, Sec 1	10	A,C,O
5. Marsh Road	NHSF	152/10	T42N-R7E, Sec 20	12	A,O*
6. Johnson Lake	NHSF	59/17	T42N-R8E, Sec 8	13	A,C,O
7. High Lake	NHSF	90/12	T43N-R7E, Sec 36	44	A,C,O
8. Siphon Creek	NHSF	26/26	T42N-R8E, Sec 9	24	A,G,O
9. Rudolph Road	NHSF	142/8	T40N-R7E, Sec 31	15	A,O
10. Shore Drive**	NHSF	205/14	T42N-R6E, Sec 8,17	6	A,G,O

Total Acreage: 186

Chemical symbols and rates of application

EPA Reg. #

A - Accord XRT II (2 quarts/acre)	62719-556
G - Garlon XRT (1.27 quarts or 40 ounces/acre)	62719-553
O - Oust (1 ounce/acre)	352-601
C - Chopper (18 ounce/acre)	241-296

***The application rate for Accord on this site will be increased to 3 quarts per acre.**

****This site will receive herbicide only - NO trenching required.**

STATE OF WISCONSIN

DEPARTMENT OF NATURAL RESOURCES

NORTHERN HIGHLAND-AMERICAN LEGION STATE FOREST

Project: Herbicide/Mechanical Site Prep

Dates: June - November 2018

Compartment: 21 - A





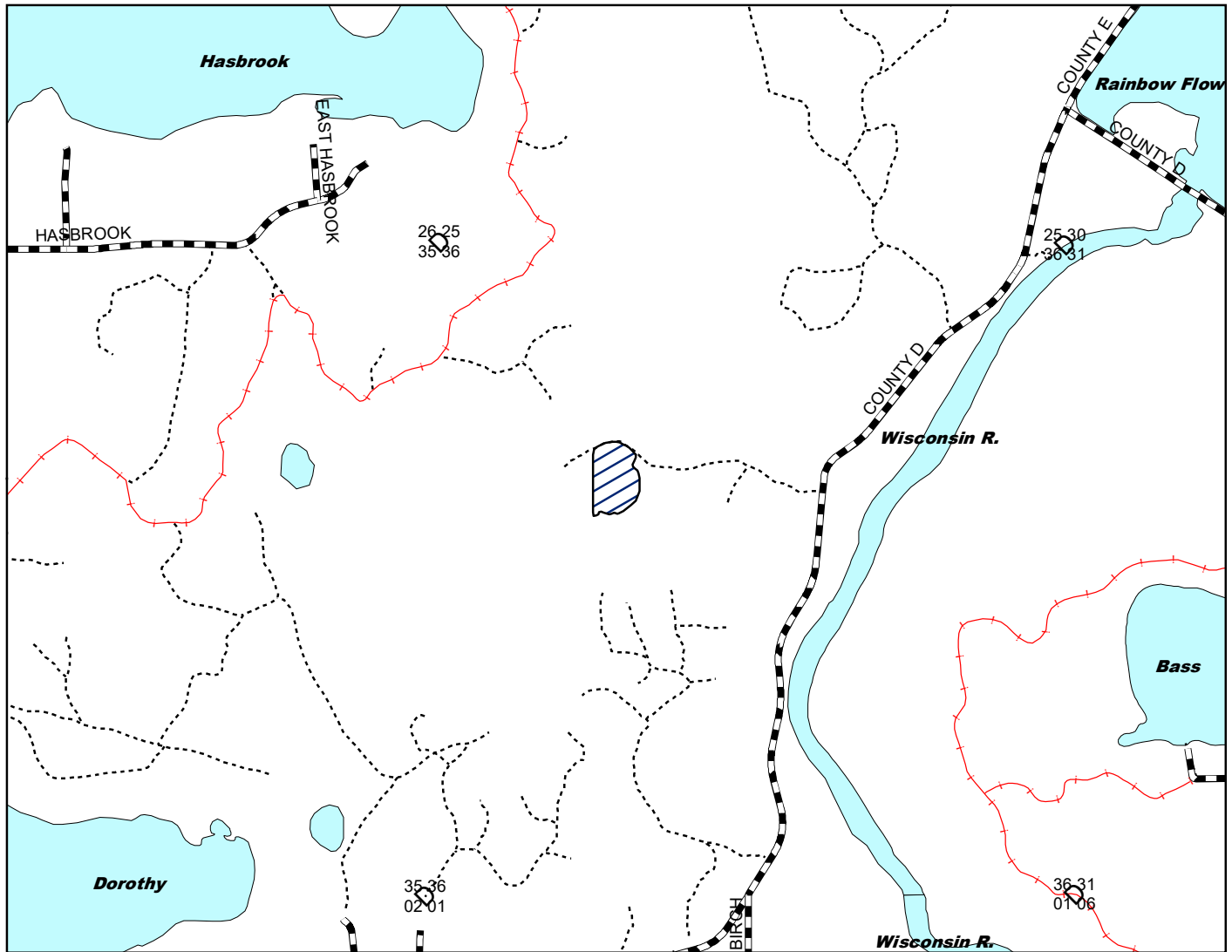

Location: T39N-R7E, Section 36

Site: Gravel Pit Salvage - Accord, Chopper, Oust



Acres: 5



Legend

-  Section Corner
-  Snowmobile Trails
-  Oneida County Roads
-  Woods Roads
-  Gravel Pit Salvage Site
-  Lakes

Woodruff Service Center Annex
8770 Highway J
Woodruff, WI 54568

 Scale: 4" = 1 Mile
 1:15,840

 Map produced by
 Paul Schultz, 4/18

STATE OF WISCONSIN

DEPARTMENT OF NATURAL RESOURCES

NORTHERN HIGHLAND-AMERICAN LEGION STATE FOREST

Project: Herbicide/Mechanical Site Prep

Dates: June - November 2018

Compartment: 11 - A

Location: T39N-R8E, Section 1

Site: Horse Trail Pine - Accord, Chopper, Oust

Acres: 21

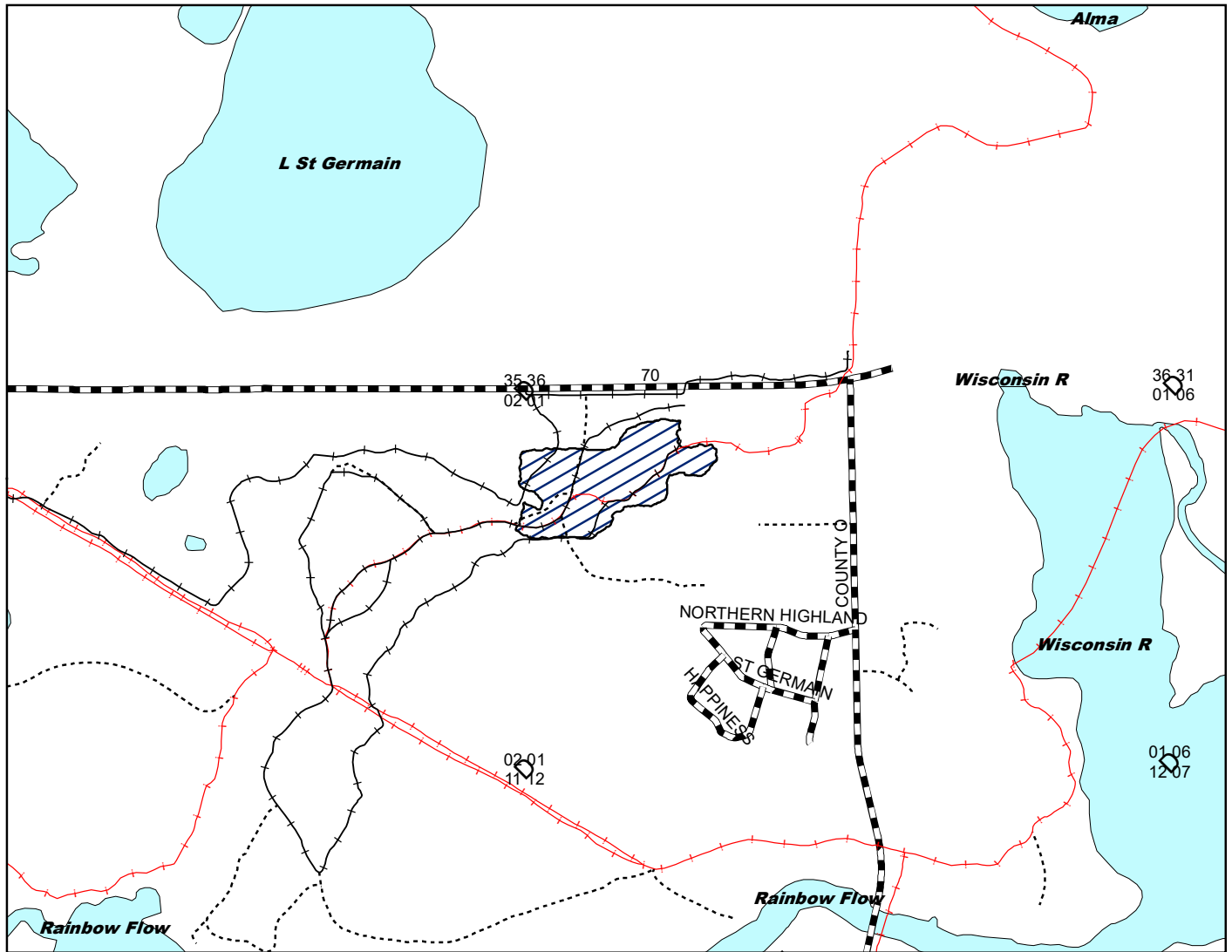

Legend

- Section Corner
- Recreational Trails
- Snowmobile Trails
- Oneida County Roads
- Woods Roads
- Horse Trail Pine Site
- Lakes

Woodruff Service Center Annex
8770 Highway J
Woodruff, WI 54568

Scale: 4" = 1 Mile
1:15,840

Map produced by
Paul Schultz, 4/18

STATE OF WISCONSIN
DEPARTMENT OF NATURAL RESOURCES
 NORTHERN HIGHLAND-AMERICAN LEGION STATE FOREST

Project: Herbicide/Mechanical Site Prep

Dates: June - November 2018

Compartment: 87 - A

T38N-R8E, Section 13
 Location: T38N-R9E, Section 18

Site: Jenny Barns - Accord, Chopper, Oust

Acres: 36

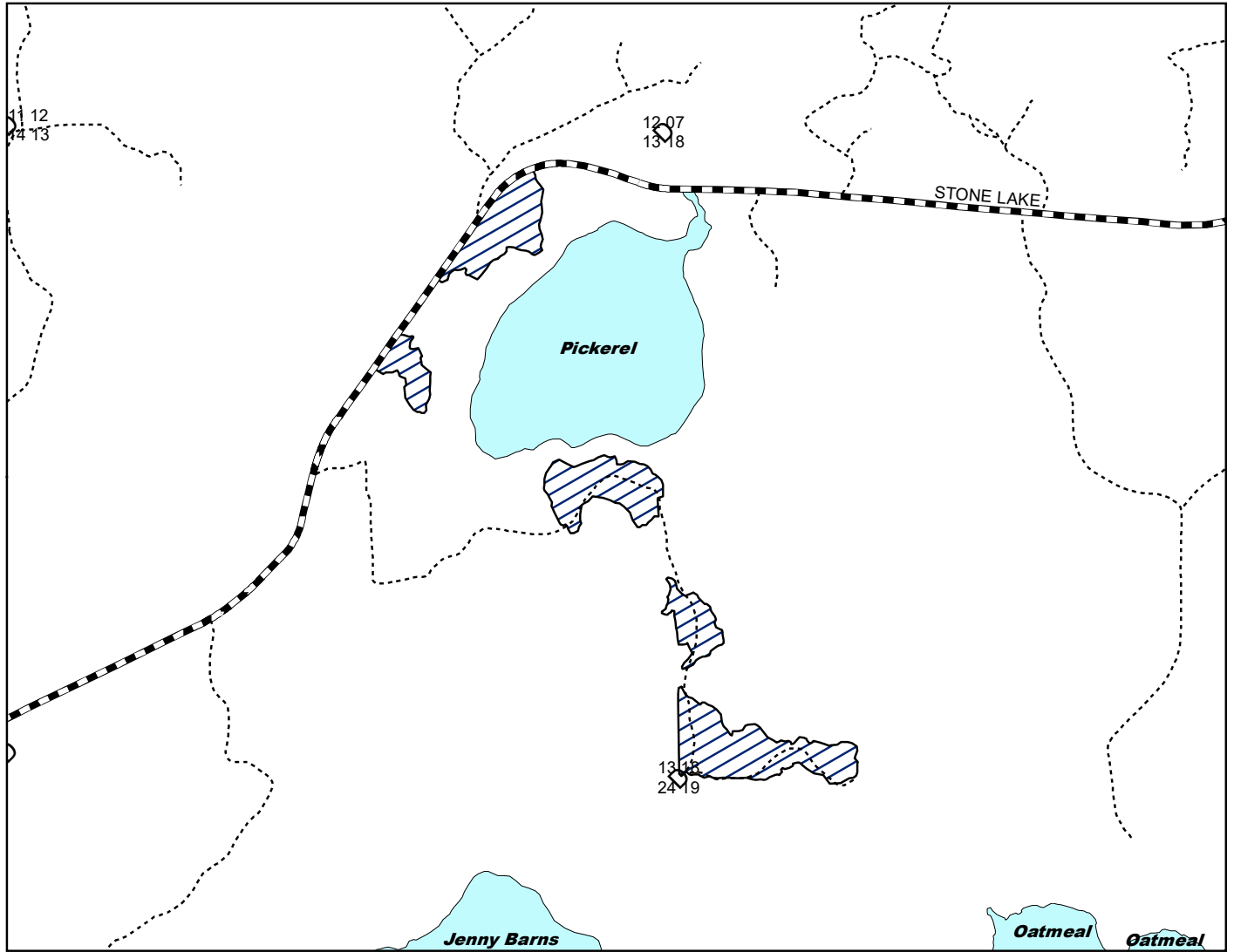

Legend

- Section Corner
- Snowmobile Trails
- Oneida County Roads
- Woods Roads
- Jenny Barns Site
- Lakes

Woodruff Service Center Annex
 8770 Highway J
 Woodruff, WI 54568

Scale: 4" = 1 Mile
 1:15,840

Map produced by
 Paul Schultz, 4/18

STATE OF WISCONSIN

DEPARTMENT OF NATURAL RESOURCES

NORTHERN HIGHLAND-AMERICAN LEGION STATE FOREST

Project: Herbicide/Mechanical Site Prep

Dates: June - November 2018

Compartment: 235 - H

Location: T42N-R5E, Section 1

Site: Clear Lake Island - Accord, Chopper, Oust

Acres: 10

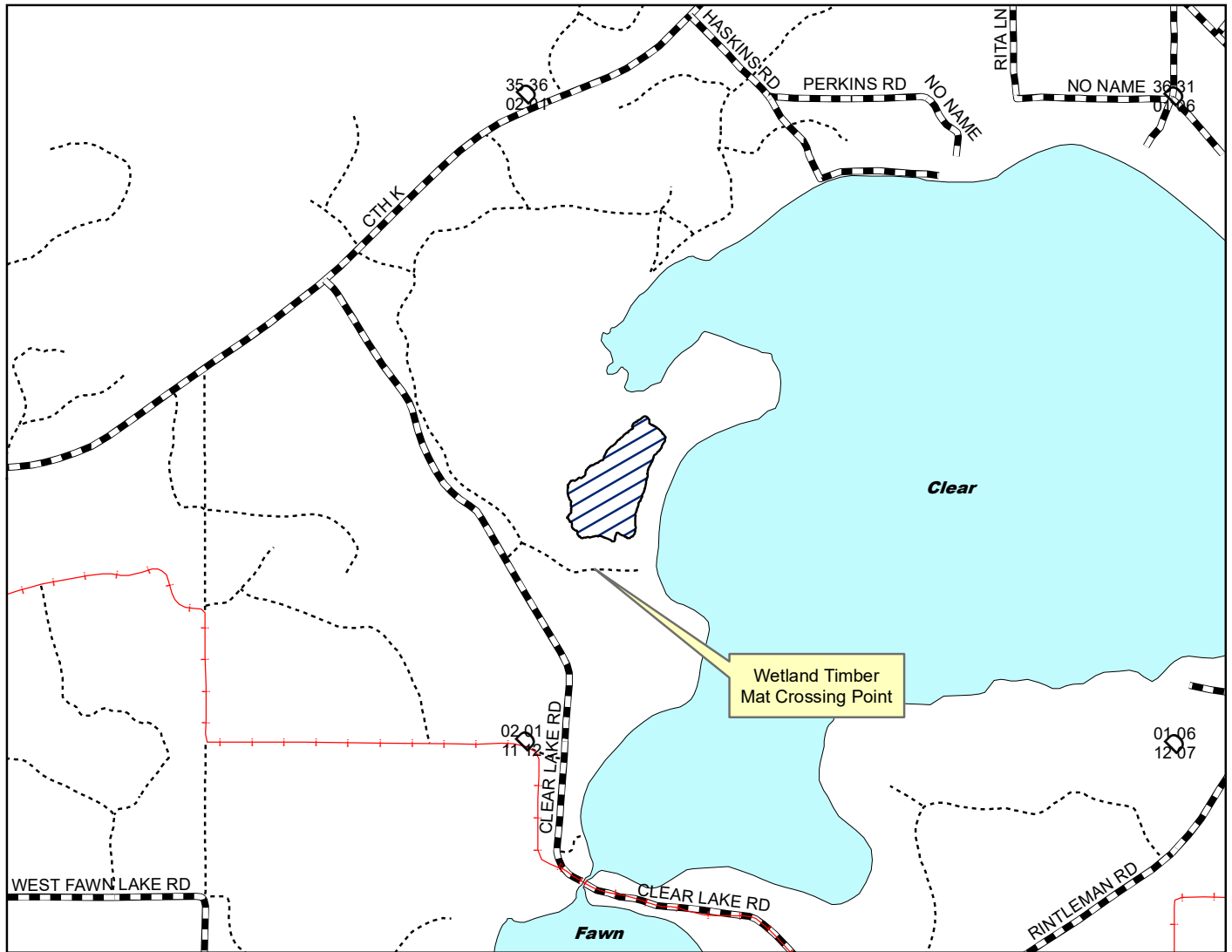

Legend

- Section Corner
- Snowmobile Trails
- Vilas County Roads
- Woods Roads
- Clear Lake Island Site
- Lakes

Woodruff Service Center Annex
8770 Highway J
Woodruff, WI 54568

Scale: 4" = 1 Mile
 1:15,840

Map produced by
 Paul Schultz, 4/18

STATE OF WISCONSIN
DEPARTMENT OF NATURAL RESOURCES
 NORTHERN HIGHLAND-AMERICAN LEGION STATE FOREST

Project: Herbicide/Mechanical Site Prep Dates: June - November 2018
 Compartment: 152 - H Location: T42N-R7E, Section 20
 Site: Marsh Road - Accord (3 Quart), Oust Acres: 12

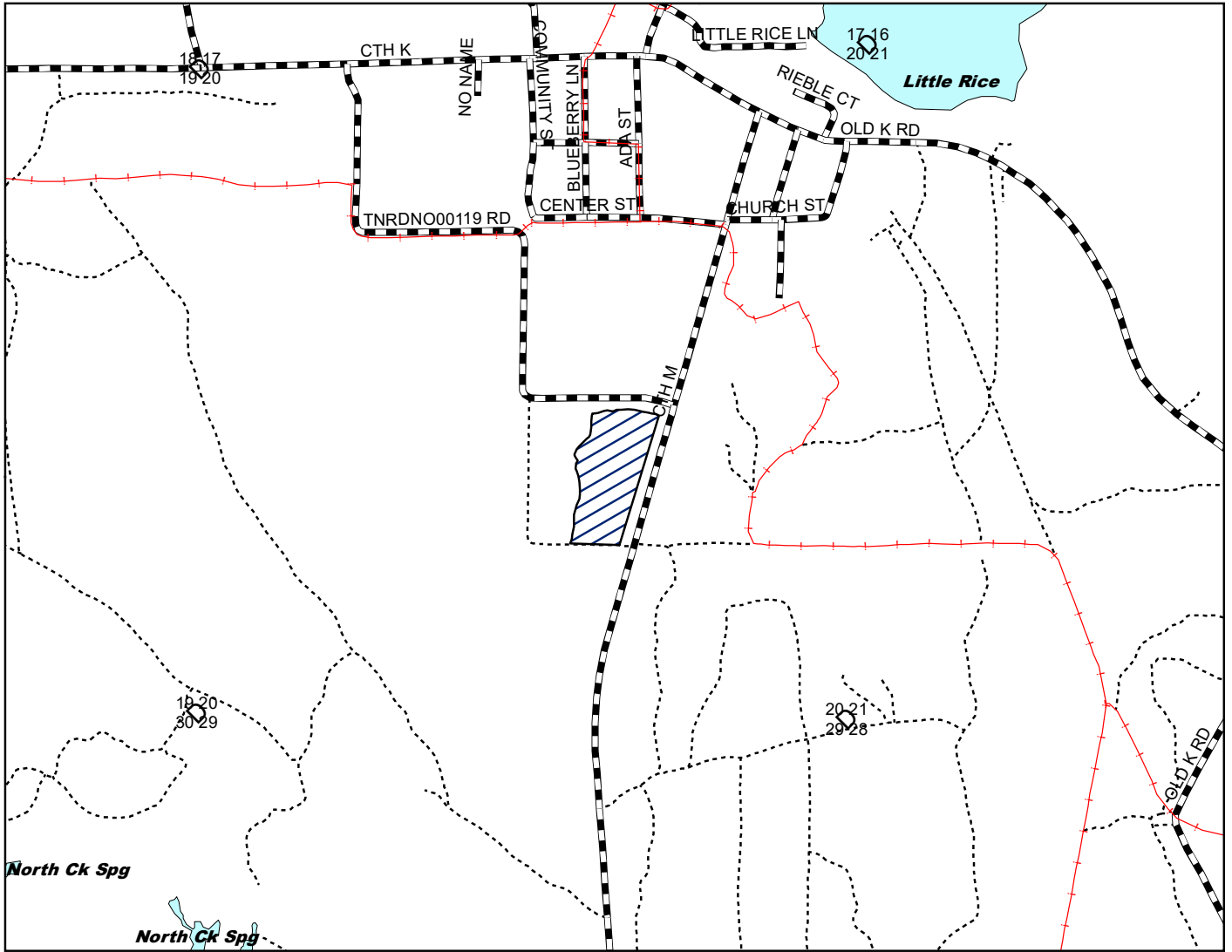

Legend

- Section Corner
- Snowmobile Trails
- Vilas County Roads
- Woods Roads
- Marsh Road Site
- Lakes

Woodruff Service Center Annex
 8770 Highway J
 Woodruff, WI 54568

Scale: 4" = 1 Mile
 1:15,840

Map produced by
 Paul Schultz, 4/18

STATE OF WISCONSIN
DEPARTMENT OF NATURAL RESOURCES
 NORTHERN HIGHLAND-AMERICAN LEGION STATE FOREST

Project: Herbicide/Mechanical Site Prep

Dates: June - November 2018

Compartment: 59 - H

Location: T42N-R8E, Section 8

Site: Johnson Lake - Accord, Chopper, Oust

Acres: 13

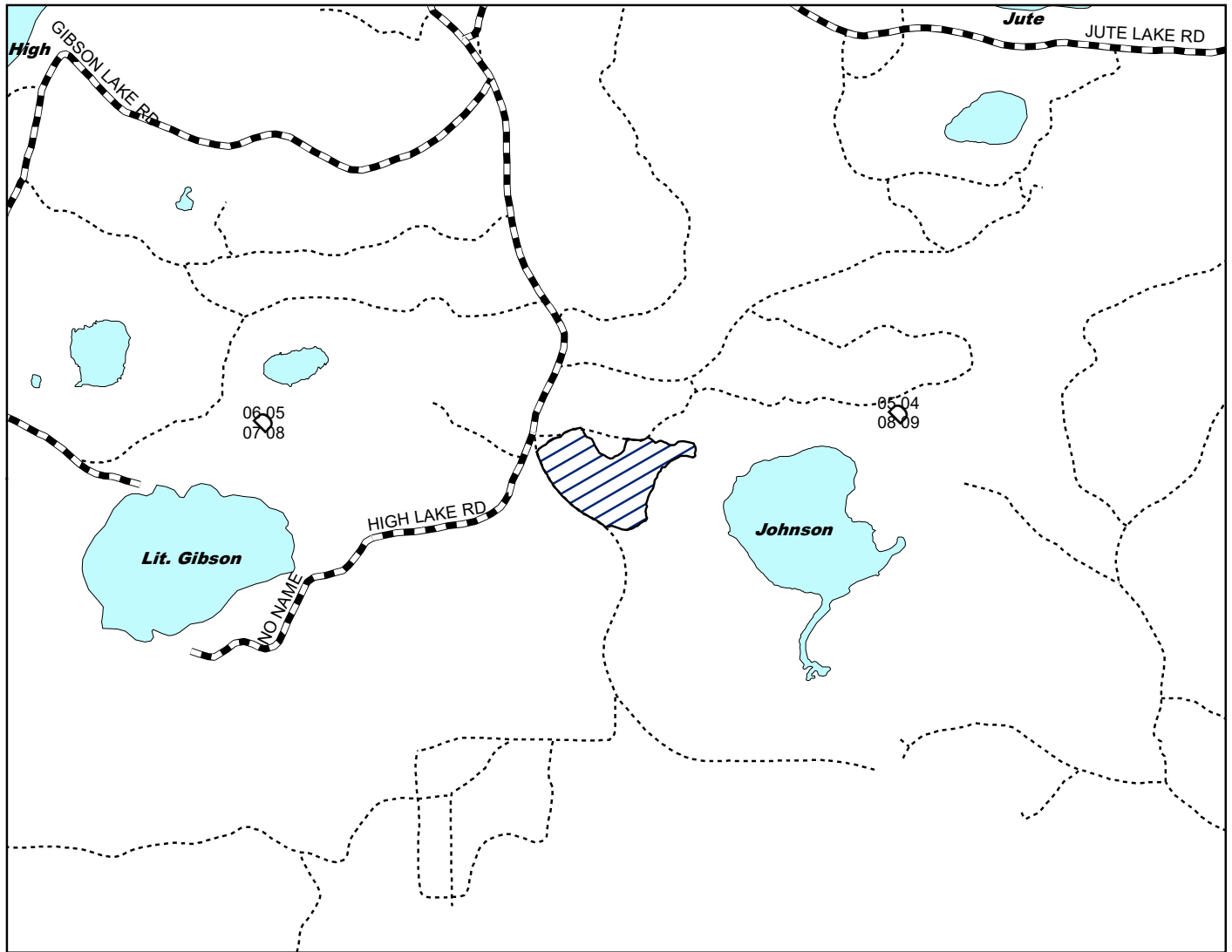

Legend

- Section Corner
- Snowmobile Trails
- Vilas County Roads
- Woods Roads
- Johnson Lake Site
- Lakes

Woodruff Service Center Annex
 8770 Highway J
 Woodruff, WI 54568

Scale: 4" = 1 Mile
 1:15,840

 Map produced by
 Paul Schult, 4/18

STATE OF WISCONSIN
DEPARTMENT OF NATURAL RESOURCES
 NORTHERN HIGHLAND-AMERICAN LEGION STATE FOREST

Project: Herbicide/Mechanical Site Prep

Dates: June - November 2018

Compartment: 90 - H

Location: T43N-R7E, Section 36

Site: High Lake - Accord, Chopper, Oust

Acres: 44

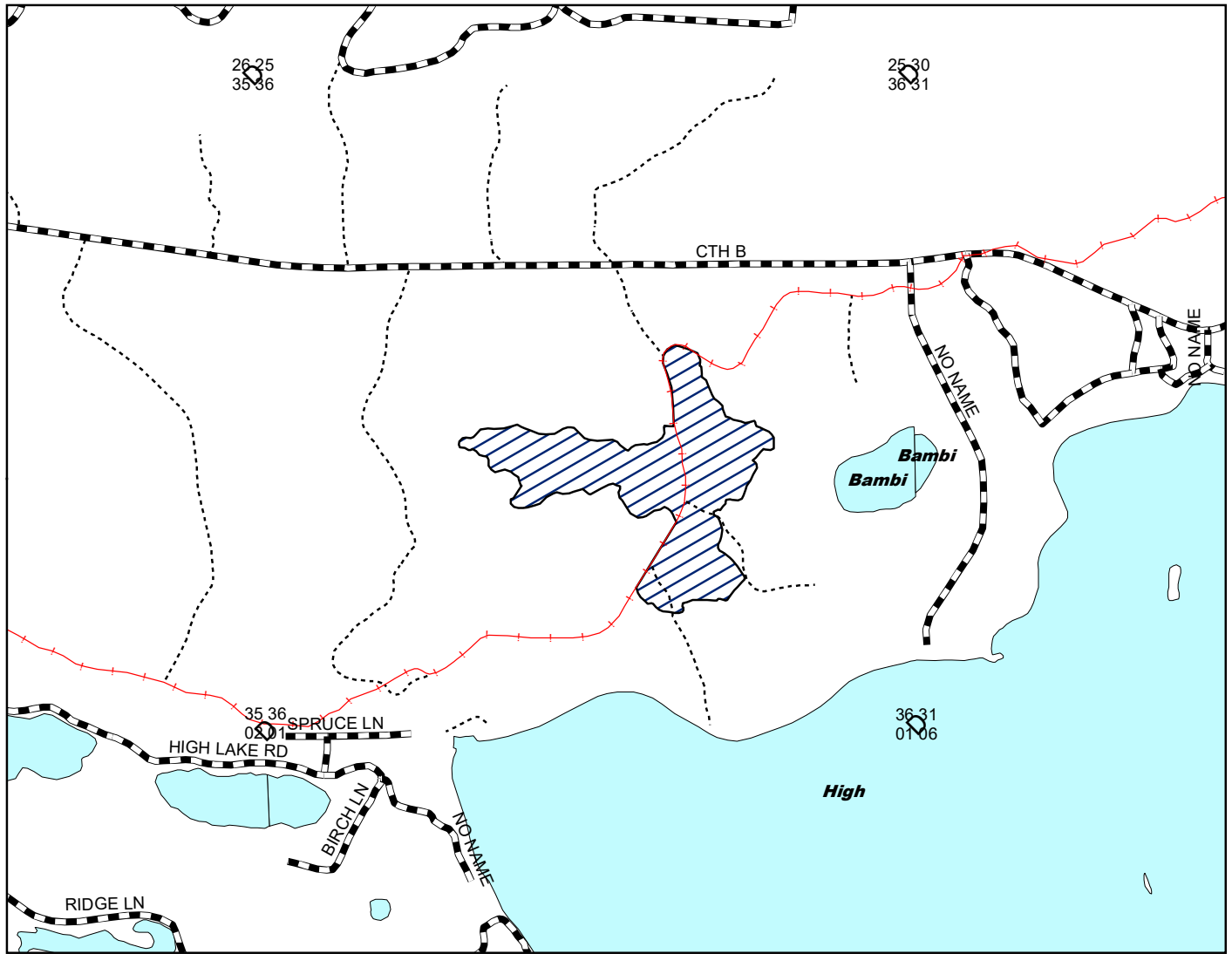

Legend

- Section Corner
- Snowmobile Trails
- Vilas County Roads
- Woods Roads
- High Lake Site
- Lakes

Woodruff Service Center Annex
 8770 Highway J
 Woodruff, WI 54568

Scale: 4" = 1 Mile
 1:15,840

 Map produced by
 Paul Schultz, 4/18

STATE OF WISCONSIN

DEPARTMENT OF NATURAL RESOURCES

NORTHERN HIGHLAND-AMERICAN LEGION STATE FOREST

Project: Herbicide/Mechanical Site Prep

Dates: June - November 2018

Compartment: 26 - H

Location: T42N-R8E, Section 9

Site: Siphon Creek - Accord, Garlon, Oust

Acres: 24

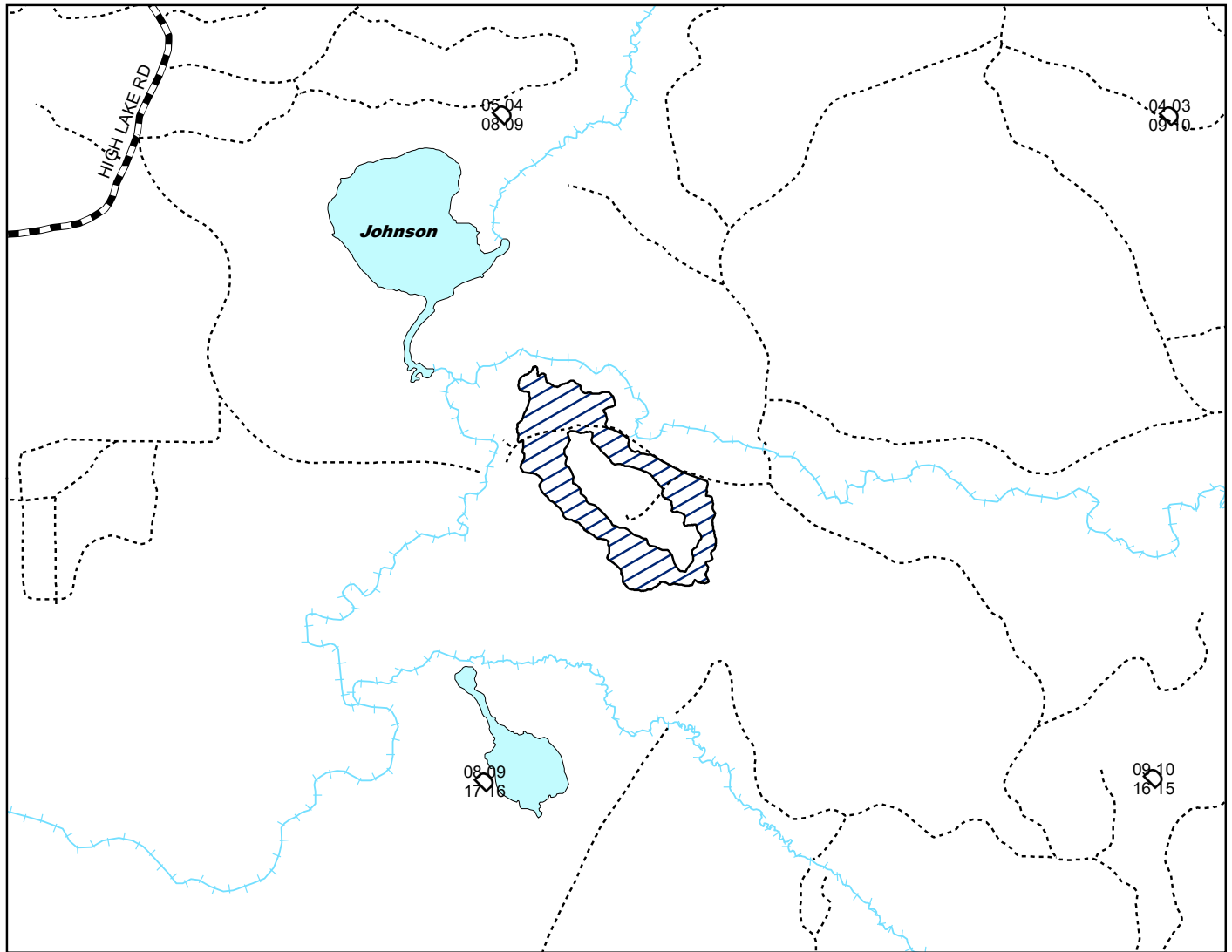

Legend

- Section Corner
- Snowmobile Trails
- Vilas County Roads
- Woods Roads
- Rivers and Streams
- Siphon Creek Site
- Lakes

Woodruff Service Center Annex
8770 Highway J
Woodruff, WI 54568

Scale: 4" = 1 Mile
 1:15,840

 Map produced by
 Paul Schultz, 4/18

STATE OF WISCONSIN

DEPARTMENT OF NATURAL RESOURCES

NORTHERN HIGHLAND-AMERICAN LEGION STATE FOREST

Project: Herbicide/Mechanical Site Prep Dates: June - November 2018

Compartment: 142 - H Location: T40N-R7E, Section 31

Site: Rudolph Road - Accord, Oust Acres: 15

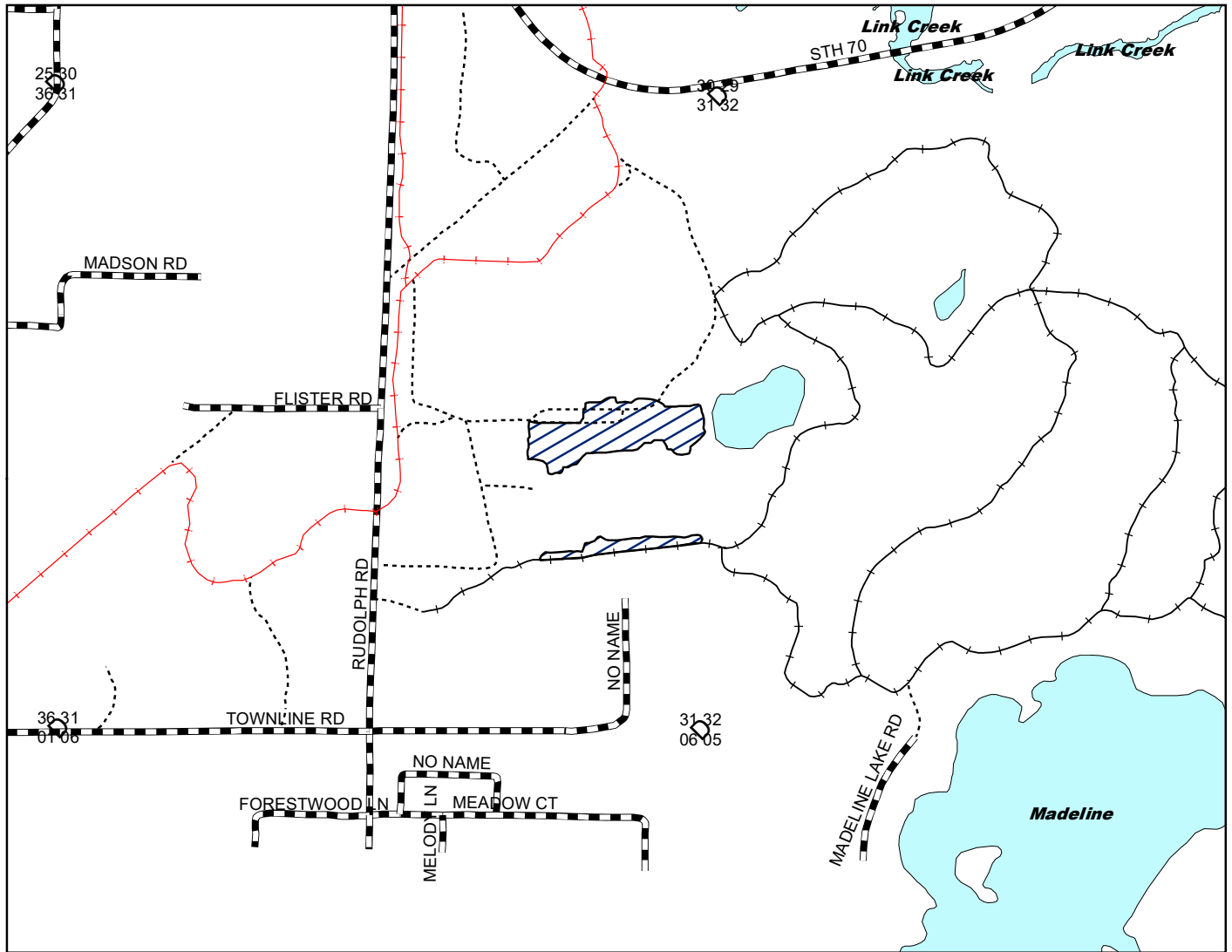

Legend

- Section Corner
- Madeline Trail
- Snowmobile Trails
- Vilas County Roads
- Woods Roads
- Rudolph Road Site
- Lakes

Woodruff Service Center Annex
8770 Highway J
Woodruff, WI 54568

Scale: 4" = 1 Mile
 1:15,840

 Map produced by
 Paul Schultz, 4/18

STATE OF WISCONSIN
DEPARTMENT OF NATURAL RESOURCES
NORTHERN HIGHLAND-AMERICAN LEGION STATE FOREST

Project: Herbicide/Mechanical Site Prep

Dates: June - November 2018

Compartment: 205 - H





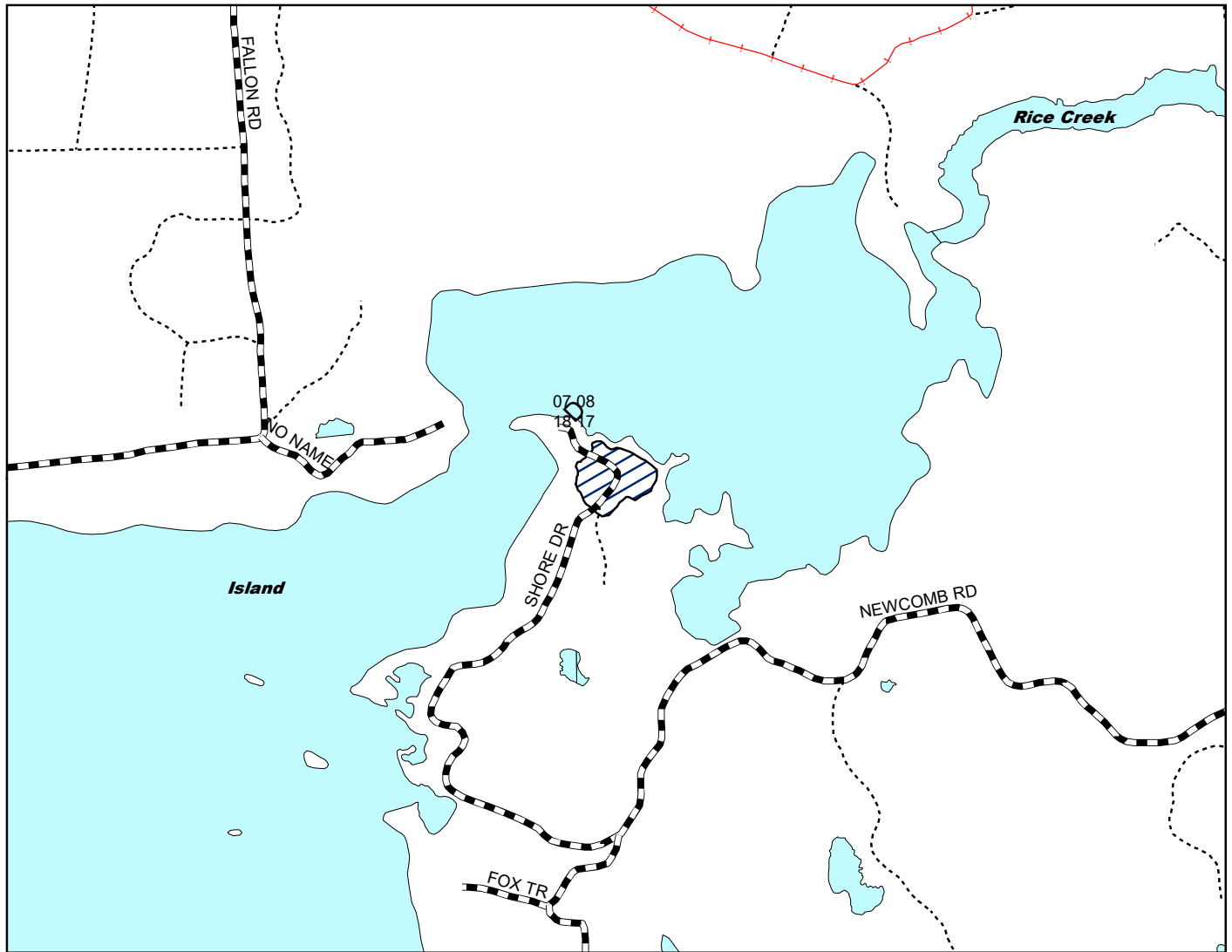

Location: T42N-R6E, Section 8, 17

Site: Shore Drive - Accord, Garlon, Oust

Acres: 6



Legend

-  Section Corner
-  Snowmobile Trails
-  Vilas County Roads
-  Woods Roads
-  Shore Drive Site
-  Lakes

Woodruff Service Center Annex
8770 Highway J
Woodruff, WI 54568

Scale: 4" = 1 Mile
1:15,840

Map produced by
Paul Schult, 4/18