

- NOTES:
1. TOPOGRAPHIC AND PLANIMETRIC DATA PROVIDED BY AERO-METRIC, INC., MINNEAPOLIS, MN. DATE OF FLIGHT: MAY 17, 2008.
 2. HORIZONTAL DATUM BASED ON NAD 1983. HORIZONTAL COORDINATES BASED ON WISCONSIN STATE PLANE NORTH (FEET.)

1,681,500 E

1,682,000 E

1,682,500 E

1,683,000 E

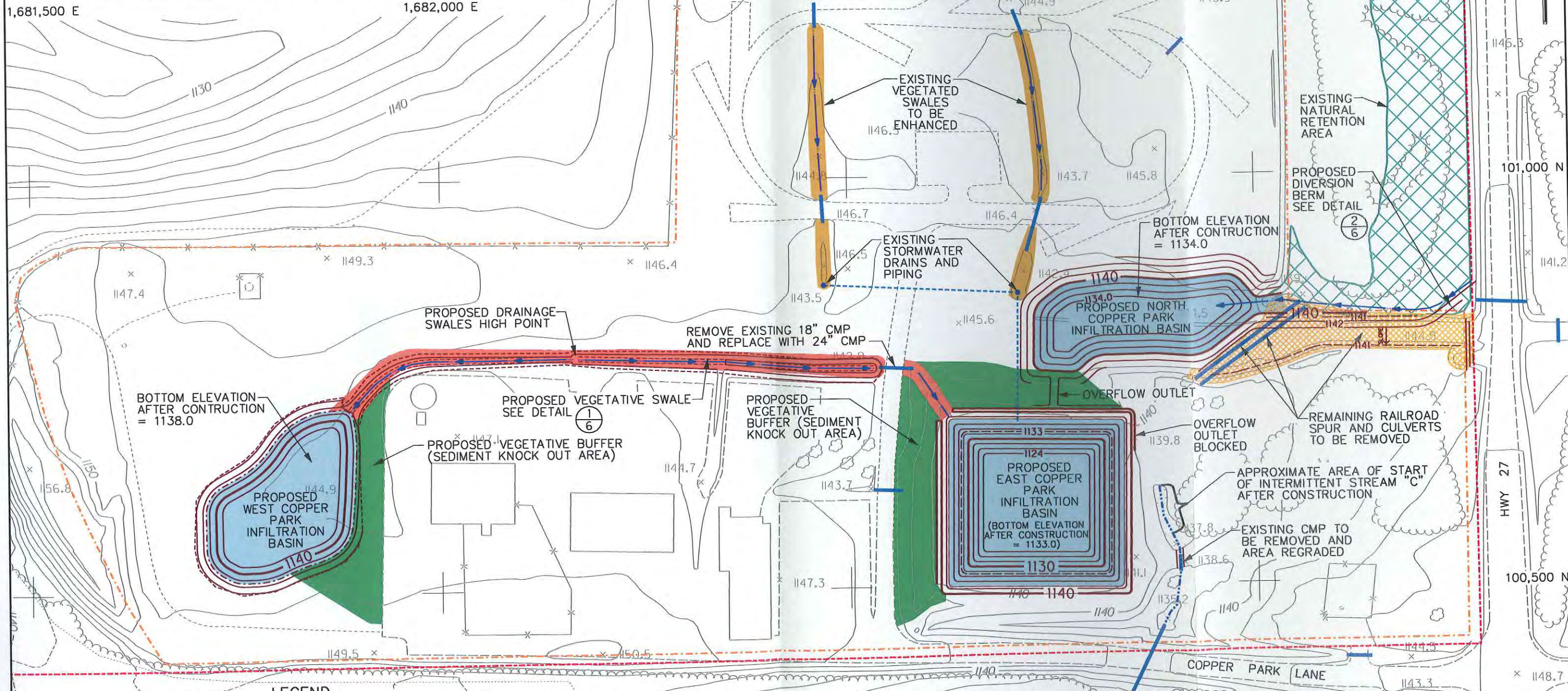

LEGEND

- | | | | |
|--------------------------|--------------------------------|------------------------|---|
| x 1147.1 | EXISTING SPOT ELEVATION | [Cross-hatched box] | RAILROAD SPUR REMOVAL AREA |
| -1150- | EXISTING 2' ELEVATION CONTOURS | [Orange box] | EXISTING VEGETATED SWALE |
| x | EXISTING FENCE | [Green box] | PROPOSED VEGETATED BUFFER |
| [Tree symbol] | EXISTING TREE | [Red box] | PROPOSED VEGETATED DRAINAGE SWALE |
| [Wavy line symbol] | EXISTING TREE LINE | [Blue box] | PROPOSED MAXIMUM WATER LEVEL IN INFILTRATION BASINS |
| [Rectangle symbol] | EXISTING BUILDING | [Blue box with arrows] | EXISTING NATURAL RETENTION AREA |
| [Dashed line symbol] | EXISTING EDGE OF GRAVEL | [Blue dashed line] | PROPOSED DRAINAGE FLOW DIRECTION |
| [Dotted line symbol] | EXISTING EDGE OF PAVEMENT | [Blue dotted line] | INTERMITTENT STEAM LOCATION |
| [Blue line symbol] | EXISTING CULVERT LOCATION | [Red dashed line] | 1140 PROPOSED GRADING CONTOUR |
| [Red dashed line symbol] | FLAMBEAU MINE AREA BOUNDARY | | |
| [Red dashed line symbol] | INDUSTRIAL OUTLOT LIMITS | | |

Foth Infrastructure & Environment, LLC

REVISED	DATE	BY	DESCRIPTION
CHECKED BY:		MAN	DATE: MAY '11
APPROVED BY:		JBHI	DATE: MAY '11
APPROVED BY:			DATE:



FLAMBEAU MINING COMPANY

FIGURE 3
SURFACE WATER GRADING PLAN AND VEGETATIVE COVER AREAS

Scale: 0 60' 120'
Date: MAY, 2011
Prepared By: JRB2
Project No: 08F777