

**WISCONSIN
DEPARTMENT OF NATURAL RESOURCES
TIMBER SALE
TRACT 01-24 BOULDER LAKE
T42N R6E SECTION 13
T42N R7E SECTION 18
HARVEST ACRES - 242**

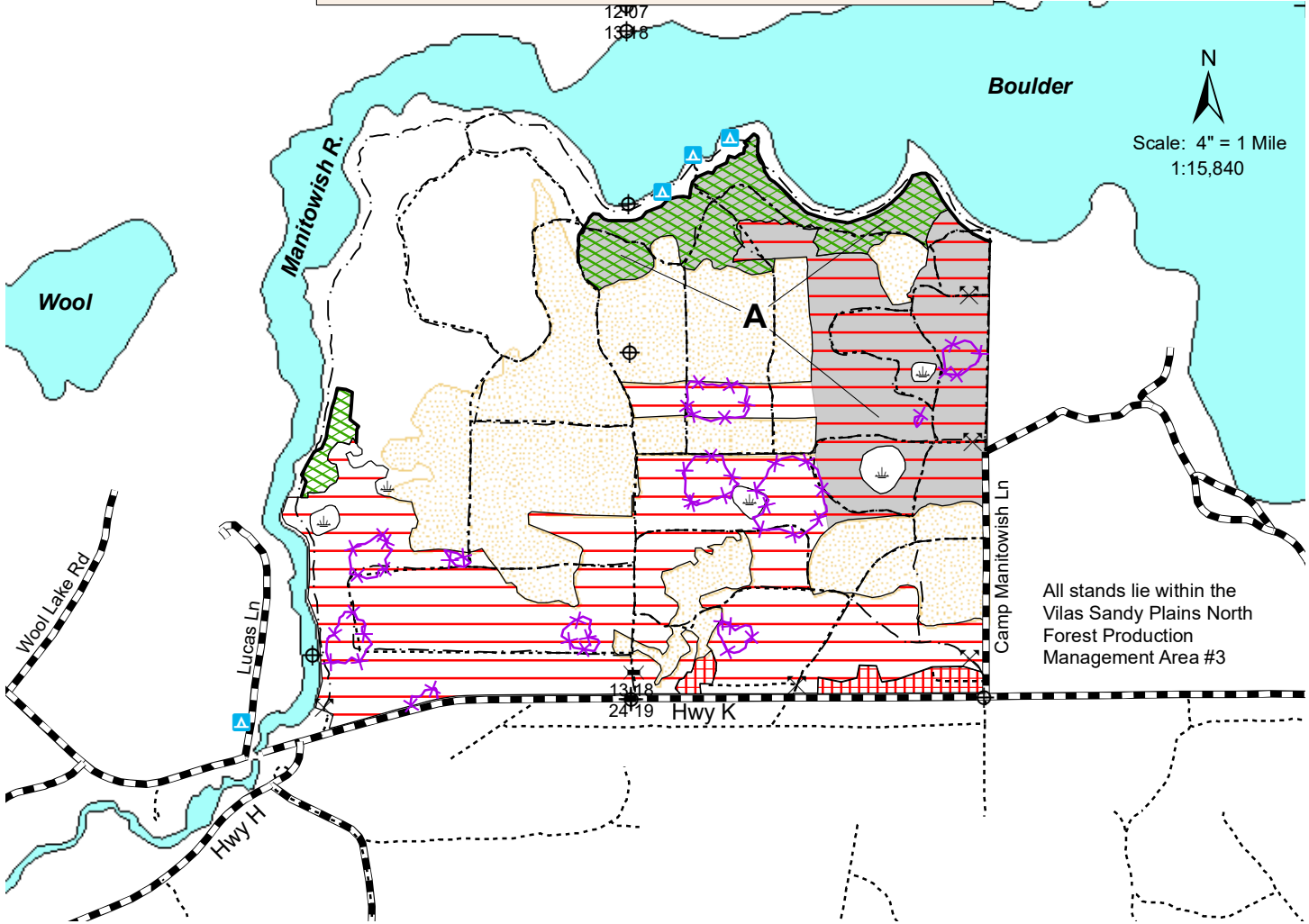

All stands lie within the Vilas Sandy Plains North Forest Production Management Area #3

Legend

- Keg/Swamp
- Gates
- Berms
- Survey Marker
- Section Corner
- Canoe Campsite
- Purple Line
- Red Line
- Recreational Trails
- Woods Roads
- Highways and Town Roads
- Zone A (80 acres)
- Young Plantations (no cut)
- Lakes

Aspen Coppice (29 Acres): Cut all aspen, balsam fir, maple and white birch not marked green. Cut all 1-5" aspen and maple.

Red Pine (207 Acres): Cut all orange marked trees. Cut all red pine within purple marked gaps including purple marked trees.

First Thinning Pine (6 Acres): Cut all orange marked trees.

Note: Do NOT cut trees marked with green paint.

Harvesting operations allowed July 16 - April 14.

Zone A: Harvesting operations allowed September 15 - April 14.



Map produced by
Chase Christopherson, 03/23

This map is not a survey of the actual boundary of any property this map depicts.

NH-ALSF TRACT 01-24
Boulder Lake

The cutting area is approximately 242 acres.

All trees that will yield one or more 100-inch sticks to the minimum 4" top diameter will be cut and utilized.

ESTIMATED VOLUME (TONS)

MINIMUM TOP DIAMETER

<u>SPECIES</u>	<u>4"</u>
White Pine ¹	260
Red Pine ²	8100
Aspen	900
Mixed Hardwood ³	110
<u>Total Minimum Bid Value \$ 172,522.00</u>	

¹Volume includes approximately 5% jack pine and an estimated 40 MBF of potential white pine logs.

²Volume includes an estimated 1,250 MBF of potential logs.

³Volume consists of approximately 67% red maple and 33% white birch.

Total sale volume equates to 38.7 tons/acre or 17.2 cords/acre.

Special Conditions:

1. Cutting must be concurrent for all species to be harvested. Do not cut, knock down, or utilize any dead standing snags unless they pose a hazard to the contractor. Logger may be asked to knock down standing dead trees adjacent to recreational trail for user safety. Biomass harvesting is not allowed.
2. Purple marked gaps are areas of red pine pocket decline. Minimize damage to understory trees within the gaps.
3. Slash within 50 feet of the highways/town roads must be lopped and scattered to lie within 2 feet of the ground and pulled back into the sale area at least 10 feet from the edges of those areas. No tops or slash allowed in adjacent seedling/sapling stands.
4. Recreational trails must be kept free of debris and slash pulled back 10 feet behind tree line. Trails must be repaired to pre-harvest condition.
5. All pine products cut between April 1 and September 1 must be removed from the sale area within three weeks from the time of cutting. Pine products cut during the remainder of the year must be removed prior to April 1 of each year.
6. If the contract is to be worked on during multiple time periods a mid-contract "pull-off" inspection meeting will be required. One-week notice shall be given by the contractor prior to moving equipment off-site. During the "pull-off" inspection, provisions needing attention will be documented. The contractor at that time can decide to remedy them before pulling equipment off or rectify them when moving back onto the site. If the latter is chosen, documented items shall be addressed before harvesting can continue.

Note: In order to fill and save this form electronically, it must be opened using Adobe Reader or Acrobat software. Save a copy of the file, open Adobe Reader, select File > Open and browse for the file you saved.

State of Wisconsin
Department of Natural Resources
dnr.wi.gov

Timber Sale Bid
Form 2400-049 (R 07/22)

Notice: Completion of this form is mandatory. The Department will not recognize your bid unless you complete and submit this form. Personal information collected will be used for program administration and may be provided to requesters as required by Wisconsin's Public Records law [ss. 19.31-19.39, Wis. Stats.].

Date

Bidder Name

Street Address

City

State

ZIP Code

Property Name (if any)

Northern Highland-American Legion

Timber Sale Name

Boulder Lake

Tract Number

01-24

Date and Hour of Bid Opening

May 1, 2024 1:30 pm

Boulder Junction Community Center

Minimum Acceptable Bid (optional)

\$172,522.00

Species-All bids including Lump Sum bids must be by species	Utilization Specifications (4 inch/Whole Tree/Logs)	Estimated Volume	Volume Units (tons/cords/mbf)	Price Bid Per Unit	Total Bid Value on Estimated Volume
white pine	4 inch	260	tons		
red pine	4 inch	8,100	tons		
aspen	4 inch	900	tons		
mixed hardwood	4 inch	110	tons		

The award shall be based on this TOTAL BID AMOUNT:

Performance Bond

Will be in the form of: (select one)

Personal Check

Assurance Bond

Certified Check/Money Order

Certificate of Deposit

Irrevocable Letter of Credit

Assignment of Savings Account

I understand that any or all bids may be rejected and that consideration and awarding of a contract will be based upon my past performance and ability to complete contracts. **I also understand that if I am the winning bidder, I have 6 weeks from the date of the bid opening to submit an acceptable performance bond. I also understand that if I am awarded the contract and fail to execute it or work under it, I will be required to forfeit to the Department an amount equal to 10% of my total bid amount.** Failure to forfeit the 10% penalty will result in being considered ineligible to bid on any state timber sales for a two-year duration. In the event the highest bidder can not or will not sign the contract, the award may be made to the next highest qualified bid.

By checking this box, I certify that I hold a Wisconsin Master Logger Certification.

Notice: I understand:

Utilization specifications and estimated volumes are listed in the prospectus which is available upon request from the Department.

A copy of the standard timber sales contract which must be entered into is available upon request from the Department.

Signature of Bidder

Bidder's Name (Please Print or Type)

Phone Number (include area code)

Email Address