

#2 Monroe Co Farmers Valley Bridge

State of Wisconsin
 Department of Natural Resources
dnr.wi.gov

Motorized Recreation Grant Application

For: (choose all that apply)

Form 8700-159 (R 04/22)

Page 1 of 5

ATV/UTV Trail Aid

Snowmobile Trail Aid

Due Date: April 15

Notice: Completion of this form is required under Wisconsin Statutes 23.09(26) and 23.33. Failure to complete this form will result in denial of financial assistance. Personally identifiable information found on this form is not intended to be used for any other purpose. The Department of Natural Resources (DNR) may provide this information to requesters as required by Wisconsin's Public Records law (ss. 19.31 – 19.39, Wis. Stats.).

Instructions: Applications may combine more than one source of funds. They may be submitted for consideration of traditional ATV, UTV, Snowmobile and Motorized Stewardship funding. Submit one copy of all forms and attachments. See Page 2 for necessary attachments. Send applications to your [Community Services Specialist](#).

DNR Use Only	
Category	Number

Section 1: Applicant Information

Applicant / Organization Name Monroe County			Check Recipient: Individual other than authorized individual to act on behalf of the applicant. <input type="checkbox"/> Select if the same as applicant.		
Individual Authorized to Act on Behalf of Applicant per Resolution Chad Ziegler			Check Recipient Name (Name to Appear on Check) Monroe County Treasurer		
Title Snowmobile Coordinator			Title		
Address 14345 County Hwy B, Suite 5			Address 14345 County Hwy B, Suite 5		
City Sparta	State WI	ZIP Code 54656	City Sparta	State WI	ZIP Code 54656
Telephone Number 608-269-8635		Email Address chad.ziegler@co.monroe.wi.us			

Section 2: Project Information Required for all Projects

Project Title Farmers Valley Creek Bridge					Current Funded Miles 322.1	New Miles (if applicable)
County Monroe	Township 17 N	Range 3	Section 19	1/4 1/4 SW	1/4 NW	GPS Coordinates: Lat. 43.936155 Long. -90.787490

Project Description Summary

Replace the ties, decking and railing on an old railroad bridge located on property owned by the WDNR. Estimated age of the deck is 50 years.

I certify that all maintenance land use agreements are on file.

Estimated Cost

Maintenance	Acquisition	Insurance	Development	Bridge Rehab.	Trail Rehab.	Total Estimated Cost \$68,000
Leave Blank – DNR Use Only						

Applicant Certification

Printed Name of Authorized Official Chad Ziegler	Official's Title Snowmobile Coordinator
---	--

As the applicant's authorized official, I certify that, to the best of my knowledge, the information in this application is true and correct.

 Signature of Authorized Official

4/5/2022
 Date Prepared

Appendix A – Required for Bridge Rehab/Replace, New, or Reroute with New Bridge

Bridge Rehab/Replace New Bridge Reroute with new bridge

County Monroe	Township 17 N	Range 3	Section 19	1/4 1/4 1/4	GPS Coordinates: Lat. 43.936155 Long. -90.787490
Water Body Name Farmers Valley Creek			Bridge Name Farmers Valley Creek Bridge		County Inventory Number WDNR Bridge
Funded Trail Name or Number (SNARS if applicable) Corridor 27			Has this bridge site ever received development or rehabilitation funds in the past? <input type="radio"/> Yes <input checked="" type="radio"/> No Year: _____ \$ _____		
Bridge is located on: <input type="radio"/> Private property <input checked="" type="radio"/> Public property			Old Bridge/Culvert Size 12' x 123' New Bridge/Culvert Size 12' x 123'		
Landowner Where Bridge is Located WDNR			Telephone Number 608-337-4775	Length of Trail Use Agreement (5 year minimum) 1	
Current maximum load	25000 lbs.	Age of Bridge	Bridge Material		
Proposed maximum load	25000 lbs.	50+	Steel I'beams, wood ties, deck, railing		
Sponsoring Club Name Sparta Trail Blazers			Club Contact Scott Lakowski	Telephone Number 608-387-0793	
Do you have your trail bridges posted as to maximum load? <input type="radio"/> Yes <input checked="" type="radio"/> No			What is the maximum load of the other bridges on the system if groomed with this bridge?		
What is the weight of your puller & drag/grading equipment? 20000			25000		
What other recreational trail uses are planned for this bridge? none					
If there are other Recreational uses planned, how much of the bridge cost will be paid for by non-snowmobile or non-ATV users? n/a					

- Yes No Have you contacted your local DNR Water Management Specialist (WMS) regarding a permit?
- Yes No Is a permit needed? (Please provide any written correspondence from WMS.)
- Yes No Have you contacted your County Zoning Dept. regarding a floodplain determination?
- Yes No Will an H & H (hydrologic and hydraulic) study be required?

Bridge Project Detailed Description

This bridge is 12' wide by 123' long. It has concrete abutments and is constructed with 2, 1' x 4' steel I-beams, approximate spacing is 60" on center. The ties that span the I-beams, the deck and railing are wood. The ties used on this 12' wide bridge are only 9' long, there is a 3' wide "catwalk" along the north side of the bridge that is supported by 14' ties spaced 6' apart. The decking and railing need to be replaced. The decking is deteriorated to the point where it is a safety hazard for the grooming equipment. If the groomer were to accidentally be operated off center of the bridge, it could fall through the decking and potentially fall off the bridge and drop 30' to the valley floor.

The proposal is to remove the existing ties, deck and railing and replace to WDNR specifications. The new deck will have a 12' wide deck supported full width with ties.

Appendix A (continued)

Summarize Costs in Appropriate Categories:

Bridge Structure

	Quote 1	Quote 2
	<input type="radio"/> Steel <input type="radio"/> Wooden	<input type="radio"/> Steel <input type="radio"/> Wooden
Bridge Dimensions:	_____	_____
Bridge Manufacturer:	_____	_____
Design Weight Load	_____ lbs.	_____ lbs.
Cost of Structure:		
1. Engineering	\$ _____	\$ _____
2. Structure	\$ _____	\$ _____
Subtotal	\$ _____	\$ _____

	Quote 1	Quote 2
	<input type="radio"/> Contractor or <input type="radio"/> Sponsor Estimate	<input type="radio"/> Contractor or <input type="radio"/> Sponsor Estimate
Installation Costs:		
1. Engineering	\$ _____	\$ _____
2. Site Preparation	\$ _____	\$ _____
3. Abutments	\$ _____	\$ _____
4. Pilings/Piers	\$ _____	\$ _____
5. Approaches	\$ _____	\$ _____
6. Riprap	\$ _____	\$ _____
7. Labor	\$ _____	\$ _____
8. Equipment Rental	\$ _____	\$ _____
9. Culverts	\$ _____	\$ _____
10. H & H Study	\$ _____	\$ _____
11. Wetland Delineation	\$ _____	\$ _____
12. Other _____	\$ _____	\$ _____
Subtotal	\$ _____	\$ _____
Total Cost	\$ _____	\$ _____

For the application grant, you must take the lowest of the two quotes.

Entire Deck and Railing Projects Contractor Sponsor Club

Bridge Dimensions:	12' x 123'
Design Weight Load	25,000 lbs.
1. Materials	\$ 48,000.00
2. Labor	\$ 20,000.00
Total	\$ 68,000.00

Appendix A (continued)

Summarize Costs in Appropriate Categories:

Bridge Structure			
		Quote 1	Quote 2
		<input type="radio"/> Steel <input type="radio"/> Wooden	<input type="radio"/> Steel <input type="radio"/> Wooden
Bridge Dimensions:		_____	_____
Bridge Manufacturer:	<u>DP Schroeder Construction</u>		<u>Eby's</u>
Design Weight Load		_____ lbs.	_____ lbs.
Cost of Structure:	1. Engineering	\$ _____	\$ _____
	2. Structure	\$ _____	\$ _____
	Subtotal	\$ _____	\$ _____
		Quote 1	Quote 2
		<input type="radio"/> Contractor or <input type="radio"/> Sponsor Estimate	<input type="radio"/> Contractor or <input type="radio"/> Sponsor Estimate
Installation Costs:			
1. Engineering		\$ _____	\$ _____
2. Site Preparation		\$ _____	\$ _____
3. Abutments		\$ _____	\$ _____
4. Pilings/Piers		\$ _____	\$ _____
5. Approaches		\$ _____	\$ _____
6. Riprap		\$ _____	\$ _____
7. Labor		\$ <u>20,000</u>	\$ _____
8. Equipment Rental		\$ _____	\$ _____
9. Culverts		\$ _____	\$ _____
10. H & H Study		\$ _____	\$ _____
11. Wetland Delineation		\$ _____	\$ _____
12. Other <u>Materials</u>		\$ <u>48,000</u>	\$ <u>88,000</u>
	Subtotal	\$ <u>68,000</u>	\$ <u>88,000</u>
	Total Cost	\$ <u>68,000</u>	\$ <u>88,000</u>

For the application grant, you must take the lowest of the two quotes.

Entire Deck and Railing Projects		<input checked="" type="radio"/> Contractor	<input type="radio"/> Sponsor	<input type="radio"/> Club
Bridge Dimensions:	<u>12' x 123'</u>			
Design Weight Load	<u>25,000</u> lbs.			
1. Materials		\$ <u>48,000</u>		
2. Labor		\$ <u>20,000</u>		
	Total	\$ <u>68,000</u>		

Hi Chad,
The Total bridge cost that I came up with is -\$88,000.00

I Did a bridge rehab for Polk County In 2020, (Cattail)140 foot bridge, costed me around 95,900.00

Below this email I have attached pics of that cattail bridge
If you need a description written out on supplies, or how I actually built it, please let me know!!! or if you want me to give you a call and explain how I did the rehab, If I was doing this rehab I would do the Farmers Valley Bridge very similar to Cattail bridge.

If you have any questions or would like too see more pics feel free to contact me.
I would be happy to help as best I can

***EBYS PORTABLE WELDING &
FABRICATION***

*JEFFERY A EBY
N5188 COUNTY ROAD B
GLEN FLORA, WI 54526
715-415-2247
EBYSWELDING@YAHOO.COM*

On Wednesday, April 5, 2023, 01:22:46 PM CDT, Chad Ziegler <chad.ziegler@co.monroe.wi.us> wrote:

Jeff,

The bridge dimensions are 123' x 12'. If replacing ties with 12' wood ties, there would be 115, 12' timbers and 17, 14' timbers (to attach the railing). In my application, I'm proposing to lengthen all the ties to 12' wide. If you have any questions, or if you would like to look at the bridge, let me know.

Thank you.

Chad Ziegler

Monroe County

Forest & Parks Administrator

14345 County Hwy B, Suite 5

Sparta, WI 54656

608-269-8635

Fax: 608-366-1809

<http://www.co.monroe.wi.us/departments/parks-forestry/>

Contractor Proposal

Page No. 1 of 1

DP Schroeder Construction LLC

1115 Depot Street - Sparta, WI 54656

Phone: 608-269-3005

Proposal Date:	11-30-2022	Proposal #	2022-0036
Submitted To	Snow Mobile Trails of Monroe County	Job Name:	Large Bridge Tie Replacement
Street		Job Location:	
City, State, Zip		Architect:	
Phone:		Date of Plans:	

We propose to furnish labor and material to:

Remove existing ties.

Install new 8" by 8" creosote treated ties.
To be bolted to existing bridge beams.
114 ties 12' long
17 ties 14' long

Estimate \$68,000.00

We Propose to furnish material and labor - complete in accordance with above specifications, for the sum of:
1 and 1/2 percent per month (18% per year) Service Charge will be applied after 30 days.

Authorized Signature:



This proposal may be withdrawn by us if not accepted within 30 days.

Acceptance of Proposal -- The above prices, specifications, and conditions are satisfactory and are hereby accepted. You are authorized to do the work as specified. Payment will be made as outlined above.

Date of Acceptance

Signature

Monroe County Snowmobile Trails

Farmers Valley Creek Bridge - Plat Map

Angelo

Township 17N - Range 3W

Copyright © 2014 Mapping Solutions

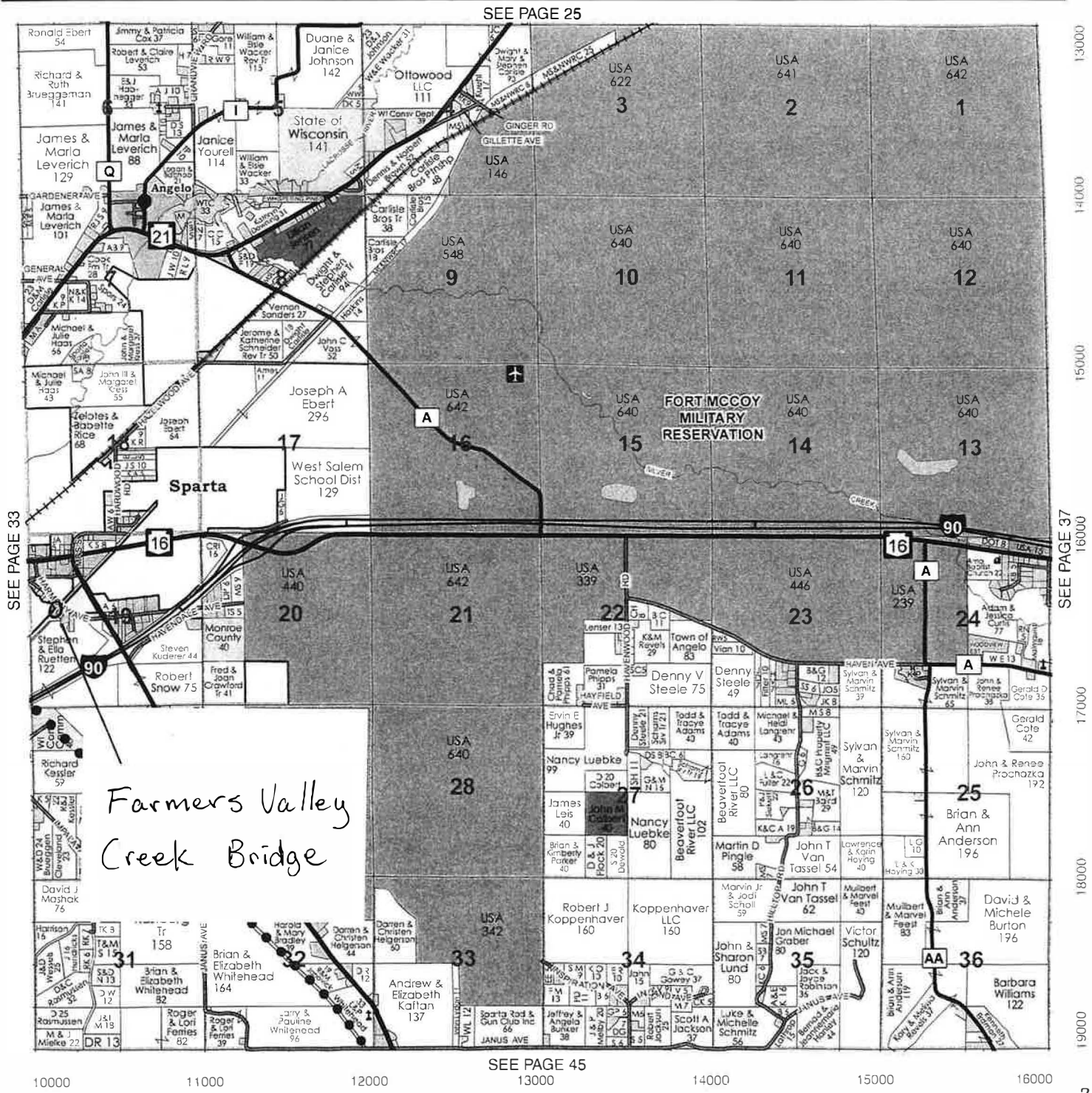

ATTACH STRINGERS W/ H.D. CONSTRUCTION SCREWS. (1) SCREW THRU EDGE PLATE & (1) THRU DECK BOARD 2' O.C. (MAX).

ATTACH RAILS TO EACH POST W/ (2) H.D. CONSTRUCTION SCREWS. ATTACH CAP RAIL TO TOP RAIL W/ H.D. CONSTRUCTION SCREWS 2' O.C. (MAX) & TO EACH POST W/ (2) H.D. CONSTRUCTION SCREWS.

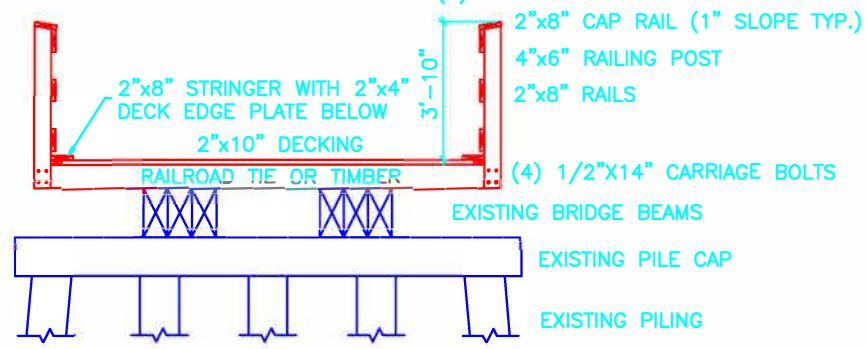

BRIDGE CROSS SECTION

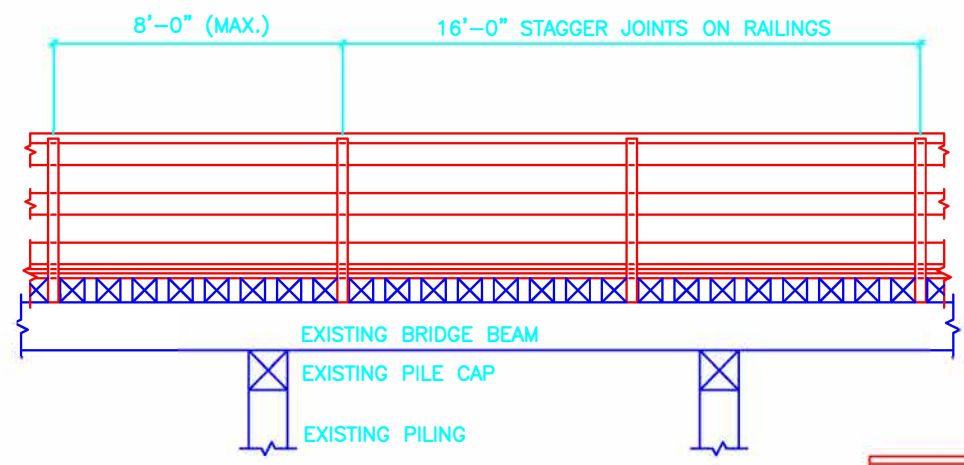

BRIDGE ELEVATION

3/4" DRIFT PIN INSTALLATION. 14" LONG WITH THREADED END. DRILL 3/4" HOLE IN UPPER MEMBER & 3/8" PILOT HOLE IN LOWER MEMBER. COUNTERSINK HEAD FLUSH WITH SURFACE. INSTALL IN EVERY FOURTH TIE.

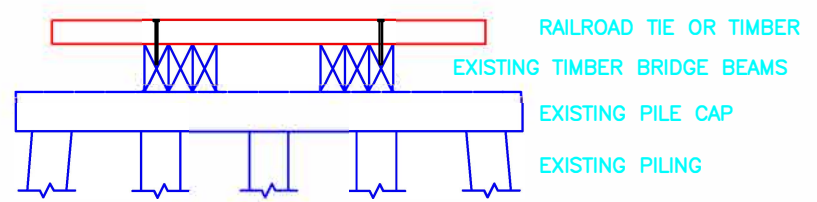

NEW TIE INSTALLATION FOR BRIDGES W/TIMBER BEAMS

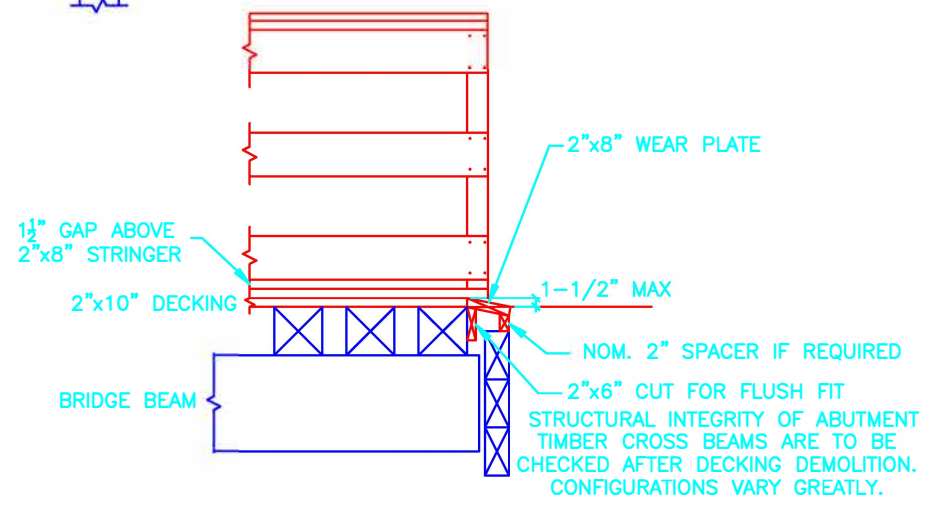

WEAR PLATE DETAIL
NOT TO SCALE

BRIDGES W/ IRON BRIDGE BEAMS ARE TO REUSE EXISTING ATTACHMENT HARDWARE IF POSSIBLE OR USE 3/4"x 5" LAG BOLTS AND CLIPS AS SHOWN. INSTALL ON EVERY FOURTH TIE.

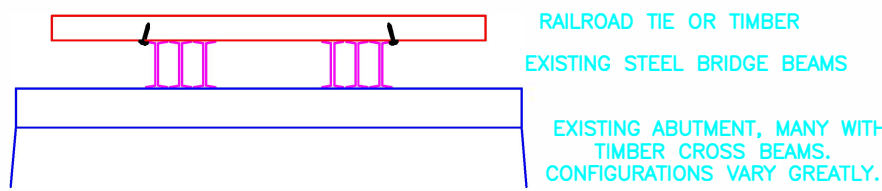

NEW TIE INSTALLATION FOR BRIDGES W/STEEL BEAMS

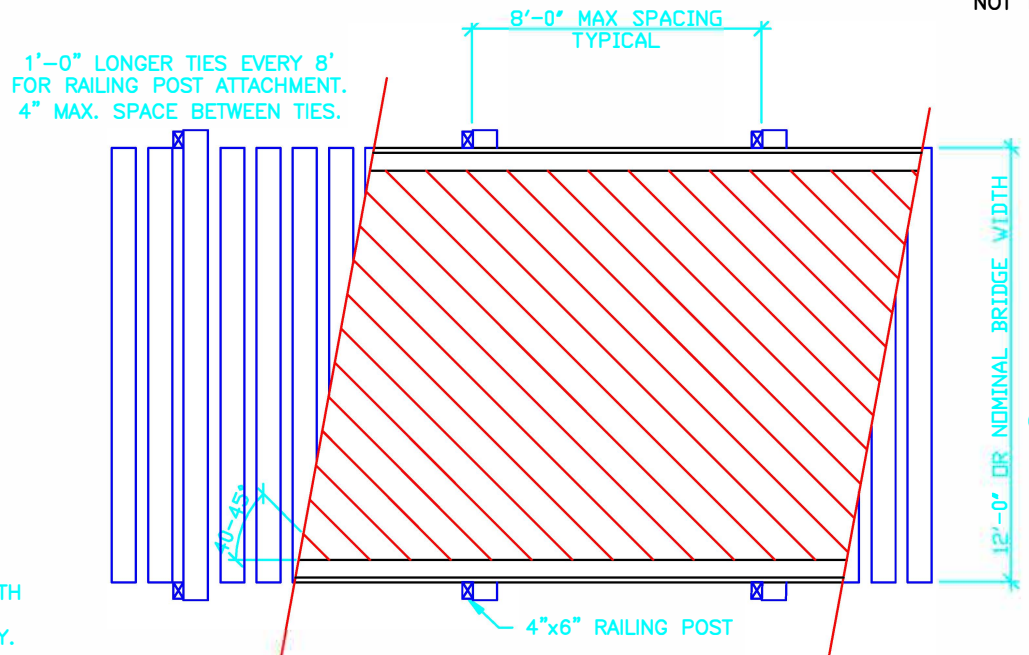

DECKING PLAN

2"x10" TREATED DECKING INSTALLED WITH BARK SIDE UP & WITH 1/4" (MAX.) GAP BETWEEN BOARDS. ATTACH W/ (2) HEAVY DUTY CONSTRUCTION SCREWS TO EACH TIE.

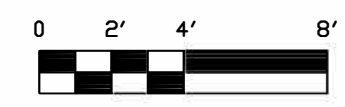

Scale: 3/16" = 1'

NOTES:
DESIGN AND DETAILS VARY WIDELY FROM BRIDGE TO BRIDGE. SOME ARE CLEAR SPANS WHILE OTHERS HAVE DRIVEN POLE PILING. SOME BRIDGE BEAMS ARE STEEL WHILE OTHERS ARE HEAVY TIMBERS. THIS DRAWING SHOWS A GENERAL VIEW AND REPRESENTATION OF VARIOUS REPAIRS AND MODIFICATIONS THAT MAY NEED TO BE MADE TO SOME BRIDGES. REFER TO "SCHEDULE OF BRIDGE RENOVATIONS" FOR A LIST OF SPECIFIC REPAIRS TO EACH BRIDGE DESIGNATED FOR REPAIRS.

REVISIONS:		DATE:	
STATE of WISCONSIN DEPARTMENT of ADMINISTRATION DIVISION of STATE FACILITIES DSF No. _____			
DEPARTMENT OF NATURAL RESOURCES BUREAU OF FACILITIES AND LANDS ENGINEERING SECTION			
PROJECT TITLE: REHABILITATION OF TRAIL BRIDGE ELROY-SPARTA STATE TRAIL MONROE COUNTY, WISCONSIN DEPARTMENT PROJECT No. _____			
DRAWING TITLE: BRIDGE REPAIR DETAILS			
ENGINEER/ARCHITECT T. J. REININGER, P.E.	SCALE: 3/16" = 1'-0"	DATE: 08/17/2009	
DRAWN BY: TJR	CHECKED BY:	SHEET ___ OF ___	

Monroe County Snowmobile Trails

Farmers Valley Creek Bridge - Topo Map

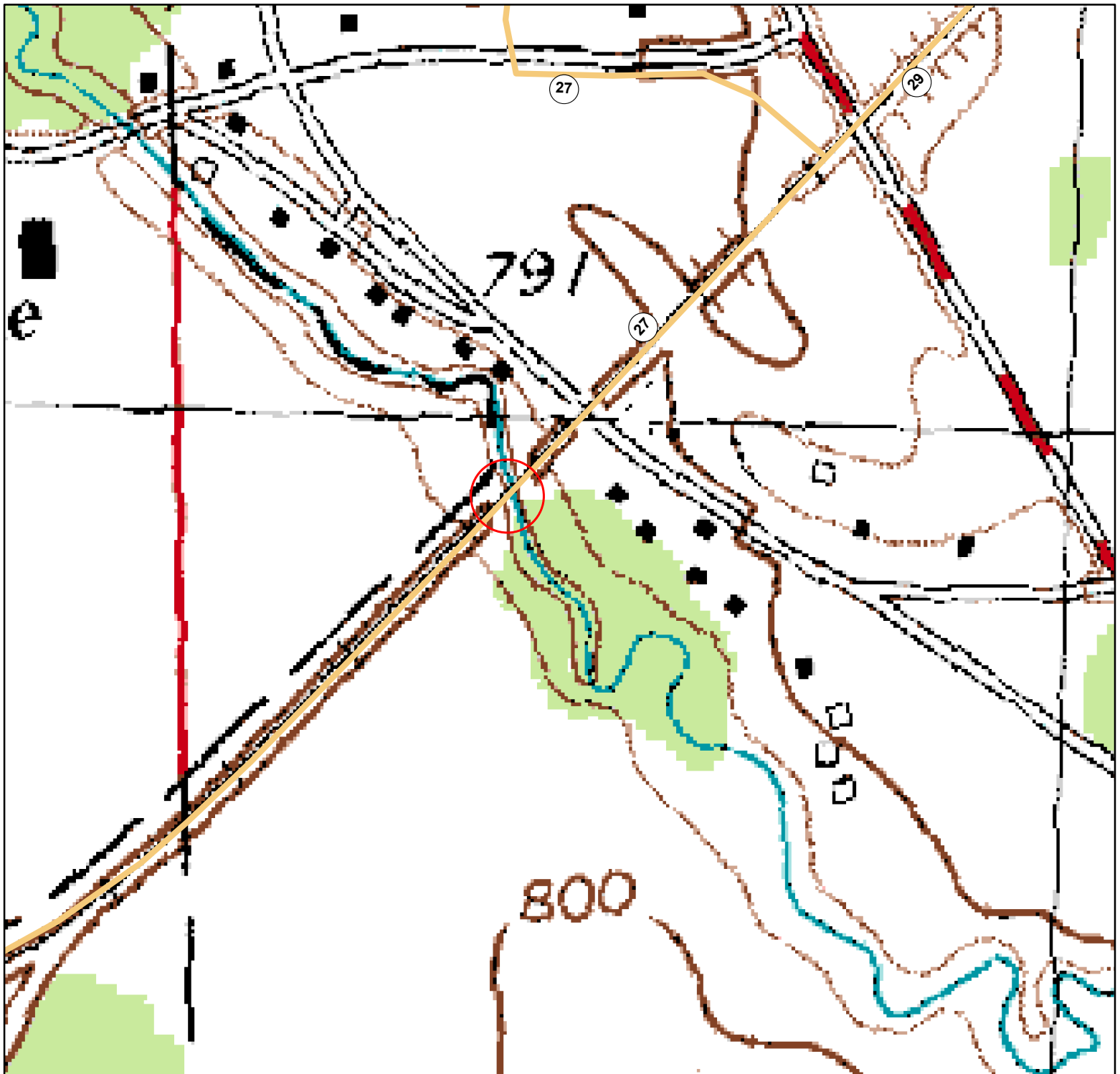

Legend

 Non_funded_trails

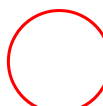
 Farmers Valley Creek Bridge

 MonroeGIS.GIS.SnowmobileTrail



0 0.0375 0.075 0.15 Miles



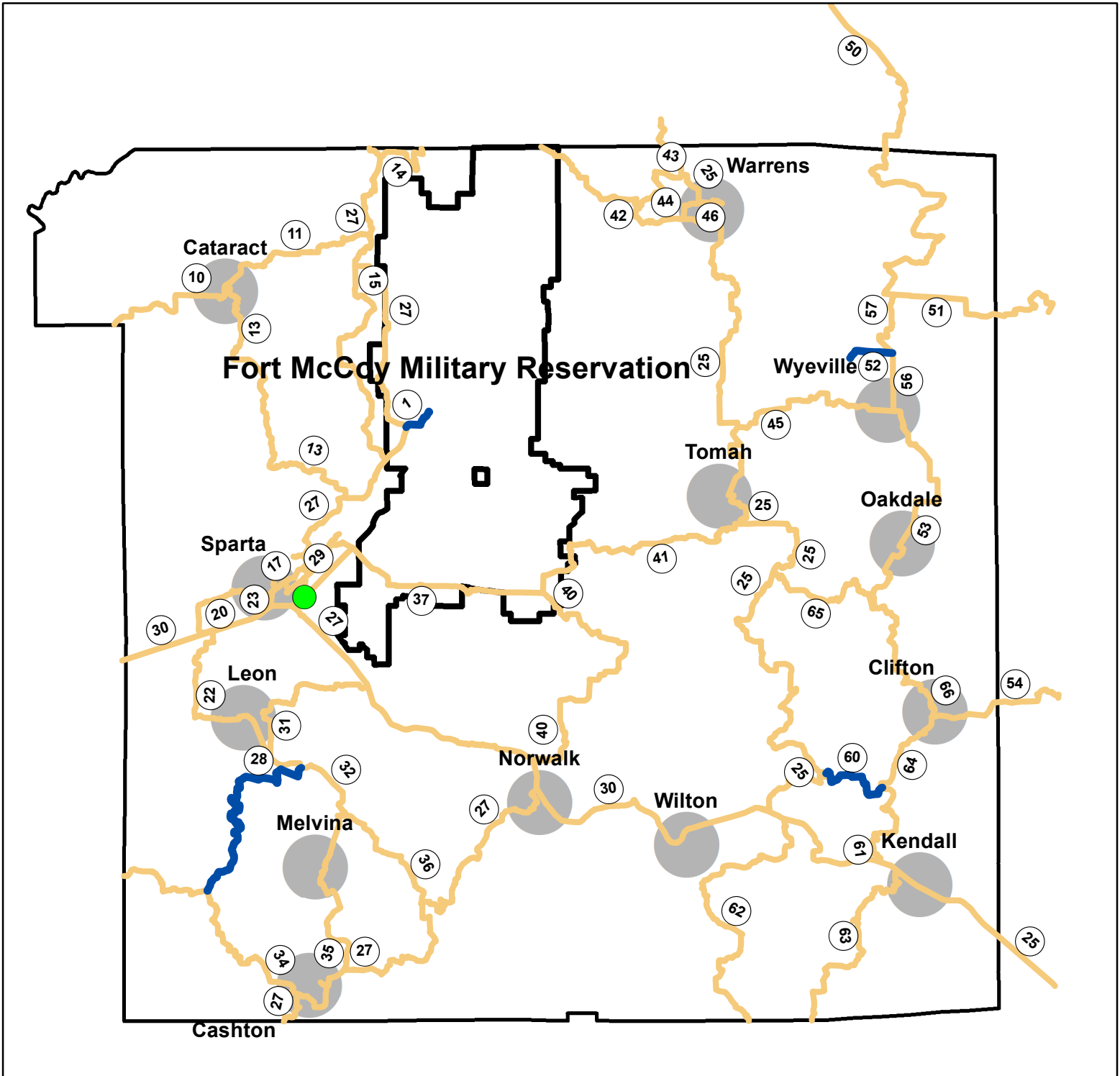

Monroe County Snowmobile Trails

Farmers Valley Creek Bridge



Legend

-  Non_funded_trails
-  Farmers Valley Creek Bridge
-  MonroeGIS.GIS.SnowmobileTrail

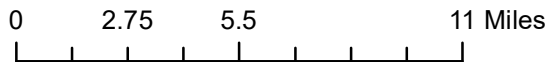

Monroe County Snowmobile Trails

Farmers Valley Creek Bridge - Wetland Map

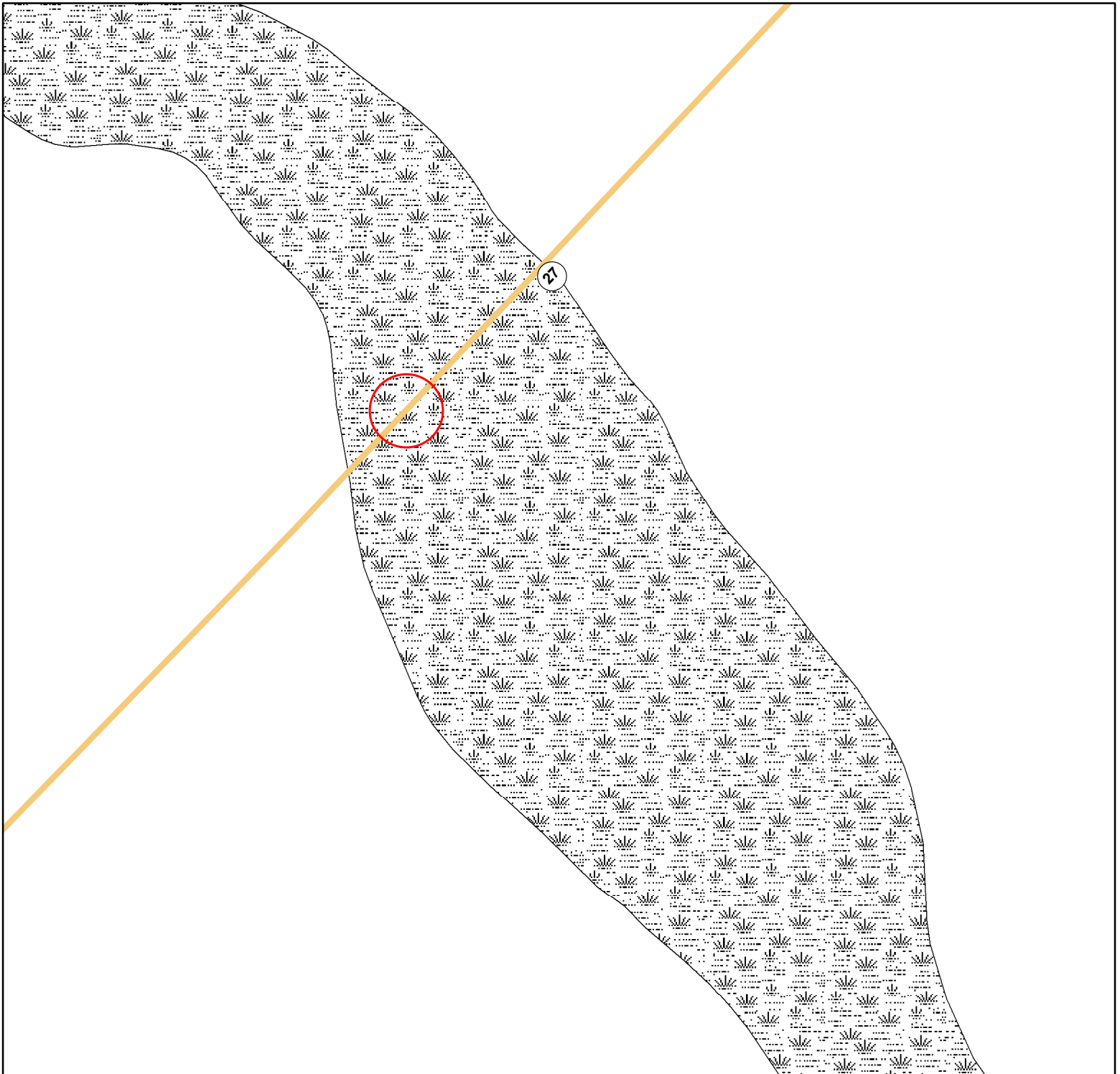

Legend

 Non_funded_trails

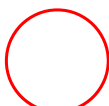
 Farmers Valley Creek Bridge

 MonroeGIS.GIS.SnowmobileTrail



0 0.0125 0.025 0.05 Miles



Monroe County Snowmobile Trails

Farmers Valley Creek Bridge



Legend

 Non_funded_trails

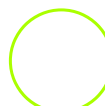
 Farmers Valley Creek Bridge

 MonroeGIS.GIS.SnowmobileTrail



0 0.0125 0.025 0.05 Miles



