

#62 Price Co Solberg Campground Expansion

State of Wisconsin
 Department of Natural Resources
dnr.wi.gov

Motorized Recreation Grant Application

For: (choose all that apply)

Form 8700-159 (R 04/22)

Page 1 of 5

ATV/UTV Trail Aid

Snowmobile Trail Aid

Due Date: April 15

Notice: Completion of this form is required under Wisconsin Statutes 23.09(26) and 23.33. Failure to complete this form will result in denial of financial assistance. Personally identifiable information found on this form is not intended to be used for any other purpose. The Department of Natural Resources (DNR) may provide this information to requesters as required by Wisconsin's Public Records law {ss. 19.31 – 19.39, Wis. Stats.}.

Instructions: Applications may combine more than one source of funds. They may be submitted for consideration of traditional ATV, UTV, Snowmobile and Motorized Stewardship funding. Submit one copy of all forms and attachments. See Page 2 for necessary attachments. Send applications to your [Community Services Specialist](#).

DNR Use Only	
Category	Number

Section 1: Applicant Information

Applicant / Organization Name Price County Forestry and Parks Department			Check Recipient: Individual other than authorized individual to act on behalf of the applicant. <input type="checkbox"/> Select if the same as applicant.		
Individual Authorized to Act on Behalf of Applicant per Resolution Fred Freeman			Check Recipient Name (Name to Appear on Check) Price County Treasurer		
Title Assistant Forest Administrator/ATV Coordinator			Title Price County Treasurer		
Address 104 S. Eyder Ave			Address 126 Cherry Street		
City Phillips	State WI	ZIP Code 54555	City Phillips	State WI	ZIP Code 54555
Telephone Number (715) 339-6371		Email Address Frederick.freeman@co.price.wi.us			

Section 2: Project Information Required for all Projects

Project Title Solberg Lake Park ATV Trail				Current Funded Miles	New Miles (if applicable) 2.37
County Price	Township 38 N	Range 1	Section <input checked="" type="radio"/> E <input type="radio"/> W	GPS Coordinates: Lat. 45.768027 Long. -90.370082	

Project Description Summary

The goal of this project is to connect the Solberg ATV/UTV trail to the Solberg Lake Campground. The project will include developing a new spring/summer/fall ATV/UTV trail segment while also developing camping/park facilities. The trail will be 2.3 miles and will include one bridge over the Aabajiwani-ziubiinsing creek. The campground area will include 40 total camp sites.

This project has been broken into two projects:

New Trail: \$378,150

Campground Expansion: \$1,019,615 ***

I certify that all maintenance land use agreements are on file.

Estimated Cost

Maintenance	Acquisition	Insurance	Development	Bridge Rehab.	Trail Rehab.	Total Estimated Cost
			\$1,397,765.00			\$1,397,765.00
Leave Blank – DNR Use Only						
						\$1,019,615.00

Applicant Certification

Printed Name of Authorized Official Fred Freeman	Official's Title Assistant Forest Administrator/ATV Coordinator
---	--

As the applicant's authorized official, I certify that, to the best of my knowledge, the information in this application is true and correct.



 Signature of Authorized Official

4/12/23

 Date Prepared

Appendix B – Required for Trail/Qualified Trout Rehab, Reroute, or Development

Trail Rehab Qualified Trout New Trail Trail Reroute (Mandatory or Discretionary)

County	Township	Range	<input checked="" type="radio"/> E <input type="radio"/> W	Section	1/4	1/4	GPS Coordinates: Lat. 45.768027 Long. -90.370082
Price	38 N	1		16			

Funded Trail Name or Number (SNARS if applicable)	Has this trail ever received development or rehabilitation funds in the past? <input type="radio"/> Yes <input checked="" type="radio"/> No Year: _____ \$ _____
---	--

Trail is located on: <input type="radio"/> Private property <input checked="" type="radio"/> Public property	Length of Easement or Landowner Use Agreement _____ years	Expiration Date
---	--	-----------------

Landowner Where Trail is Located Price County	Telephone Number (715) 339-6371
--	------------------------------------

What other recreational trail uses are planned for this trail?
Some areas are winter snowmobile trail. All county land is open to pedestrians.
If there are other Recreational uses planned, how much of the trail development/rehab. cost will be paid for by other users?
0

How many miles would be affected if this project is not funded? 2.3	Will this result in closure of a trail? <input type="radio"/> Yes <input checked="" type="radio"/> No
--	--

Is this a critical section to the overall trail system? <input checked="" type="radio"/> Yes <input type="radio"/> No	Is there a reasonable alternative? ATV's can currently use the town road. The road is busy and has lots of curves.
--	---

Does any section of this trail contain a bridge? <input checked="" type="radio"/> Yes <input type="radio"/> No	Will this bridge require rehabilitation now or in the next few years? <input type="radio"/> Yes <input checked="" type="radio"/> No	What is the weight of your puller & drag/grading equipment? 10,000 lbs.
---	--	--

- Yes No Have you contacted your local [DNR Water Management Specialist \(WMS\)](#) regarding a permit?
- Yes No Is a permit needed? (Please provide any written correspondence from WMS.)
- Yes No Will this project be located near or cross any intermittent or perennial waterway? [Surface Water Data Viewer](#)
- Yes No Will this project be located near or cross any wetland?
- Yes No Will this project involve land disturbance – including clearing and grubbing – of 1 acre or more of land? (Less than 4/10th mile for a typical trail) [DNR Storm Water Contact List](#)

Trail Project Detailed Description

The goal of this project is to connect the Solberg ATV/UTV trail to the Solberg Lake Campground. The project will include developing a new spring/summer/fall ATV/UTV trail segment and developing camping/park facilities. The trail will be 2.3 miles and will include one bridge over the Aabajjiwani-ziibiinsing creek. This bridge will be 80 feet in length and 12 feet wide. 1.2 miles of the new ATV trail will be run on existing woods roads. 1.1 miles of the new ATV trail will need to be created. A small portion of the trail will need to have wetland delineation completed on it. This portion of the ATV trail will be utilizing an existing woods road. The trail surface will be covered in 6" of 3/4 inch crushed gravel for long-term sustainability of the trail. Culverts will be placed along the trail where cross drainage is needed. 2 trail kiosks will be placed with maps giving directions to the Flambeau trail system located on the Chequamegon National Forest. 3 access gates will be placed where the trail crosses Hicks Landing Road (2 gates) and where it attaches to the new campground area (1 gate). 2 unloading ramps will be made, 1 by the ATV parking lot and 1 by the new campground entrance. The park facility upgrades will include 40 new campsites, park access roads, and bathroom/shower facilities on the North side of West Solberg Lake Road. The older portion of Solberg Lake Campground has smaller sites that do not allow for much room to park extra trailers and toy haulers. The new camp sites will be more geared to ATV/UTV riders with wider and longer foot prints. All sites will include water and electric. There will be a flush bathroom and shower facility along with a vaulted toilet.

This project is only for the campground expansion.

Recreation Grant Project Cost Estimate Worksheet

Form 8700-014 (R 02/23)

For use with Recreation Grant Application Forms

Project Name: Solberg Lake Park ATV Trail (Support Facilities)		Prepared By: Fred Freeman	Date 03/29/2023
County Price	Project Applicant: Price County Forestry and Parks	Landowner Name Price County	<input checked="" type="radio"/> Public <input type="radio"/> Private

Indicate - (C) Contract, (F) Force Acct., (D) Donated

	DEVELOPMENT PROJECT ITEMS <i>List by individual item or break down by Use Areas (See Item List On Back Of This Form)</i>	Quantity	Unit of Measure	Component Costs	Estimated Total Item Cost
C					
C					
C					
C	Parking Area, Campground Roads and site gravel	2,680	yards	\$23.00	61,640.00
C	Parking Area and Campground Dozing/Excavating/hauling	290	hours	\$170.00	49,300.00
C	Camp Ground road asphalt	940	tons	\$145.00	136,300.00
C	Seed/Mulch	1		\$4,000.00	4,000.00
C	Flush Toilet/Shower Building	1		\$350,000.00	350,000.00
C	Well	1		\$15,000.00	15,000.00
C	Septic	1		\$15,000.00	15,000.00
C	Vault Toilet	1		\$65,000.00	65,000.00
C	Price Electric power hookup -- main power to campground	1		\$35,000.00	35,000.00
C	Camp Site Power	40		\$2,800.00	112,000.00
C	Camp Site Water	40		\$1,000.00	40,000.00
C	Camp Site Fish Table	40		\$120.00	4,800.00
C	Camp Site Picnic Table	40		\$675.00	27,000.00
C	Camp Site Fire Ring	40		\$420.00	16,800.00
C	Camp Site Marker	40		\$35.00	1,400.00
C	Electrical Hookup and Security Lighting -- power to sites	1		\$35,000.00	35,000.00
C					
F	Price County and Town of Worcester Equipment	75		\$65.00	4,875.00
F	Price County and Town of Worcester Employee wage	330		\$50.00	16,500.00
C	Engineering Fee	1		\$30,000.00	30,000.00
C					
				TOTAL \$	\$1,019,615.00

NOTE:

- For development projects, contingency and indirect costs are not eligible expenses.
- For acquisition projects, complete the Acquisition Project Cost Estimate Section of this form.

Solberg Lake Park ATV Trail

T38N R1E Town of Worcester

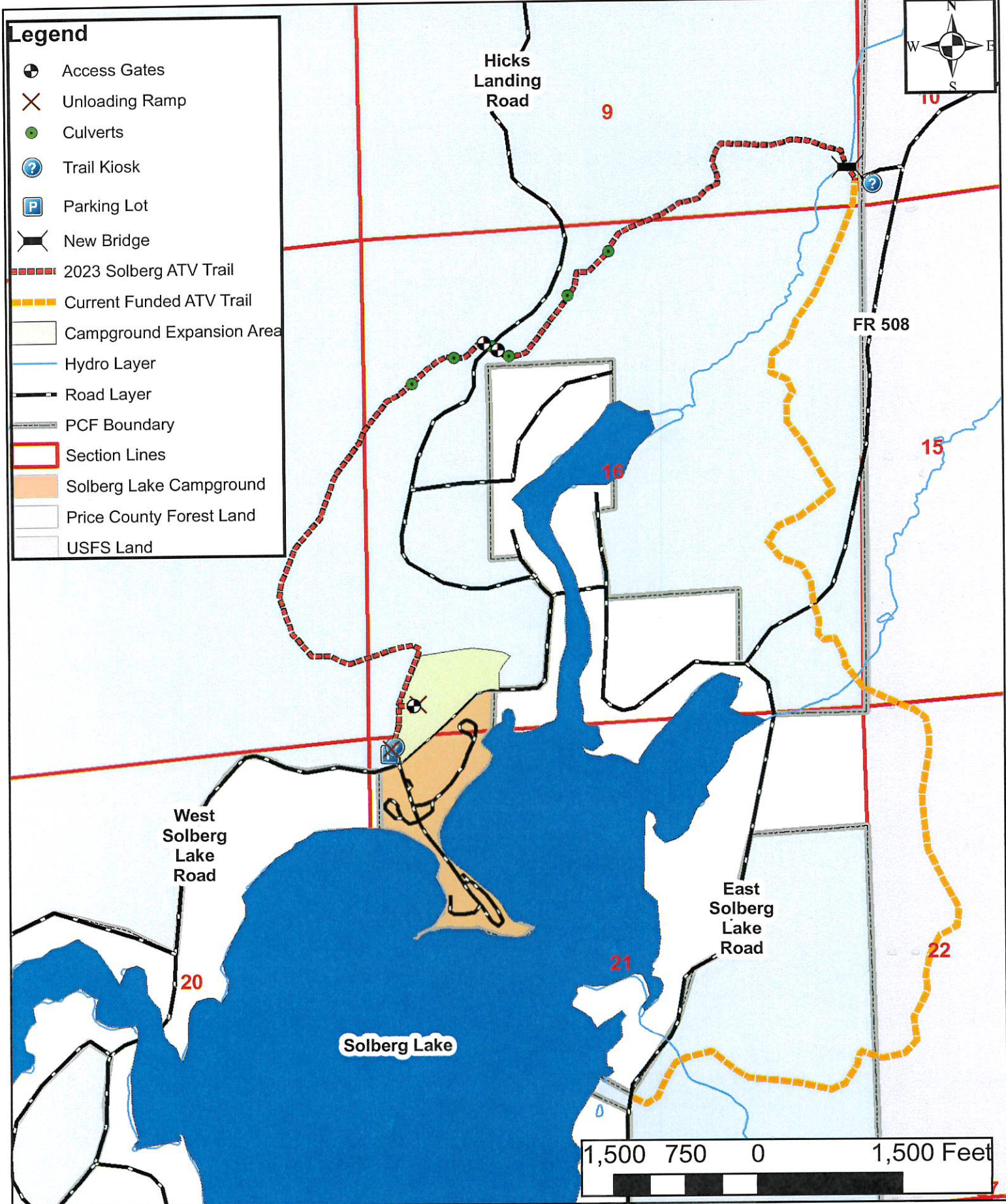

Solberg Lake ATV Trail Campground Expansion

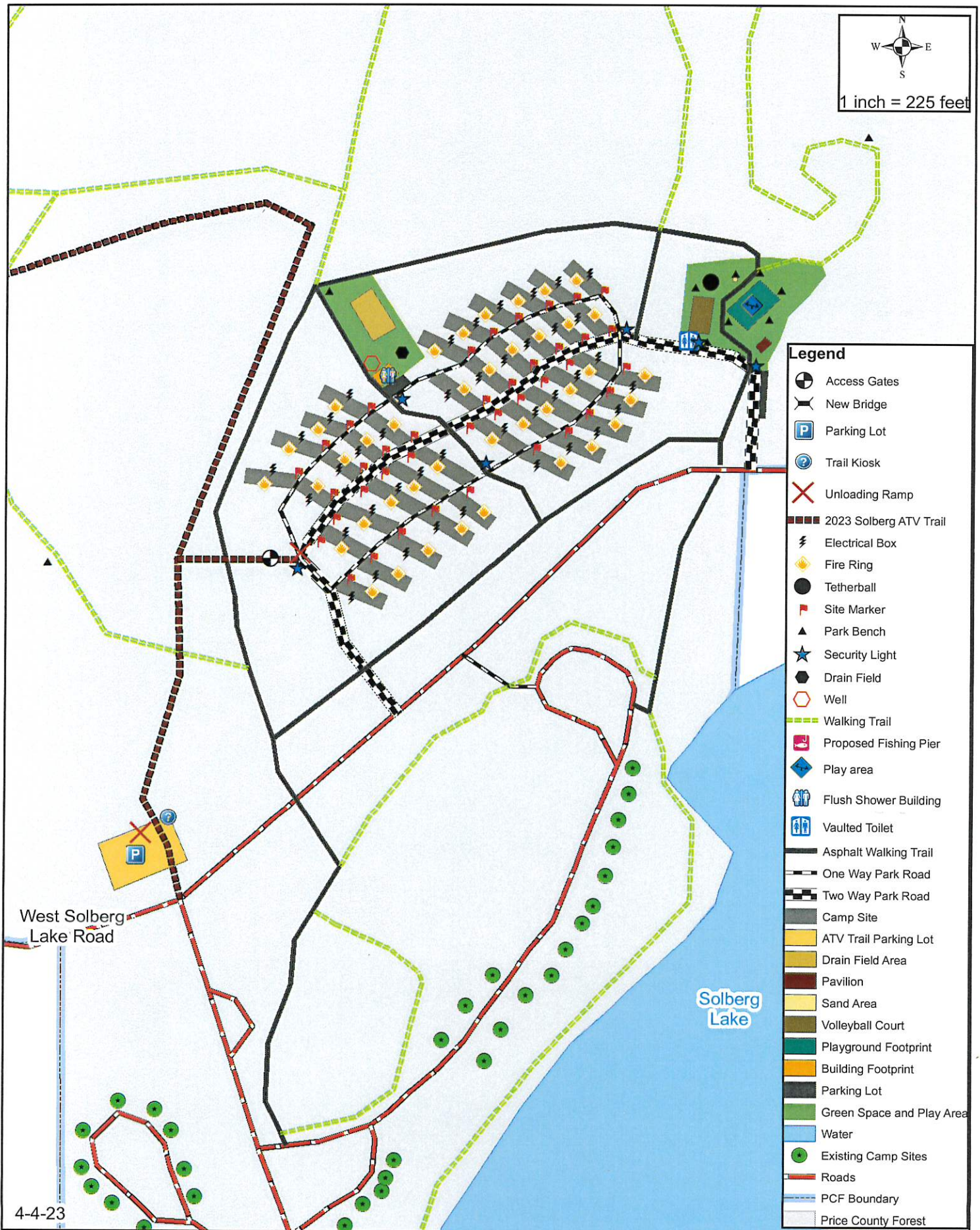

Solberg Lake ATV Trail Campground Expansion

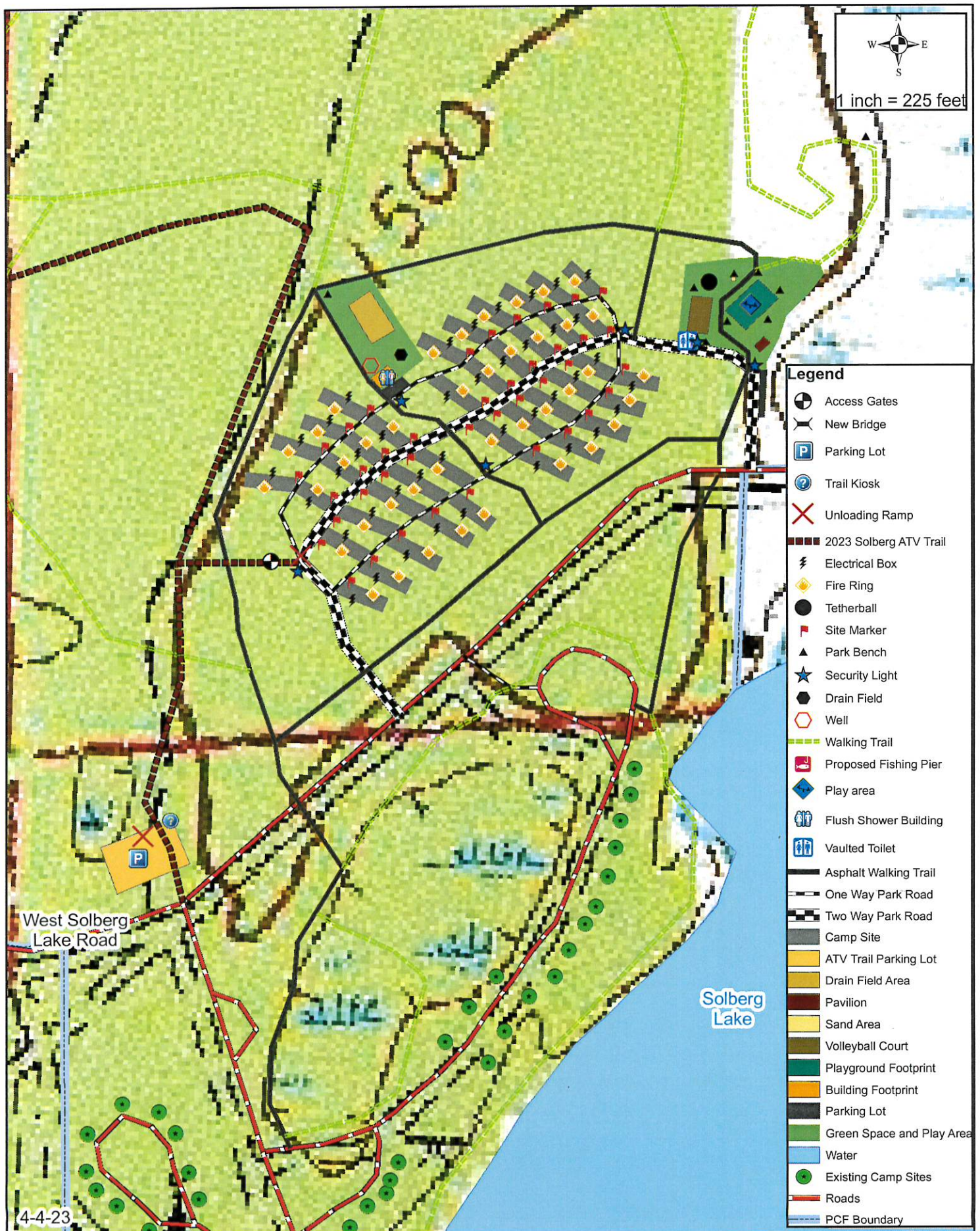

Price County ATV Trails

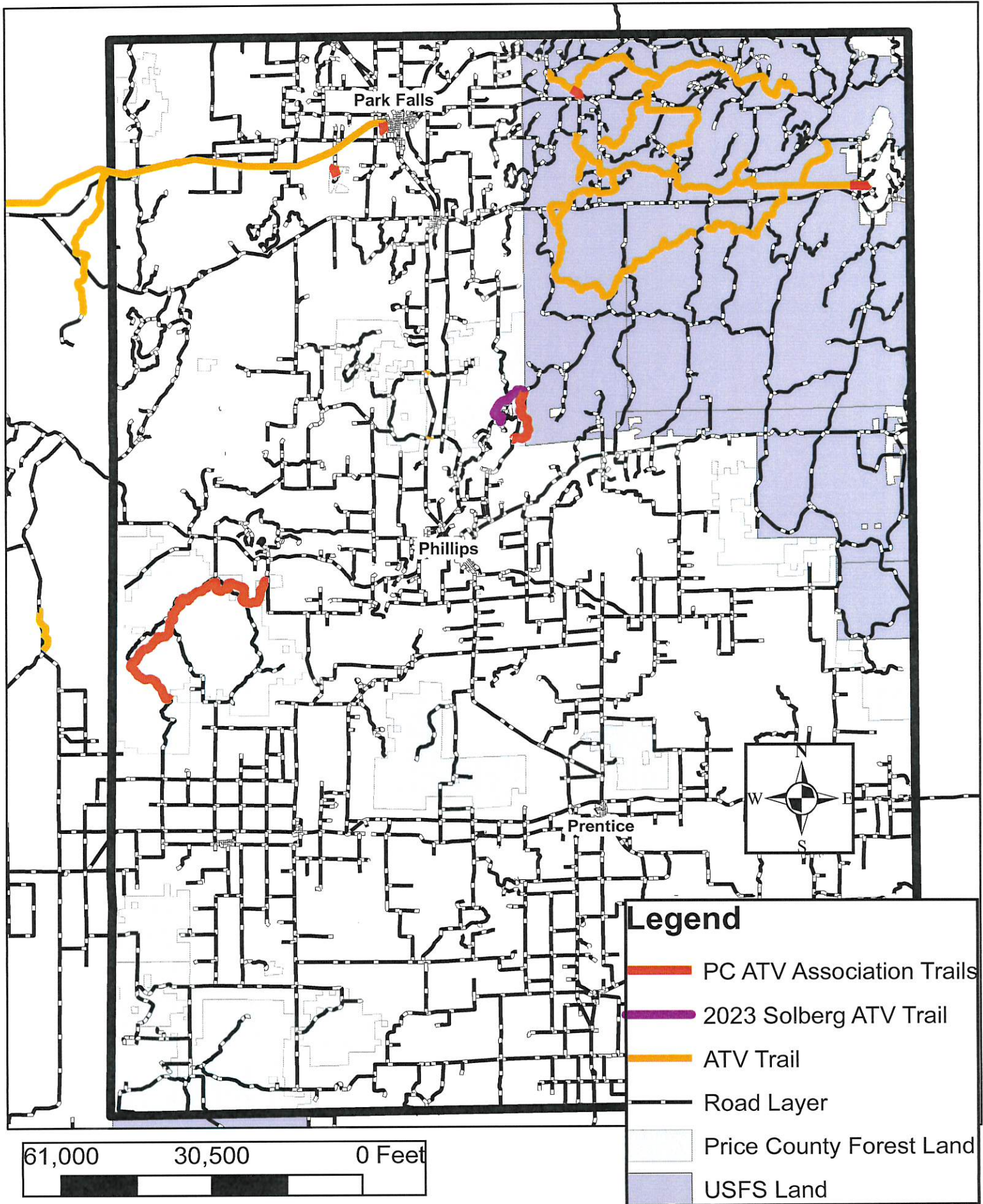

Solberg Lake County Park & Campground



Documents

[Directions to Solberg Lake Park and Campground](#)

[Solberg Lake Park Map](#)

[Solberg Lake Shelter Reservation Form](#)

[Solberg Lake Walking Trails](#)



Solberg Lake County Park & Campground

N10750 County Park Road
Phillips, WI 54555

Contact

Ph: 715-339-6371

Rating

5 average based on 3 votes

Park Overview

This is a premier northwoods campground and day-use park located on a 35-acre peninsula extending into Solberg Lake. This 60-unit campground (20+ lakeside campsites) accommodates RV's, trailers, tent trailers and tents. Solberg Lake is perfect for fishing, water skiing and swimming. There is a beautiful beach on the southern most point surrounded by red pine.

Facilities

- 60-unit campground, all sites with electrical hookups, open year-round (please be advised that roads are not plowed during winter months)
- Firewood is provided in eight foot lengths (personal saw is needed to cut into firewood length)
- ATV/UTV trail access to the Solberg Trail which connects to the Flambeau Trail System
- Fishing pier
- Nature / hiking trail and snowmobile trail
- Open air shelter with electricity (to reserve call 715-339-6371 - fee required - \$50)
- Paved boat ramp, boat dock
- Paved road and parking area
- Picnic area, tables and grills
- Playground equipment
- Pressure water (faucet and drinking fountain), mid-April/May through September/late-October, weather permitting

- Sand beach
- Sand volleyball court, horseshoe pit (must provide own volleyball and horseshoes)
- Sanitary dump station, open when the water is turned on (mid-April/May through September/late-October, weather permitting) - use fee (quarters are required)
- Sites have a picnic table, prep/storage table and fire ring
- Two shower / flush toilet buildings (mid-April/May thru September/mid- to late-October, weather permitting), \$.25 for 2 minute shower

Rules

- Camping fee required - \$30 includes electric
- All campsites are ATV accessible. Keep ATVs in campsites and on the park roads only.
- Campsites cannot be reserved
- Caretaker on site Memorial Day weekend thru Labor Day weekend
- Check-out time is 2 p.m., 30-day limit at any one site
- Pet requirements: must be under control or on a leash at all times - not allowed near swimming area or in buildings

[▲ Back to top](#)