

# 59 Polk Co New Intensive Use Area

State of Wisconsin  
 Department of Natural Resources  
[dnr.wi.gov](http://dnr.wi.gov)

**Motorized Recreation Grant Application**

For: (choose all that apply)

Form 8700-159 (R 04/22)

Page 1 of 5

Due Date: April 15

ATV/UTV Trail Aid

Snowmobile Trail Aid

**Notice:** Completion of this form is required under Wisconsin Statutes 23.09(26) and 23.33. Failure to complete this form will result in denial of financial assistance. Personally identifiable information found on this form is not intended to be used for any other purpose. The Department of Natural Resources (DNR) may provide this information to requesters as required by Wisconsin's Public Records law {ss. 19.31 – 19.39, Wis. Stats.}.

**Instructions:** Applications may combine more than one source of funds. They may be submitted for consideration of traditional ATV, UTV, Snowmobile and Motorized Stewardship funding. Submit one copy of all forms and attachments. See Page 2 for necessary attachments. Send applications to your [Community Services Specialist](#).

DNR Use Only	
Category	Number

**Section 1: Applicant Information**

Applicant / Organization Name			Check Recipient: Individual other than authorized individual to act on behalf of the applicant. <input type="checkbox"/> Select if the same as applicant.		
Polk County					
Individual Authorized to Act on Behalf of Applicant per Resolution			Check Recipient Name (Name to Appear on Check)		
Brent Sisko					
Title			Title		
Forest Administrator					
Address			Address		
100 Polk Plaza					
City	State	ZIP Code	City	State	ZIP Code
Balsam Lake	WI	54810			
Telephone Number		Email Address			
(715) 554-0248		brent.sisko@polkcountywi.gov			

**Section 2: Project Information Required for all Projects**

Project Title					Current Funded Miles	New Miles (if applicable)
Polk County ATV/UTV Intensive Use Area						
County	Township	Range	Section	¼ ¼	¼	GPS Coordinates:
Polk	36 N	20	23		NE	Lat. _____ Long. _____

**Project Description Summary**

Polk County is proposing the development of a 60 acre ATV/UTV Intensive Use Area located in the Town of Sterling. The proposal comprises of the following:  
 0.6 mi beginner course, 0.6 mi. challenge course (with obstacles), 1.25 mi. ATV/UTV Track (with humps, bumps, corners), 1.25 acre sand pit, perimeter fencing, associated gates, and signage.

I certify that all maintenance land use agreements are on file.

**Estimated Cost**

Maintenance	Acquisition	Insurance	Development	Bridge Rehab.	Trail Rehab.	Total Estimated Cost
			\$ 316,940.00			\$ 316,940.00

Leave Blank – DNR Use Only

--	--	--	--	--	--	--

**Applicant Certification**

Printed Name of Authorized Official	Official's Title
Brent Sisko	Polk County Forest Administrator / Parks Assistant

As the applicant's authorized official, I certify that, to the best of my knowledge, the information in this application is true and correct.

  
 Signature of Authorized Official

4/11/23  
 Date Prepared

**Appendix B – Required for Trail/Qualified Trout Rehab, Reroute, or Development**

Trail Rehab       Qualified Trout       New Trail       Trail Reroute (Mandatory or Discretionary)

County	Township	Range	<input type="radio"/> E <input checked="" type="radio"/> W	Section	1/4 1/4	1/4	GPS Coordinates: Lat. Long.
Polk	36 N	20		23			

Funded Trail Name or Number (SNARS if applicable)	Has this trail ever received development or rehabilitation funds in the past?
N/A	<input type="radio"/> Yes <input checked="" type="radio"/> No    Year: _____ \$ _____

Trail is located on: <input type="radio"/> Private property <input checked="" type="radio"/> Public property	Length of Easement or Landowner Use Agreement _____ years	Expiration Date
---	--	-----------------

Landowner Where Trail is Located	Telephone Number
Polk County Forest	(715) 554-0248

What other recreational trail uses are planned for this trail?

**Intensive Use Area Only**

If there are other Recreational uses planned, how much of the trail development/rehab. cost will be paid for by other users?

**ATV/UTV Only. No other funding**

How many miles would be affected if this project is not funded?	Will this result in closure of a trail? <input type="radio"/> Yes <input checked="" type="radio"/> No
---	--

Is this a critical section to the overall trail system? <input type="radio"/> Yes <input checked="" type="radio"/> No	Is there a reasonable alternative? If funding is not approved, project will likely not move forward.
--	---

Does any section of this trail contain a bridge? <input type="radio"/> Yes <input checked="" type="radio"/> No	Will this bridge require rehabilitation now or in the next few years? <input type="radio"/> Yes <input checked="" type="radio"/> No	What is the weight of your puller & drag/grading equipment? _____ lbs.
---	--	---

- Yes    No    Have you contacted your local [DNR Water Management Specialist \(WMS\)](#) regarding a permit?
- Yes    No    Is a permit needed? (Please provide any written correspondence from WMS.)
- Yes    No    Will this project be located near or cross any intermittent or perennial waterway? [Surface Water Data Viewer](#)
- Yes    No    Will this project be located near or cross any wetland?
- Yes    No    Will this project involve land disturbance – including clearing and grubbing – of 1 acre or more of land? (Less than 4/10th mile for a typical trail) [DNR Storm Water Contact List](#)

**Trail Project Detailed Description**

Polk County is proposing the development of a 60 acre ATV/UTV Intensive Use Area located in the Town of Sterling. Pre-approval engineering was completed in conjunction with SEH consulting services to meet the deadline period for this application. If the grant application was to be rewarded, Polk County would start implementation as soon as possible.

Please see attached for all the supporting documentation to accompany the application requirements.

- Maps and detailed project descriptions
- Site Plans
- Construction Plans
- Certificate of Permit Coverage-Construction Site Storm Water Runoff
- Lupine Survey
- Evaluation for Wetland Technical Memo

\*In addition, Polk County will submit a Lupine Survey in the Spring of 2023 on an additional 20 acres. This 20 acre expansion from the original 40 acre proposal was added to the scope of the project when a Lupine Survey could no longer be completed by SEH due to time of year.



# CONSTRUCTION PLANS FOR:

# POLK COUNTY

# ATV/UTV INTENSIVE

# USE PARK

## TOWN OF STERLING, POLK CO, WISCONSIN

EXISTING	
	RIGHT OF WAY
	PERMANENT EASEMENT
	PROPERTY LINE
	HORIZONTAL CONTROL POINT
	BENCHMARK
	SURVEY MARKER
	SOIL BORING
	SANITARY SEWER AND MANHOLE
	FORCE MAIN AND LIFT STATION
	SANITARY SEWER SERVICE & CLEANOUT
	WATER MAIN, HYDRANT, VALVE AND MANHOLE
	WATER SERVICE AND CURB STOP BOX
	STORM SEWER, MANHOLE AND CATCH BASIN
	CULVERT AND APRON ENDWALL
	GAS MAIN, VALVE, VENT AND METER
	HANDHOLE
	BURIED FIBER OPTIC CABLE AND MANHOLE
	BURIED PHONE CABLE, PEDESTAL AND MANHOLE
	BURIED TV CABLE, PEDESTAL AND MANHOLE
	BURIED ELECTRIC CABLE, PEDESTAL, MANHOLE, TRANSFORMER AND METER
	OVERHEAD WIRE, POLE AND GUY WIRE
	LIGHT POLE
	TRAFFIC SIGNAL
	STREET NAME SIGN
	SIGN (NON STREET NAME)
	RAILROAD TRACKS
	DECIDUOUS AND CONIFEROUS TREE
	BUSH / SHRUB AND STUMP
	EDGE OF WOODED AREA
	WETLAND
	BUILDING
	FENCE (UNIDENTIFIED)
	BARBED WIRE FENCE
	CHAIN LINK FENCE
	ELECTRIC WIRE FENCE
	WOOD FENCE
	WOVEN WIRE FENCE
	PLATE BEAM GUARDRAIL
	CABLE GUARDRAIL
	POST / BOLLARD
	RETAINING WALL
	PROPOSED STREET CENTERLINE
	RIGHT-OF-WAY
	PERMANENT EASEMENT
	TEMPORARY EASEMENT
	CONSTRUCTION LIMITS
	SANITARY SEWER, BULKHEAD AND MANHOLE
	FORCE MAIN
	SANITARY SERVICE AND CLEANOUT
	WATER MAIN, TEE, HYDRANT, BULKHEAD AND VALVE
	WATER VALVE MANHOLE, REDUCER, BEND AND CROSS
	WATER SERVICE AND CURB STOP BOX
	STORM SEWER, MANHOLE AND CATCH BASIN
	CULVERT AND APRON ENDWALL
	DRAIN TILE
	DITCH / SWALE
	RIPRAP
	STREET NAME SIGN
	SIGN (NON STREET NAME)
	RETAINING WALL

### INDEX

SHEET NO.	DESCRIPTION
1	TITLE SHEET
2	PROJECT OVERVIEW
3	TYPICAL SECTIONS
4	DETAILS
5	SIGNING AND FENCING PLAN
6	EROSION CONTROL PLAN
7	CHALLENGE COURSE OBSTACLE DETAILS
8	CHALLENGE COURSE LAYOUT
9	BEGINNERS COURSE - ATV/UTV TRACK FEATURES
10	BEGINNERS COURSE LAYOUT
11	ATV/UTV TRACK LAYOUT
12-21	PROFILE VIEWS

THIS PLAN CONTAINS 21 SHEETS.

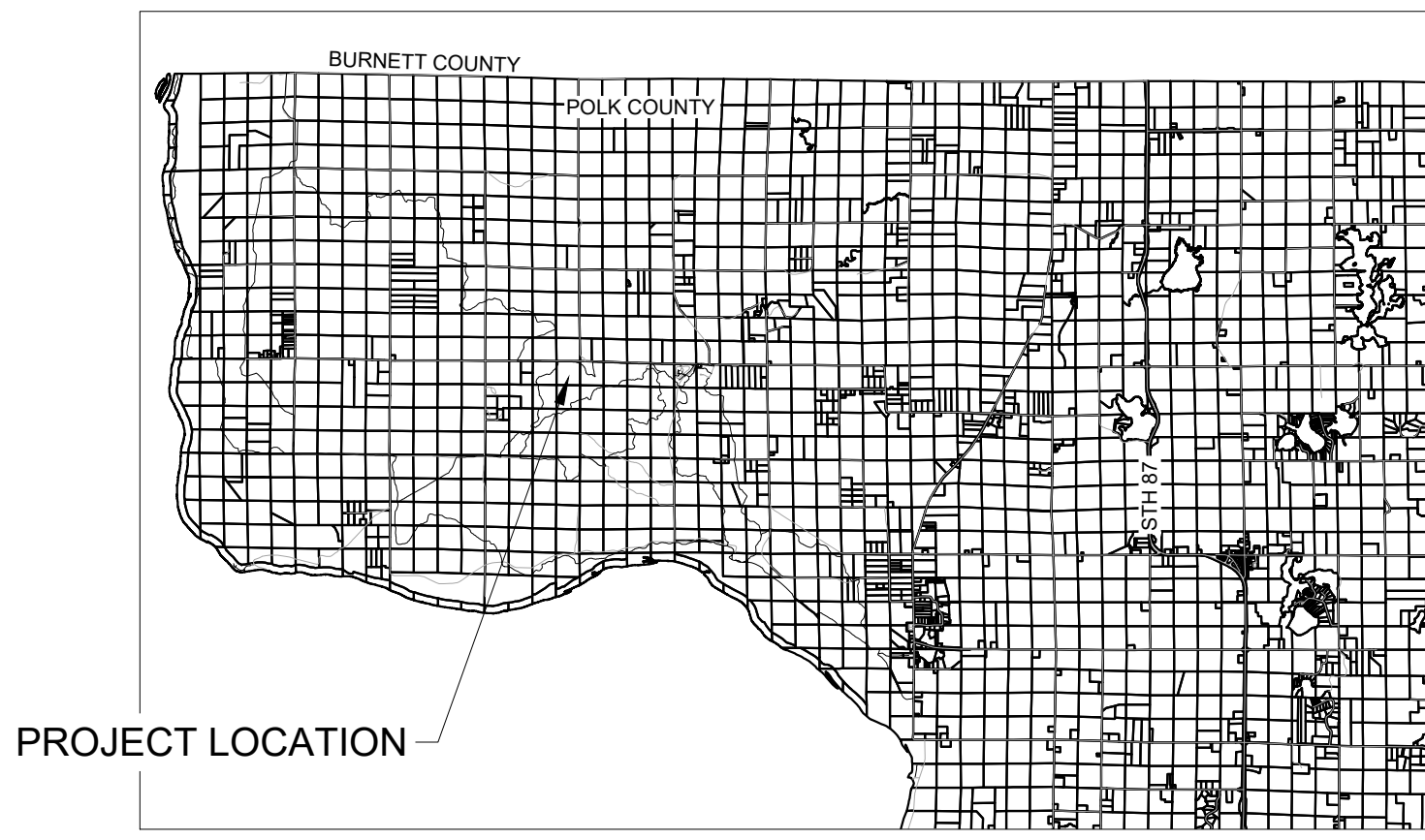
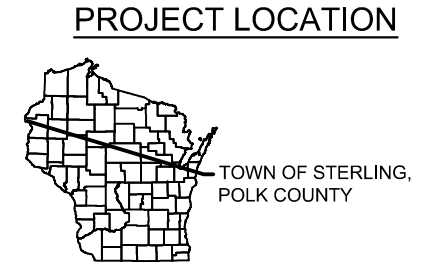

N.T.S.



POLK COUNTY, WISCONSIN

NOTE:  
THE SUBSURFACE UTILITY QUALITY INFORMATION IN THIS PLAN IS LEVEL D. THIS UTILITY QUALITY LEVEL WAS DETERMINED ACCORDING TO THE GUIDELINES OF C/ASCE 38-02 ENTITLED "STANDARD GUIDELINES FOR THE COLLECTION AND DEPICTION OF EXISTING SUBSURFACE UTILITY DATA."

THE CONTRACTOR SHALL CALL THE WISCONSIN ONE CALL SYSTEM AT 811 BEFORE COMMENCING EXCAVATION.



**SEH**  
PHONE: 414.465.1200  
316 NORTH MILWAUKEE STREET  
SUITE 302  
MILWAUKEE, WI 53202-5888  
www.sehinc.com

FILE NO.  
POLPW  
168092

1  
of 21

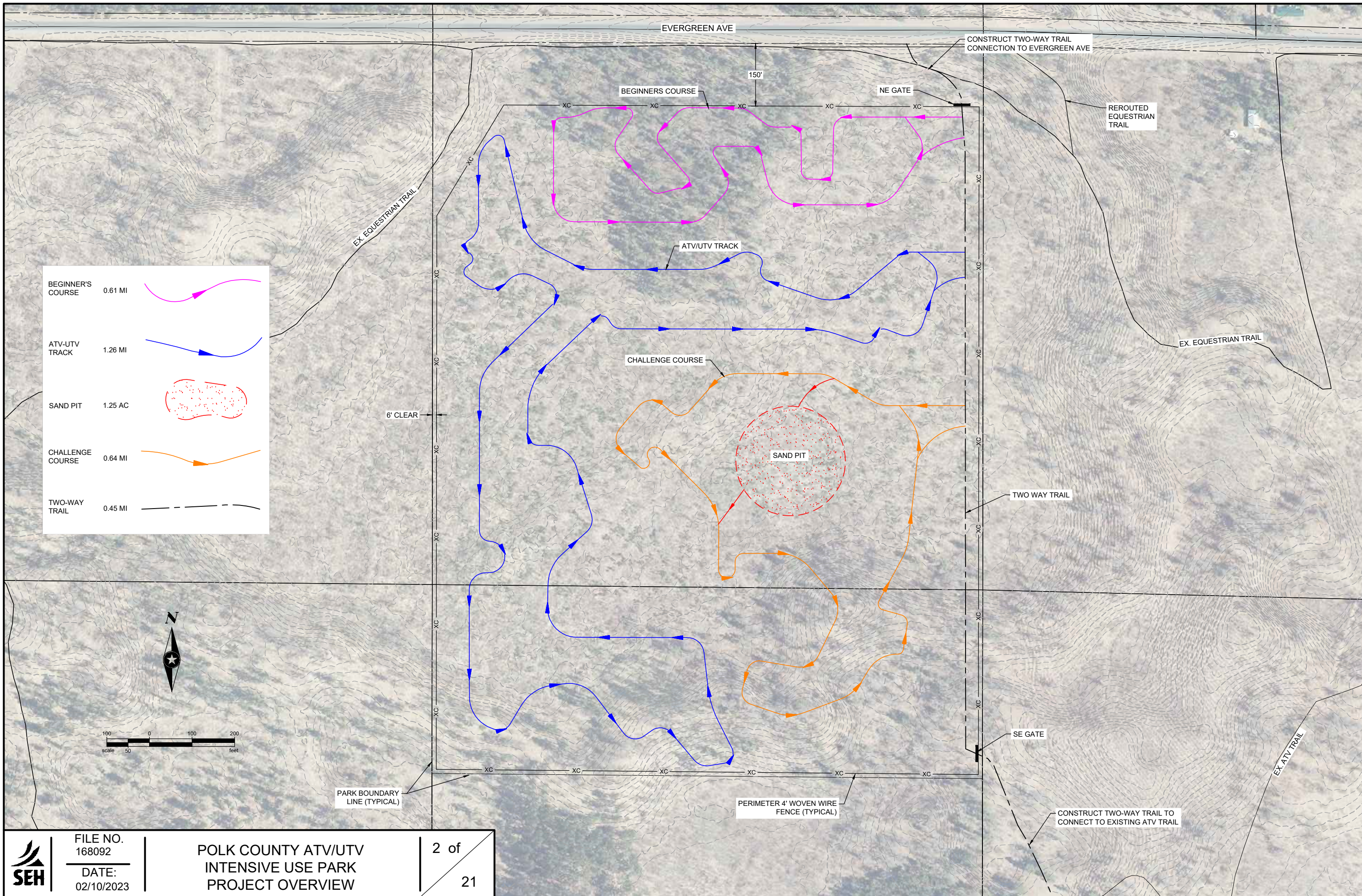

FILE NO.  
168092  
DATE:  
02/10/2023

POLK COUNTY ATV/UTV  
INTENSIVE USE PARK  
PROJECT OVERVIEW

2 of  
21

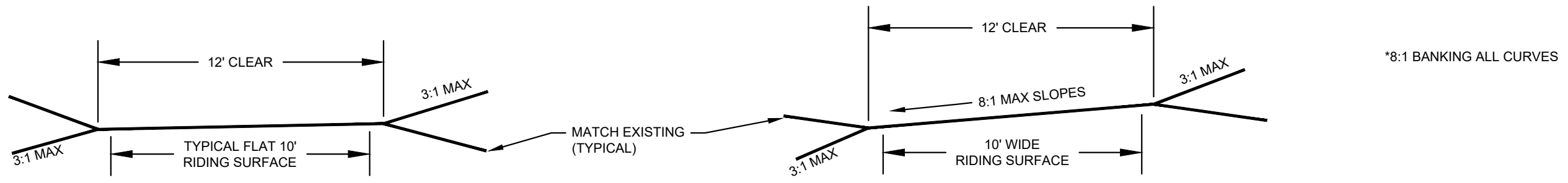

**BEGINNER'S COURSE TYPICAL**

**BEGINNER'S COURSE CURVE TYPICAL**

\*8:1 BANKING ALL CURVES

**NOTE**  
CLEARING LIMITS WIDER AS REQUIRED  
FOR 3:1 CUT/FILL SLOPES ON HILLSIDES  
AND BANKING/JUMP FEATURE AREAS

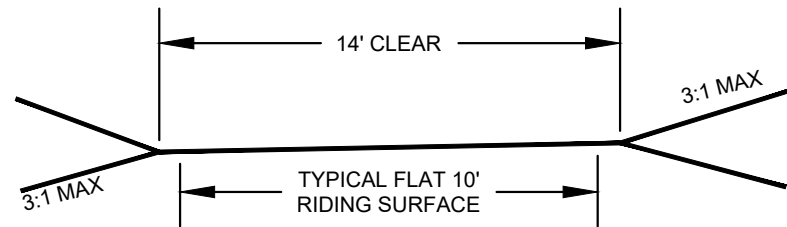

**CHALLENGE COURSE TYPICAL**

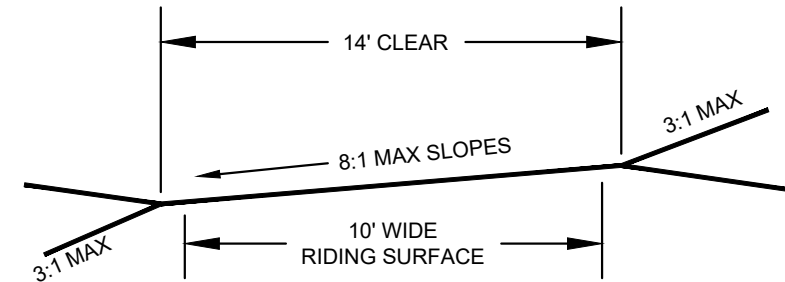

**CHALLENGE COURSE CURVE TYPICAL**

\*8:1 BANKING ALL CURVES

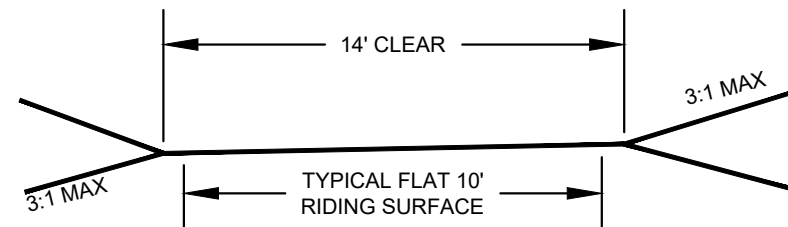

**ATV/UTV TRACK TYPICAL**

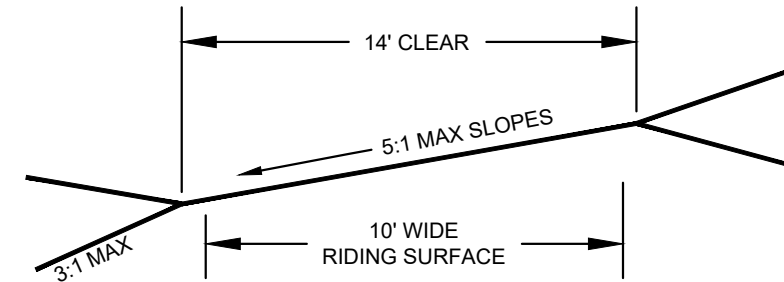

**ATV/UTV TRACK CURVE TYPICAL**

\*MB=5:1 MAX BANKING FOR SHARP CURVES  
\*HB=10:1 HALF BANKING FOR GRADUAL CURVES

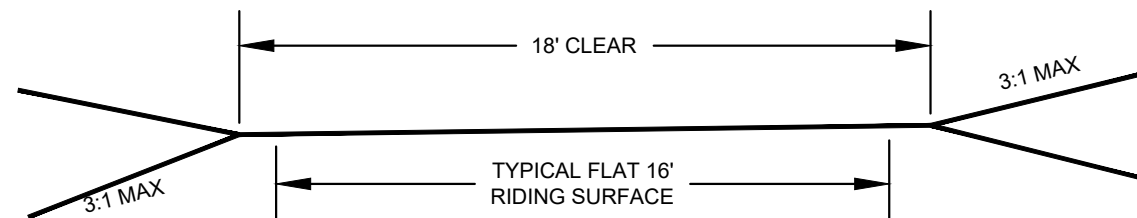

**TWO-WAY TRAIL TYPICAL**

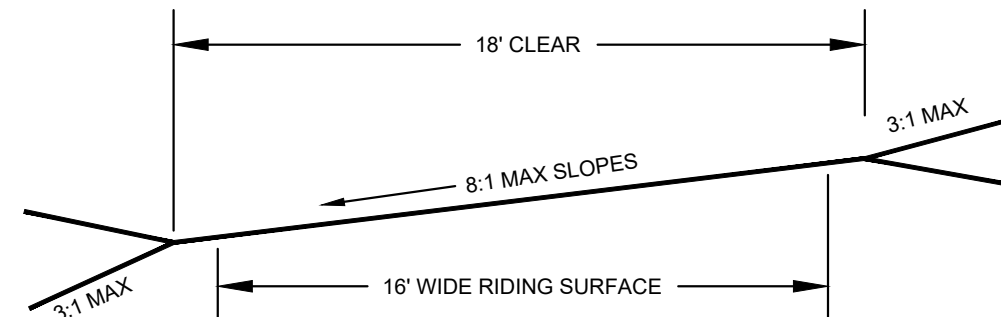

**TWO-WAY TRAIL CURVE TYPICAL**

\*8:1 BANKING ALL CURVES

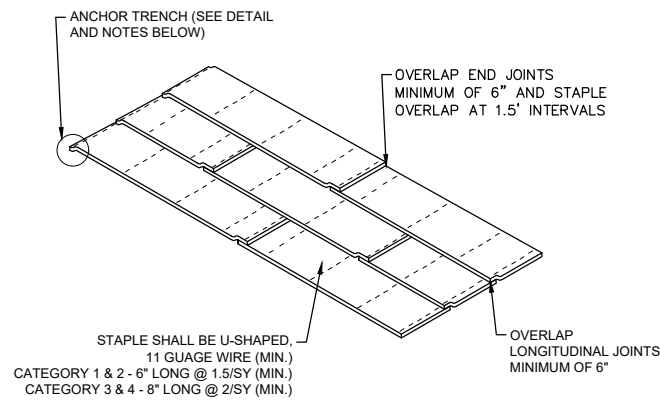

- ANCHOR TRENCH**
1. DIG 6" X 6" TRENCH
  2. LAY BLANKET IN TRENCH
  3. STAPLE AT 1.5' INTERVALS
  4. BACKFILL WITH NATURAL SOIL AND COMPACT
  5. BLANKET LENGTH SHALL NOT EXCEED 100' WITHOUT AN ANCHOR TRENCH

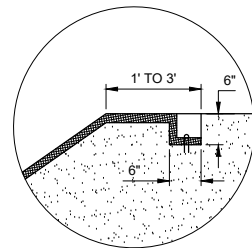

NTS

DESIGN GUIDELINES:  
(SEE MNDOT SPEC.  
2573.3C AND 3886)

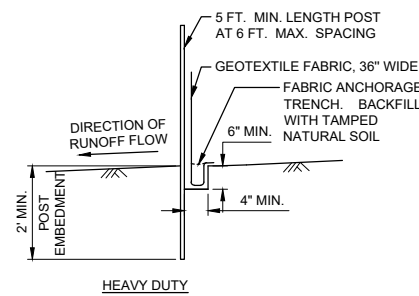
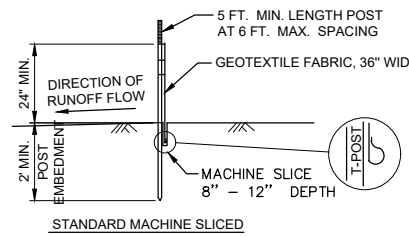
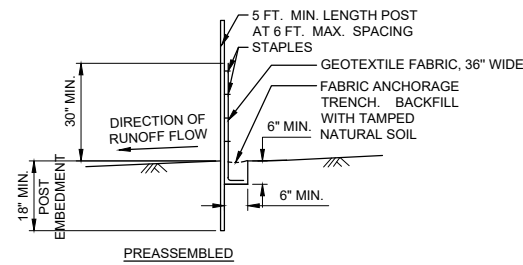

NTS

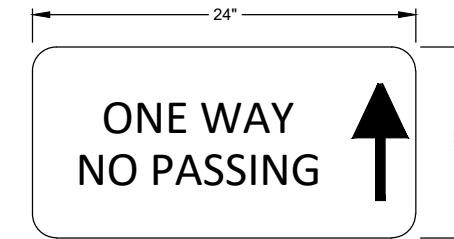

TYPICAL SIGN DETAIL

**EROSION CONTROL BLANKET INSTALLATION**

**SILT FENCE**

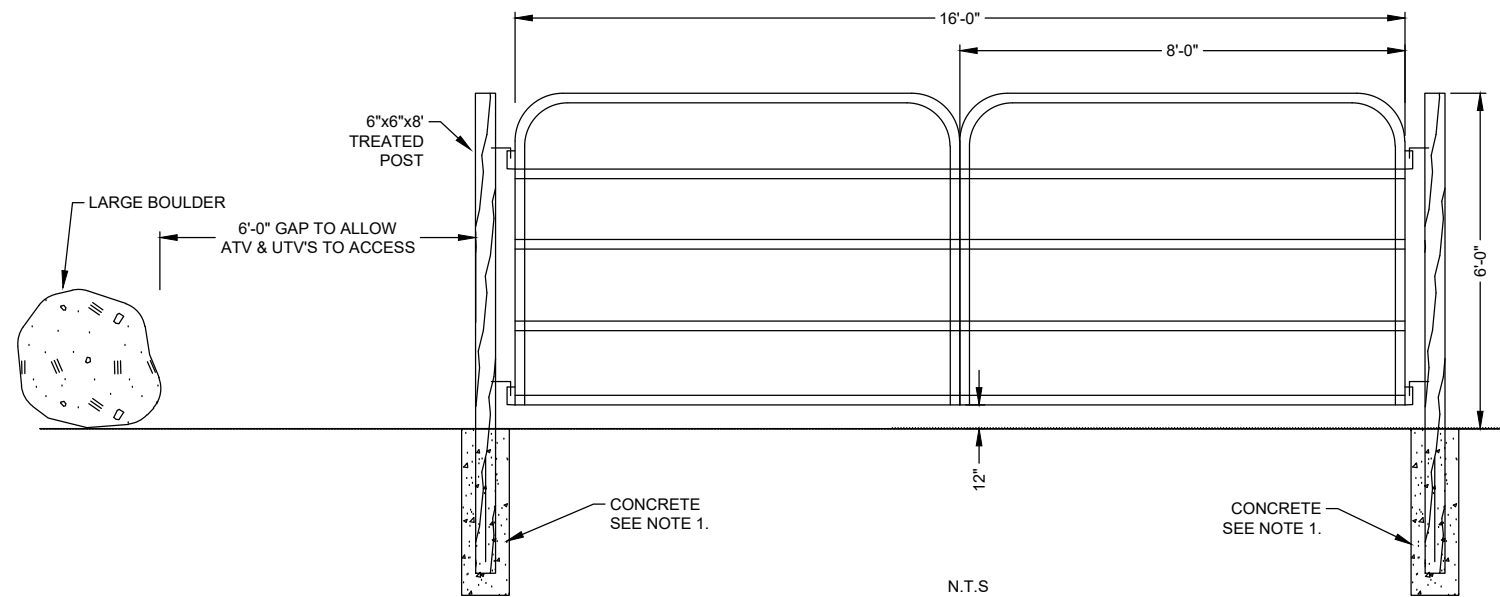

**SWING GATE DETAIL**

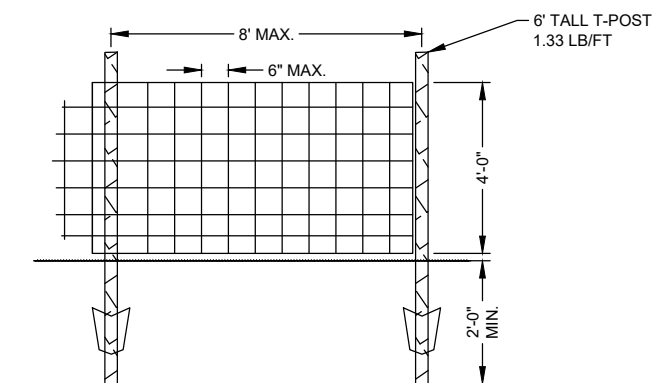

**WOVEN WIRE FENCE SECTION ELEVATION**

- NOTES:**
1. CONCRETE DIA. SHALL BE 4 TIMES THE DIA. OF THE POST.

SEH Project	168092	Rev.#	Revision Issue Description	Date	Rev.#	Revision Issue Description	Date
Drawn By	CRT						
Designed By	CRT						
Checked By	MVG						



POLK COUNTY ATV/UTV  
INTENSIVE USE PARK  
TOWN OF STERLING, WI

DETAILS

EVERGREEN AVE

TWO-WAY TRAIL NO PASSING

16' WIDE DOUBLE SWING GATE (TYPICAL)

ONE WAY ^ NO PASSING

REROUTED EQUESTRIAN TRAIL

BEGINNER'S COURSE

RE-ENTER

DO NOT ENTER

EXIT

ATV/UTV TRACK

ONE WAY ^

DO NOT ENTER

RE-ENTER

EXIT

SAND PIT

ONE WAY ^

CHALLENGE COURSE AND SAND PIT

DO NOT ENTER

RE-ENTER

EXIT

DO NOT ENTER

EXIT ^

CAUTION - TRAFFIC FROM LEFT

YIELD TO TRAFFIC FROM RIGHT

(2 SIDED) TWO-WAY TRAIL NO PASSING

16' WIDE DOUBLE SWING GATE (TYPICAL)

EX. ATV TRAIL

4' HIGH, WOVEN WIRE PERIMETER FENCE - TYPICAL (6 FOOT WIDE CLEARING)

- SIGN NOTES**
1. MOUNT SIGNS ON TREATED 4"x4" x8" POSTS, BURIED 3 FEET
  2. FINAL SIGN LOCATIONS VERIFIED BY OWNER

6' CLEAR



FILE NO.  
168092  
DATE:  
02/10/2023

POLK COUNTY ATV/UTV  
INTENSIVE USE PARK  
SIGNING AND FENCING

5 of  
21



# GENERAL EROSION CONTROL NOTES

WDNR TECHNICAL STANDARDS SHALL BE REVIEWED AND FOLLOWED FOR EROSION CONTROL PRACTICES SUCH AS DUST CONTROL (WDNR TECHNICAL STANDARD 1068), DEWATERING (WDNR TECHNICAL STANDARD 1061), MULCHING (WDNR TECHNICAL STANDARD 1058), OR OTHER STANDARD PRACTICES AS NEEDED.

DISTURBED AREAS SHALL BE UNIFORMLY GRADED PRIOR TO TURF ESTABLISHMENT.

STONE TRACKING PADS SHALL BE THE FULL WIDTH OF THE EGRESS POINT, A MINIMUM OF 50-FOOT LONG AND 12-INCH DEPTH (3-6" CLEAR STONE). STONE TRACKING PADS SHALL BE PLACED IN LOCATIONS AS REQUIRED. WDNR TECHNICAL STANDARD 1057 SHALL BE FOLLOWED FOR THE MAINTENANCE OF THE STONE TRACKING PADS.

ANY DISTURBED SOIL NOT ANTICIPATED TO BE REMOVED WITHIN 7 DAYS SHALL BE TEMPORARY SEEDED OR OTHERWISE PROTECTED. WORK IS INCIDENTAL TO THE BID ITEM TURF ESTABLISHMENT.

A MINIMUM OF 4 INCHES OF TOPSOIL MUST BE APPLIED TO ALL AREAS TO BE SEEDED OR SODDED.

ALL WASTE, AND UNUSED BUILDING MATERIALS (INCLUDING GARBAGE, DEBRIS, CLEANING WASTES, WASTEWATER, OR TOXIC MATERIALS) SHALL BE PROPERLY DISPOSED OF AND NOT ALLOWED TO BE CARRIED OFFSITE BY RUNOFF OR WIND.

ALL OFFSITE SEDIMENT DEPOSITS OCCURRING AS A RESULT OF CONSTRUCTION WORK OR A STORM EVENT SHALL BE CLEANED UP BY THE END OF EACH DAY. FLUSHING SHALL NOT BE ALLOWED.

ANY SOIL EROSION THAT OCCURS AFTER FINAL GRADING AND/OR THE APPLICATION OF STABILIZED MEASURES MUST BE REPAIRED AND THE WORK REDONE.

ALL TEMPORARY EROSION CONTROL INSTALLATIONS SHALL BE MAINTAINED UNTIL THE SITE IS STABILIZED WITH 70% VEGETATION AND A NOTICE OF TERMINATION HAS BEEN APPROVED BY THE WDNR.

WIND EROSION SHALL BE KEPT TO A MINIMUM DURING CONSTRUCTION. WATERING, MULCH, OR A TACKING AGENT MAY NEED TO BE UTILIZED TO PROTECT NEARBY RESIDENCES/WATER RESOURCES.

THE CONTRACTOR SHALL BE RESPONSIBLE FOR MAINTAINING ALL THE EROSION CONTROL MEASURES IN CONFORMANCE WITH THE WDNR TECHNICAL STANDARDS.

DISTURBED SOILS SHALL BE STABILIZED IMMEDIATELY AFTER FINAL GRADING IS COMPLETE.

ALL EROSION CONTROL DEVICES SUCH AS SILT FENCE AND INLET PROTECTION SHALL BE IN PLACE PRIOR TO ANY LAND DISTURBING ACTIVITIES.

UPON COMPLETION OF STORM INLET INSTALLATION, THE CONTRACTOR SHALL INSTALL INLET PROTECTION.

FINE SEDIMENT ACCUMULATIONS SHALL BE CLEANED FROM STREETS, PRIVATE DRIVES, AND/OR PARKING AREAS BY SWEEPING A MINIMUM OF ONCE PER WEEK AND BEFORE ALL IMMINENT RAINS.

EROSION AND SEDIMENT CONTROL STRUCTURES SHALL BE INSPECTED WEEKLY AND WITHIN 24 HOURS OF RAINFALL OF 0.5-INCHES OR MORE. CONTRACTOR SHALL BE RESPONSIBLE FOR EROSION CONTROL MEASURES UNTIL FINAL SITE STABILIZATION.

CONTRACTOR SHALL REMOVE TEMPORARY EROSION CONTROL Bmps UPON PROJECT ACCEPTANCE AND ESTABLISHED TURF.

DO NOT STORE SALVAGED TOPSOIL IN WETLAND OR LAKESHORE AREAS. SALVAGED TOPSOIL SHALL BE STORED AT A LOCATION APPROVED BY THE CITY OR ENGINEER IN THE FIELD.

ALL DISTURBED AREAS SHALL BE RESTORED AS NOTED. AREAS REQUIRING TEMPORARY SEEDING SHALL BE SEEDED USING A TEMPORARY SEED MIX AND DISC ANCHORED.

FOR DORMANT SEEDING (NOV. 1 TO MAY 15), SEED WITH SPECIFIED MIX AT A RATE OF 150% OF WHAT IS SPECIFIED (INCIDENTAL). ALL AREAS SEEDED IN LATE FALL/WINTER SHALL BE RE-SEEDED AFTER THE THREAT OF FROST IN THE SPRING PASSES.

CLEAR AND GRUB TREES, STUMPS, AND ROOTS WHILE PRESERVING TOPSOIL AS PRACTICAL WITHIN RIDING SURFACE.

CLEAR AND GRUB TREES, STUMPS, AND ROOTS, AND SALVAGE AND REPLACE TOPSOIL IN CUT/FILL SLOPE AREAS.

INSTALL SILT FENCE WHERE THE RISK OF RUNOFF LEAVING THE PROPERTY IS PRESENT

**NOTE:**

POLK COUNTY TO PERFORM ALL REQUIRED CLEARING, GRUBBING, AND DISPOSAL OF TREES AND STUMPS.

**NOTE**

HATCH AREAS REPRESENT SUBSTANTIAL 3:1 SLOPES WITH EMAT AREAS OF CUT/FILL AND/OR FEATURE SLOPES

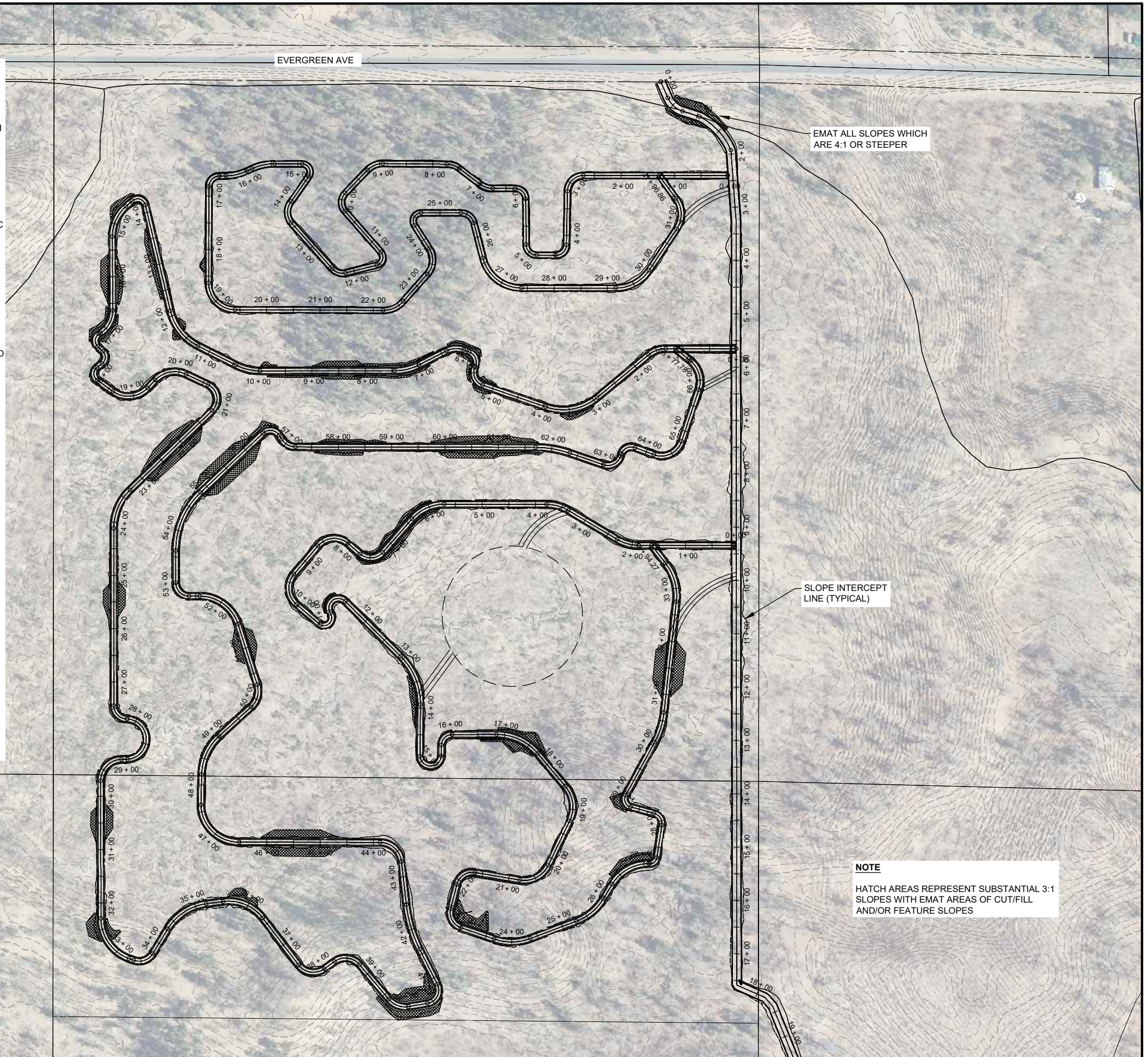

SEH Project	168092	Rev.#	Revision Issue Description	Date	Rev.#	Revision Issue Description	Date
Drawn By	CRT						
Designed By	CRT						
Checked By	MVG						



DATE 02/10/2023

POLK COUNTY ATV/UTV  
INTENSIVE USE PARK  
TOWN OF STERLING, WI

EROSION CONTROL PLAN



**OBSTACLE 1- ANGLED LOGS**



**OBSTACLE 2 - MED/LARGE RIPRAP**



**OBSTACLE 3 - TIRES TO LOGS**

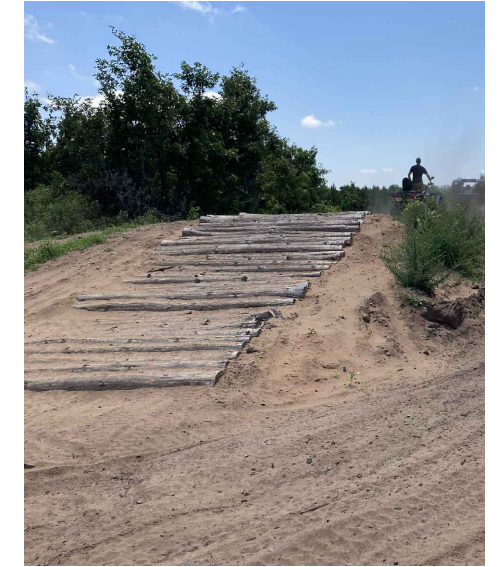

**OBSTACLE 4 - LOG HILL**



**OBSTACLE 5- OFFSET R/R TIES**

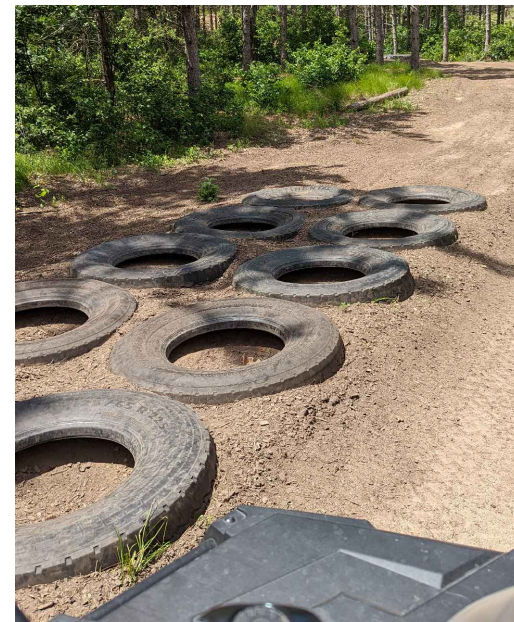

**OBSTACLE 6 - LARGE TIRES**

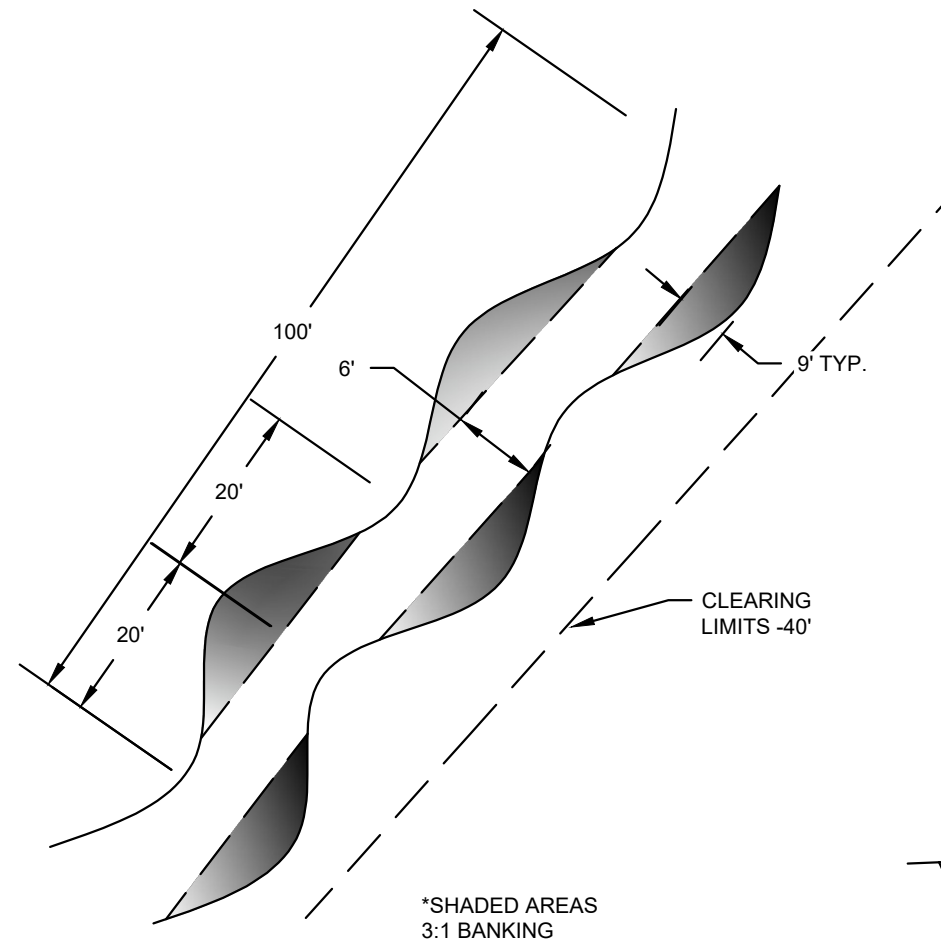

**OBSTACLE 7 - LUGE BANKING**

**NOTES**

1. TYPICAL OBSTACLE WIDTH IS 8 FEET
2. TYPICAL OBSTACLE LENGTH 50 FEET UNLESS OTHERWISE NOTED
3. MAINTAIN 6' WIDE BYPASS RIDING SURFACE FOR ALL OBSTACLES

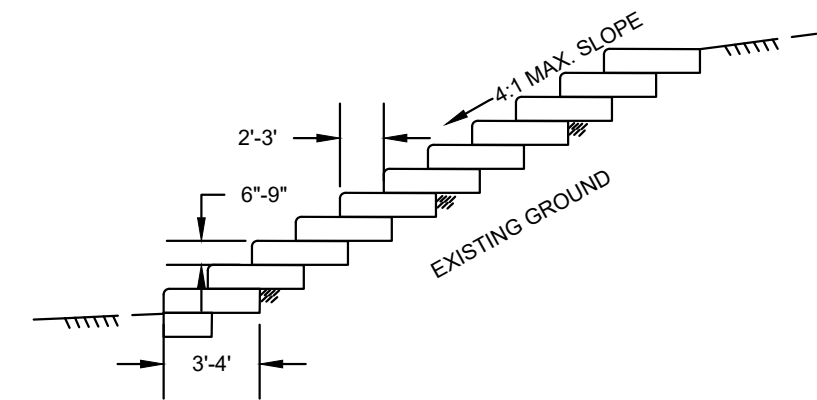

**OBSTACLE 8 - FLAT ROCK STEPS**

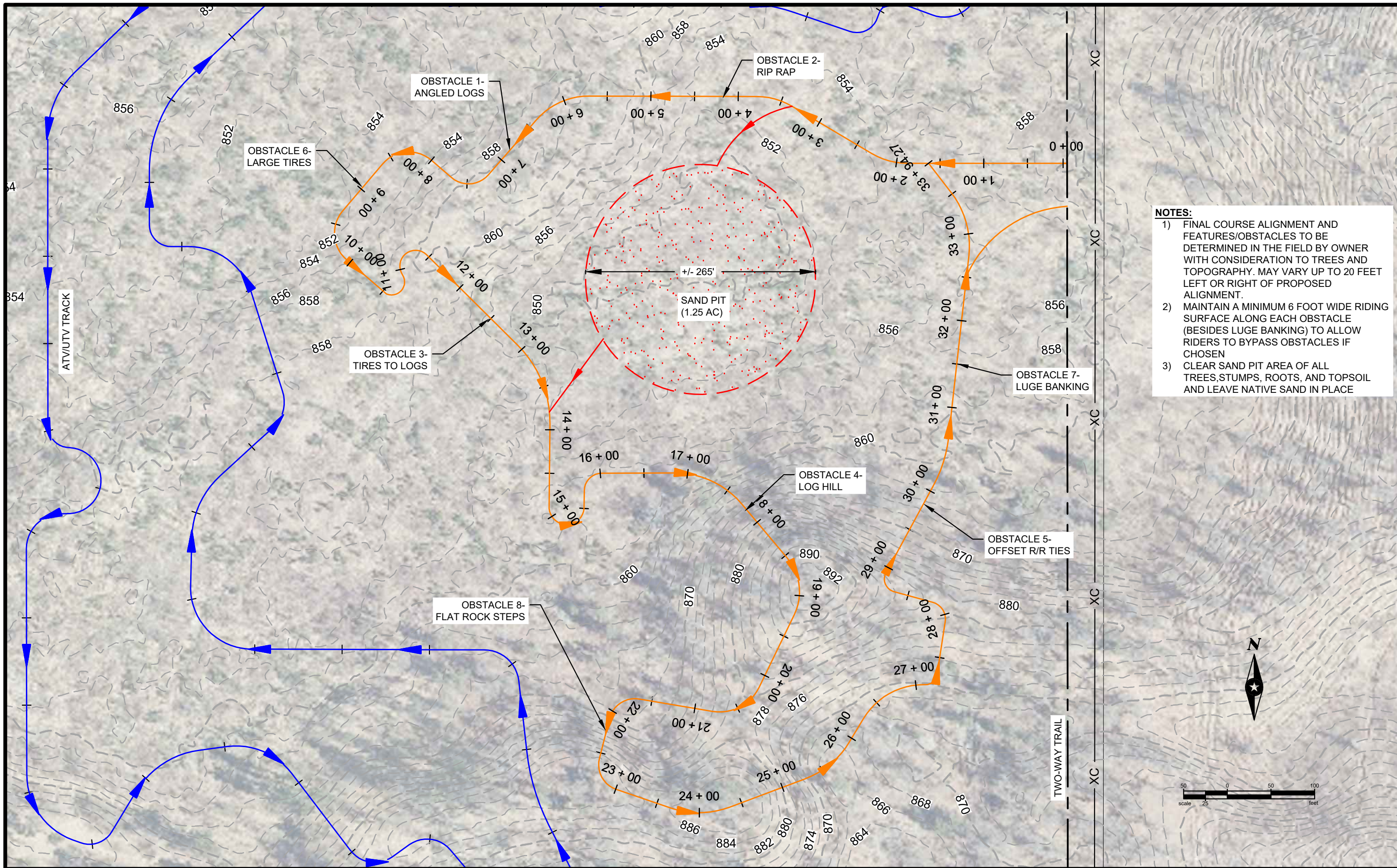

- NOTES:**
- 1) FINAL COURSE ALIGNMENT AND FEATURES/OBSTACLES TO BE DETERMINED IN THE FIELD BY OWNER WITH CONSIDERATION TO TREES AND TOPOGRAPHY. MAY VARY UP TO 20 FEET LEFT OR RIGHT OF PROPOSED ALIGNMENT.
  - 2) MAINTAIN A MINIMUM 6 FOOT WIDE RIDING SURFACE ALONG EACH OBSTACLE (BESIDES LUGE BANKING) TO ALLOW RIDERS TO BYPASS OBSTACLES IF CHOSEN
  - 3) CLEAR SAND PIT AREA OF ALL TREES, STUMPS, ROOTS, AND TOPSOIL AND LEAVE NATIVE SAND IN PLACE

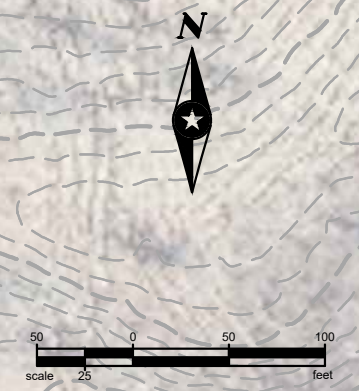

SEH Project	168092	Rev.#	Revision Issue Description	Date	Rev.#	Revision Issue Description	Date
Drawn By	CRT						
Designed By	CRT						
Checked By	MVG						



DATE 02/10/2023

POLK COUNTY ATV/UTV  
INTENSIVE USE PARK  
TOWN OF STERLING, WI

CHALLENGE COURSE  
OBSTACLE LAYOUT

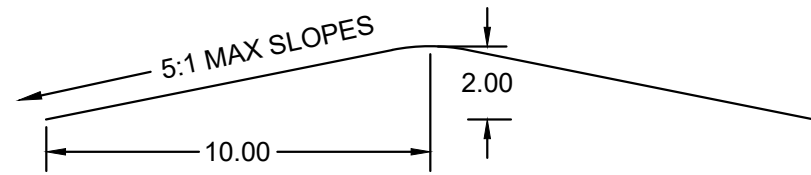

**FEATURE 1. - SMALL ROLLING JUMP**

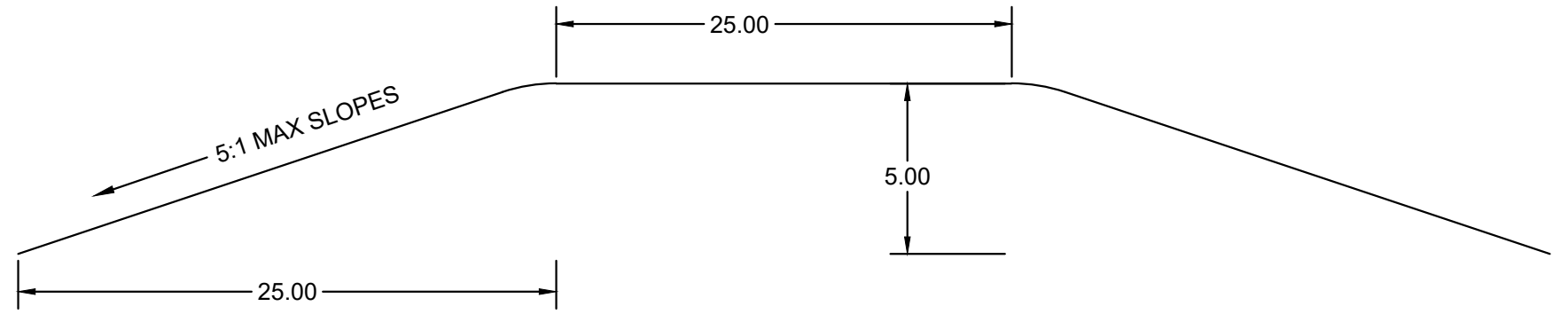

**FEATURE 4. - LONG TABLE TOP**

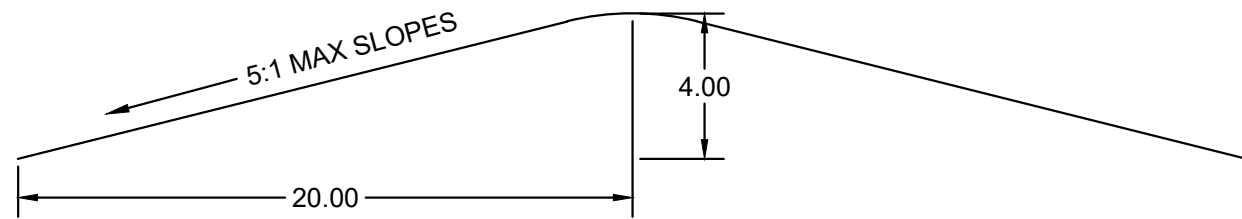

**FEATURE 2. - LARGE ROLLING JUMP**

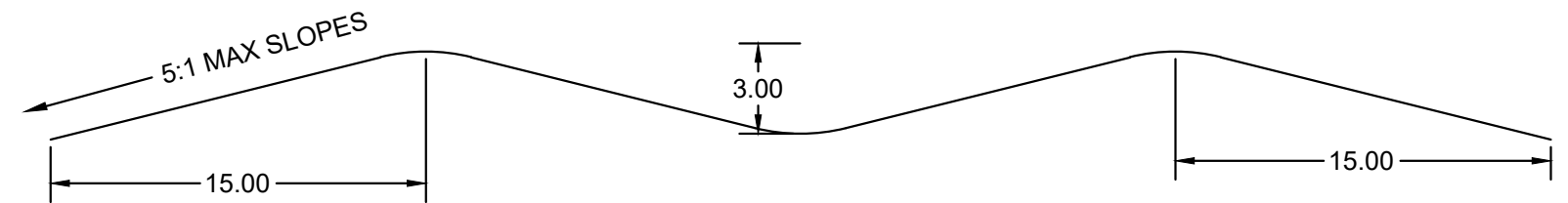

**FEATURE 5. - DOUBLE ROLLING JUMP**

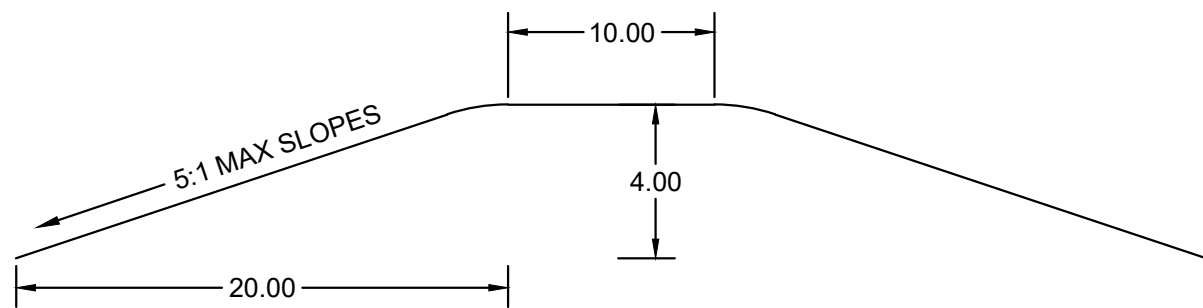

**FEATURE 3. - SHORT TABLE TOP**

\*\* ALL SIDE SLOPES OF FEATURES SHALL HAVE 3:1 SLOPES

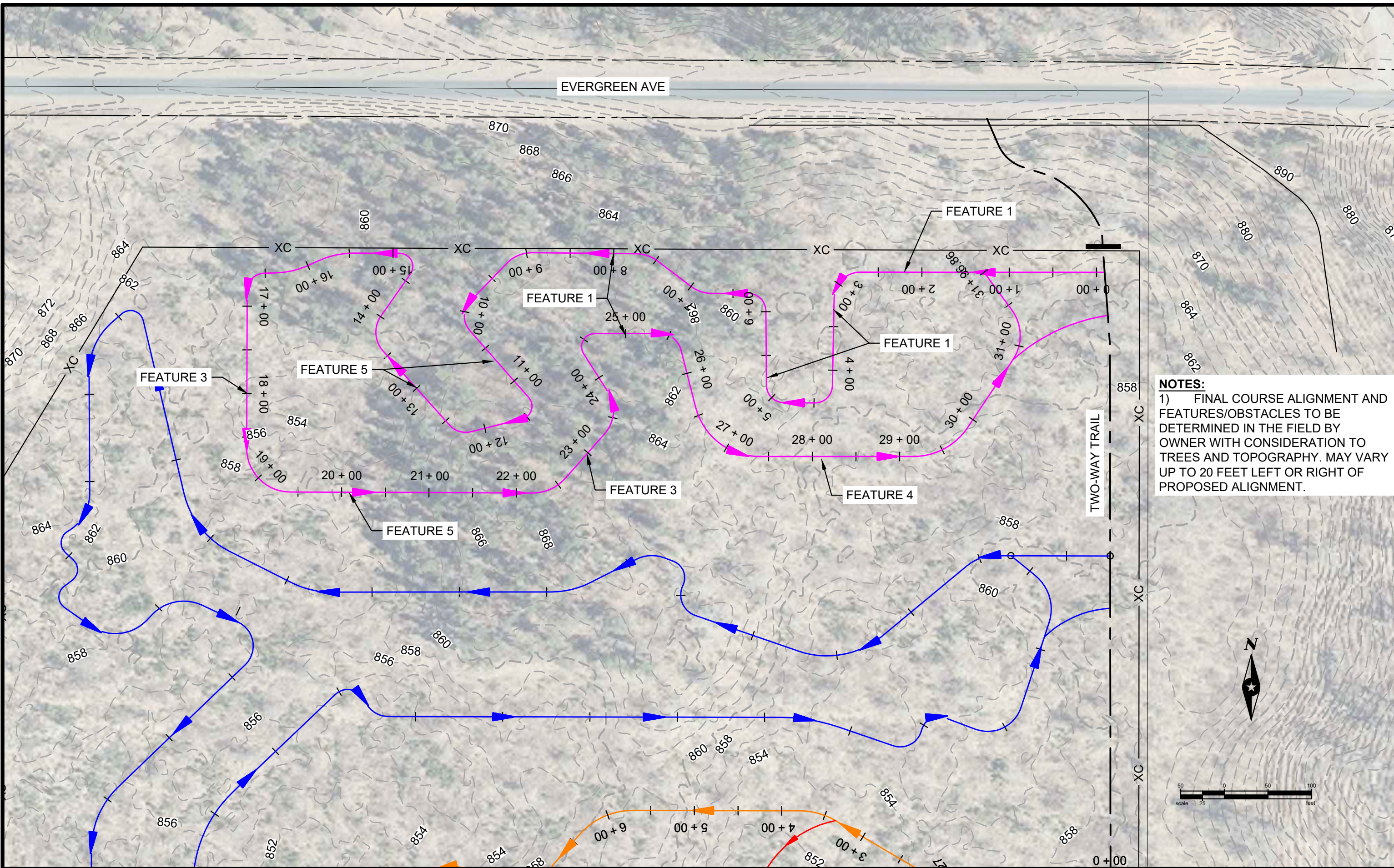

**NOTES:**  
 1) FINAL COURSE ALIGNMENT AND FEATURES/OBSTACLES TO BE DETERMINED IN THE FIELD BY OWNER WITH CONSIDERATION TO TREES AND TOPOGRAPHY. MAY VARY UP TO 20 FEET LEFT OR RIGHT OF PROPOSED ALIGNMENT.

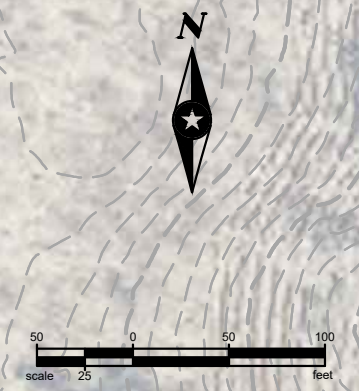

SEH Project	168092	Rev.#	Revision Issue Description	Date	Rev.#	Revision Issue Description	Date
Drawn By	CRT						
Designed By	CRT						
Checked By	MVG						



DATE 02/10/2023

POLK COUNTY ATV/UTV  
 INTENSIVE USE PARK  
 TOWN OF STERLING, WI

BEGINNERS COURSE  
 LAYOUT

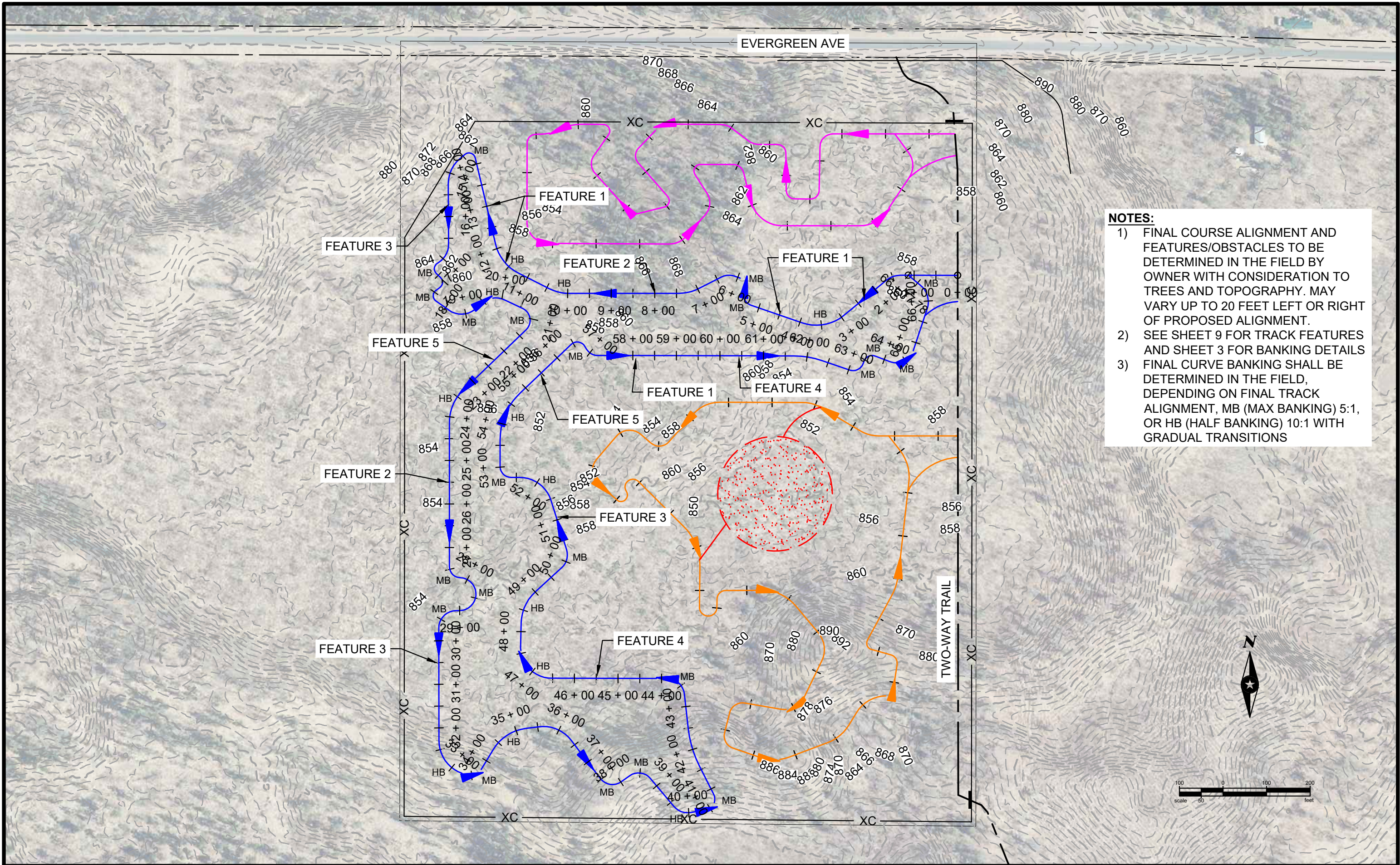

- NOTES:**
- 1) FINAL COURSE ALIGNMENT AND FEATURES/OBSTACLES TO BE DETERMINED IN THE FIELD BY OWNER WITH CONSIDERATION TO TREES AND TOPOGRAPHY. MAY VARY UP TO 20 FEET LEFT OR RIGHT OF PROPOSED ALIGNMENT.
  - 2) SEE SHEET 9 FOR TRACK FEATURES AND SHEET 3 FOR BANKING DETAILS
  - 3) FINAL CURVE BANKING SHALL BE DETERMINED IN THE FIELD, DEPENDING ON FINAL TRACK ALIGNMENT, MB (MAX BANKING) 5:1, OR HB (HALF BANKING) 10:1 WITH GRADUAL TRANSITIONS

SEH Project	168092	Rev.#	Revision Issue Description	Date	Rev.#	Revision Issue Description	Date
Drawn By	CRT						
Designed By	CRT						
Checked By	MVG						



DATE 02/10/2023

POLK COUNTY ATV/UTV  
INTENSIVE USE PARK  
TOWN OF STERLING, WI

ATV/UTV TRACK LAYOUT

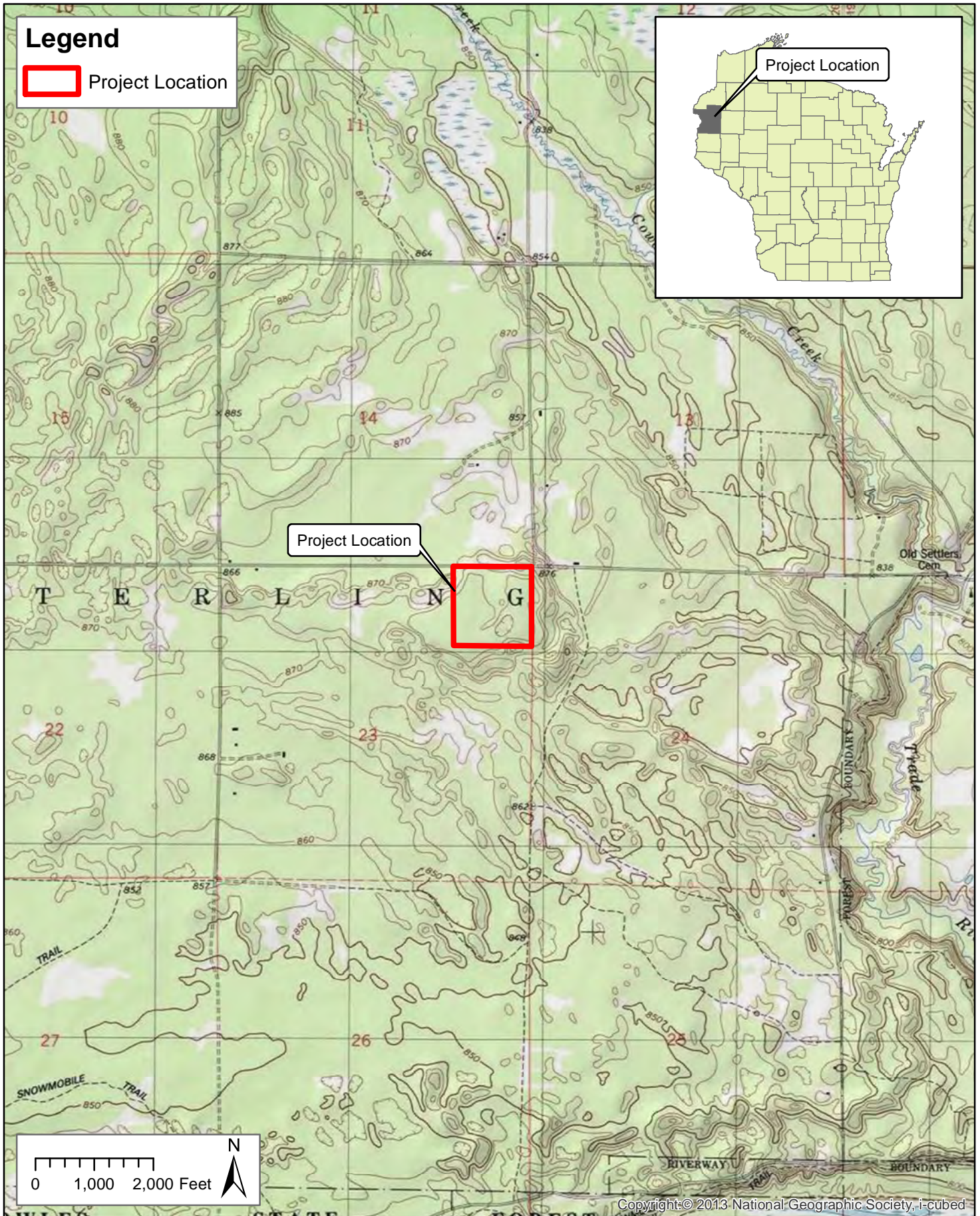

 10 NORTH BRIDGE STREET  
 CHIPPEWA FALLS, WI 54729-2550  
 PHONE: (715) 720-6200  
 FAX: (888) 908-8166  
 TF: (800) 472-5881  
 www.sehinc.com

Project: POLPW 168092  
 Print Date: 6/27/2022  
 Map by: Jgreen  
 Projection: WISCRS,  
 Polk County (ft)  
 Source: WDNR, Polk Co.  
 Aerial Photo Year: 2020

**Project Location Map**  
 ATV/UTV Intensive Use Park  
 Town of Sterling, Polk County, WI

**Figure**  
 1

**Legend**



Project Location



Wisconsin Wetland Inventory

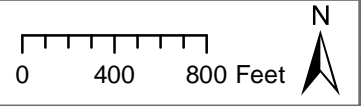
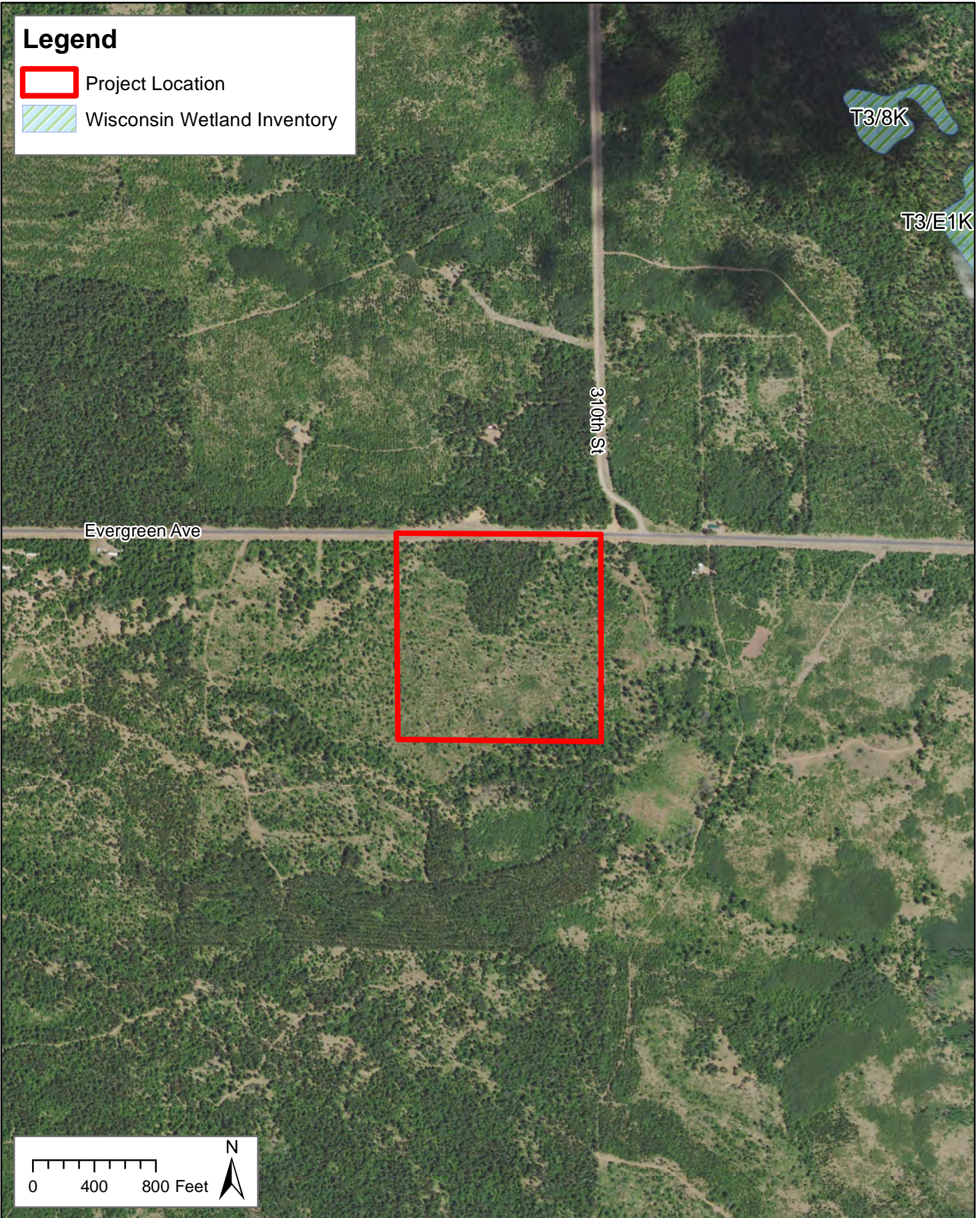

10 NORTH BRIDGE STREET  
CHIPPEWA FALLS, WI 54729-2550  
PHONE: (715) 720-6200  
FAX: (888) 908-8166  
TF: (800) 472-5881  
www.sehinc.com

Project: POLPW 168092  
Print Date: 6/27/2022  
Map by: Jgreen  
Projection: WISCRS,  
Polk County (ft)  
Source: WDNR, Polk Co.  
Aerial Photo Year: 2020

**Wisconsin Wetland Inventory**  
**ATV/UTV Intensive Use Park**  
**Town of Sterling, Polk County, WI**

**Figure**  
**3**



### Legend

- Project Location
- Sample Points

### Soil Hydric Rating

- Nonhydic
- Predominantly Nonhydic
- Partially Hydic

Map Unit	Soil Description
399B	Grayling sand, 0 to 6 percent slopes
399C	Grayling sand, 6 to 12 percent slopes
399D	Grayling sand, 12 to 30 percent slopes
465A	Newson-Meehan complex, 0 to 3 percent slopes
825A	Meehan sand, 0 to 2 percent slopes

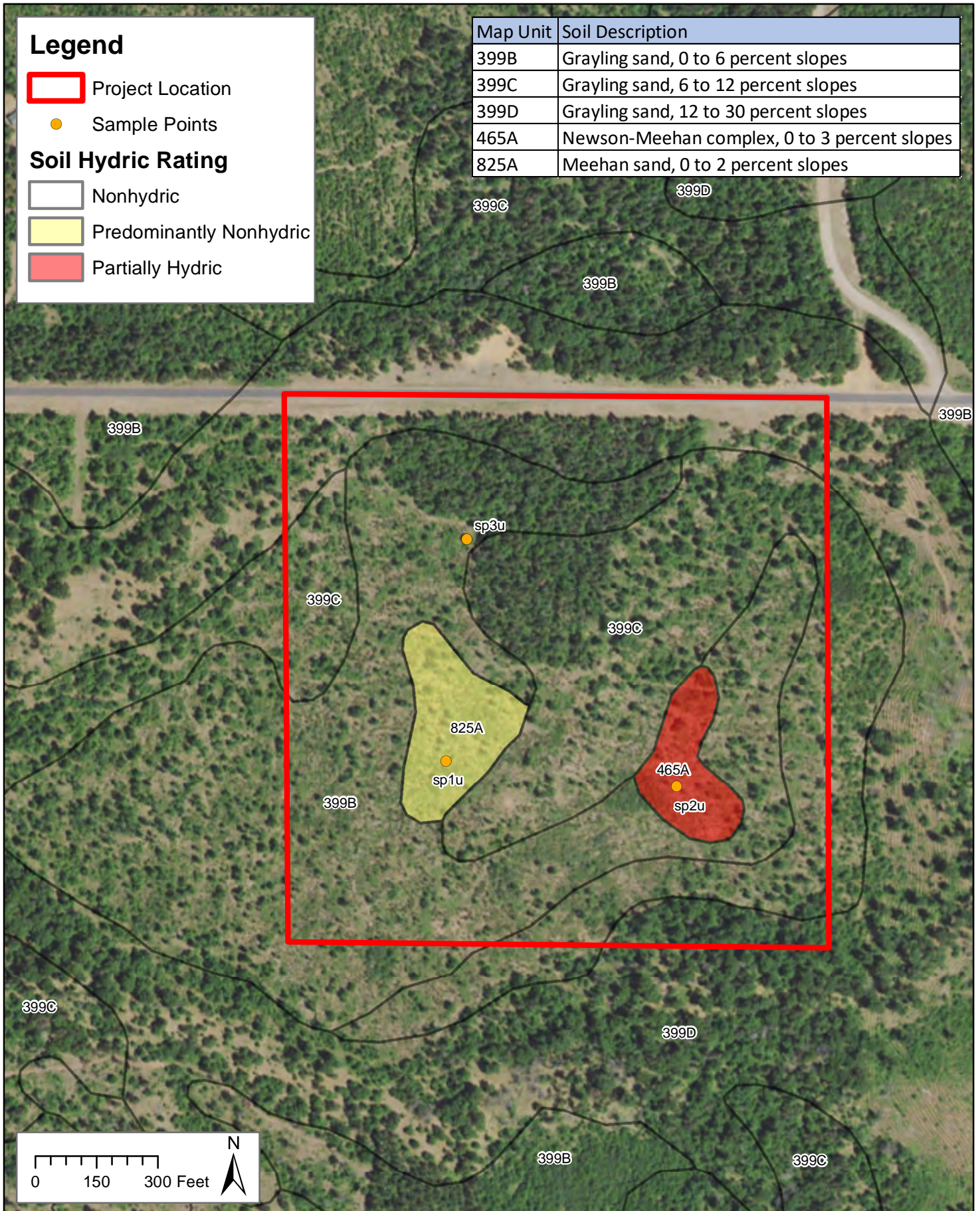



10 NORTH BRIDGE STREET  
 CHIPPEWA FALLS, WI 54729-2550  
 PHONE: (715) 720-6200  
 FAX: (888) 908-8166  
 TF: (800) 472-5881  
 www.sehinc.com

Project: POLPW 168092  
 Print Date: 7/11/2022  
 Map by: Jgreen  
 Projection: WISCRS,  
 Polk County (ft)  
 Source: WDNR, Polk Co.  
 Aerial Photo Year: 2020

**Areas of Potential Habitat  
 ATV/UTV Intensive Use Park  
 Town of Sterling, Polk County, WI**

**Figure  
 3**

## Representative Site Photos



Photo 1 Grassed open space along Evergreen Avenue is composed of short grasses and short forbs, facing east from the western limits of PCA 1



Photo 2 Grassed open space along Evergreen Avenue consists of short grasses and short forbs, facing west from the eastern portion of PCA 2



Photo 3 UTV/ATV trail in the northwest corner of PCA 2, facing south. The trail veers southwest off the parcel.



Photo 4 Young trees establishing in PCA 2 following timber harvesting that occurred 7-9 years prior. Photo taken facing southeast from the northwestern portion of PCA 2.



Photo 5 Southwestern portion of PCA 2 with dense raspberries and blackberries growing in openings between young trees.



Photo 6 Young trees with dense shrub stratum within the southern portion of PCA 2



Photo 7 Grassed opening intermixed with young trees in the south-central portion of PCA 2



Photo 8 Areas of southeastern PCA 2 have a more open understory



Photo 9 Young trees with herbaceous stratum that mostly consisted of grasses and short forbs. Photo taken in southeastern portion of PCA 2



Photo 10 In the northeast portion of PCA 2, the elevation increases and open space areas becomes more common.



Photo 11 Along the western site limits, dense shrub stratum is common



Photo 12 PCA 3 is upland forest area with a moderate amount of shading. Photo taken in the northeastern portion of PCA, facing west.





Photo 13 Selective tree harvesting appears to have occurred in PCA 3 relatively recently. Photo taken in the northcentral portion of PCA 3, facing south.



Photo 14 Western portion of PCA 3, facing east



Photo 15 Trees remaining in PCA 3 typically consisted of northern red oak, white oak, and a few maples. Photo taken in the southern portion of PCA 3.



Photo 16 Wild lupine was observed growing along 250<sup>th</sup> Avenue, 2.7 miles southeast of the subject site. This observation indicates that if wild lupine were present on the subject property that the plant would exist in a sufficient state of development to not be overlooked.

## Representative Site Photos



Photo 1 Vegetation found with the area mapped as predominantly non-hydric soils did not have dominant hydrophytic vegetation. Photo taken facing south from Sample Point 1U.



Photo 2 SP1U was taken at the lowest point of elevation in the predominantly non-hydric mapped soil. Although a few wetland plants species were found, they were not dominant. Area failed to meet wetland criteria. Photo facing north from SP1U.



Photo 3 Partially hydric soils are mapped in the southeast portion of the site. To confirm lack of wetland criteria, field data was collected at Sample Point 2U. Photo taken facing west from SP2U.



Photo 4 Within the mapped partially hydric soils, field data was collected at the lowest elevational point in the area. Photo taken facing northeast from SP2U.



Photo 5 NRCS “wet spot” was identified in the northern portion of the site. Field investigation revealed that no wetland criteria was met. Photo taken facing southwest at Sample Point 3U.



Photo 6 Southwestern portion of project site. Dense stands of raspberries and blackberries were found growing in openings between young trees.



Photo 7 Young trees with dense shrub stratum within the southern portion of the parcel



Photo 8 Mix of short shrubs and young trees was typically found in the south-central portion of the site, in the area between Sample Points 1U and 2U



Photo 9 Areas with a more open understory became more common in the southeast portion of the site



Photo 10 The elevation is higher in the northeast portion of the site and areas of open space becomes more common.



Photo 11 In the forested areas of the northern portion of the site, trees appear to have been selectively harvested relatively recently. Photo taken facing east from just east of Sample Point 3U.



Photo 12 A logging road follows the tree line on the western side of the forested area, facing northwest along the tree line





Photo 13 Selective tree harvesting appears to have occurred in the upland forest relatively recently. Photo taken in the northcentral portion of the forest, facing south



Photo 14 Upland grassed open space along Evergreen Avenue consists primarily of short grasses and short forbs, facing west from the northeastern portion of the site



Photo 15 Upland grassed open space along Evergreen Avenue, facing east from the northwestern limits of site