

LAKE SURVEY MAP

SPRING
LAKE

VILAS
COUNTY

SEC. 27

T. 43- N. R. 9- E.

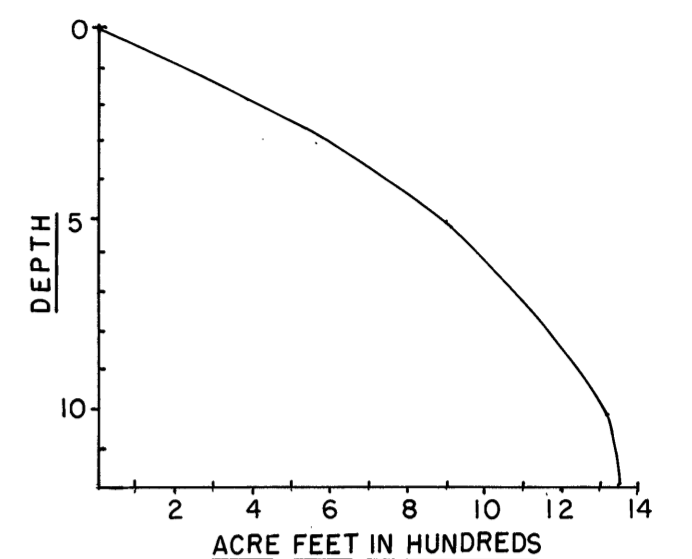
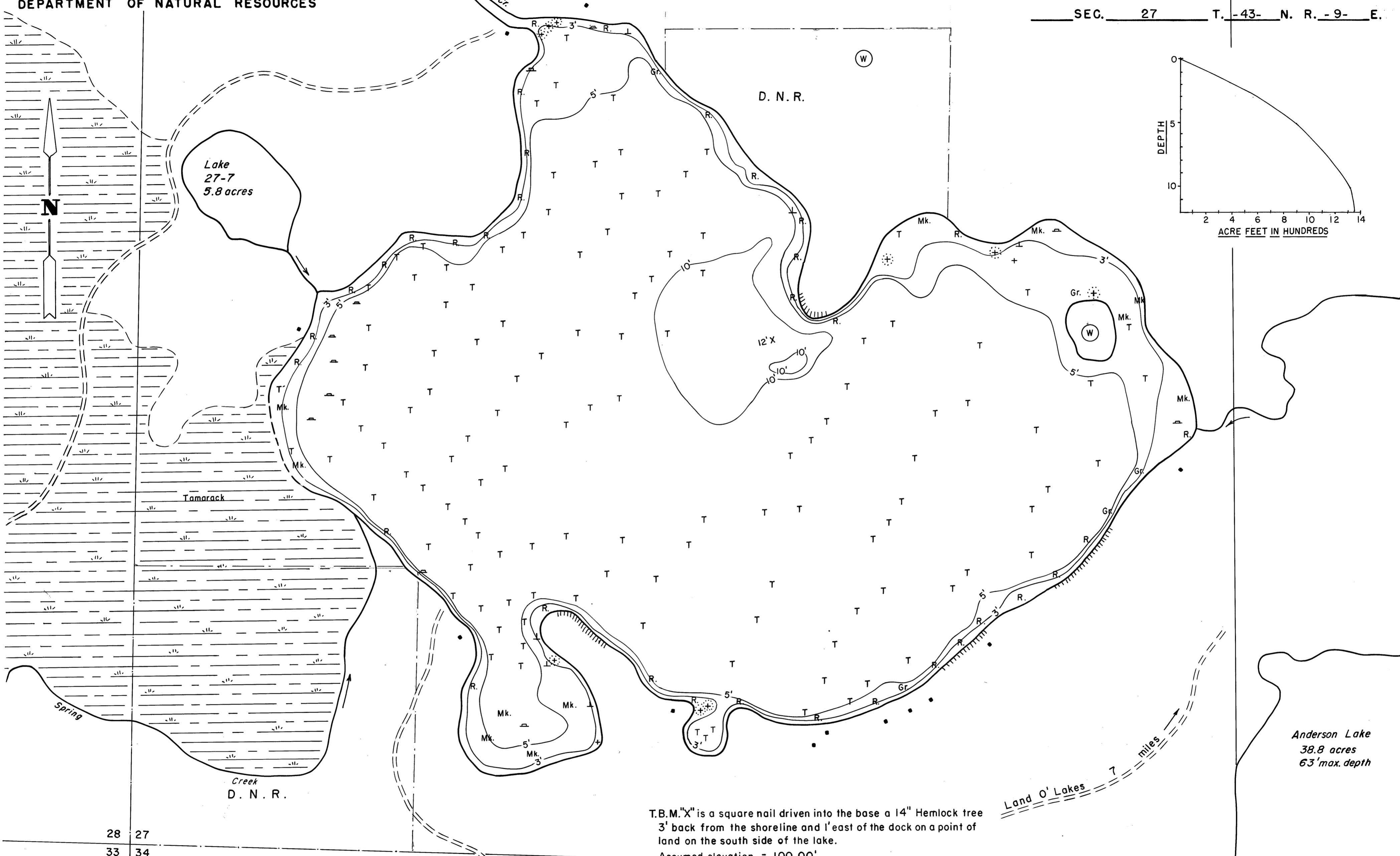

T.B.M. "X" is a square nail driven into the base a 14" Hemlock tree
3' back from the shoreline and 1' east of the dock on a point of
land on the south side of the lake.
Assumed elevation = 100.00'
Water level = 97.62'

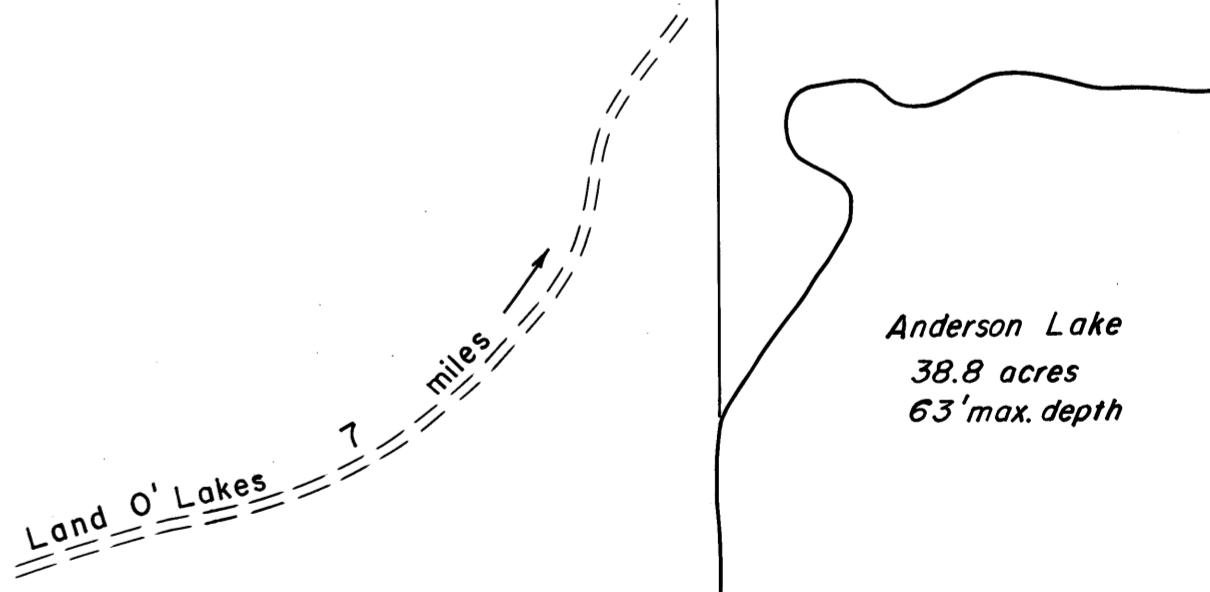

EQUIPMENT RECORDING SONAR MAPPED JULY 1978

TOPOGRAPHIC SYMBOLS		LAKE BOTTOM SYMBOLS	
(B) Brush	Steep slope	P. Peat	B Boulders
(PW) Partially wooded	Indefinite shoreline	Mk. Muck	Stumps & Snags
(W) Wooded	Marsh	C. Clay	Rock danger to navigation
(C) Cleared	Spring	M. Marl	T Submergent vegetation
(P) Pastured	Intermittent stream	Sd. Sand	Emergent vegetation
(A) Agricultural	Permanent inlet	St. Silt	Floating vegetation
B.M. Bench Mark	Permanent outlet	Gr. Gravel	Brush shelters
■ Dwelling	Dam	R. Rubble	
□ Resort	D.N.R. State owned land	Br. Bedrock	
□ Camp			

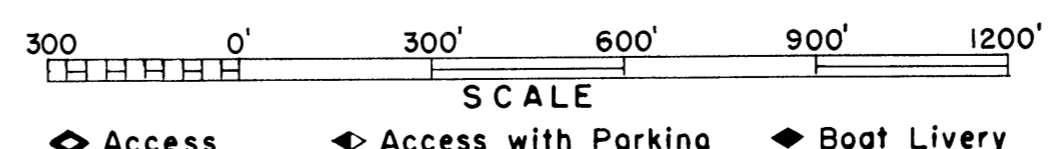

◆ Access ◆ Access with Parking ◆ Boat Livery

Drawn by: R. Williams
Field work by: J. Smith, K. Arnold, H. Carlson, D. Peterson

SPECIES OF FISH	Abundance		
	Abundant	Common	Present
Muskie			X
N. Pike			X
Walleye	X		
L.M. Bass			X
S.M. Bass			X
Panfish	X		
Trout			

WATER AREA 194.5 ACRES
 UNDER 3 FT. 6 %
 OVER 20 FT. 0 %
 MAX. DEPTH 12 FEET.
 TOTAL ALK. 85 P.P.M.
 VOLUME 1,345.88 ACRE FT.
 MAIN SHORELINE 2.9 MI.
 ISLAND SHORELINE .17 MI.

Source: Wisconsin Department of Natural Resources 608-266-2621
Spring Lake – Vilas County, Wisconsin DNR Lake Map
Date – Jul 1978 - Historical Lake Map - Not for Navigation
A Public Document - Please Identify the Source when using it.