

Department of Natural Resources B.M. 1188-A, "x"

A square chisel cut in the top of a rock outcrop. It is located 97 feet northwest of the water's edge and 32 feet northeast of the access in the northeast corner of the lake.

Assumed elevation 100.00'

Water elevation 88.85', taken July 20, 1967.

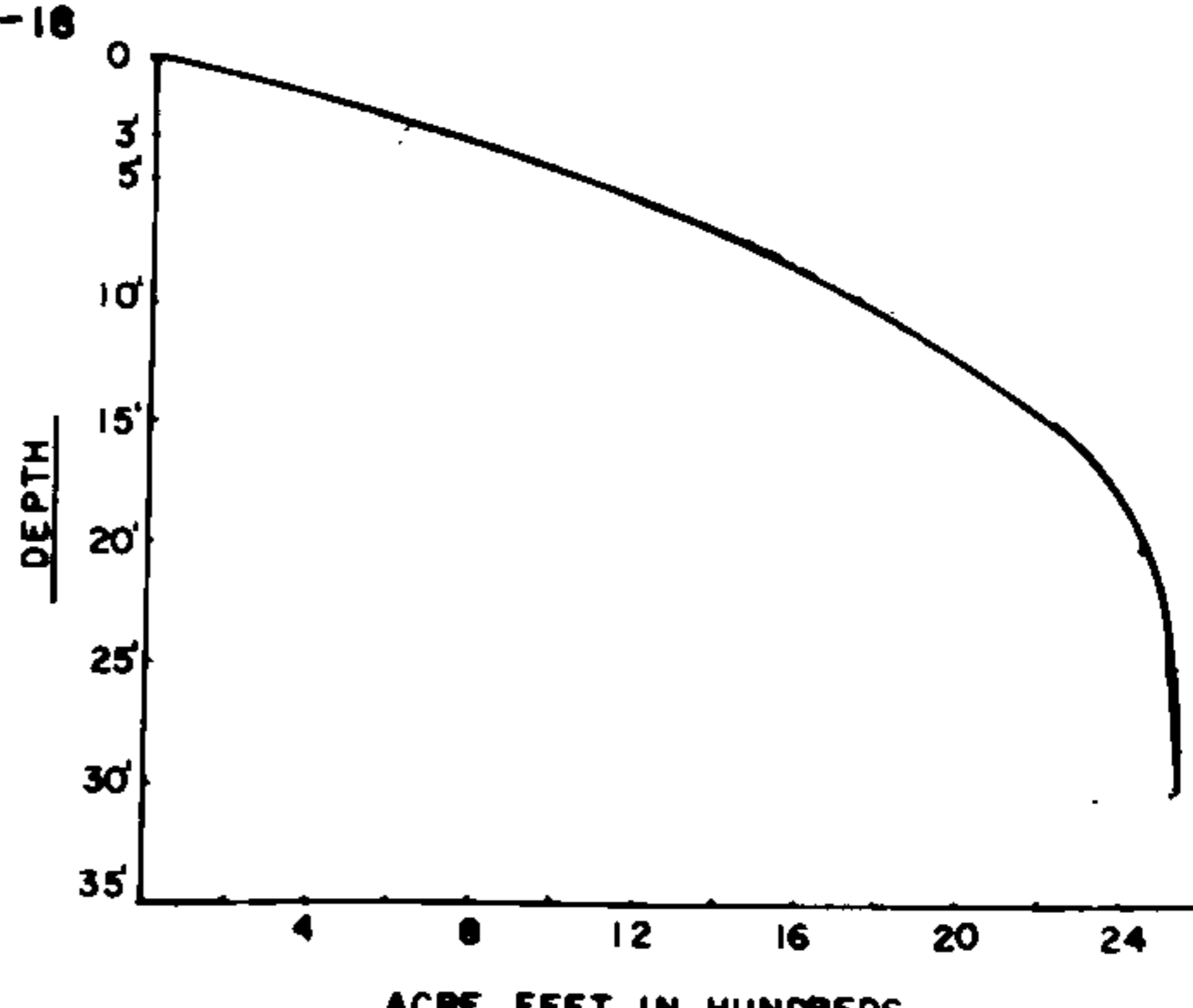
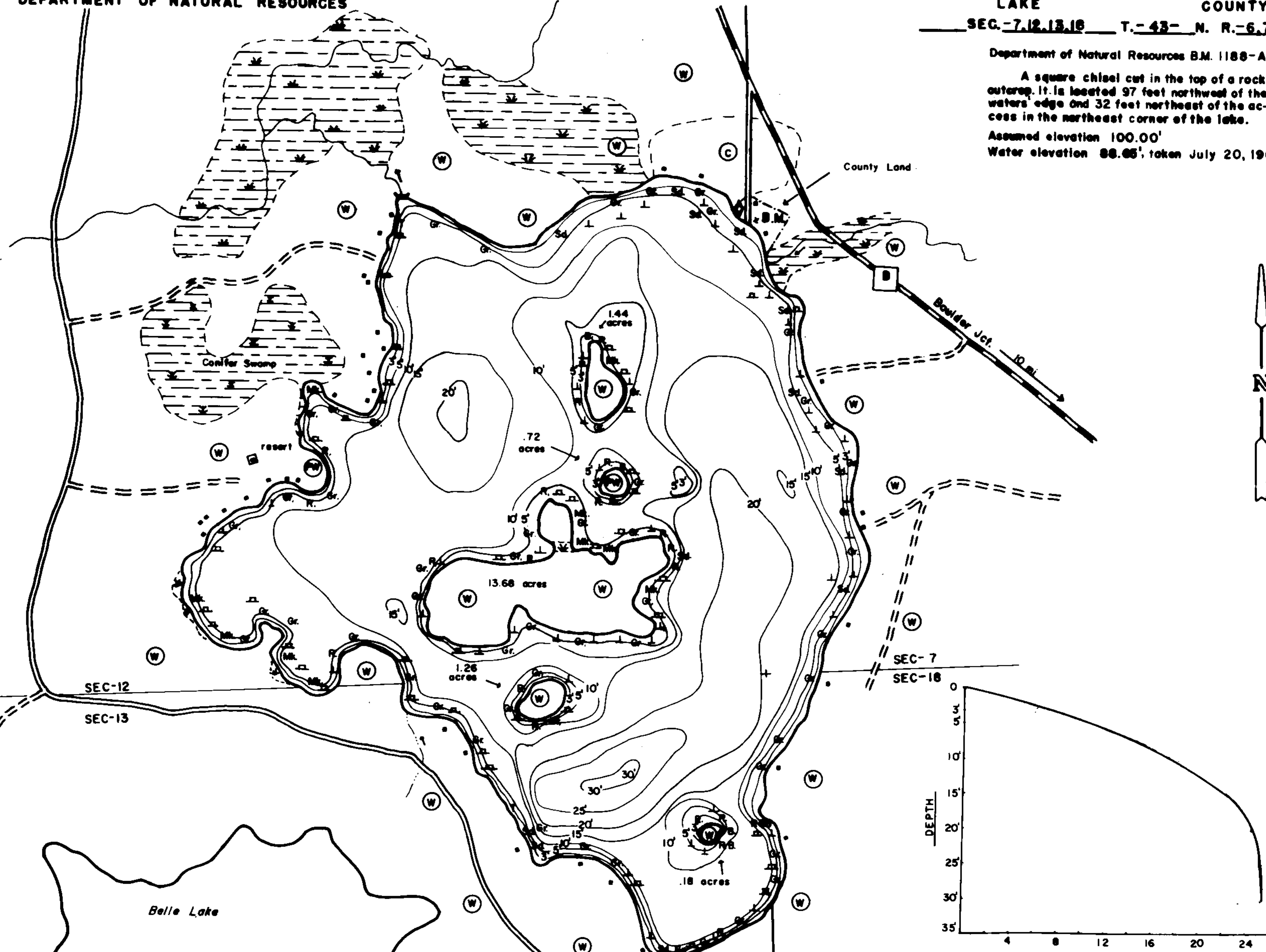

EQUIPMENT POLE & SONAR MAPPED JUNE 1967

- | TOPOGRAPHIC SYMBOLS   |                            | LAKE BOTTOM SYMBOLS |                           |
|-----------------------|----------------------------|---------------------|---------------------------|
| (B) Brush             | Steep slope                | P. Peat             | B Boulders                |
| (PW) Partially wooded | - - - Indefinite shoreline | Mk. Muck            | Stumps & Snags            |
| (W) Wooded            | Marsh                      | C. Clay             | Rock danger to navigation |
| (C) Cleared           | Spring                     | M. Marl             | T Submergent vegetation   |
| (P) Pastured          | Intermittent stream        | Sd. Sand            | I Emergent vegetation     |
| (A) Agricultural      | Permanent inlet            | St. Silt            | F Floating vegetation     |
| B.M. Bench Mark       | Permanent outlet           | Gr. Gravel          | Brush shelters            |
| Dwelling              | Dam                        | R. Rubble           |                           |
| Resort                | D.N.R. State owned land    | Bc. Bedrock         |                           |
| Comp                  |                            |                     |                           |



Drawn by: T. Gindry  
Field work by: P. Michelson, J. Smith

SPECIES OF FISH	Abundance		
	Abundant	Common	Present
Muskie			X
N. Pike			X
Walleye	X		
L. M. Bass			X
S. M. Bass			X
Panfish	X		
Trotl			

WATER AREA 212.5 ACRES  
 UNDER 3 FT. 5.2 %  
 OVER 20 FT. 11.0 %  
 MAX. DEPTH 30 FEET.  
 TOTAL ALK. 10 P.P.M.  
 VOLUME 2545 ACRE FT.  
 SHORELINE 2.86 MILES  
 WITH ISLANDS 4.24 MILES

Source: Wisconsin Department of Natural Resources 608-266-2621  
Annabelle Lake - Vilas County, Wisconsin DNR Lake Map  
Date – Jun 1967 - Historical Lake Map - Not for Navigation  
A Public Document - Please Identify the Source when using it.