

LAKE SURVEY MAP

PORCUPINE LAKE BAYFIELD COUNTY  
SEC. 17, 18, 19, 20 T. 44 - N. R. - 6 - E.W.

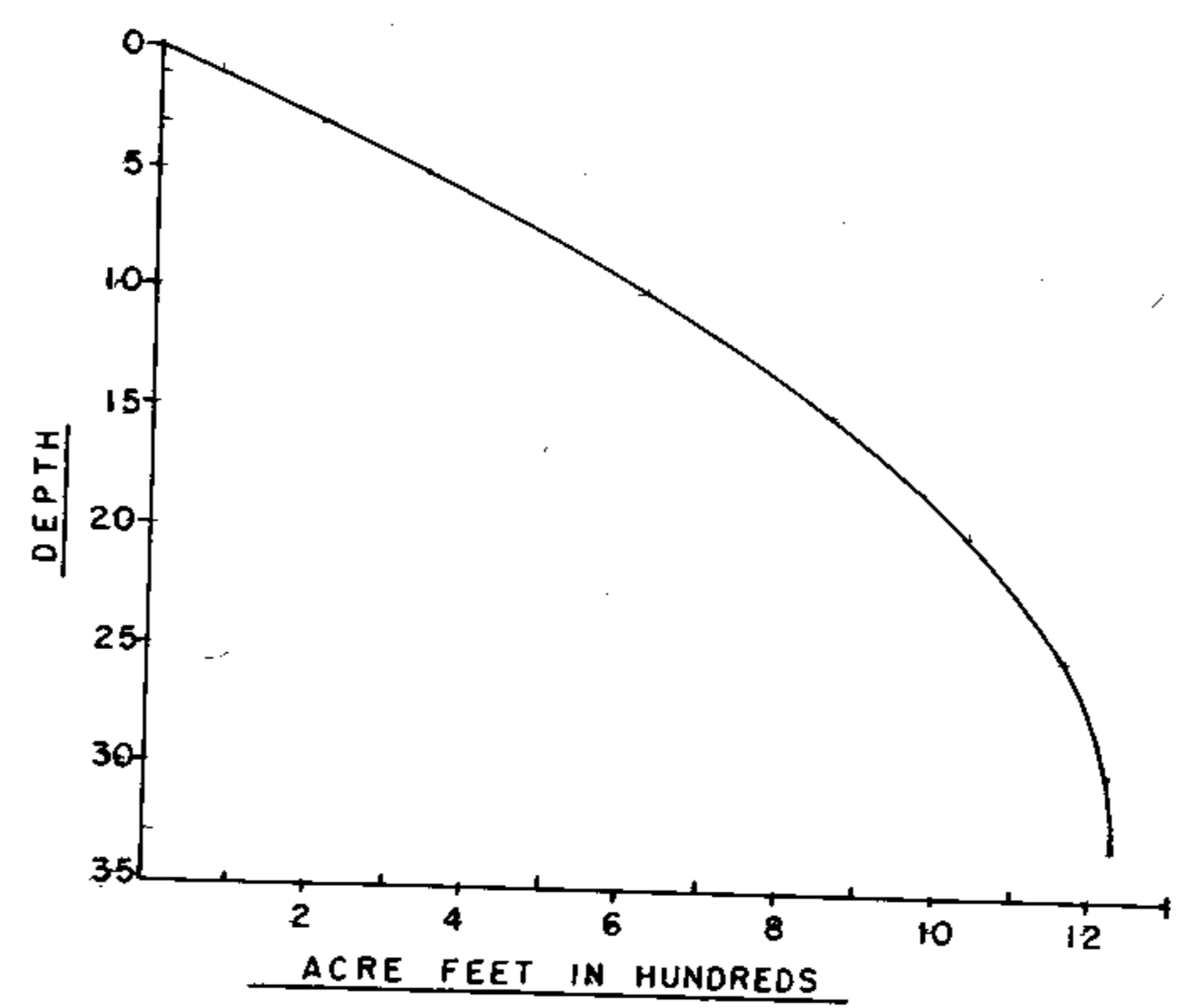
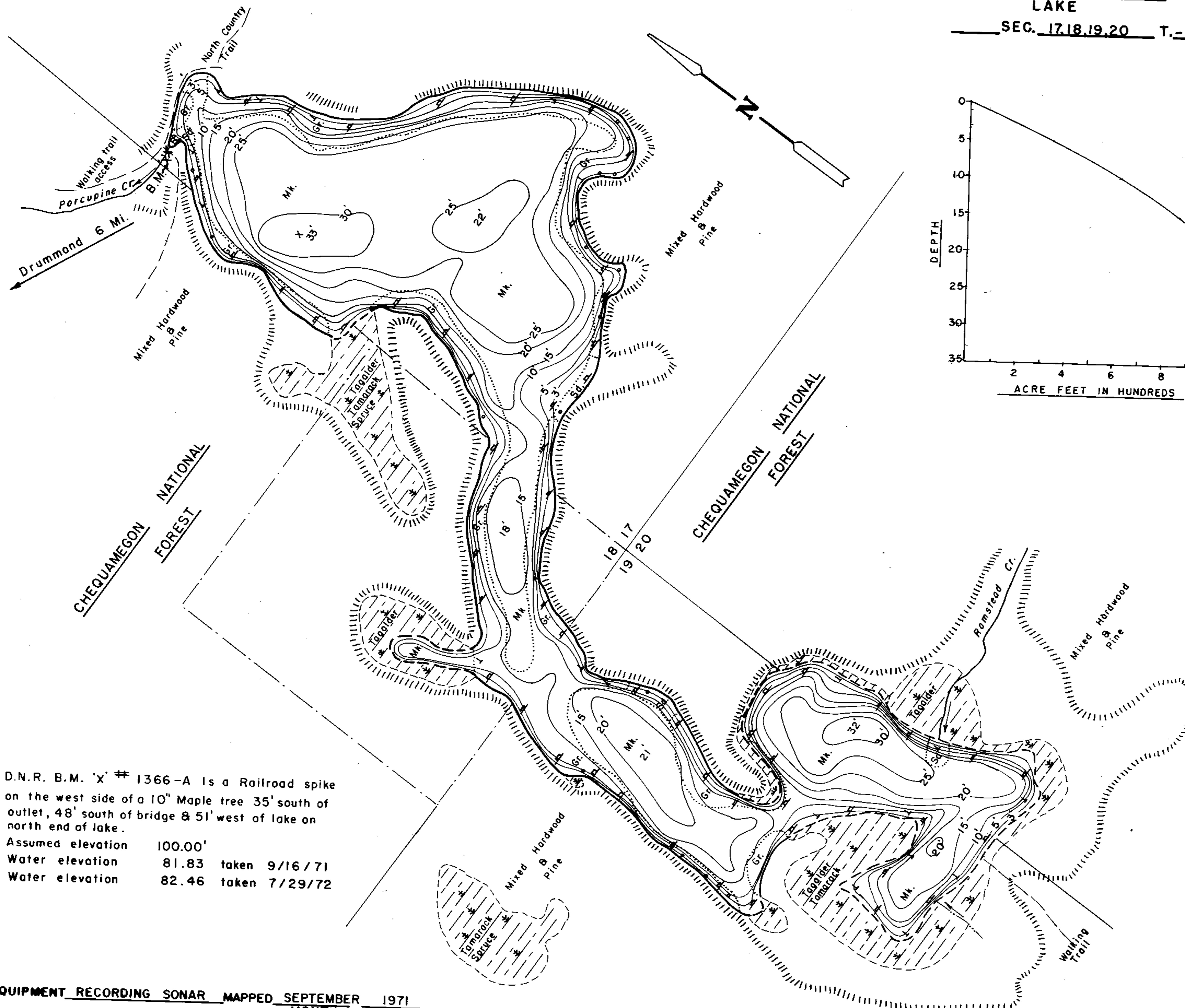

D.N.R. B.M. 'X' # 1366-A is a Railroad spike on the west side of a 10" Maple tree 35' south of outlet, 48' south of bridge & 51' west of lake on north end of lake.  
Assumed elevation 100.00'  
Water elevation 81.83 taken 9/16/71  
Water elevation 82.46 taken 7/29/72

EQUIPMENT RECORDING SONAR MAPPED SEPTEMBER 1971

- | TOPOGRAPHIC SYMBOLS |                           | MONTH       | YEAR                          |
|---------------------|---------------------------|-------------|-------------------------------|
| (B) Brush           | (S) Steep slope           | P. Peat     | B Boulders                    |
| (PW) Partly wooded  | (MS) Indefinite shoreline | Mk. Muck    | (S) Stumps & Snags            |
| (W) Wooded          | (M) Marsh                 | C. Clay     | (R) Rock danger to navigation |
| (C) Cleared         | (S) Spring                | M. Marl     | T Emergent vegetation         |
| (P) Pastured        | (IS) Intermittent stream  | Sd. Sand    | (F) Floating vegetation       |
| (A) Agricultural    | (PI) Permanent inlet      | St. Silt    | (BV) Brush shelters           |
| B.M. Bench Mark     | (PO) Permanent outlet     | Gr. Gravel  |                               |
| (D) Dwelling        | (D) Dam                   | R. Rubble   |                               |
| (R) Resort          | (D.N.R.) State owned land | Br. Bedrock |                               |
| (C) Camp            |                           |             |                               |



Access Access with Parking Boat Livery  
Drawn by: E. Eaton  
Field work by: C. Busch, G. Lund, J. Sather

SPECIES OF FISH	Abundance	
	Common	Present
Muskie		
N. Pike	X	
Walleye		
L. M. Bass	X	
S. M. Bass		
Panfish	X	
Trout		X

WATER AREA 74.9 ACRES  
UNDER 3 FT. 11 %  
OVER 20 FT. 40 %  
MAX. DEPTH 33 FEET.  
TOTAL ALK. 50 P.P.M.  
VOLUME 1,224 ACRE FT.  
SHORELINE 2.95 MILES

Source: Wisconsin Department of Natural Resources 608-266-2621  
Porcupine Lake – Bayfield County, Wisconsin DNR Lake Map  
Date – Sep 1971 - Historical Lake Map - Not for Navigation  
A Public Document - Please Identify the Source when using it.