

LAKE NYMPHIA POND
 SECTION 11 & 14
 TOWNSHIP 45 N.
 RANGE 7 W.
 TOWN _____
 COUNTY BAYFIELD

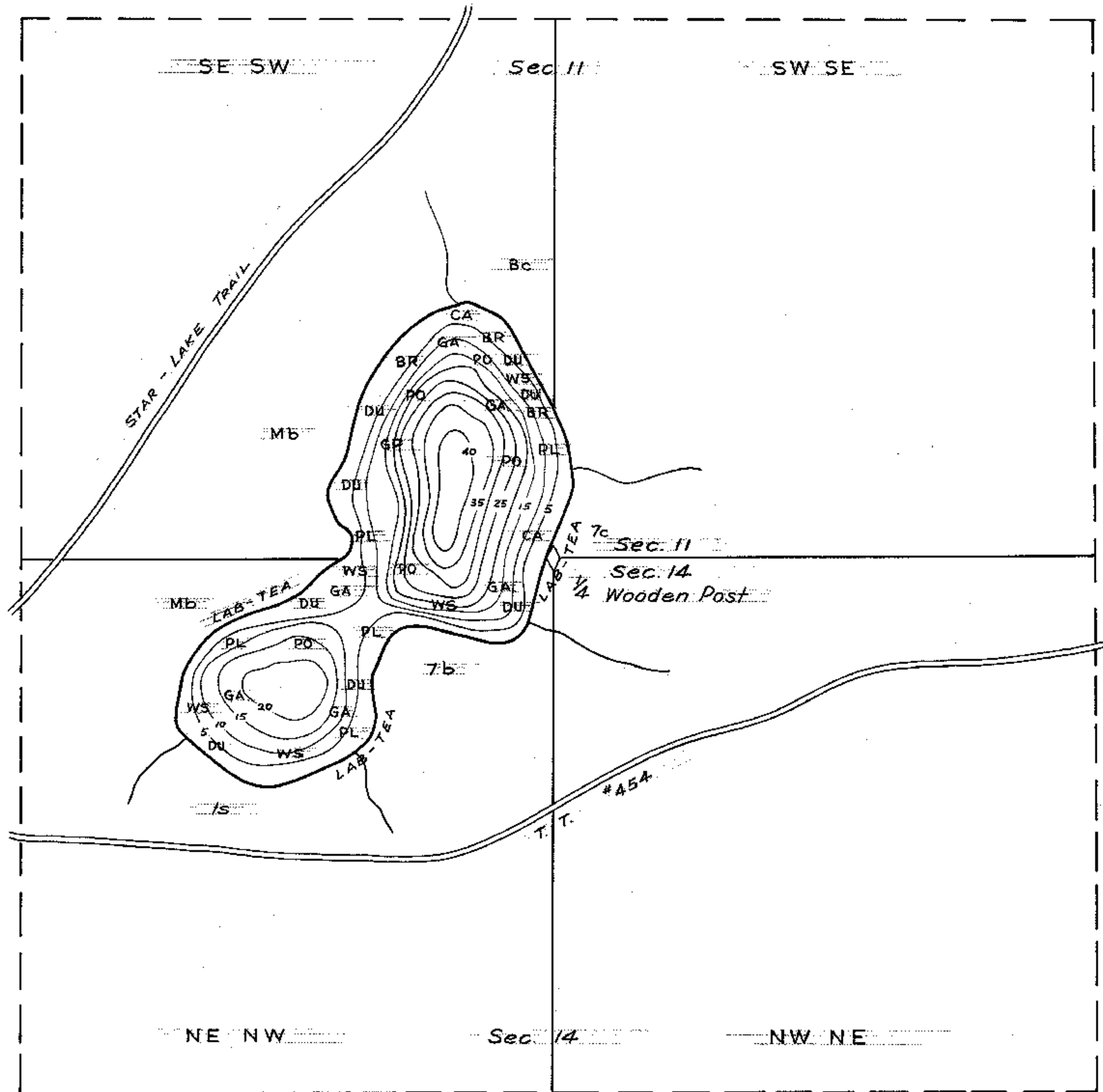

DATE 1937
 SOURCE OF INFORMATION
U.S. Department of Agriculture
Forest Service
 SOUNDINGS 5' Intervals

AREA 12 Acres
 TOTAL SHORELINE .70 Miles
 MAX. DEPTH 40 Feet
 SCALE: 16" = 1 Mile

Source: Wisconsin Department of Natural Resources 608-266-2621
Nymphia Pond – Bayfield County, Wisconsin DNR Lake Map
Date – 1937 - Historical Lake Map - Not for Navigation
A Public Document - Please Identify the Source when using it.