

Brown Beaver Lake
18 Acres
8' Deep

STATE OF MICHIGAN
STATE OF WISCONSIN

B.M. 1708-A, is a brass cap stamped Dept. of Nat. Resources set in a concrete post located 20' W. of lake, 49' S.E. of enclosed patio (GAZEBO), 65' N. of centerline of beach at Wilderness Club on W. side of lake.

Assumed elev. 100.00'
Water level 93.83'
Reading taken 10/13/72

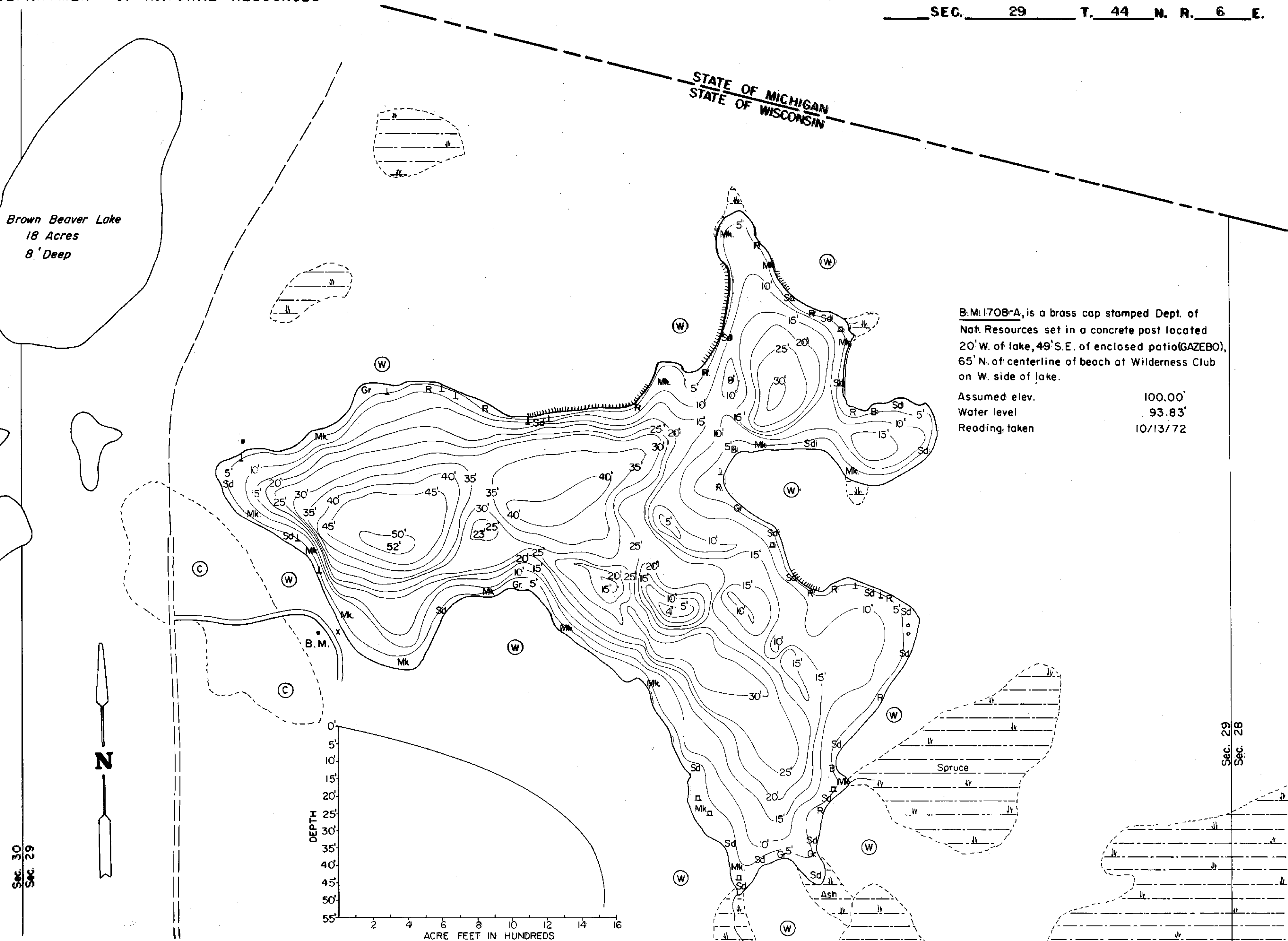

EQUIPMENT RECORDING SONAR MAPPED JUNE 1971

- TOPOGRAPHIC SYMBOLS**
- (B) Brush
 - (PW) Partially wooded
 - (W) Wooded
 - (C) Cleared
 - (P) Pastured
 - (A) Agricultural
 - B.M. Bench Mark
 - Dwelling
 - Resort
 - Camp
 - (|||||) Steep slope
 - Indefinite shoreline
 - (||||) Marsh
 - Spring
 - ~ Intermittent stream
 - Permanent inlet
 - Permanent outlet
 - ↓ Dam
 - D.N.R. State owned land

- LAKE BOTTOM SYMBOLS**
- P. Peat
 - Mk. Muck
 - C. Clay
 - M. Marl
 - Sd. Sand
 - St. Silt
 - Gr. Gravel
 - R. Rubble
 - Br. Bedrock
 - B Boulders
 - ⊙ Stumps & Snags
 - ⊙ Rock danger to navigation
 - T Submergent vegetation
 - ⊥ Emergent vegetation
 - ⊥ Floating vegetation
 - ⊥ Brush shelters

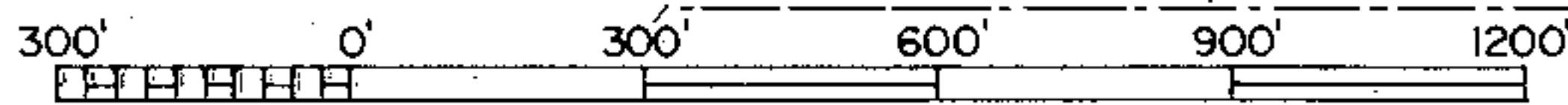

Access Access with Parking Boat Livery
 Drawn by: C. Holt
 Field work by: R. Theis, J. Smith

SPECIES OF FISH	Abundance		
	Abundant	Common	Present
Muskie			X
N. Pike			X
Walleye			X
L.M. Bass			X
S.M. Bass			
Panfish	X		
Trout			

WATER AREA 80.5 ACRES
 UNDER 3 FT. 6.2 %
 OVER 20 FT. 40 %
 MAX. DEPTH 52 FEET.
 TOTAL ALK. 4 P.P.M.
 VOLUME 1522.6 ACRE FT.
 SHORELINE 2.36 MILES

Sec. 29
Sec. 28

Source: Wisconsin Department of Natural Resources 608-266-2621
Murphy Lake - Vilas County, Wisconsin DNR Lake Map
Date – Jun 1971 - Historical Lake Map - Not for Navigation
A Public Document - Please Identify the Source when using it.