

LAKE SURVEY MAP

LONG LAKE
SEC. 2,3,35 T. 47 N. R. 8 W.
BAYFIELD COUNTY

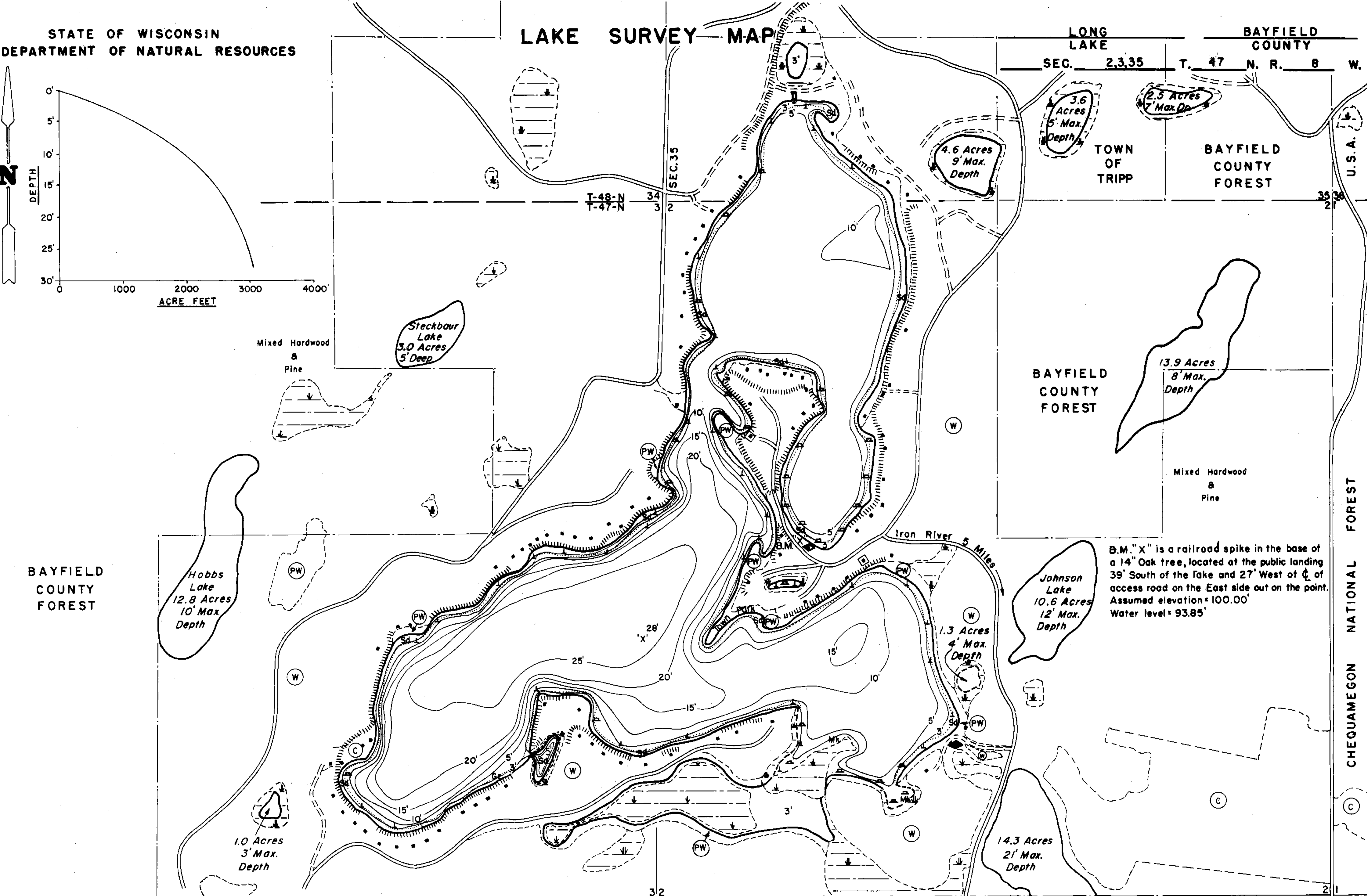
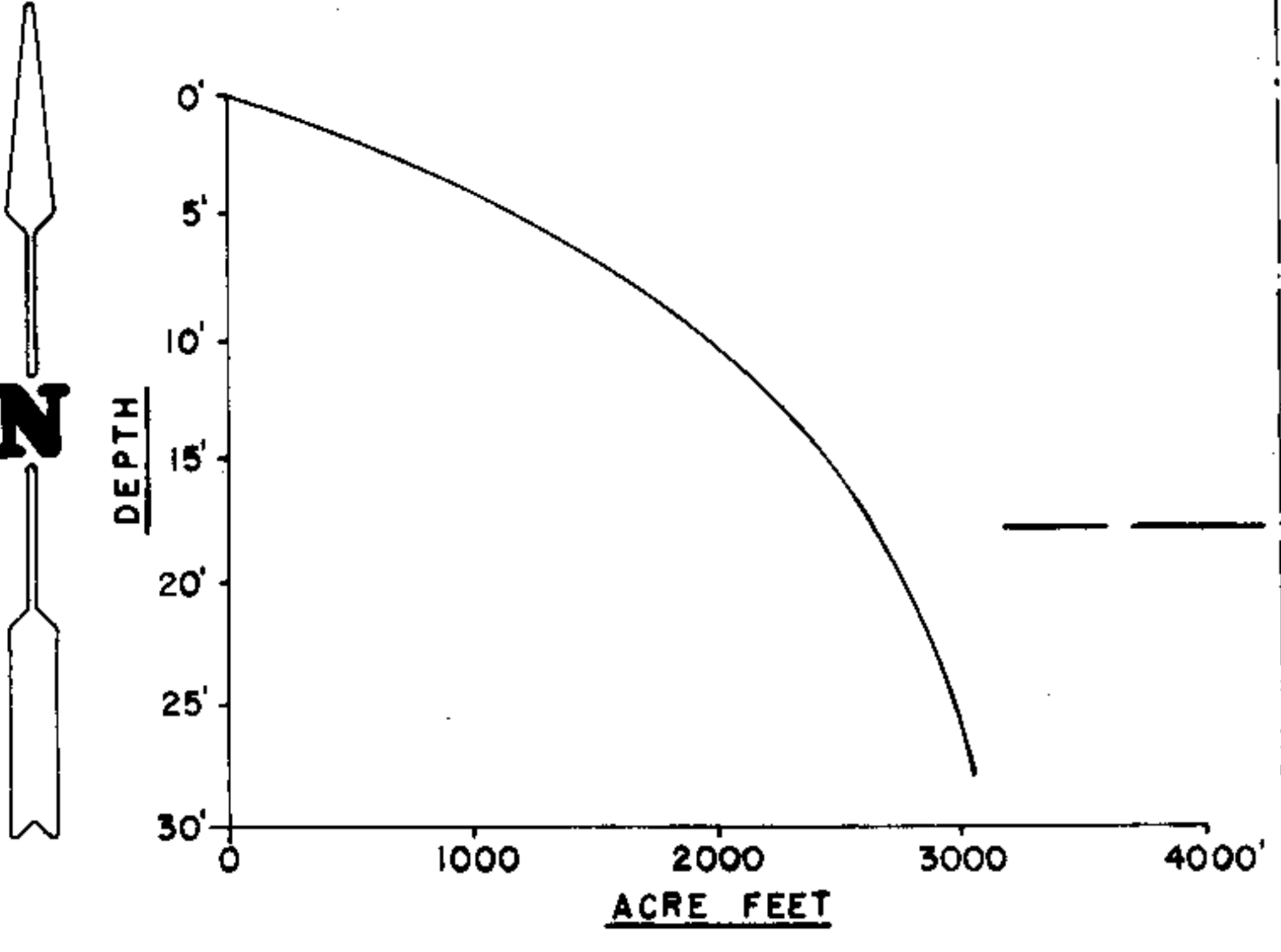

EQUIPMENT RECORDING SONAR MAPPED		SEPT. 1973	
TOPOGRAPHIC SYMBOLS		LAKE BOTTOM SYMBOLS	
(B) Brush	Steep slope	P. Peat	B. Boulders
(PW) Partially wooded	- - - Indefinite shoreline	Mk. Muck	o Stumps & Snags
(W) Wooded	Marsh	C. Clay	Rock danger to navigation
(C) Cleared	Spring	M. Marl	T. Submergent vegetation
(P) Pastured	Intermittent stream	Sd. Sand	Emergent vegetation
(A) Agricultural	Permanent inlet	St. Silt	Floating vegetation
B.M. Bench Mark	Permanent outlet	Gr. Gravel	Brush shelters
■ Dwelling	Dam	R. Rubble	
□ Resort	D.N.R. State owned land	Br. Bedrock	
□ Camp			

BAYFIELD COUNTY FOREST
Mixed Hardwood & Pine

500' 0' 500' 1000' 1500' 2000'

SCALE

◆ Access ◆ Access with Parking ◆ Boat Livery

Drawn by: G. Thuesen
Field work by: C. Busch, K. Cable, L. Sather

SPECIES OF FISH	Abundance		
	Abundant	Common	Present
Muskie			
N. Pike	X		
Walleye	X		
L. M. Bass	X		
S. M. Bass	X		
Panfish	X		
Trout			

WATER AREA 262.5 ACRES
 UNDER 3 FT. 8 %
 OVER 20 FT. 23 %
 MAX. DEPTH 28 FEET.
 TOTAL ALK. 44 P.P.M.
 VOLUME 3052.75 ACRE FT.
 MAIN SHORELINE 6.81 MI.
 ISLAND SHORELINE 0 MI.

B.M. "X" is a railroad spike in the base of a 14" Oak tree, located at the public landing 39' South of the lake and 27' West of center of access road on the East side out on the point. Assumed elevation = 100.00' Water level = 93.85'

CHEQUAMEGON NATIONAL FOREST

Source: Wisconsin Department of Natural Resources 608-266-2621
Long Lake (T47N R8W Sec 3)– Bayfield County, Wisconsin DNR Lake Map
Date – Sep 1973 - Historical Lake Map - Not for Navigation
A Public Document - Please Identify the Source when using it.