

LAKE SURVEY MAP

LAKE BREITZMAN
 SECTION 23
 TOWNSHIP 46 N
 RANGE 15 W
 TOWN OF SUMMIT
 COUNTY DOUGLAS

FORM FI-117

WISCONSIN CONSERVATION DEPARTMENT
 BIOLOGY DIVISION
 LAKE AND STREAM IMPROVEMENT SECTION

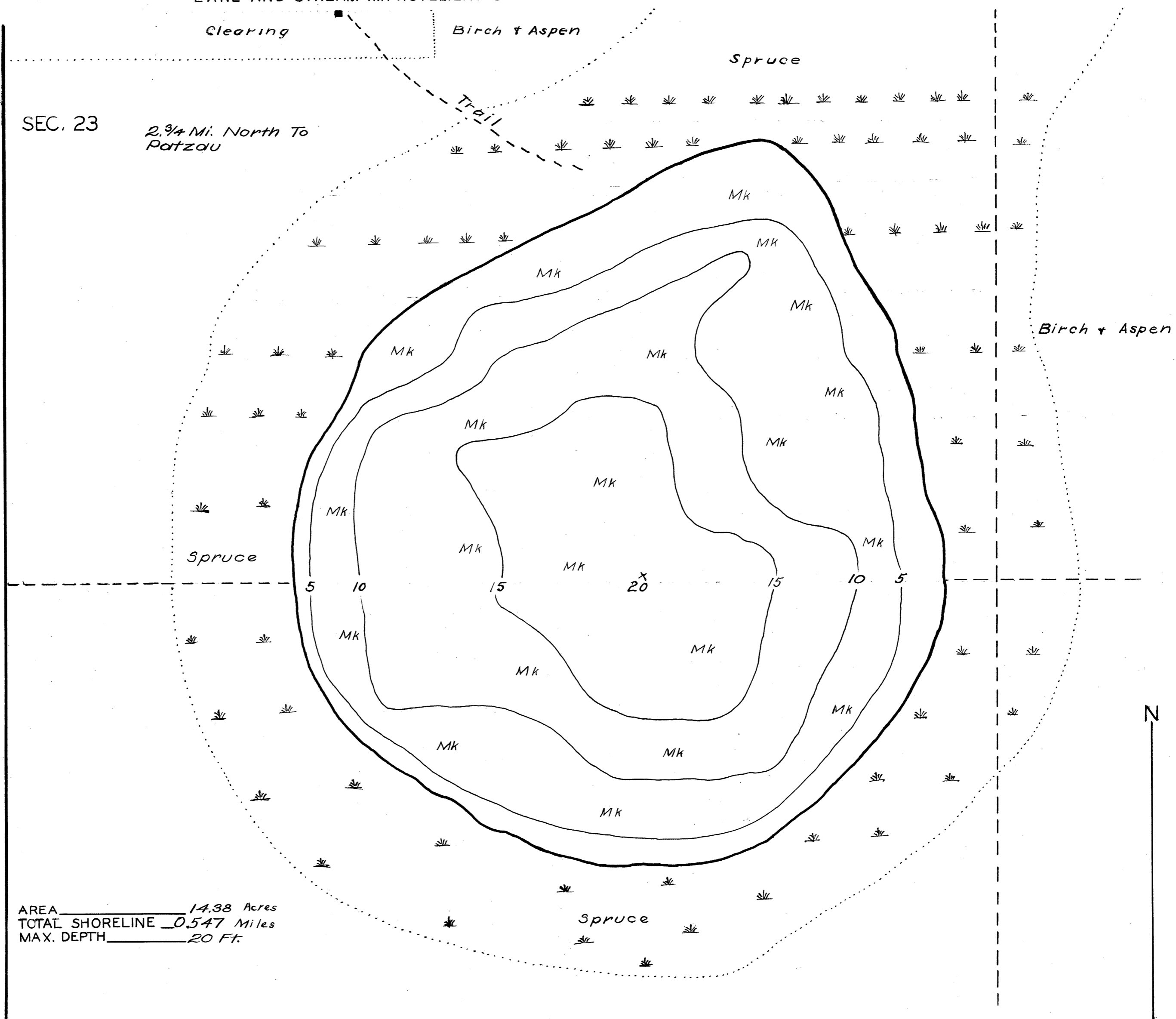

AREA 14.38 Acres
 TOTAL SHORELINE 0.547 Miles
 MAX. DEPTH 20 Ft.

SCALE 1 inch Equals 110 Ft.

DATE Dec 2 1940
 COMPILED BY _____
 TRACED BY (W.P.A.) W.F.S.
 SOURCE OF INFORMATION
W.P.A. Lake Survey Project

 SOUNDINGS 10 Rod Intervals

 DATES OF MAP REVISION _____

 WORK AGENCY W.P.A.

LAKE IMPROVEMENT RECORD	
TYPE	DATE
BRUSH REFUGES	_____
SAPLING TANGLES	_____
SPAWNING BOXES	_____
MINNOW SPAWNERS	_____
TOTAL	_____

- LEGEND
- ☉ WEED BEDS
 - * ROCKY SHOALS
 - Sd SAND
 - Cl CLAY
 - Gr GRAVEL
 - Mk MUCK
 - DWELLING
 - ABANDONED DWELLING
 - ▣ RESORT

*Checked
 W.F.S.
 E.M.H.
 C.P.*

Source: Wisconsin Department of Natural Resources 608-266-2621
Breitzman Lake - Douglas County, Wisconsin DNR Lake Map
December, 1940 Historical Lake Map Not for Navigation
A Public Document - Please Identify the Source when using it.