

LAKE SURVEY MAP

LAKE DEERPRINT
 SECTION 21-28
 TOWNSHIP 45 N
 RANGE 10 W
 TOWN OF HIGHLAND
 COUNTY DOUGLAS

FORM F-117

WISCONSIN CONSERVATION DEPARTMENT
 BIOLOGY DIVISION
 LAKE AND STREAM IMPROVEMENT SECTION

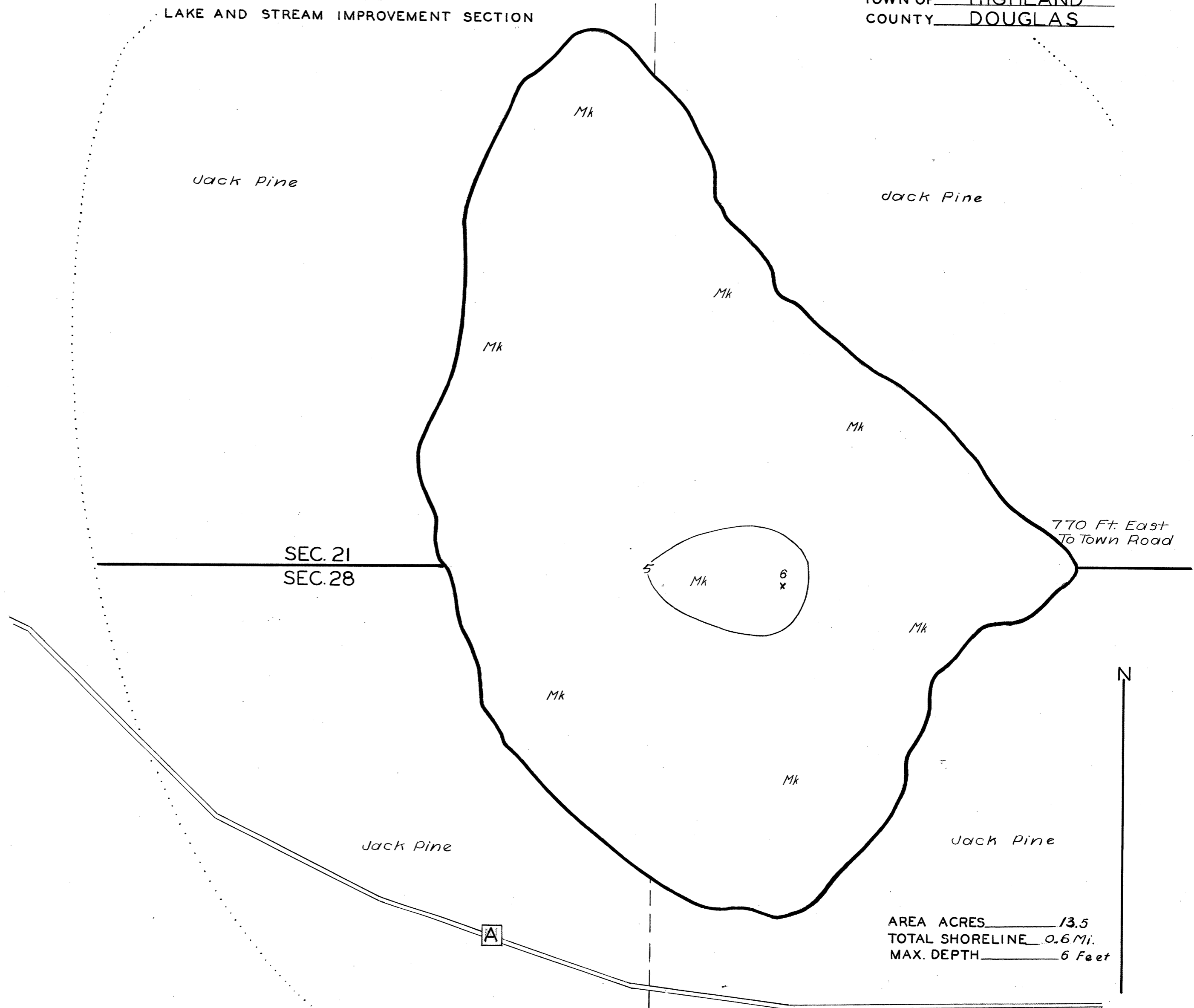

AREA ACRES 13.5
 TOTAL SHORELINE 0.6 Mi.
 MAX. DEPTH 6 Feet

DATE Jan 24 1941
 COMPILED BY _____
 TRACED BY W.P.S.-N.L.M. (W.P.A.)
 SOURCE OF INFORMATION W.P.A. Lake Survey Project

 SOUNDINGS At 165 Foot Intervals

 DATES OF MAP REVISION _____

 WORK AGENCY W.P.A.

SCALE 1 inch Equals 110 Feet.

LAKE IMPROVEMENT RECORD

TYPE	DATE				
BRUSH REFUGES					
SAPLING TANGLES					
SPAWNING BOXES					
MINNOW SPAWNERS					
TOTAL					

- LEGEND**
- WEED BEDS
 - ROCKY SHOALS
 - Sd.* SAND
 - Cl.* CLAY
 - Gr.* GRAVEL
 - Mk.* MUCK
 - DWELLING
 - ABANDONED DWELLING
 - ▣ RESORT

Checked
W.P.S.
E.M.K.
6/24/41

Source: Wisconsin Department of Natural Resources 608-266-2621
Deer Print Lake - Douglas County, Wisconsin DNR Lake Map
Jan., 1941 Historical Lake Map Not for Navigation
A Public Document - Please Identify the Source when using it.