

Sheet 2
 Sheet 1

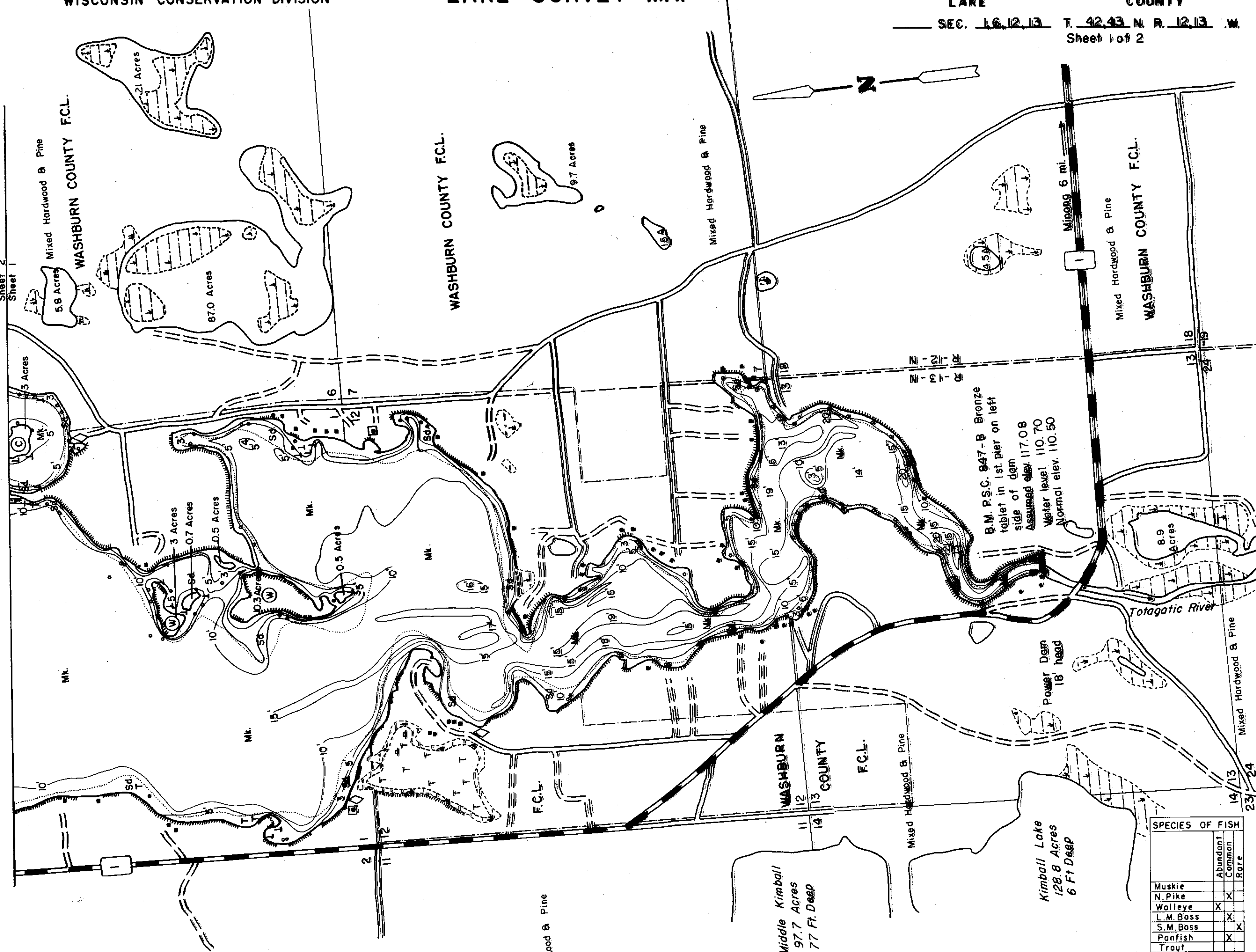

EQUIPMENT RECORDING SONAR MAPPED SEPT 1966
 MO. YR.

- TOPOGRAPHIC SYMBOLS
- (B) Brush
 - (PW) Partially wooded
 - (W) Wooded
 - (C) Cleared
 - (P) Pastured
 - (A) Agricultural
 - B.M. Bench Mark
 - Dwelling
 - Resort
 - ||||| Steep slope
 - - - Indefinite shoreline
 - Marsh
 - Spring
 - intermittent stream
 - Permanent inlet
 - Permanent outlet
 - Dam

- WATER ELEV. 110.70
- LAKE BOTTOM SYMBOLS
- P. Peat
 - Mk. Muck
 - C. Clay
 - M. Marl
 - Sd. Sand
 - Sf. Silt
 - Gr. Gravel
 - R. Rubble
 - Br. Bedrock
 - T Submergent vegetation
 - ↓ Emergent vegetation
 - Floating vegetation
 - Stumps & Snags



◇ Access ◆ Access with Parking ◆ Boat Livery
 Field work by N. Pokorny, C. Busch, L. Sather. Drawn by C. Holt

SPECIES OF FISH		
	Abundant	Rare
Muskie		
N. Pike	X	
Walleye	X	
L.M. Bass		X
S.M. Bass		X
Panfish	X	
TROUT		

1564.3 WITHOUT IS.
 AREA 1609.9 ACRES
 UNDER 3FT. 14.5 %
 OVER 20FT. 0 %
 VOLUME 13,326.5 ACRE FT.
 TOTAL ALK. 48 P.P.M.
 SHORELINE 24.8 MILES
 MAX. DEPTH 21 FEET

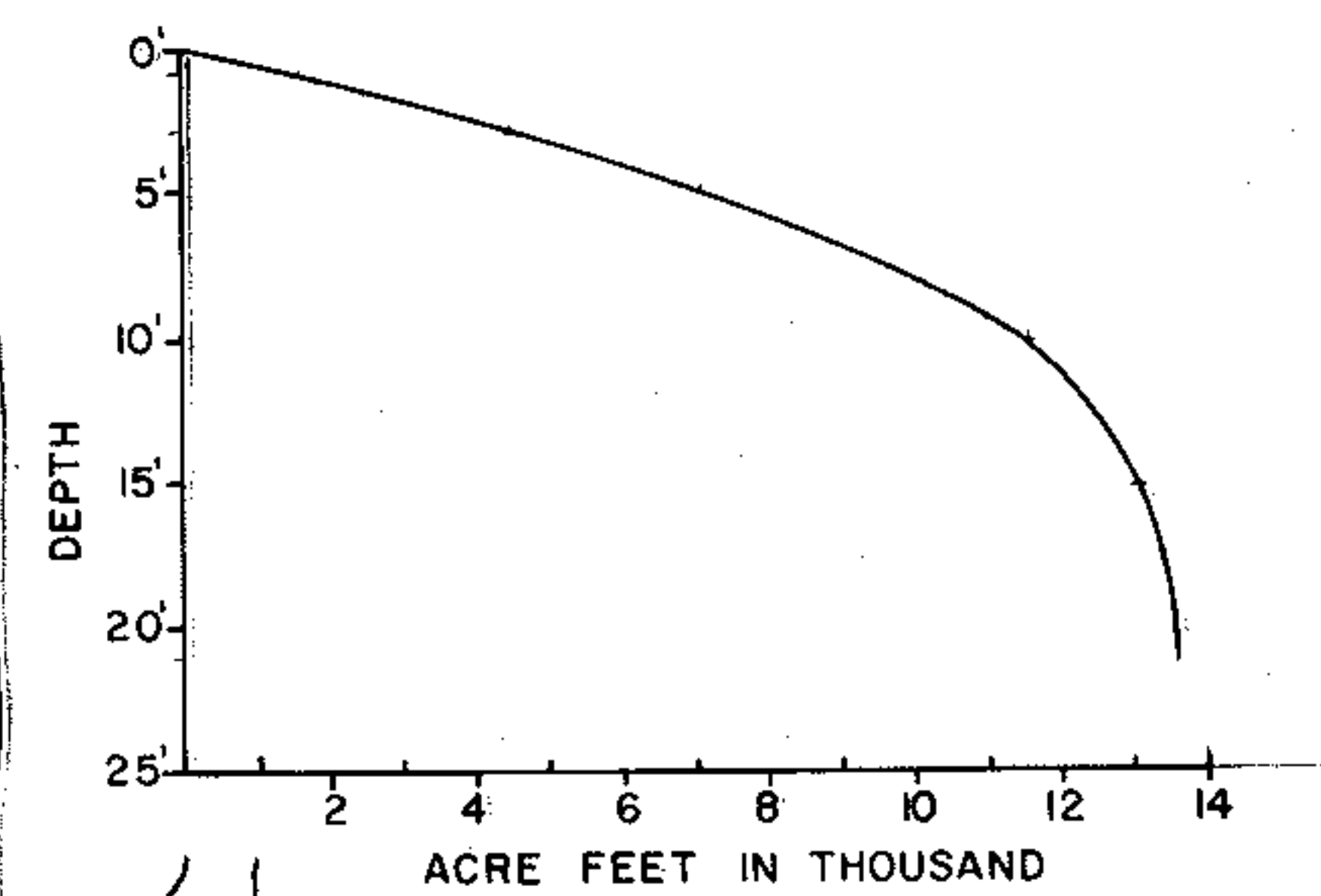
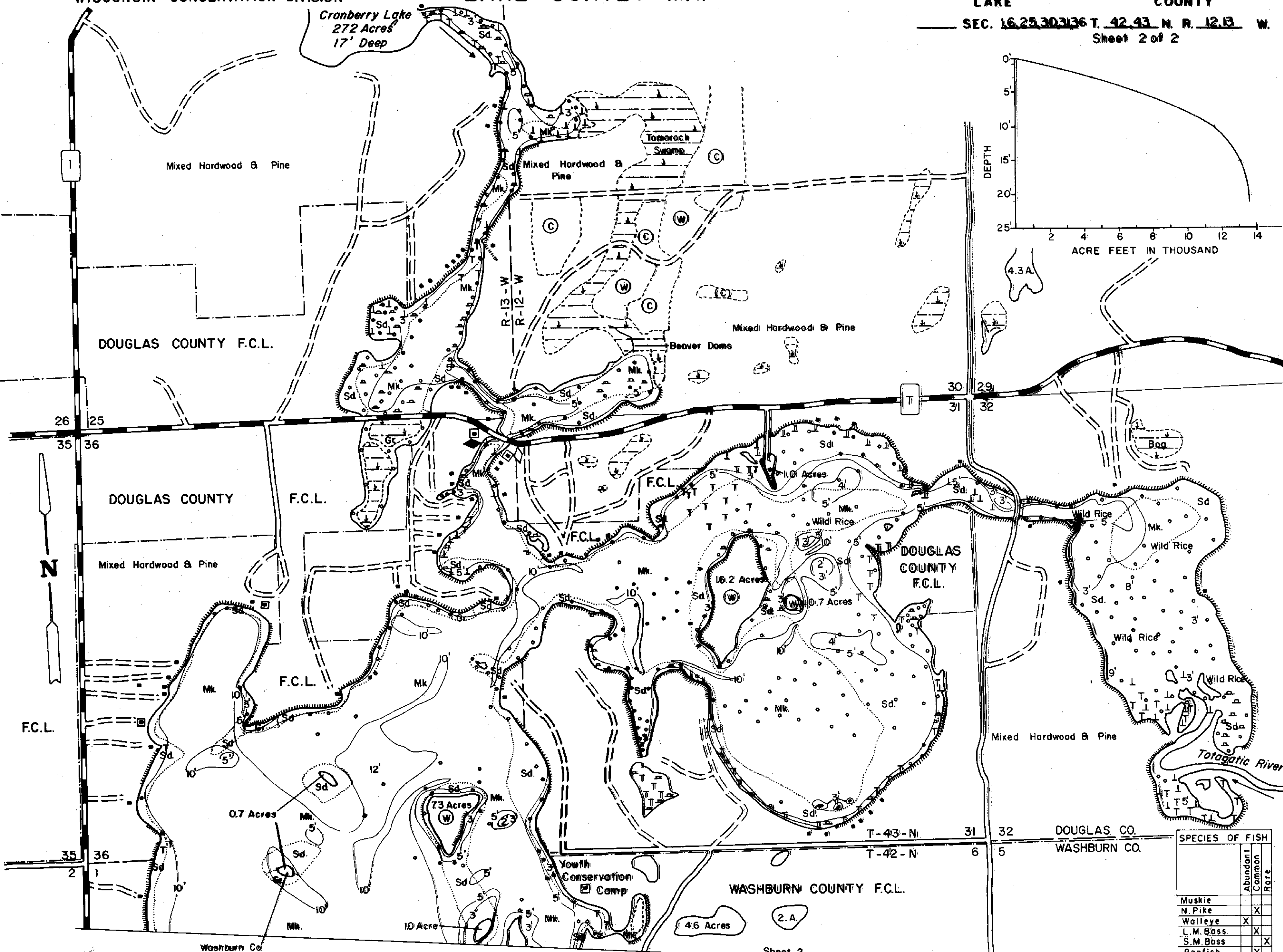

- EQUIPMENT RECORDING SONAR MAPPED SEPT 1966 MO. 1966
- TOPOGRAPHIC SYMBOLS
- (B) Brush
 - (W) Partially wooded
 - (W) Wooded
 - (C) Cleared
 - (P) Pastured
 - (A) Agricultural
 - B.M. Bench Mark
 - Dwelling
 - Resort
- LAKE BOTTOM SYMBOLS
- P. Peaf
 - Mk. Muck
 - M. Marl
 - Sd. Sand
 - St. Silt
 - Gr. Gravel
 - R. Rubble
 - Br. Bedrock
 - T. Submergent vegetation
 - ↓ Emergent vegetation
 - Floating vegetation
 - Stumps & Snags
- WATER ELEV. 110.70

ALL ISLANDS IN DOUGLAS COUNTY ARE COUNTY OWNED



◇ Access ◆ Access with Parking ◆ Boat Livery

Field work by N. Pokorny, C. Busch, L. Sather Drawn by C. Holt

SPECIES OF FISH		Abundant	Common	Rare
Muskie				
N. Pike		X		
Walleye	X			
L. M. Bass	X			
S. M. Bass		X		
Panfish	X			
Trout				

1564.3 WITHOUT IS.
AREA 1609.9 ACRES
UNDER 3FT. 14.5 %
OVER 20FT. 0 %
VOLUME 13,326.5 ACRE FT.
TOTAL ALK. 48 P.P.M.
SHORELINE 24.8 MILES
MAX. DEPTH 21 FEET

Sheet 2
Sheet 1

Source: Wisconsin Department of Natural Resources 608-266-2621
Minong Flowage – Douglas County, Wisconsin DNR Lake Map
Date – Sep 1966 - Historical Lake Map - Not for Navigation
A Public Document - Please Identify the Source when using it.