

LAKE SURVEY MAP

BRIGGS
LAKE

BURNETT
COUNTY

SEC. 28, 29 T. 41 N. R. 15 W.

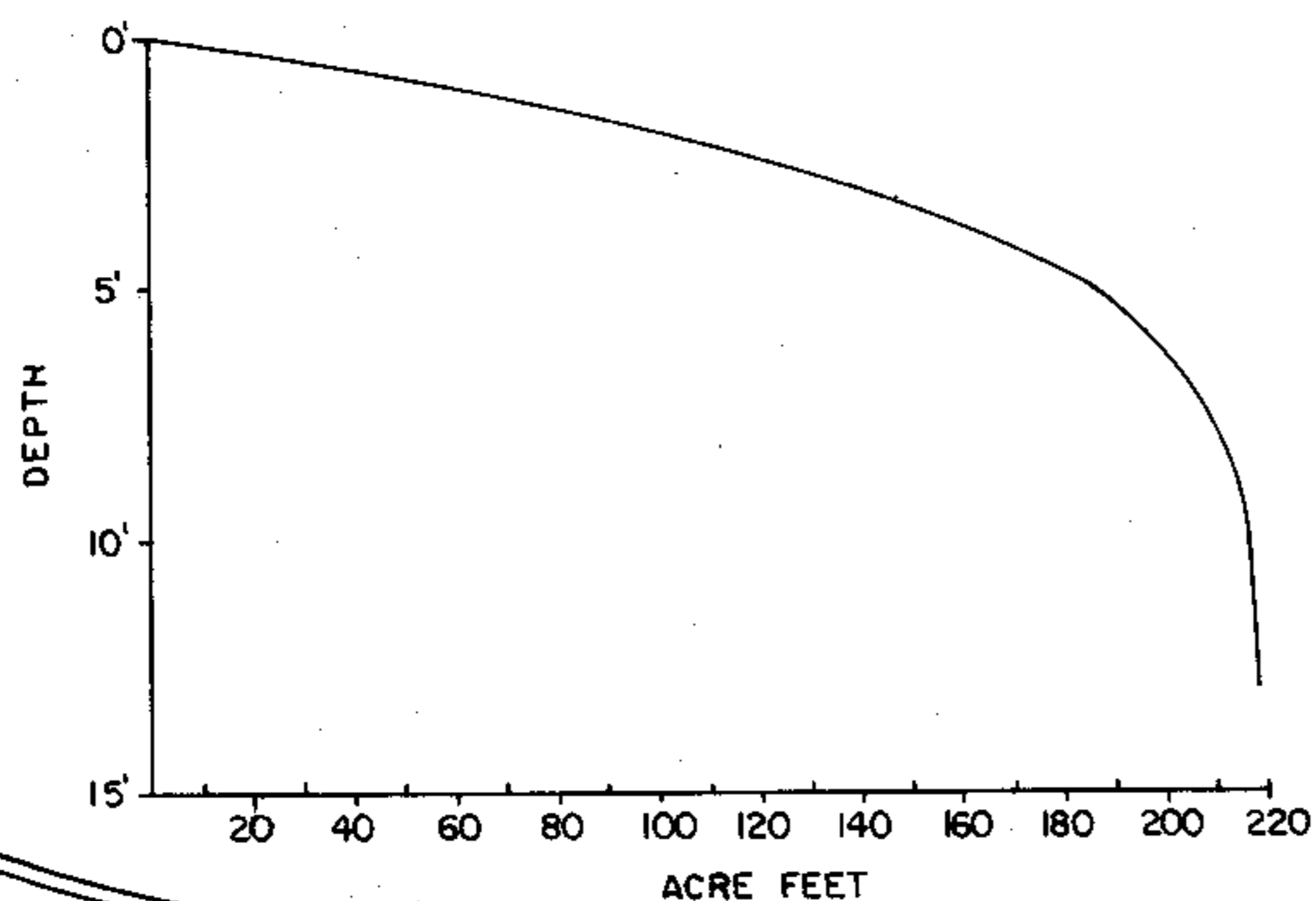

Stone Lake
34 Acres
11' Deep

B.M. 'X' Railroad spike in S. side of a
12" oak, 10' W. of the centerline of the
public boat landing and 42' N. of the
waters edge on the N. side of the lake
Assumed elevation 100.00'
Water level 94.15'

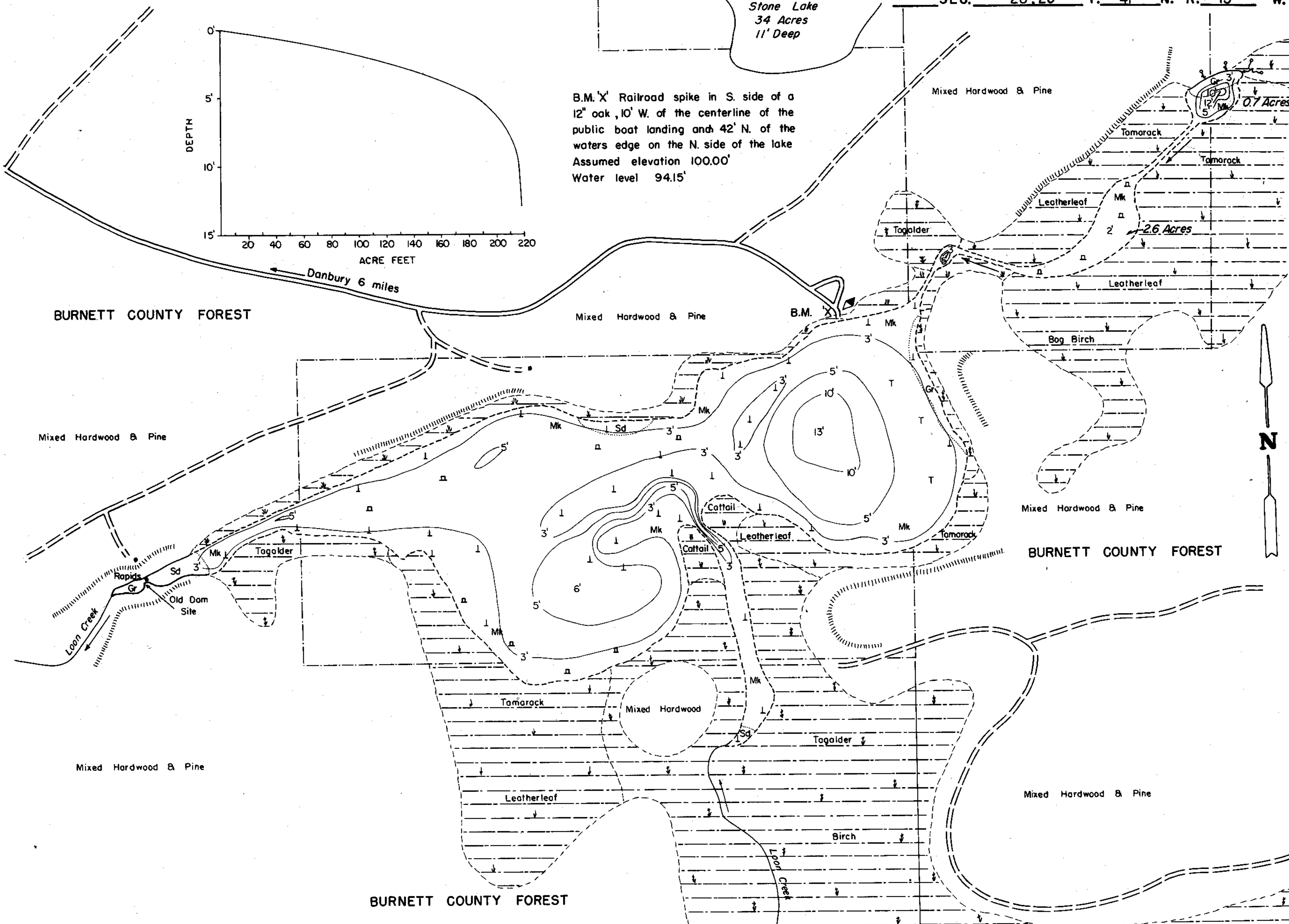

EQUIPMENT RECORDING SONAR MAPPED MAY 1972

- TOPOGRAPHIC SYMBOLS
- (B) Brush
 - (PW) Partially wooded
 - (W) Wooded
 - (C) Cleared
 - (P) Pastured
 - (A) Agricultural
 - B.M. Bench Mark
 - Dwelling
 - Resort
 - ⊠ Camp
 - ||||| Steep slope
 - - - Indefinite shoreline
 - ⊠ Marsh
 - Spring
 - Intermittent stream
 - === Permanent inlet
 - === Permanent outlet
 - ⊠ Dam
 - ⊠ D.N.R. State owned land

- LAKE BOTTOM SYMBOLS
- P. Peat
 - Mk. Muck
 - C. Clay
 - M. Marl
 - Sd. Sand
 - Sl. Silt
 - Gr. Gravel
 - R. Rubble
 - Bc. Bedrock
 - B Boulders
 - ⊠ Stumps & Snags
 - ⊠ Rock danger to navigation
 - T Submergent vegetation
 - ⊠ Emergent vegetation
 - ⊠ Floating vegetation
 - ⊠ Brush shelters

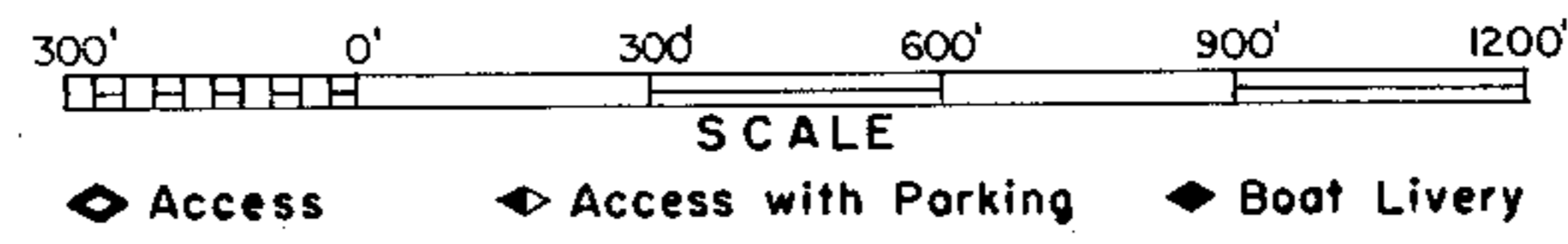

Drawn by: C. Holt
Field work by: C. Busch, G. Lund, L. Sather

SPECIES OF FISH	Abundance		
	Abundant	Common	Present
Muskie			
N. Pike			
Walleye		X	
L. M. Bass			X
S. M. Bass			
Panfish	X		
Trout			

WATER AREA 54.8 ACRES

UNDER 3 FT. 32 %

OVER 20 FT. 0 %

MAX. DEPTH 13 FEET.

TOTAL ALK. 54 P.P.M.

VOLUME 219 ACRE FT.

SHORELINE 232 MILES

Source: Wisconsin Department of Natural Resources 608-266-2621
Briggs Lake – Burnett County, Wisconsin DNR Lake Map
Date – May 1972 - Historical Lake Map - Not for Navigation
A Public Document - Please Identify the Source when using it.