

LAKE SURVEY MAP

BASS LAKE
BARRON COUNTY
SEC. 7 T. 35 N. R. 14 W.

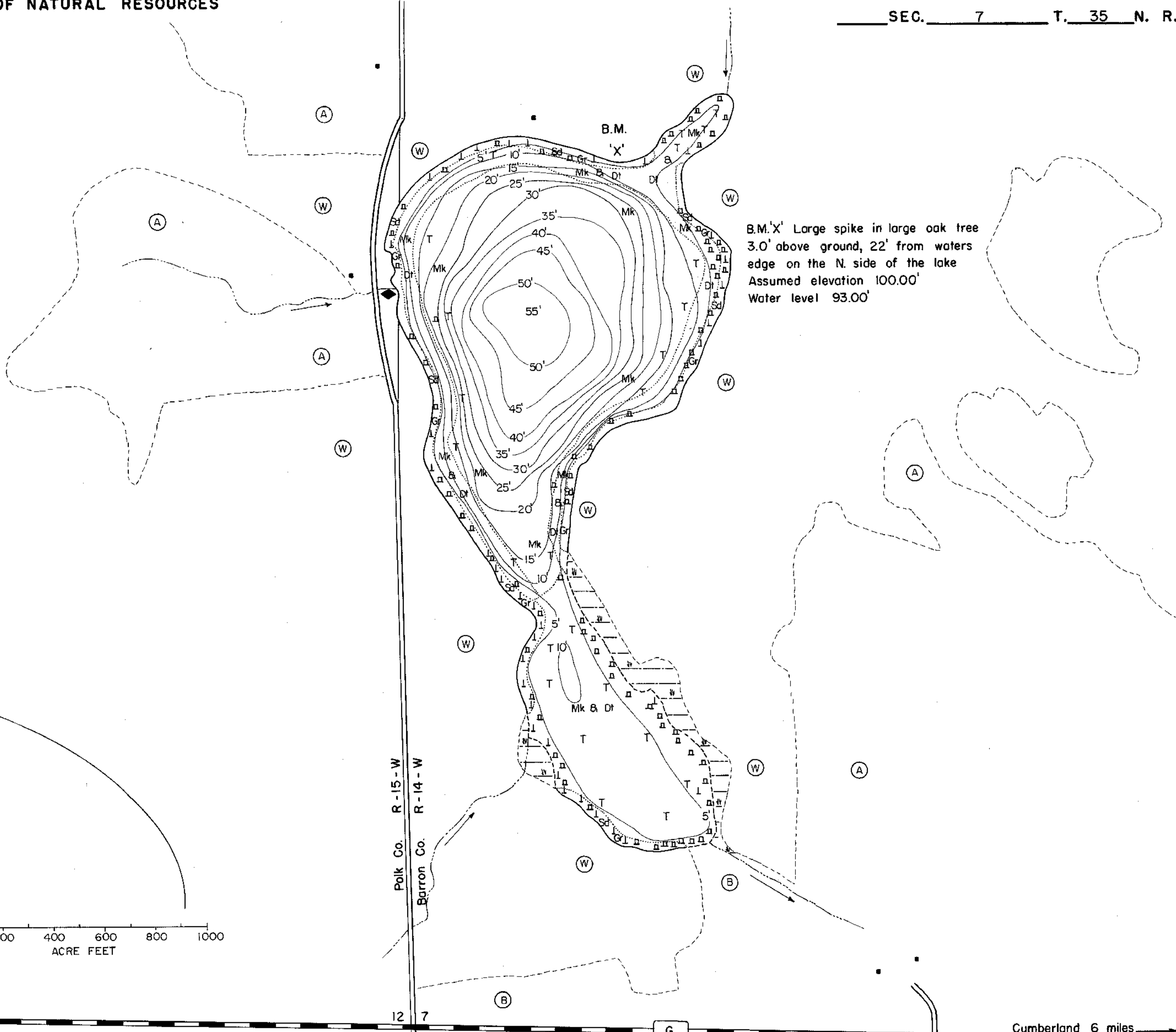

B.M. 'X' Large spike in large oak tree
3.0' above ground, 22' from waters
edge on the N. side of the lake
Assumed elevation 100.00'
Water level 93.00'

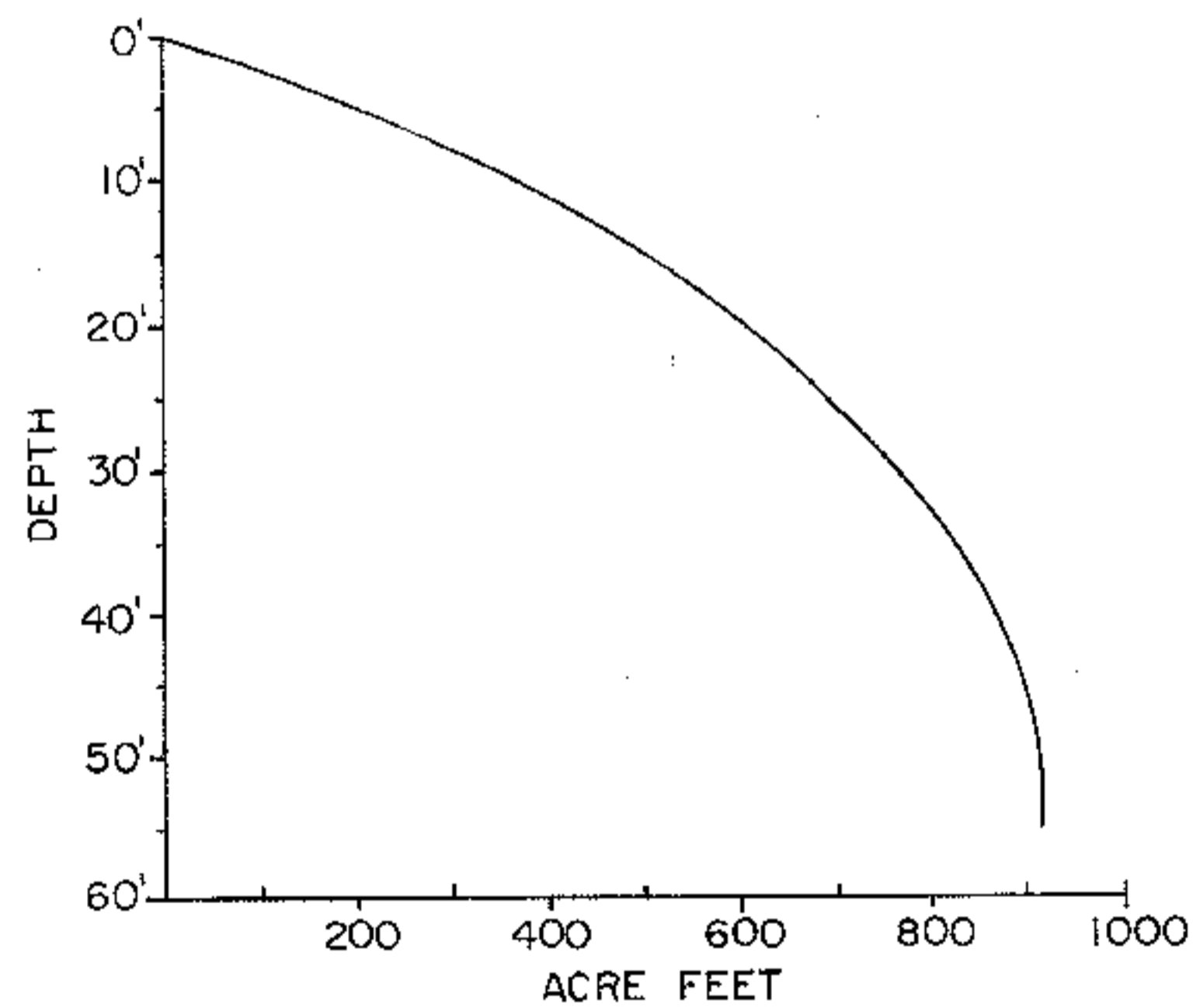

EQUIPMENT SONAR & POLE MAPPED JULY 1972

TOPOGRAPHIC SYMBOLS		LAKE BOTTOM SYMBOLS	
(B) Brush	Steep slope	P. Peat	B. Boulders
(PW) Partially wooded	- - - Indefinite shoreline	Mk. Muck	⊙ Stumps & Snags
(W) Wooded	Marsh	C. Clay	⊛ Rock danger to navigation
(C) Cleared	Spring	M. Marl	T Submergent vegetation
(P) Pastured	Intermittent stream	Sd. Sand	⊥ Emergent vegetation
(A) Agricultural	Permanent inlet	St. Silt	Floating vegetation
B.M. Bench Mark	Permanent outlet	Gr. Gravel	Brush shelters
■ Dwelling	Dam	R. Rubble	
▣ Resort	D.N.R. State owned land	Br. Bedrock	
▢ Camp		Dt. Detritus	

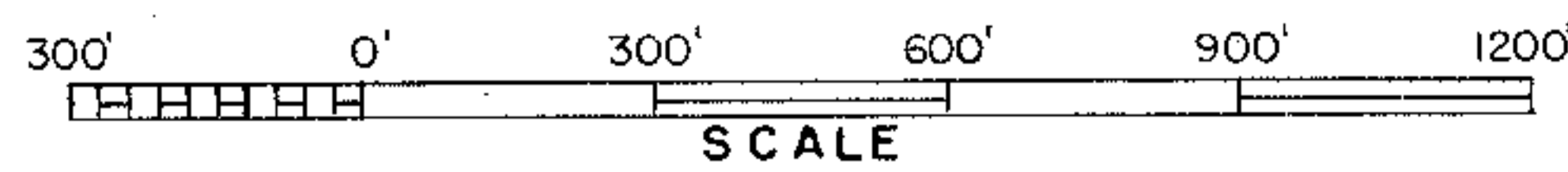

◆ Access ◆ Access with Parking ◆ Boat Livery

Drawn by: C. Holt
Field work by: M. Clark

SPECIES OF FISH	Abundance		
	Abundant	Common	Present
Muskie			
N. Pike		X	
Walleye			X
L. M. Bass			X
S. M. Bass			
Panfish	X		
Trout			

WATER AREA 46.2 ACRES
 UNDER 3 FT. 19 %
 OVER 20 FT. 42 %
 MAX. DEPTH 55 FEET.
 TOTAL ALK. 13 P.P.M.
 VOLUME 915 ACRE FT.
 SHORELINE 1.57 MILES

Source: Wisconsin Department of Natural Resources 608-266-2621
Bass Lake – Barron County, Wisconsin DNR Lake Map
Date – Jul 1972 - Historical Lake Map - Not for Navigation
A Public Document - Please Identify the Source when using it.