

B.M. No. 1566-A, is a railroad spike set in the N. side of 12" elm, 12" above ground, located 35' S. of centerline of town road and 35' W. of boat landing.  
Assumed elevation 100.00  
Water level 92.12' taken 7/3/69

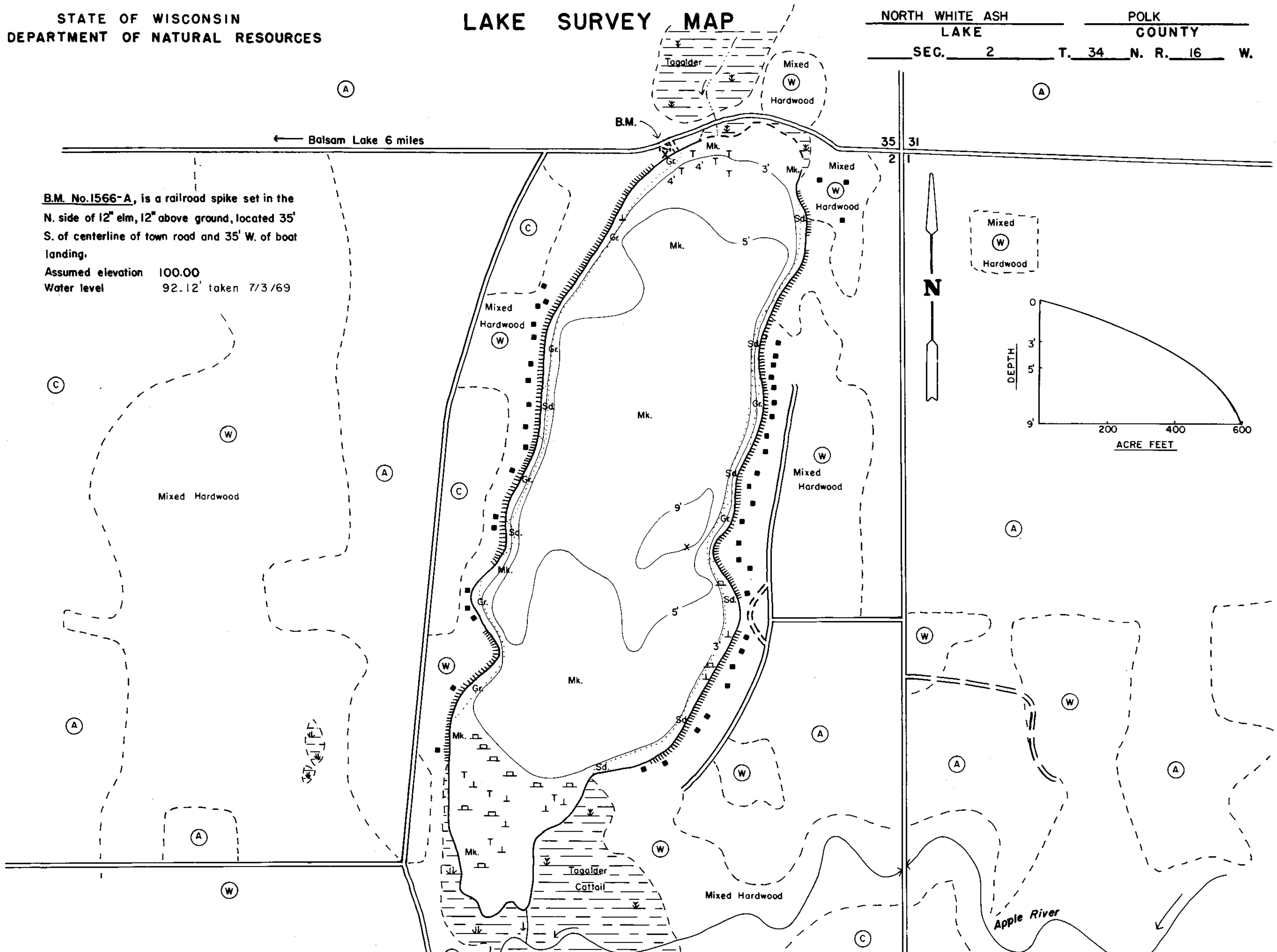

Apple River

EQUIPMENT RECORDING SONAR MAPPED JULY 1969  
MONTH YEAR  
LAKE BOTTOM SYMBOLS

- |                      |                           |             |                             |
|----------------------|---------------------------|-------------|-----------------------------|
| TOPOGRAPHIC SYMBOLS  |                           | P. Peat     | B Boulders                  |
| (B) Brush            | Steep slope               | Mk. Muck    | ⊙ Stumps & Snags            |
| (W) Partially wooded | ~ Indefinite shoreline    | C. Clay     | ⊙ Rock danger to navigation |
| (W) Wooded           | ~ Marsh                   | M. Marl     | T Submergent vegetation     |
| (C) Cleared          | ~ Spring                  | Sd. Sand    | ⊥ Emergent vegetation       |
| (P) Pastured         | ~ Intermittent stream     | St. Silt    | ⊥ Floating vegetation       |
| (A) Agricultural     | ~ Permanent inlet         | Gr. Gravel  | ⊥ Brush shelters            |
| B.M. Bench Mark      | ~ Permanent outlet        | R. Rubble   |                             |
| ■ Dwelling           | ~ Dam                     | Bc. Bedrock |                             |
| ■ Resort             | ~ D.N.R. State owned land |             |                             |
| ■ Camp               |                           |             |                             |



Access Access with Parking Boat Livery

Drawn by: T. Ginder  
Field work by: C. Busch, C. Belter, & S. Johannes

SPECIES OF FISH	ABUNDANCE		
	Abundant	Common	Present
Muskie			
N. Pike		X	
Walleye			
L.M. Bass		X	
S.M. Bass			
Panfish		X	
Trout			

WATER AREA 118.6 ACRES  
UNDER 3 FT. 18 %  
OVER 20 FT. 0 %  
MAX. DEPTH 9 FEET.  
TOTAL ALK. 95 P.P.M.  
VOLUME 594.77 ACRE FT.  
SHORELINE 2.11 MILES

Source: Wisconsin Department of Natural Resources 608-266-2621  
North White Ash Lake – Polk County, Wisconsin DNR Lake Map  
Date – Jul 1969 - Historical Lake Map - Not for Navigation  
A Public Document - Please Identify the Source when using it.