

LAKE SURVEY MAP

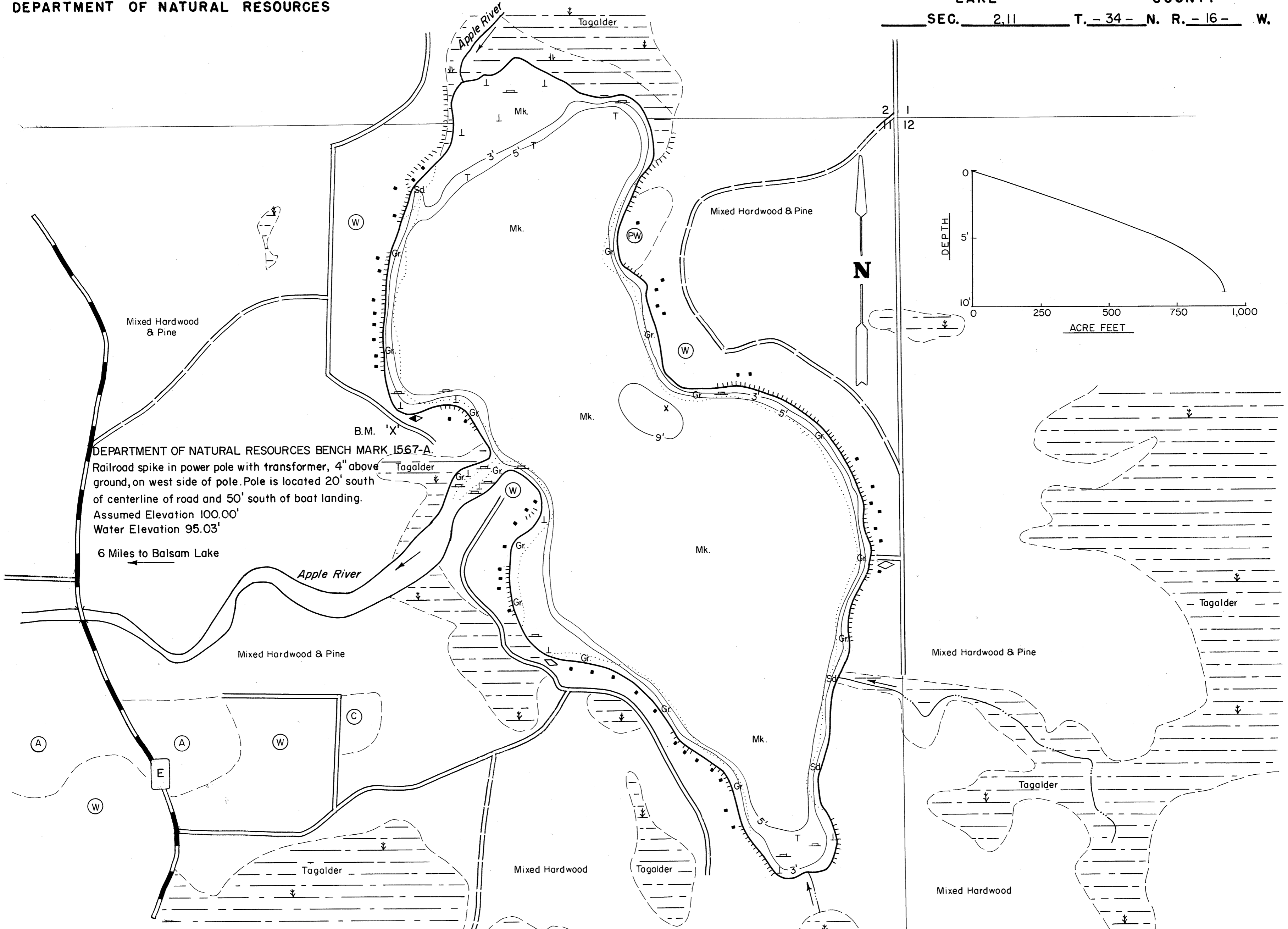

DEPARTMENT OF NATURAL RESOURCES BENCH MARK 1567-A.
Railroad spike in power pole with transformer, 4" above ground, on west side of pole. Pole is located 20' south of centerline of road and 50' south of boat landing.
Assumed Elevation 100.00'
Water Elevation 95.03'
6 Miles to Balsam Lake

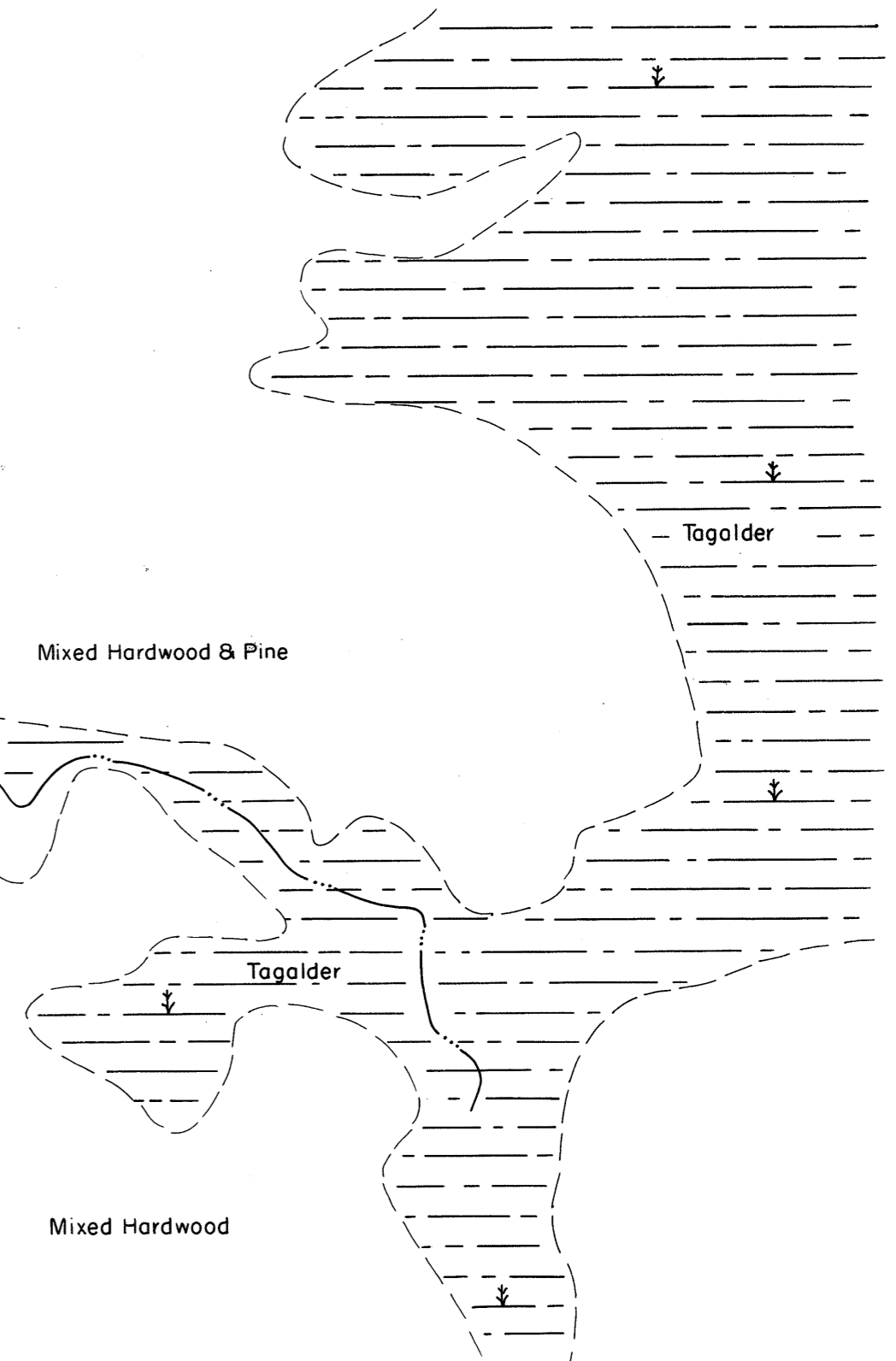
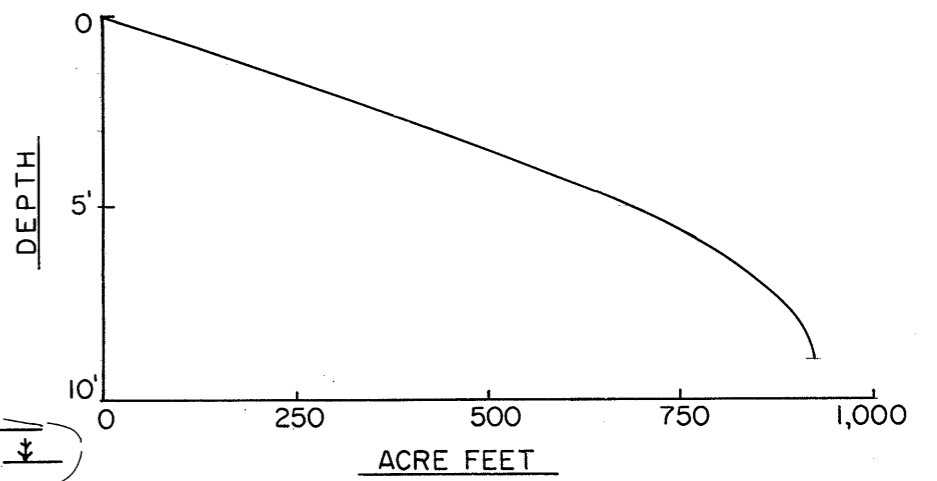

EQUIPMENT RECORDING SONAR MAPPED JULY 1969
MONTH YEAR
LAKE BOTTOM SYMBOLS

- | TOPOGRAPHIC SYMBOLS | | LAKE BOTTOM SYMBOLS | |
|-----------------------|-------------------------|---------------------|-----------------------------|
| (B) Brush | Steep slope | P. Peat | B Boulders |
| (PW) Partially wooded | ~ Indefinite shoreline | Mk. Muck | o Stumps & Snags |
| (W) Wooded | ~ Marsh | C. Clay | o Rock danger to navigation |
| (C) Cleared | o Spring | M. Marl | T Submergent vegetation |
| (P) Pastured | ~ Intermittent stream | Sd. Sand | ⊥ Emergent vegetation |
| (A) Agricultural | ~ Permanent inlet | St. Silt | ~ Floating vegetation |
| B.M. Bench Mark | ~ Permanent outlet | Gr. Gravel | ~ Brush shelters |
| ■ Dwelling | ~ Dam | R. Rubble | |
| ■ Resort | D.N.R. State owned land | Br. Bedrock | |
| ■ Camp | | | |



◆ Access ◆ Access with Parking ◆ Boat Livery

Drawn by: J. Roth
Field work by: C. Busch, C. Belter, S. Johannes

SPECIES OF FISH	ABUNDANCE	
	Abundant	Common
Muskie		
N. Pike	X	
Walleye		
L.M. Bass	X	
S.M. Bass		
Panfish	X	
Trout		

WATER AREA 153.1 ACRES
UNDER 3 FT. 14 %
OVER 20 FT. 0 %
MAX. DEPTH 9 FEET.
TOTAL ALK. 136 P.P.M.
VOLUME 924.0 ACRE FT.
SHORELINE 2.53 MILES

Source: Wisconsin Department of Natural Resources 608-266-2621
White Ash Lake – Polk County, Wisconsin DNR Lake Map
Date – Jul 1969 - Historical Lake Map - Not for Navigation
A Public Document - Please Identify the Source when using it.