

SURVEY MAP

BIG ROUND
LAKE

POLK
COUNTY

SEC. 11, 12, 13, 14 T. -35- N. R. -16- P.W.

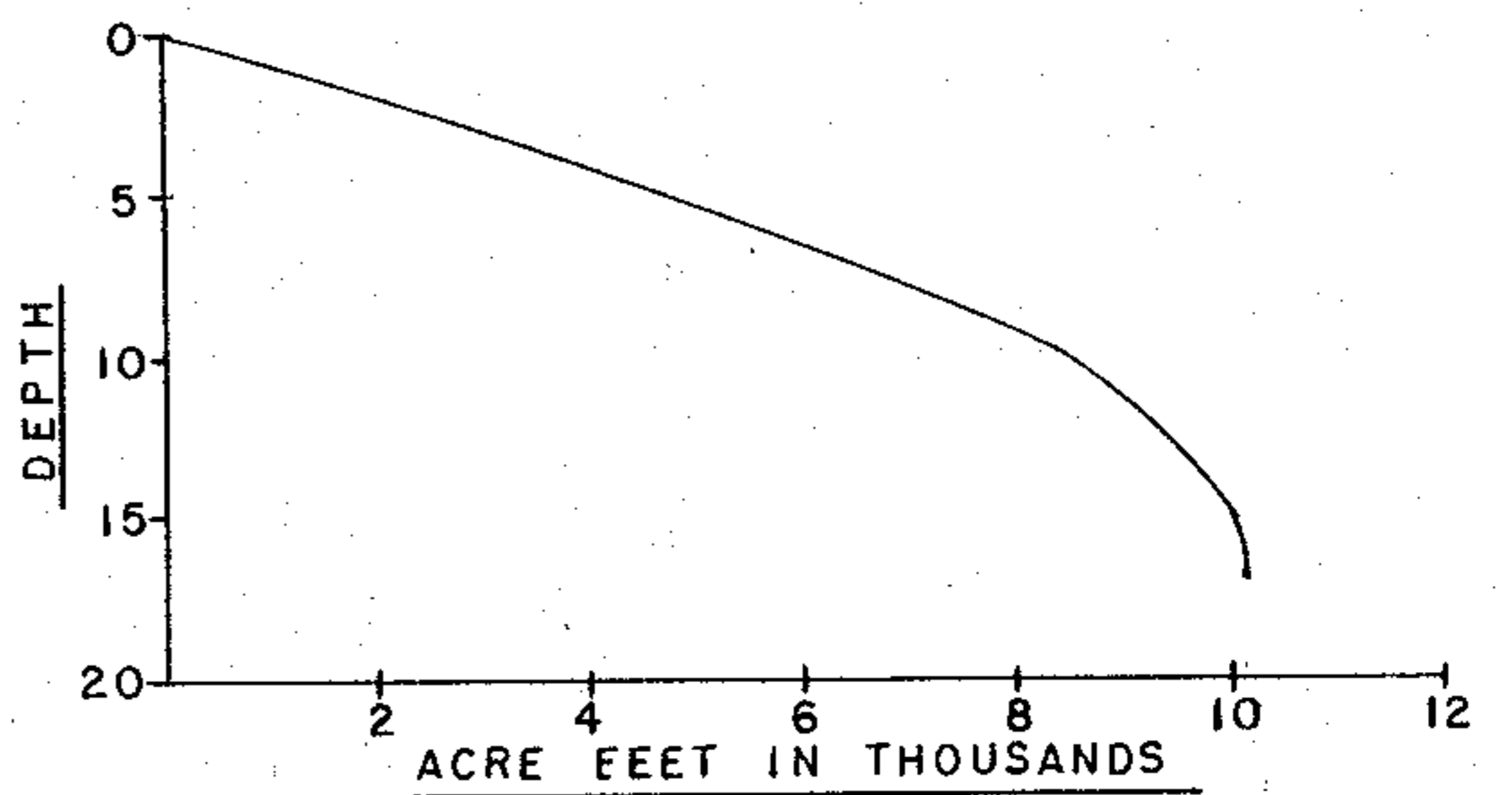
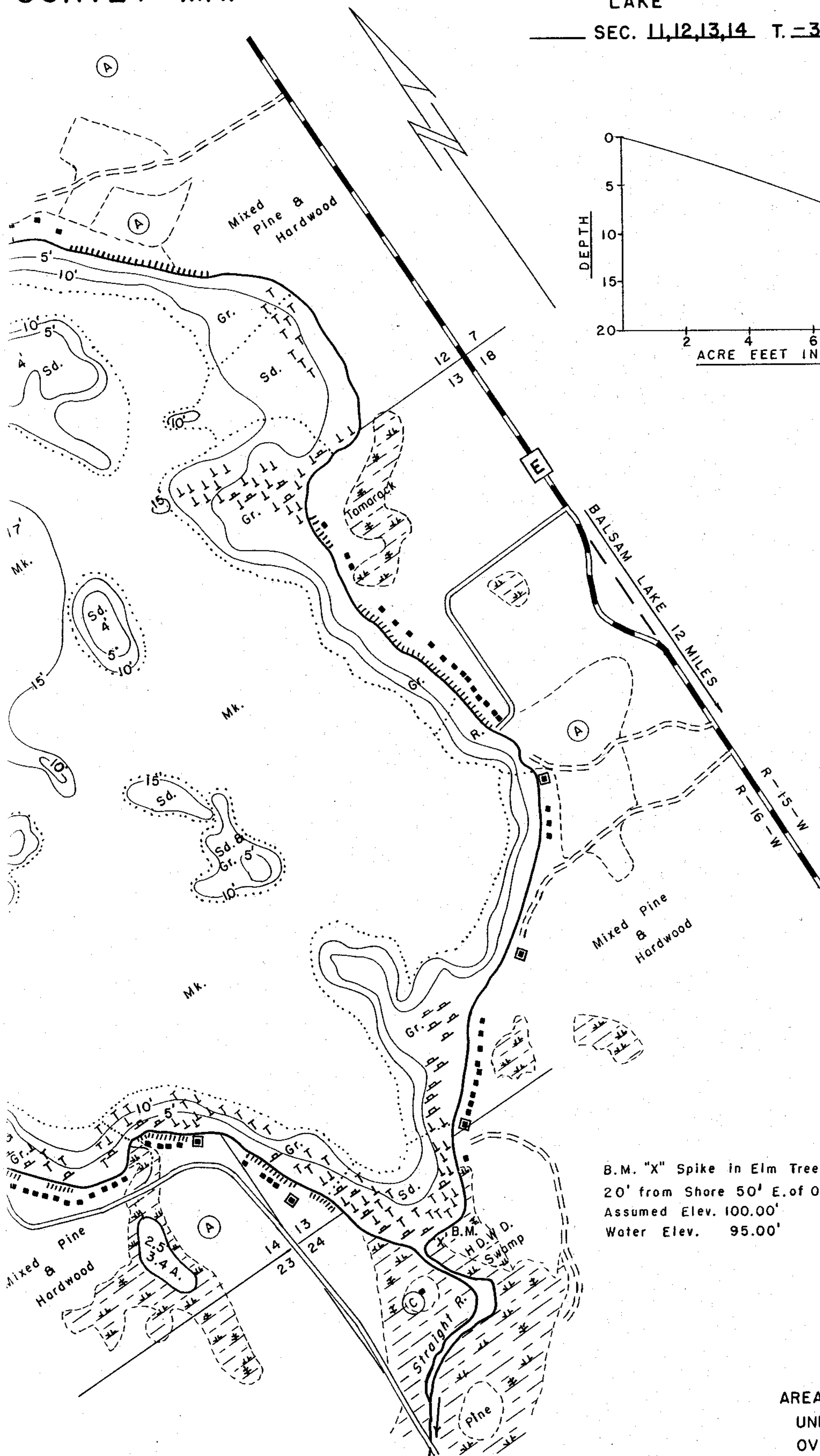

B.M. "X" Spike in Elm Tree
20' from Shore 50' E. of Outlet
Assumed Elev. 100.00'
Water Elev. 95.00'

SPECIES OF FISH			
	Abundant	Common	Rare
Muskie			
N. Pike		X	
Walleye		X	
L.M. Bass	X		
S.M. Bass			
Panfish	X		
Trout			

1,016.5 WITH ISLAND
AREA 1,015.1 ACRES
UNDER 5 FT. 19 %
OVER 20 FT. 0 %
VOLUME 10,093.5 ACRE FT.
TOTAL ALK. 105 P.P.M.
SHORELINE 5.7 MILES
MAX. DEPTH 17 FEET

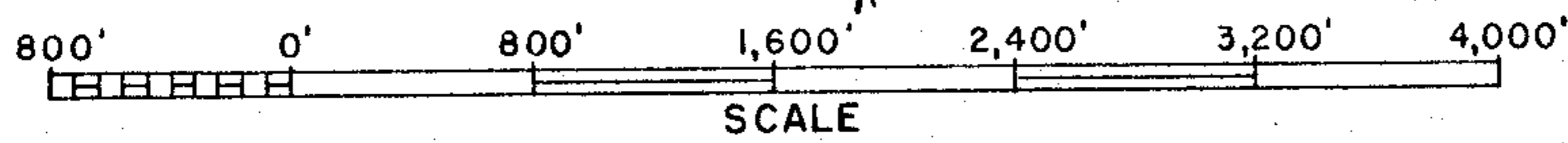

- ◇ Access
- ◀ Access with Parking
- ◆ Boat Livery



EQUIPMENT RECORDING SONAR MAPPED JULY 1964
MO. YR.

- TOPOGRAPHIC SYMBOLS**
- (B) Brush
 - (PW) Partially wooded
 - (W) Wooded
 - (C) Cleared
 - (P) Pastured
 - (A) Agricultural
 - B.M. Bench Mark
 - Dwelling
 - Resort
 - ||||| Steep slope
 - ~ Indefinite shoreline
 - Marsh
 - o Spring
 - Intermittent stream
 - Permanent inlet
 - Permanent outlet
 - Dam

WATER ELEV. 95.00'

- LAKE BOTTOM SYMBOLS**
- P. Peat
 - Mk. Muck
 - C. Clay
 - M. Marl
 - Sd. Sand
 - St. Silt
 - Gr. Gravel
 - R. Rubble
 - Br. Bedrock
 - T Submergent vegetation
 - Emergent vegetation
 - Floating vegetation

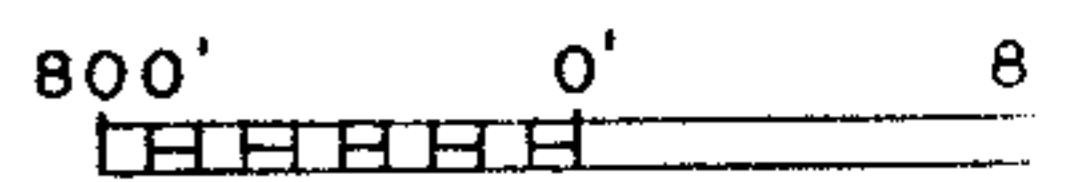

◇ Access

Field work by R. Hopke, M.

Source: Wisconsin Department of Natural Resources 608-266-2621
Big Round Lake – Polk County, Wisconsin DNR Lake Map
Date – Jul 1964 - Historical Lake Map - Not for Navigation
A Public Document - Please Identify the Source when using it.