

LAKE SURVEY MAP

MUD (BRIDGET)
LAKE

POLK
COUNTY

SEC. 33 T. 34 N. R. 17 W.

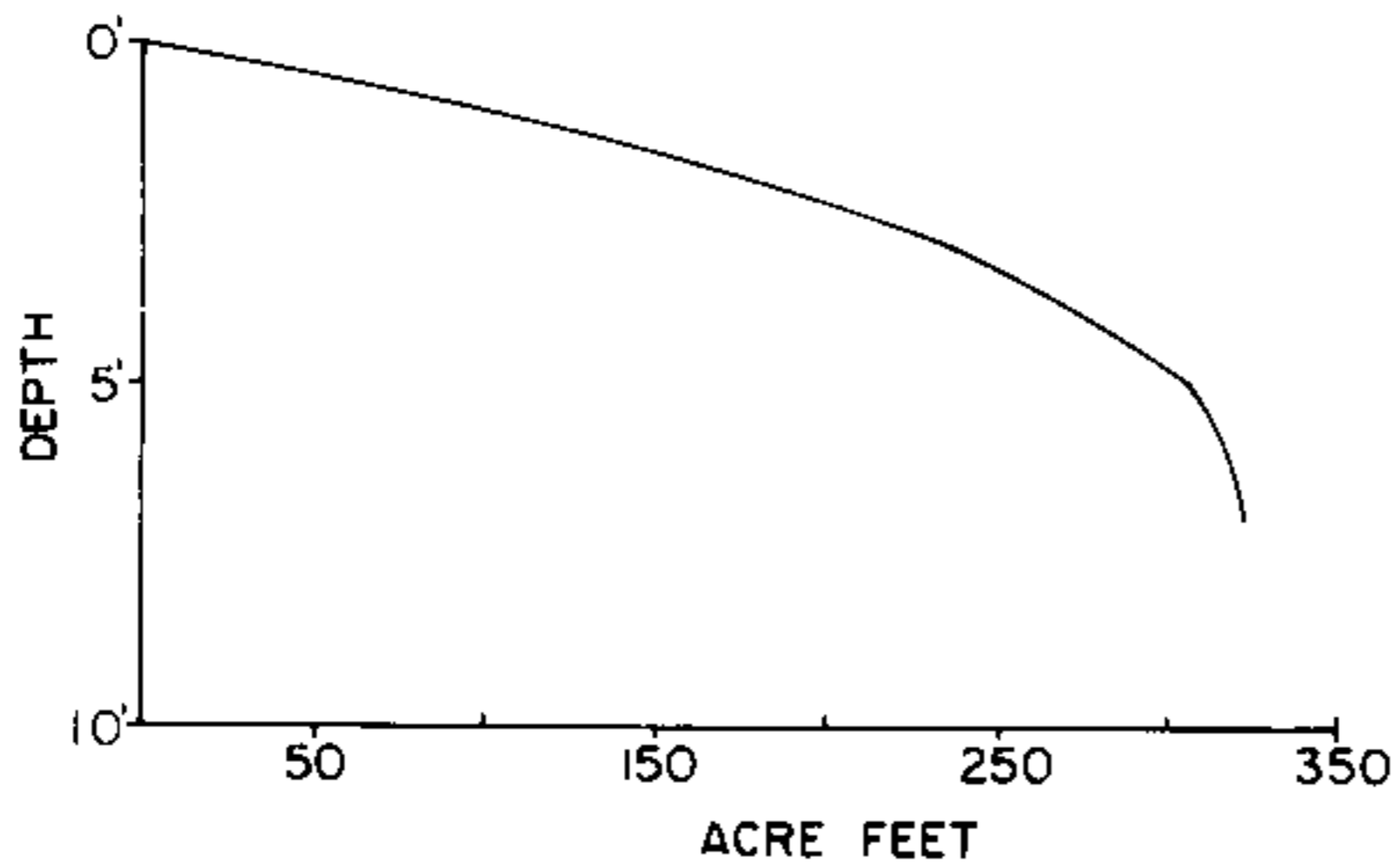
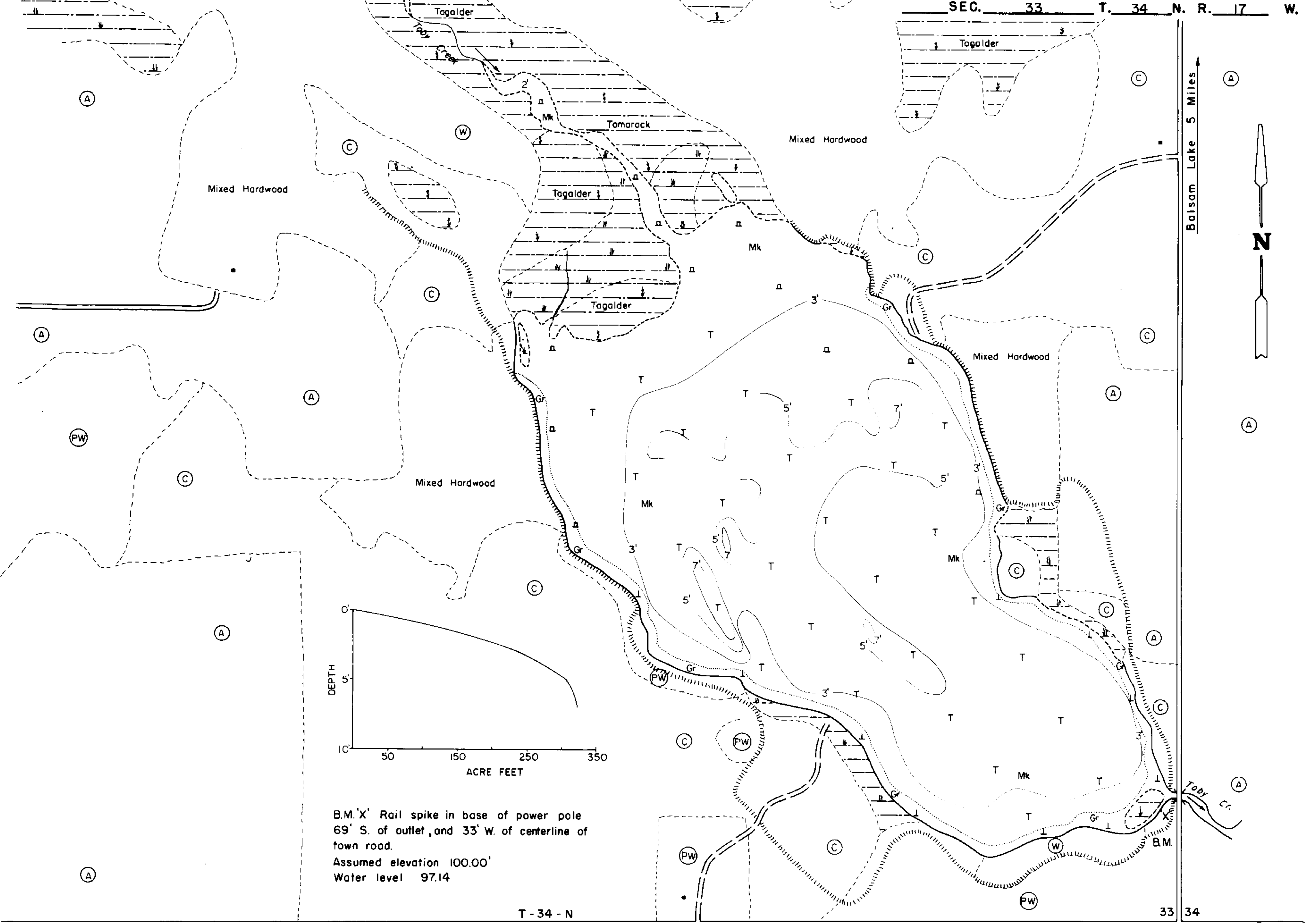

B.M. 'X' Rail spike in base of power pole
69' S. of outlet, and 33' W. of centerline of
town road.
Assumed elevation 100.00'
Water level 97.14

EQUIPMENT RECORDING SONAR MAPPED MAY 1971

- TOPOGRAPHIC SYMBOLS**
- (B) Brush
 - (PW) Partially wooded
 - (W) Wooded
 - (C) Cleared
 - (P) Pastured
 - (A) Agricultural
 - B.M. Bench Mark
 - Dwelling
 - Resort
 - Camp

- LAKE BOTTOM SYMBOLS**
- P. Peat
 - Mk. Muck
 - C. Clay
 - M. Marl
 - Sd. Sand
 - St. Silt
 - Gr. Gravel
 - R. Rubble
 - Br. Bedrock
 - ||||| Steep slope
 - - - Indefinite shoreline
 - Marsh
 - Spring
 - Intermittent stream
 - Permanent inlet
 - Permanent outlet
 - Dam
 - D.N.R. State owned land
 - ▲ Boulders
 - ⊙ Stumps & Snags
 - ⊙ Rock danger to navigation
 - T Submergent vegetation
 - ⊥ Emergent vegetation
 - ⊥ Floating vegetation
 - ⊥ Brush shelters



◆ Access ◆ Access with Parking ◆ Boat Livery

Drawn by: C. Holt
Field work by: C. Busch, G. Lund, L. Sather

SPECIES OF FISH	Abundant	Common	Present
	Muskie		
N. Pike		X	
Walleye			
L.M. Bass		X	
S.M. Bass			
Panfish	X		
Trout			

WATER AREA 95.4 ACRES
 UNDER 3 FT. 36 %
 OVER 20 FT. 0 %
 MAX. DEPTH 7 FEET.
 TOTAL ALK. 88 P.P.M.
 VOLUME 322 ACRE FT.
 SHORELINE 2.35 MILES

Source: Wisconsin Department of Natural Resources 608-266-2621
Mud Lake (Bridget Lake) – Polk County, Wisconsin DNR Lake Map
Date – May 1971 - Historical Lake Map - Not for Navigation
A Public Document - Please Identify the Source when using it.