

# LAKE SURVEY MAP

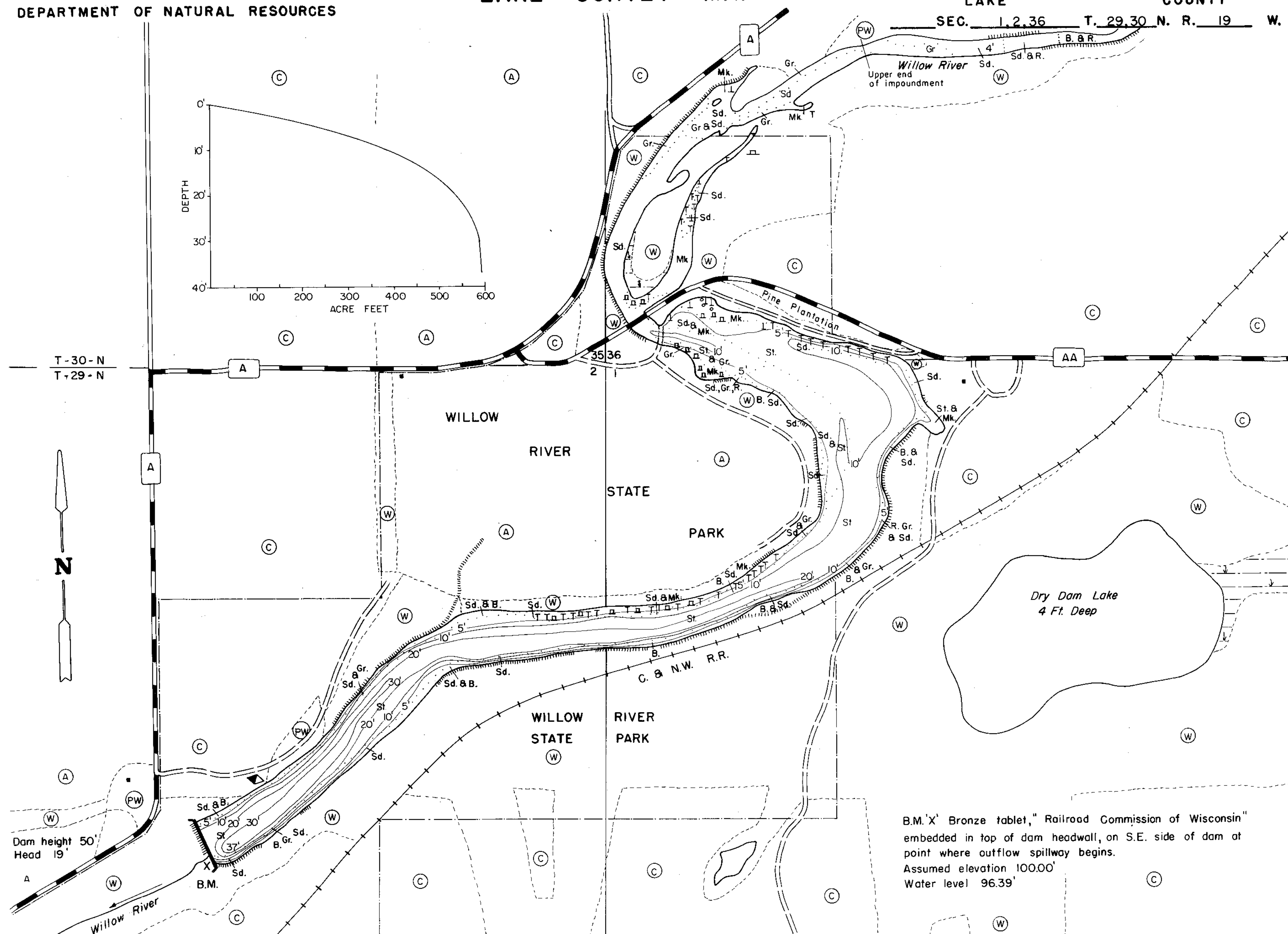
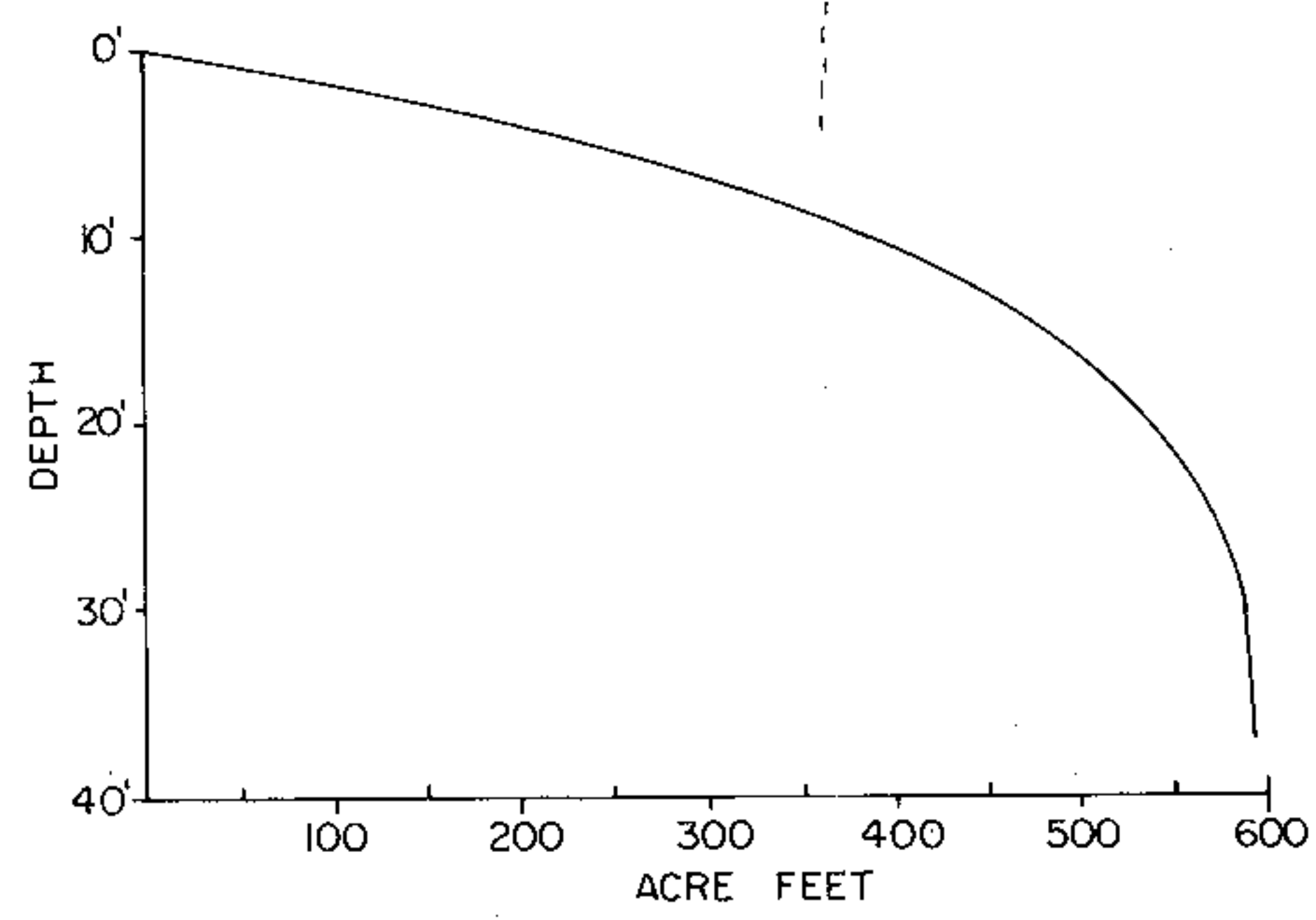

B.M. 'X' Bronze tablet, "Railroad Commission of Wisconsin" embedded in top of dam headwall, on S.E. side of dam at point where outflow spillway begins. Assumed elevation 100.00' Water level 96.39'

EQUIPMENT RECORDING SONAR MAPPED MAY 1970

- | TOPOGRAPHIC SYMBOLS   |                            | LAKE BOTTOM SYMBOLS |                           |
|-----------------------|----------------------------|---------------------|---------------------------|
| (B) Brush             | Steep slope                | P. Peat             | B Boulders                |
| (PW) Partially wooded | - - - Indefinite shoreline | Mk. Muck            | o Stumps & Snags          |
| (W) Wooded            | Marsh                      | C. Clay             | Rock danger to navigation |
| (C) Cleared           | Spring                     | M. Marl             | T Submergent vegetation   |
| (P) Pastured          | Intermittent stream        | Sd. Sand            | ┆ Emergent vegetation     |
| (A) Agricultural      | Permanent inlet            | St. Silt            | ┆ Floating vegetation     |
| B.M. Bench Mark       | Permanent outlet           | Gr. Gravel          | ┆ Brush shelters          |
| ■ Dwelling            | Dam                        | R. Rubble           |                           |
| ▣ Resort              | D.N.R. State owned land    | Br. Bedrock         |                           |
| ▢ Camp                |                            |                     |                           |



Drawn by: C. Holt  
Field work by: S. Hagen

SPECIES OF FISH	Abundance		
	Abundant	Common	Present
Muskie			
N. Pike		X	
Walleye			
L.M. Bass	X		
S.M. Bass			
Panfish	X		
Trout			

WATER AREA 56.9 ACRES  
 UNDER 3 FT. 20.2 %  
 OVER 20 FT. 15.5 %  
 MAX. DEPTH 37 FEET.  
 TOTAL ALK. 153 P.P.M.  
 VOLUME 593.8 ACRE FT.  
 SHORELINE 1.78 MILES

Source: Wisconsin Department of Natural Resources 608-266-2621  
Mounds Pond – St. Croix County, Wisconsin DNR Lake Map  
Date – May 1970 - Historical Lake Map - Not for Navigation  
A Public Document - Please Identify the Source when using it.