

WILLOW RIVER STATE PARK

B.M.'X IS A BRONZE TABLET MARKED RAILROAD COMMISSION OF WISCONSIN SET IN CONCRETE LEDGE ON DOWNSTREAM SIDE OF DAM, BELOW WALKWAY BETWEEN SOUTH EAST GATE AND OBSERVATION PLATFORM. DAM IS 27' HIGH WITH 18' HEAD ASSUMED ELEVATION 100.00' WATER ELEVATION 100.50'

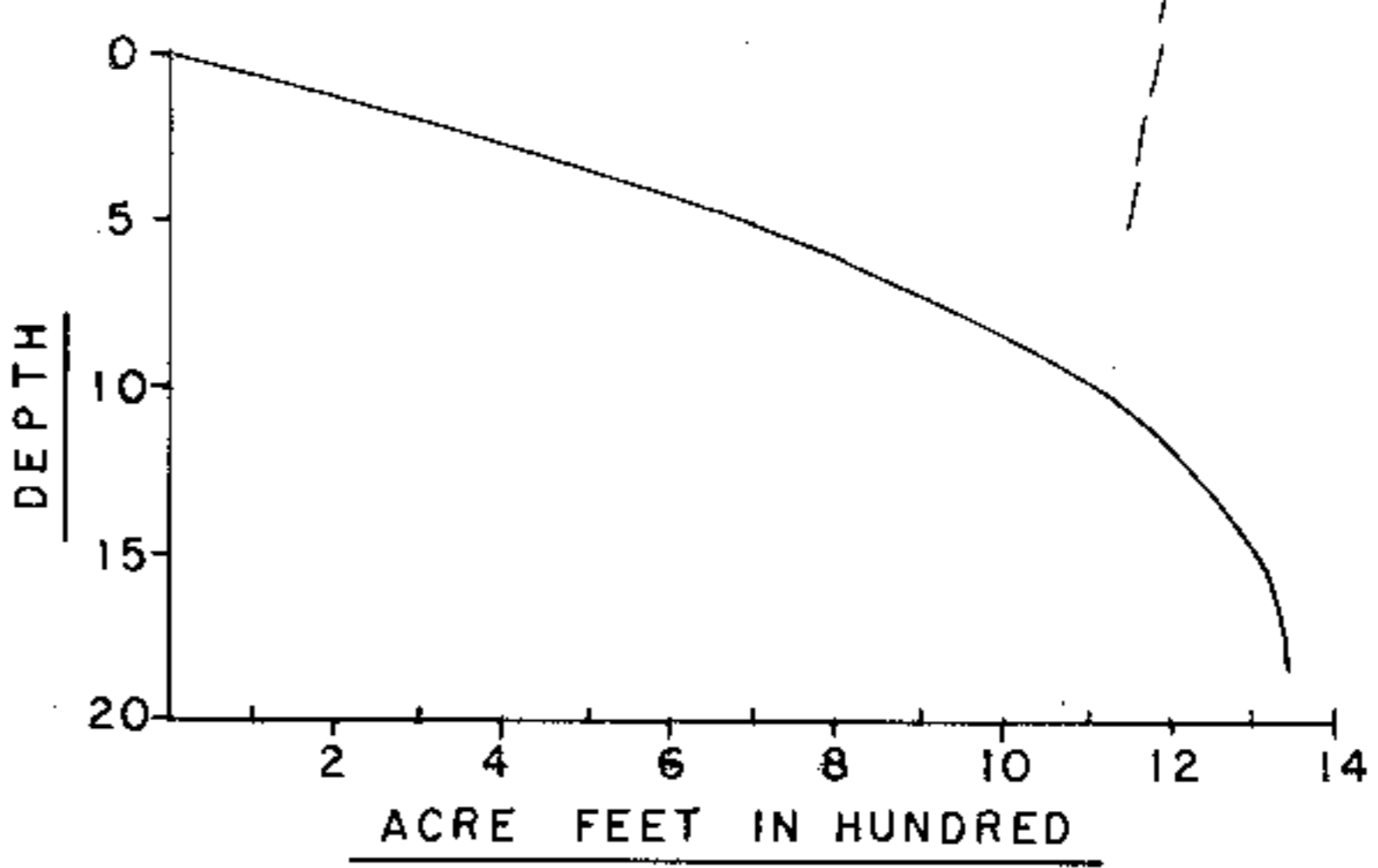
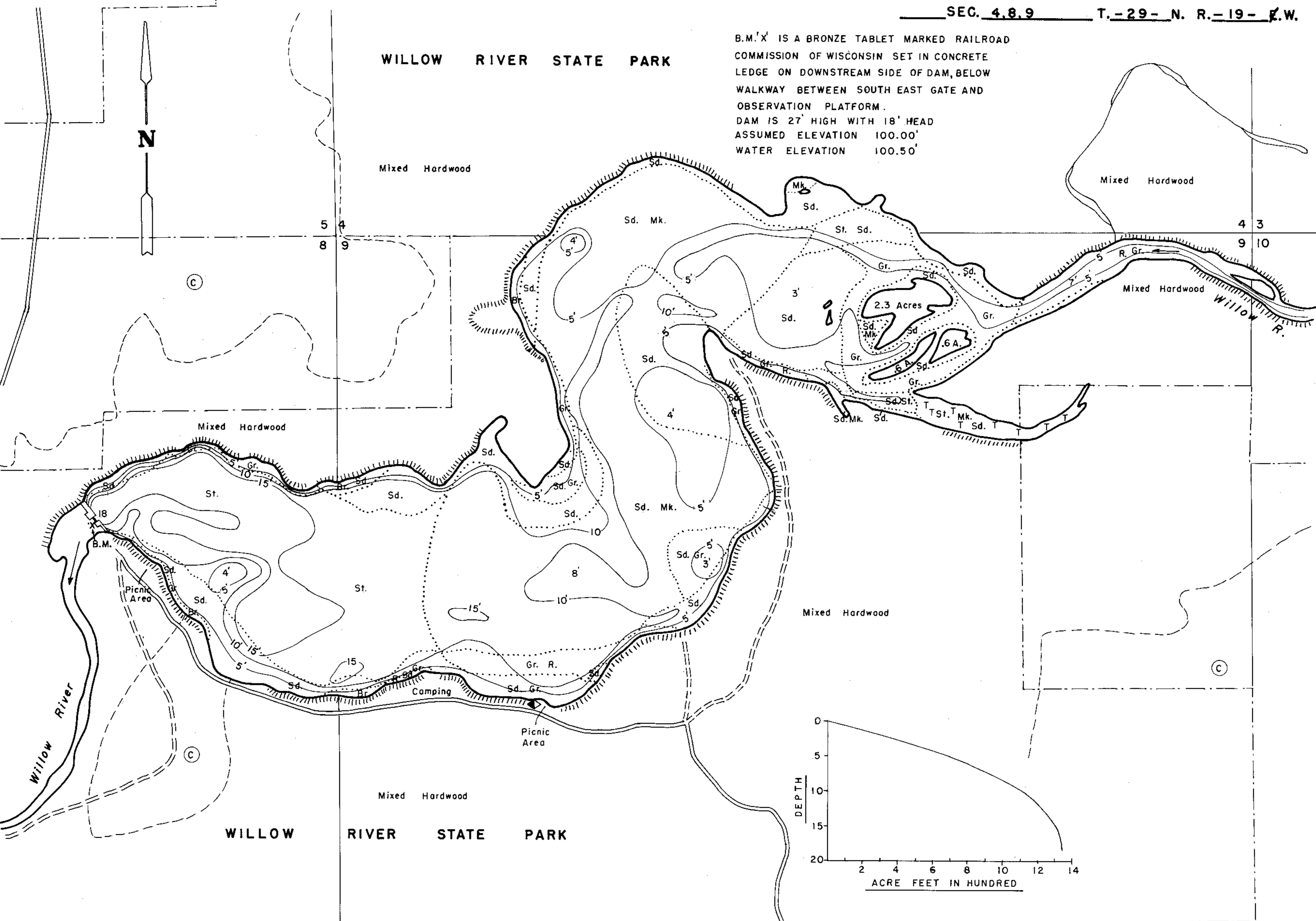

EQUIPMENT SONAR & POLE MAPPED MAY 1970

- TOPOGRAPHIC SYMBOLS
- (B) Brush
  - (PW) Partly wooded
  - (W) Wooded
  - (C) Cleared
  - (P) Pastured
  - (A) Agricultural
  - B.M. Bench Mark
  - Dwelling
  - Resort
  - Camp
  - ||||| Steep slope
  - - - Indefinite shoreline
  - Marsh
  - Spring
  - Intermittent stream
  - Permanent inlet
  - Permanent outlet
  - Dam
  - D.N.R. State owned land

- LAKE BOTTOM SYMBOLS
- P. Peat
  - Mk. Muck
  - C. Clay
  - M. Marl
  - Sd. Sand
  - St. Silt
  - Gr. Gravel
  - R. Rubble
  - Bc. Bedrock
  - B Boulders
  - Stumps & Snags
  - Rock danger to navigation
  - T Submergent vegetation
  - Emergent vegetation
  - Floating vegetation
  - Brush shelters

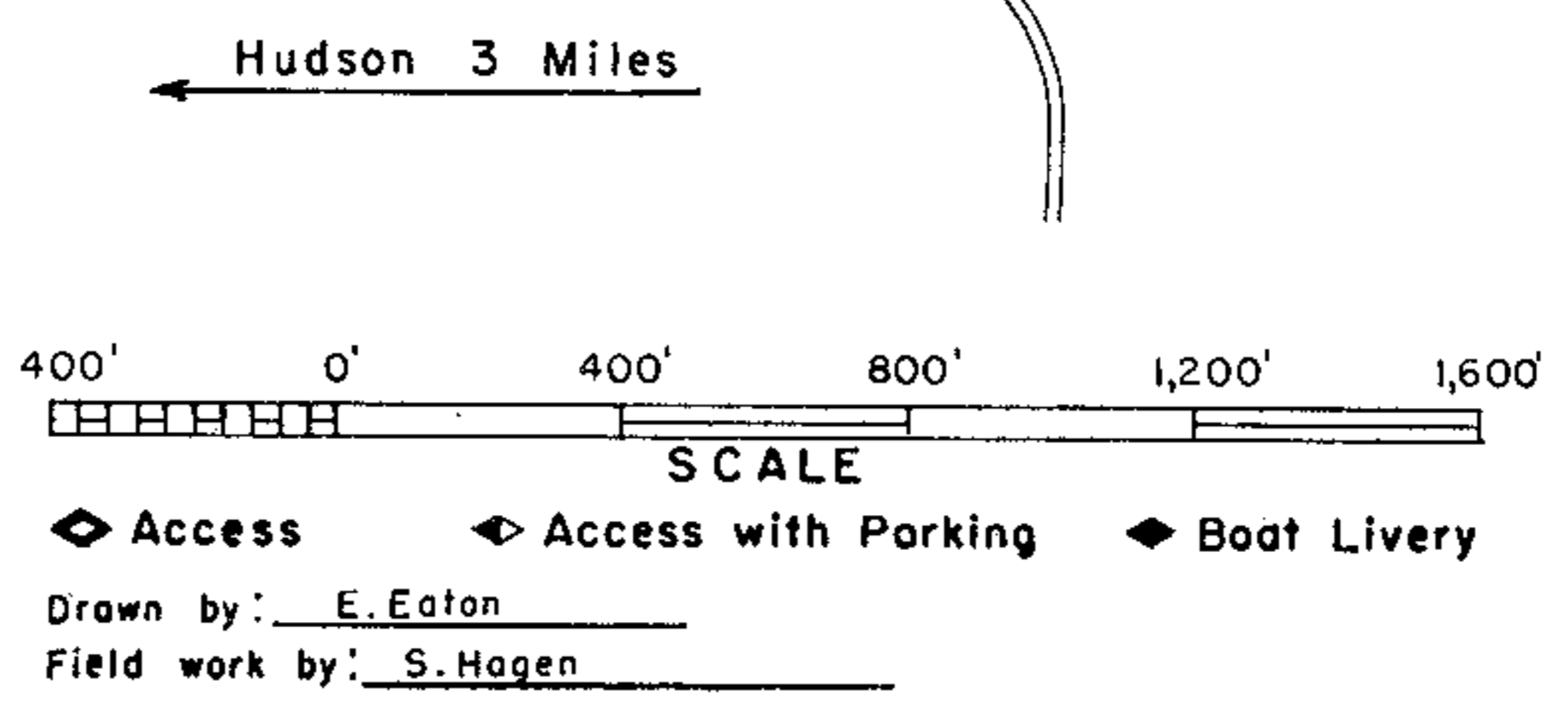

SPECIES OF FISH	Abundance		
	Abundant	Common	Present
Muskie			
N. Pike			
Walleye			
L.M. Bass		X	
S.M. Bass			
Panfish	X		
Trout			

WATER AREA 171.6 ACRES  
 UNDER 3 FT. 38.0 %  
 OVER 20 FT. 0.0 %  
 MAX. DEPTH 18 FEET.  
 TOTAL ALK. 147 P.P.M.  
 VOLUME 1,342.8 ACRE FT.  
 SHORELINE 4.86 MILES  
 WITHOUT ISL. 4.12 MILES

Source: Wisconsin Department of Natural Resources 608-266-2621  
Little Falls Pond – St. Croix County, Wisconsin DNR Lake Map  
Date – May 1970 - Historical Lake Map - Not for Navigation  
A Public Document - Please Identify the Source when using it.