

LAKE SURVEY MAP

WISCONSIN CONSERVATION DEPARTMENT
BIOLOGY DIVISION
LAKE AND STREAM IMPROVEMENT SECTION

LAKE TRAVERS
SECTION 6-7
TOWNSHIP 45 N
RANGE 8 W
TOWN OF DRUMMOND
COUNTY BAYFIELD

FORM FH17

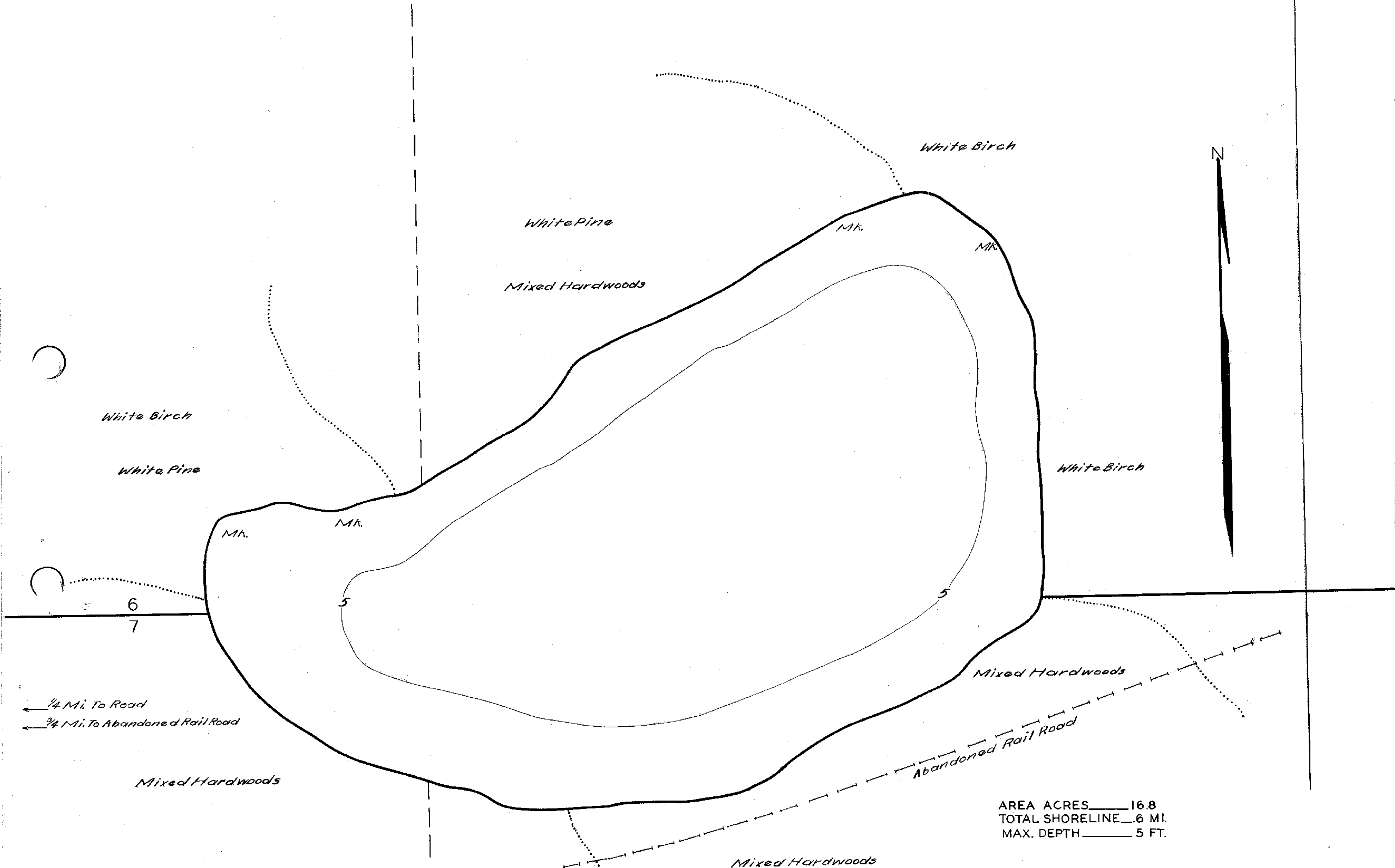

← 1/4 Mi. To Road
← 3/4 Mi. To Abandoned Rail Road

AREA ACRES 16.8
TOTAL SHORELINE .6 MI.
MAX. DEPTH 5 FT.

DATE OCT. 1 1941
COMPILED BY _____
TRACED BY W.T.Z. (W.P.A.)
SOURCE OF INFORMATION
U.S. FOREST LAKE AND STREAM SURVEY
SOUNDINGS _____
DATES OF MAP REVISION _____
WORK AGENCY _____

*Checked
W.P.S.
E.M.K.
11/13/1941*

LAKE IMPROVEMENT RECORD

TYPE	DATE			
BRUSH REFUGES				
SPAWNING BOXES				
SAPLING TANGLES				
* MINNOW SPAWNERS				
TOTAL				



- LEGEND**
- WEED BEDS
 - ROCKY SHOALS
 - SD. SAND
 - CL. CLAY
 - GR GRAVEL
 - MK. MUCK
 - DWELLING
 - ABANDONED DWELLING
 - RESORT

Source: Wisconsin Department of Natural Resources 608-266-2621
Travers Lake – Bayfield County, Wisconsin DNR Lake Map
Date – Oct 1941 - Historical Lake Map - Not for Navigation
A Public Document - Please Identify the Source when using it.