

LAKE SURVEY MAP

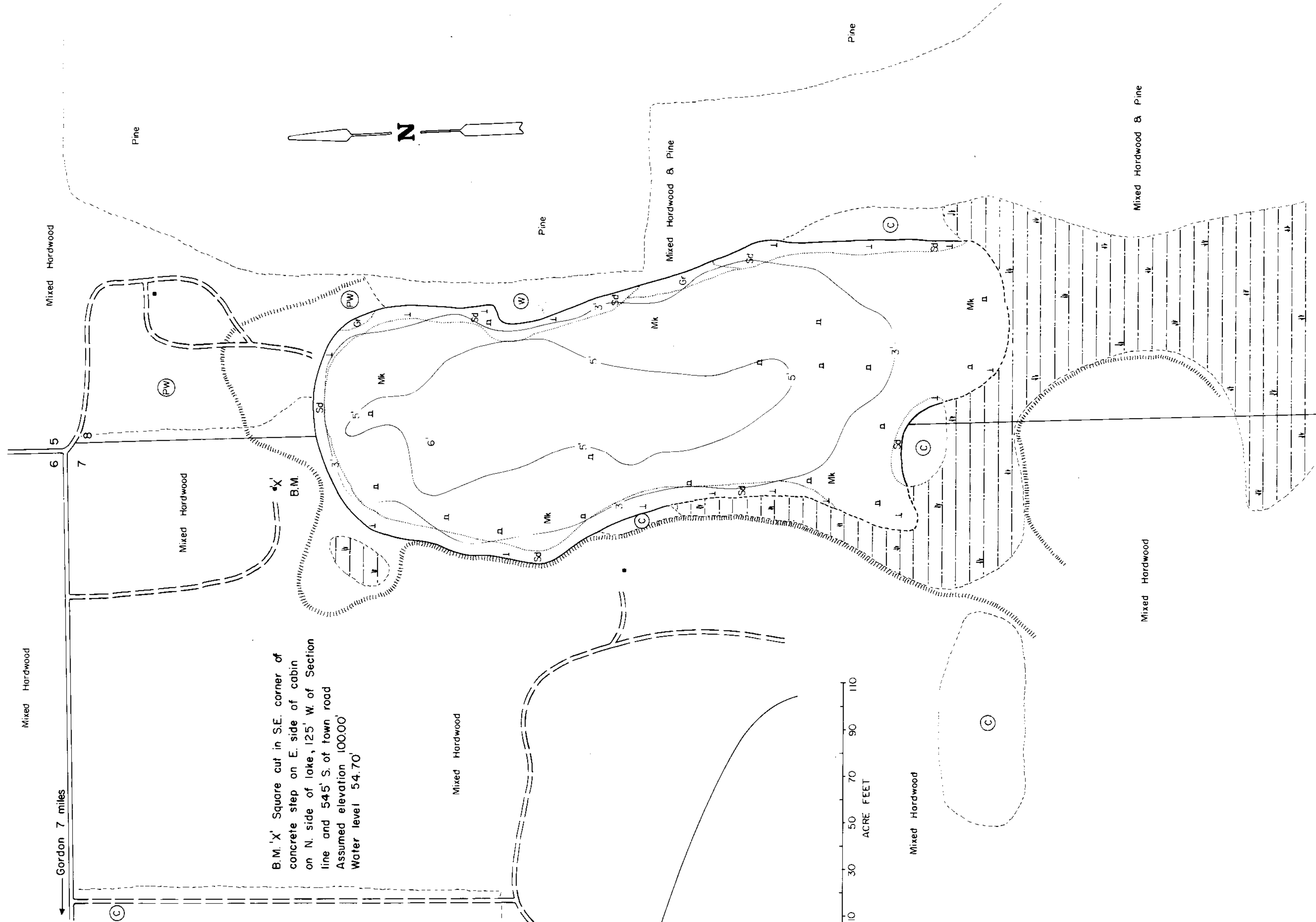

B.M. 'X' Square cut in S.E. corner of concrete step on E. side of cabin on N. side of lake, 125' W. of Section line and 545' S. of town road Assumed elevation 10000' Water level 54.70'

EQUIPMENT RECORDING SONAR MAPPED AUG 1971
MONTH YEAR
LAKE BOTTOM SYMBOLS

- | | | | |
|---------------------|-----------------------------|---------------------|-----------------------------|
| TOPOGRAPHIC SYMBOLS | | LAKE BOTTOM SYMBOLS | |
| (a) Brush | Steep slope | P. Peat | B. Boulders |
| PW Partially wooded | - - - Indefinite shoreline | Mk. Muck | o Stumps & Snags |
| (w) Wooded | (m) Marsh | C. Clay | ⚡ Rock danger to navigation |
| (c) Cleared | (s) Spring | M. Marl | T Submergent vegetation |
| (p) Pastured | (i) Intermittent stream | Sd. Sand | ⌈ Emergent vegetation |
| (a) Agricultural | (in) Permanent inlet | St. Silt | ⌋ Floating vegetation |
| B.M. Bench Mark | (o) Permanent outlet | Gr. Gravel | ⌋ Brush shelters |
| (d) Dwelling | (d) Dam | R. Rubble | |
| (r) Resort | (s) D.N.R. State owned land | Br. Bedrock | |
| (c) Camp | | | |



Access Access with Parking Boat Livery
 Drawn by: C. Holt
 Field work by: C. Busch, G. Lund, Sather

SPECIES OF FISH	Abundance		
	Abundant	Common	Present
Muskie			X
N. Pike			X
Walleye			X
L.M. Bass		X	
S.M. Bass			
Panfish	X		
Trout			

WATER AREA 294 ACRES
 UNDER 3 FT. 31 %
 OVER 20 FT. 0 %
 MAX. DEPTH 6 FEET.
 TOTAL ALK. 5 P.P.M.
 VOLUME 104 ACRE FT.
 SHORELINE 100 MILES

Source: Wisconsin Department of Natural Resources 608-266-2621
Thorne Lake – Douglas County, Wisconsin DNR Lake Map
Date – Aug 1971 - Historical Lake Map - Not for Navigation
A Public Document - Please Identify the Source when using it.