

LAKE SURVEY MAP

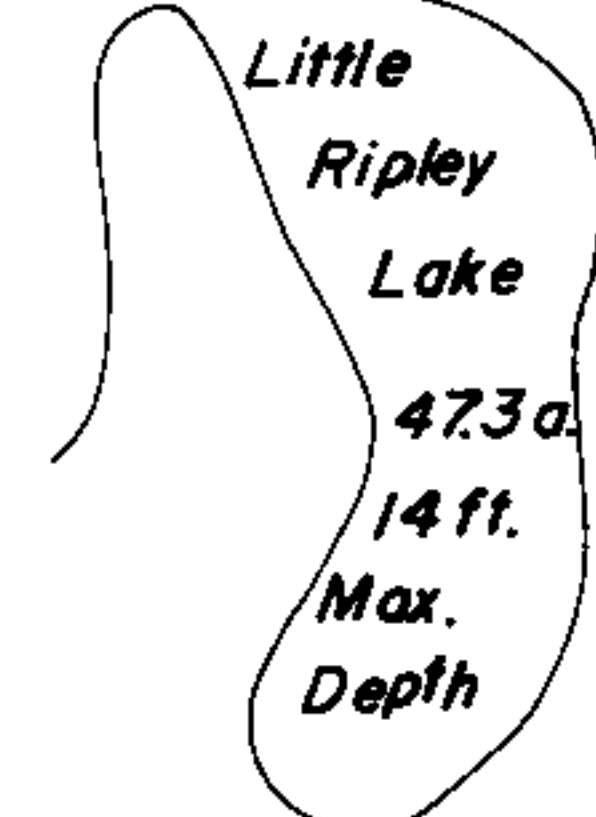
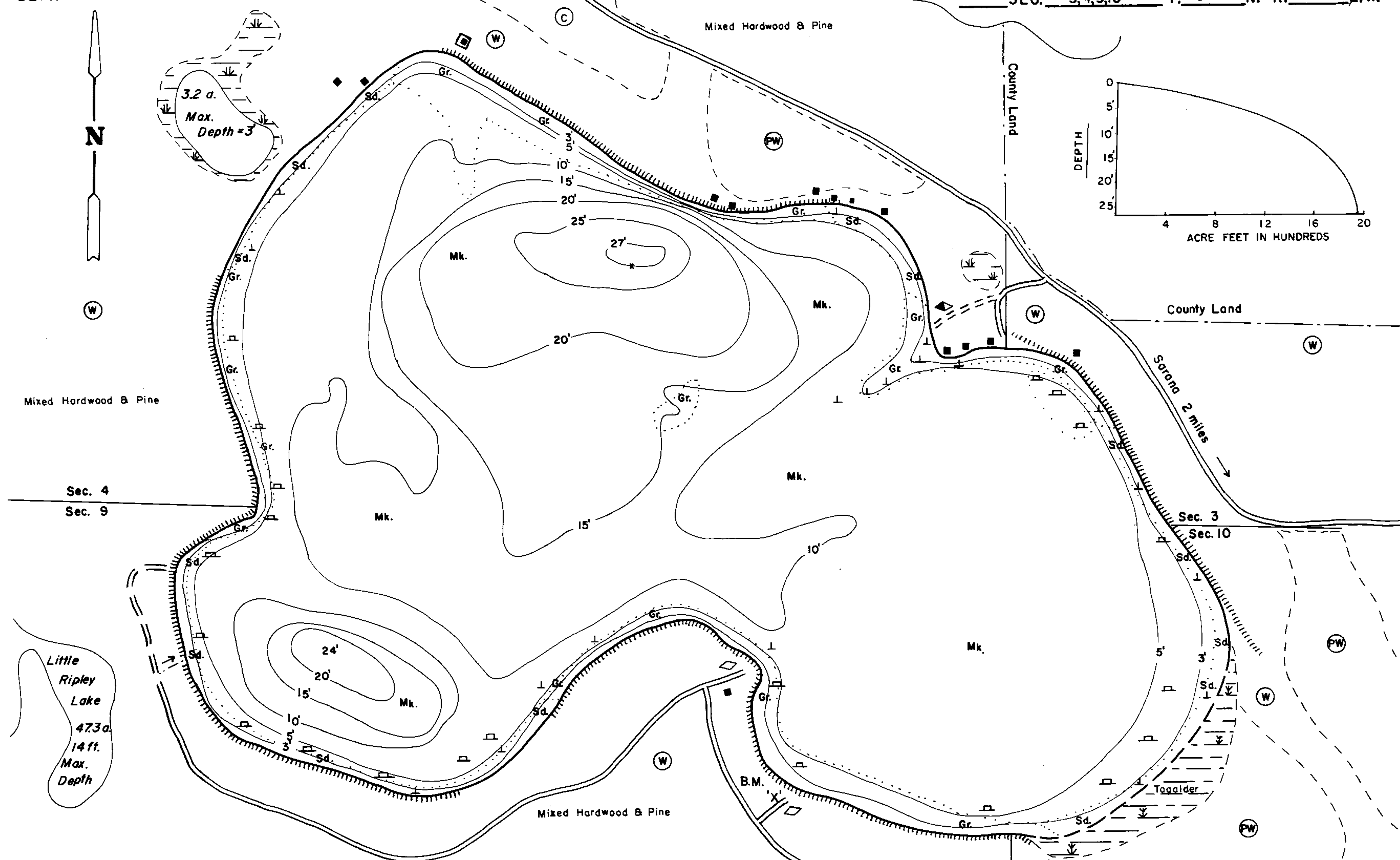
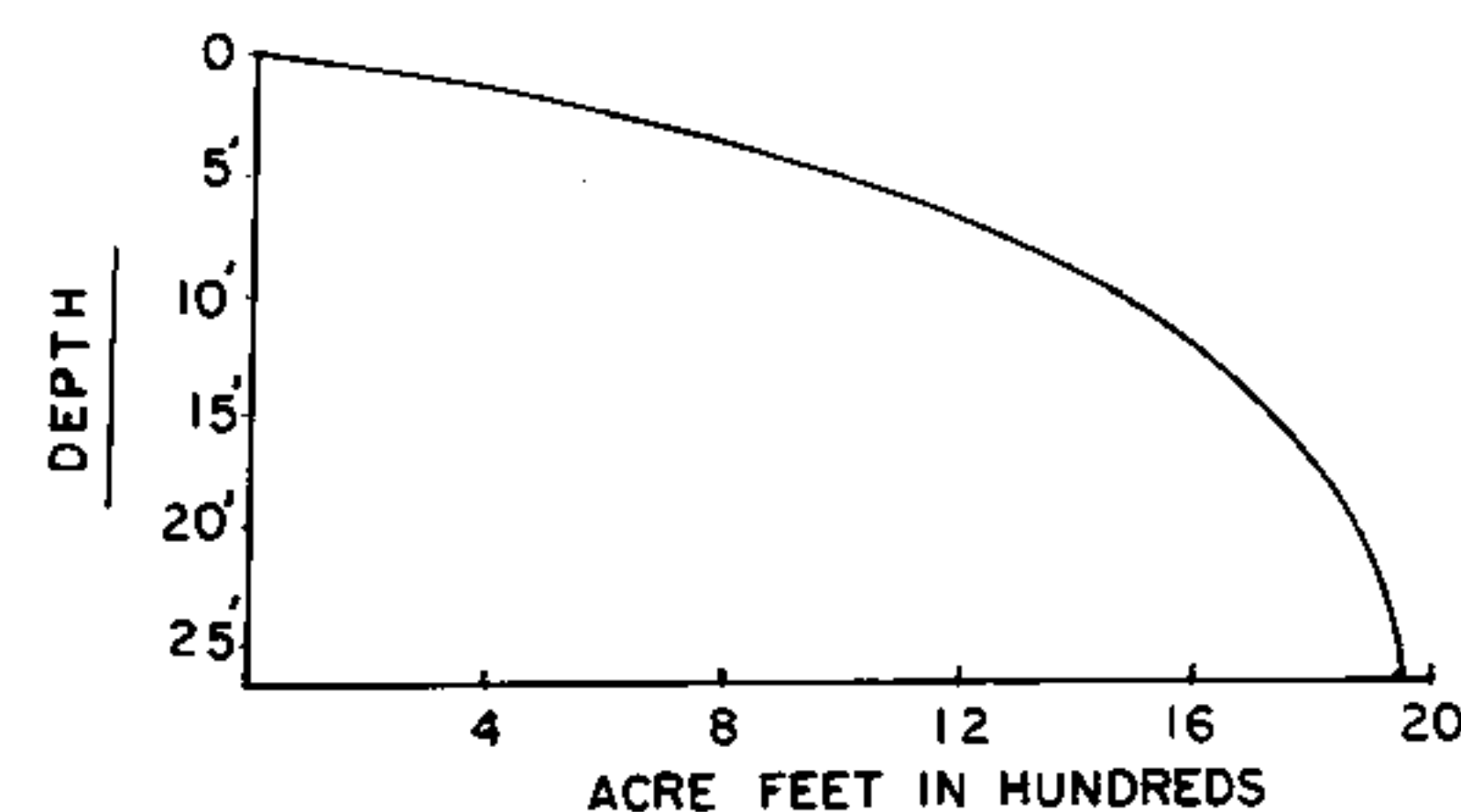
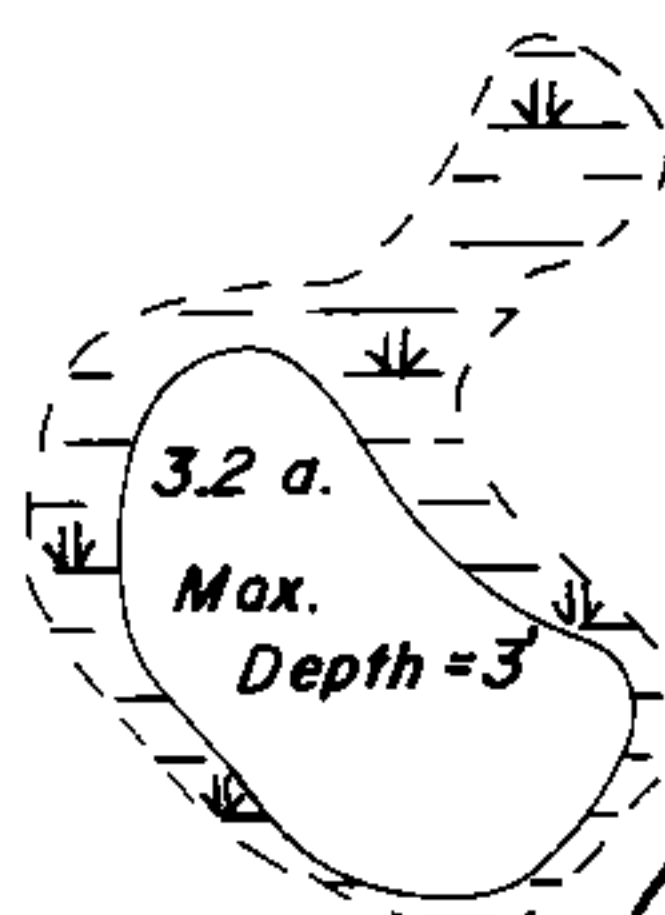

B.M. 'X' is a rectangle cut in a boulder located 30' W. of the center line of the access and 25' S. of lake.
Assumed elevation = 100.00'
Water level = 96.85'

EQUIPMENT RECORDING SONAR MAPPED JULY 1969

TOPOGRAPHIC SYMBOLS		MONTH YEAR LAKE BOTTOM SYMBOLS	
(B) Brush	Steep slope	P. Peat	B Boulders
(PW) Partially wooded	----- Indefinite shoreline	Mk. Muck	o Stumps & Snags
(W) Wooded	----- Marsh	C. Clay	o Rock danger to navigation
(C) Cleared	o Spring	M. Marl	T Submergent vegetation
(P) Pastured	----- Intermittent stream	Sd. Sand	⊥ Emergent vegetation
(A) Agricultural	----- Permanent inlet	St. Silt	⊥ Floating vegetation
B.M. Bench Mark	----- Permanent outlet	Gr. Gravel	⊥ Brush shelters
■ Dwelling	⊥ Dam	R. Rubble	
□ Resort	D.N.R. State owned land	Bc. Bedrock	
□ Camp			



◆ Access ◆ Access with Parking ◆ Boat Livery

Drawn by: T. Ginder
Field work by: C. Busch, C. Belter, & S. Johannes

SPECIES OF FISH	Abundance		
	Abundant	Common	Present
Muskie			
N. Pike		X	
Walleye		X	
L.M. Bass		X	
S.M. Bass			
Panfish	X		
Trout			

WATER AREA 189.5 ACRES
 UNDER 3 FT. 7 %
 OVER 20 FT. 8 %
 MAX. DEPTH 27 FEET.
 TOTAL ALK. 20 P.P.M.
 VOLUME 1933.5 ACRE FT.
 SHORELINE 2.5 MILES

Source: Wisconsin Department of Natural Resources 608-266-2621
Ripley Lake - Washburn County, Wisconsin DNR Lake Map
Date – Jul 1969 - Historical Lake Map - Not for Navigation
A Public Document - Please Identify the Source when using it.