

# LAKE SURVEY MAP

WISCONSIN CONSERVATION DEPARTMENT  
BIOLOGY DIVISION  
LAKE AND STREAM IMPROVEMENT SECTION

LAKE PERSONS  
SECTION 22-23-27  
TOWNSHIP 43 N  
RANGE 13 W  
TOWN OF WASCOTT  
COUNTY DOUGLAS

FORM FI-117

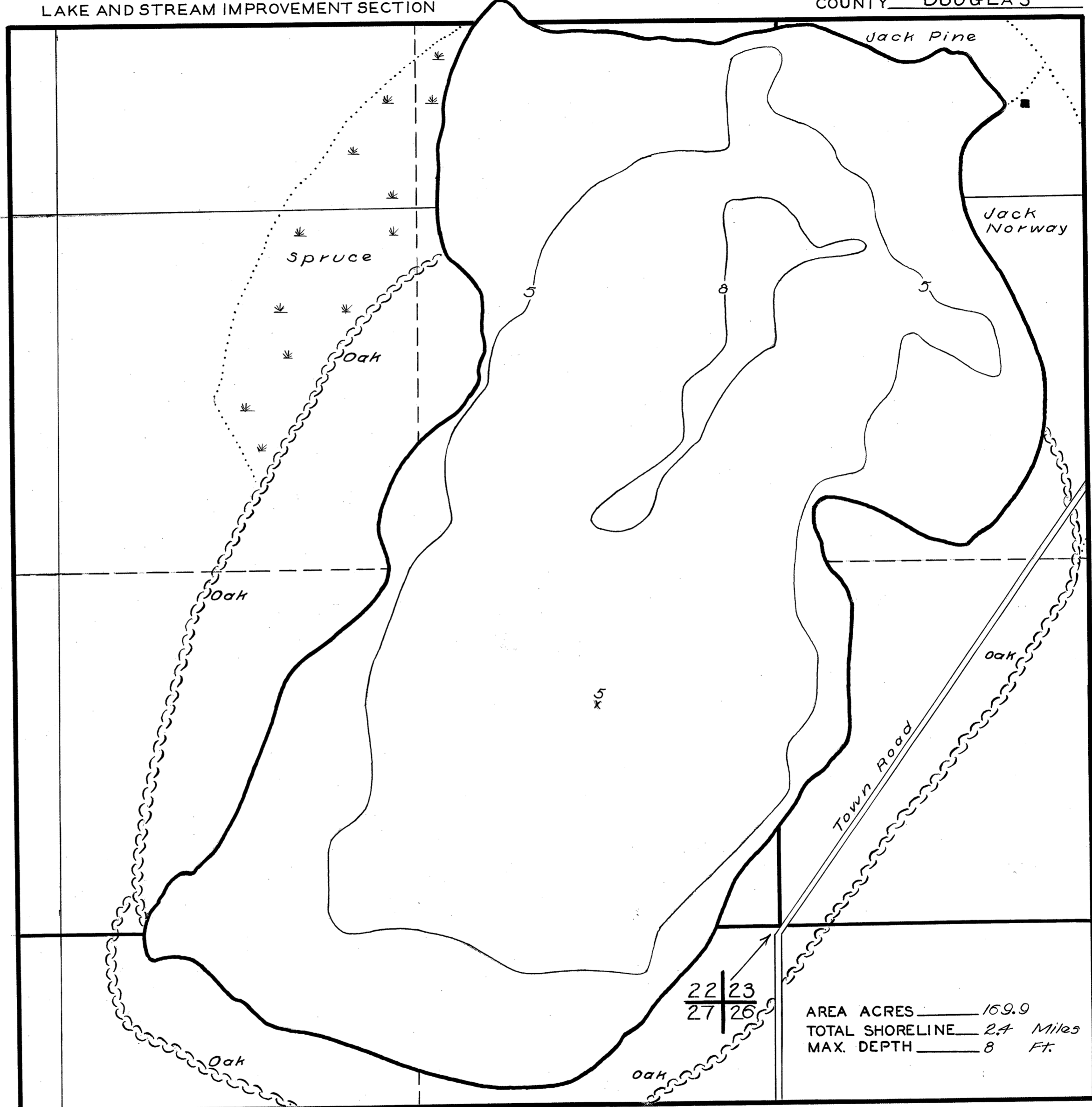

DATE May 22, 1939  
COMPILED BY \_\_\_\_\_  
TRACED BY W.P.S.  
SOURCE OF INFORMATION  
W.P.A. Lake Survey Project  
\_\_\_\_\_  
SOUNDINGS  
W.P.A. Lake Survey Project  
\_\_\_\_\_  
DATES OF MAP REVISION \_\_\_\_\_  
WORK AGENCY W.P.A.  
CHECKED BY  
W.P.S. 4-16-41

### LAKE IMPROVEMENT RECORD

| TYPE            | DATE |  |  |  |
|-----------------|------|--|--|--|
| BRUSH REFUGES   |      |  |  |  |
| SAPLING TANGLES |      |  |  |  |
| SPAWNING BOXES  |      |  |  |  |
| MINNOW SPAWNERS |      |  |  |  |
| TOTAL           |      |  |  |  |

SCALE 1 inch = 330 feet

0 50 100 200 300 400 500 Feet

### LEGEND

- WEED BEDS
- ROCKY SHOALS
- SAND
- CLAY
- GRAVEL
- MUCK
- DWELLING
- ABANDONED DWELLING
- RESORT
- Pronounced Ridge

Source: Wisconsin Department of Natural Resources 608-266-2621  
Person Lake - Douglas County, Wisconsin DNR Lake Map  
Date May 1939 - Historical Lake Map - Not for Navigation  
A Public Document - Please Identify the Source when using it.