

LAKE SURVEY MAP

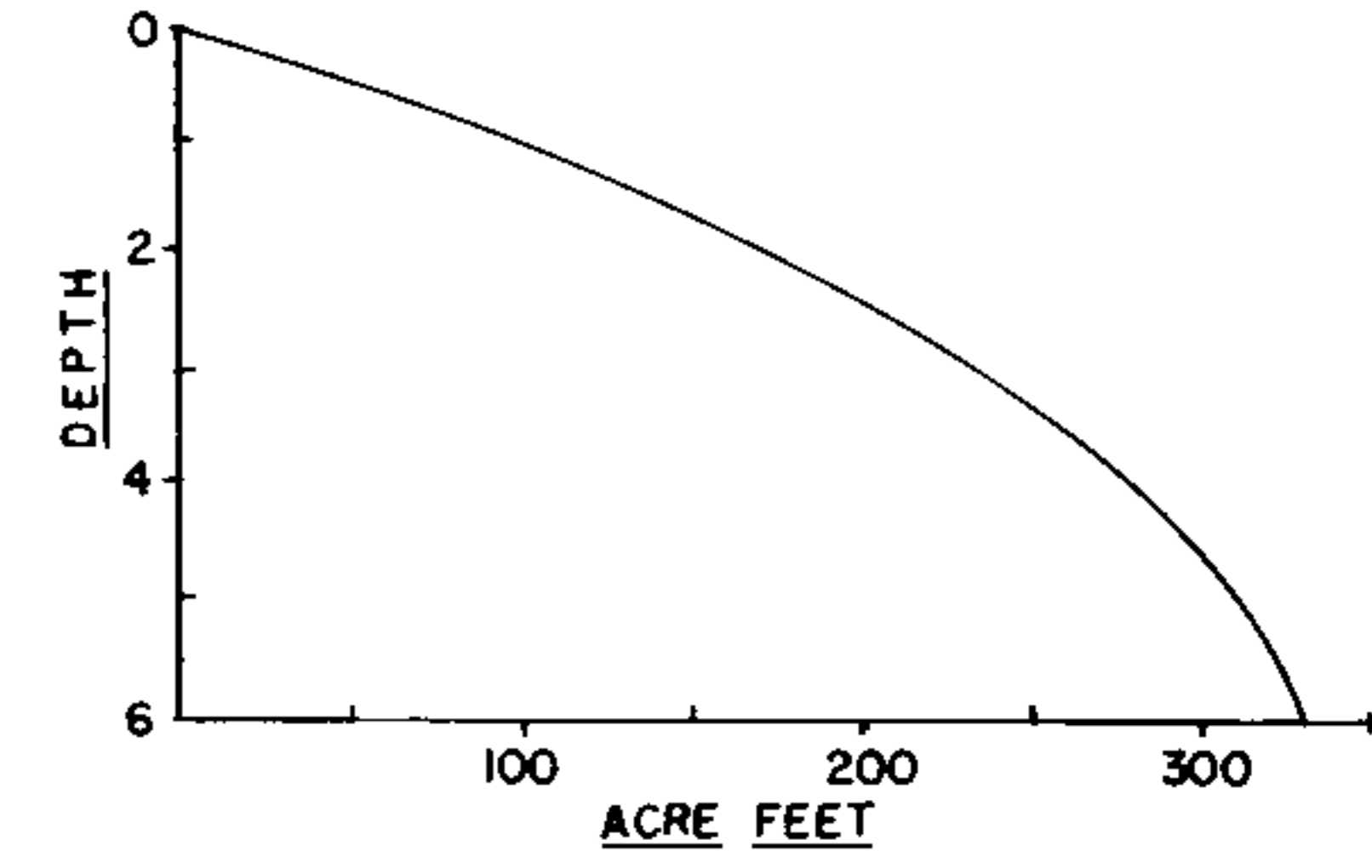
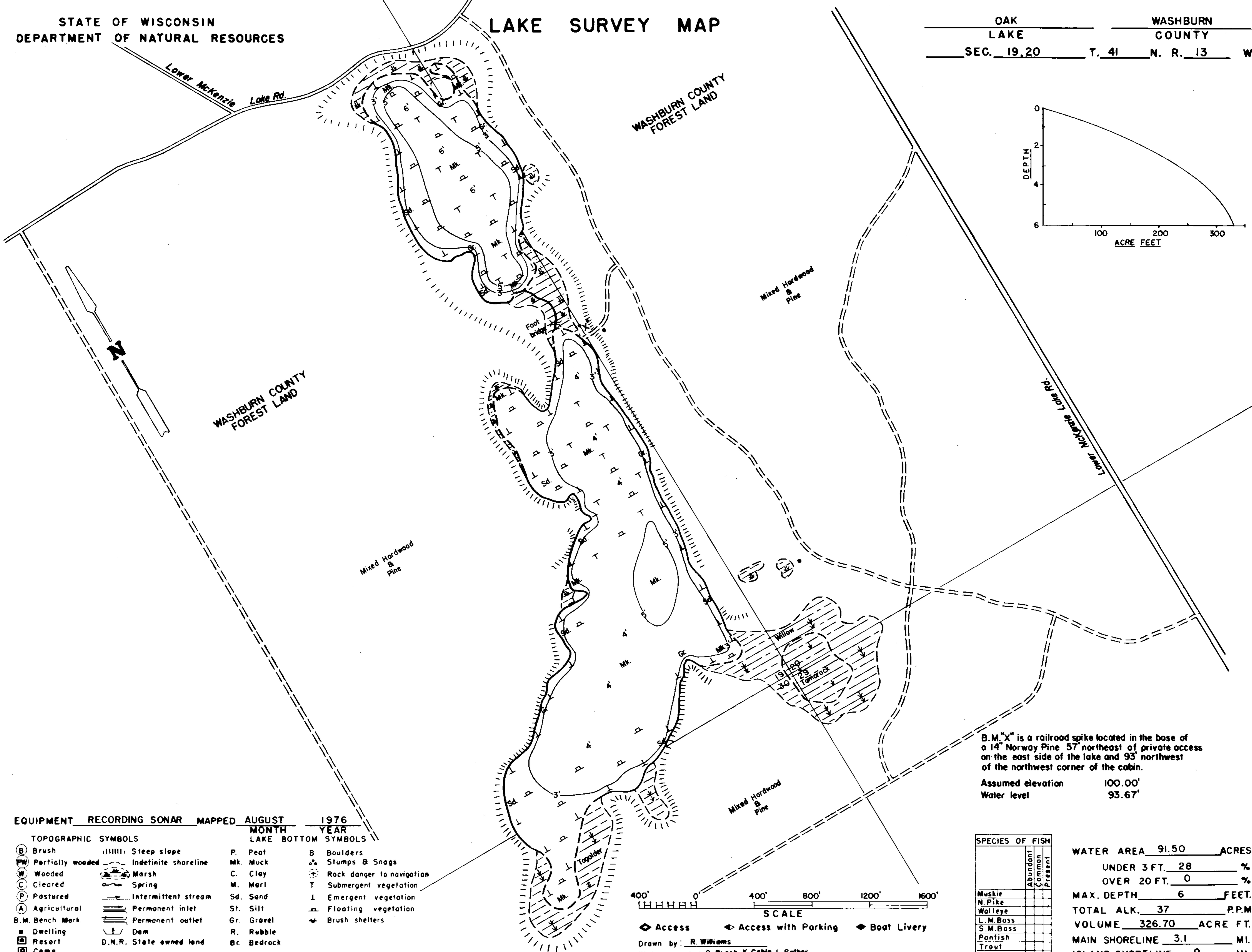

EQUIPMENT RECORDING SONAR MAPPED AUGUST 1976

TOPOGRAPHIC SYMBOLS		LAKE BOTTOM SYMBOLS	
MONTH		YEAR	
(B) Brush	Steep slope	P. Peat	B Boulders
(PW) Partially wooded	----- Indefinite shoreline	Mk. Muck	o Stumps & Snags
(W) Wooded	----- Marsh	C. Clay	o Rock danger to navigation
(C) Cleared	o Spring	M. Marl	T Submergent vegetation
(P) Pastured	----- Intermittent stream	Sd. Sand	l Emergent vegetation
(A) Agricultural	===== Permanent inlet	St. Silt	o Floating vegetation
B.M. Bench Mark	===== Permanent outlet	Gr. Gravel	o Brush shelters
■ Dwelling	o Dam	R. Rubble	
■ Resort	D.N.R. State owned land	Br. Bedrock	
■ Camp			

B.M. "X" is a railroad spike located in the base of a 14" Norway Pine 57' northeast of private access on the east side of the lake and 93' northwest of the northwest corner of the cabin.
Assumed elevation 100.00'
Water level 93.67'



◆ Access ◆ Access with Parking ◆ Boat Livery

Drawn by: R. Williams
Field work by: C. Busch, K. Coble, L. Sather

SPECIES OF FISH	Abundance		
	Abundant	Common	Present
Muskie			
N. Pike			
Walleye			
L. M. Bass			
S. M. Bass			
Panfish			
Trout			
Minnows			X

WATER AREA	91.50	ACRES
UNDER 3 FT.	28	%
OVER 20 FT.	0	%
MAX. DEPTH	6	FEET.
TOTAL ALK.	37	P.P.M.
VOLUME	326.70	ACRE FT.
MAIN SHORELINE	3.1	MI.
ISLAND SHORELINE	0	MI.

Source: Wisconsin Department of Natural Resources 608-266-2621
Oak Lake - Washburn County, Wisconsin DNR Lake Map
Date – Aug 1976 - Historical Lake Map - Not for Navigation
A Public Document - Please Identify the Source when using it.