

LAKE SURVEY MAP

WISCONSIN CONSERVATION DEPARTMENT
BIOLOGY DIVISION
LAKE AND STREAM IMPROVEMENT SECTION

LAKE LOON FORM FI-117
SECTION 27
TOWNSHIP 43 N
RANGE 13 W
TOWN OF WASCOTT
COUNTY DOUGLAS

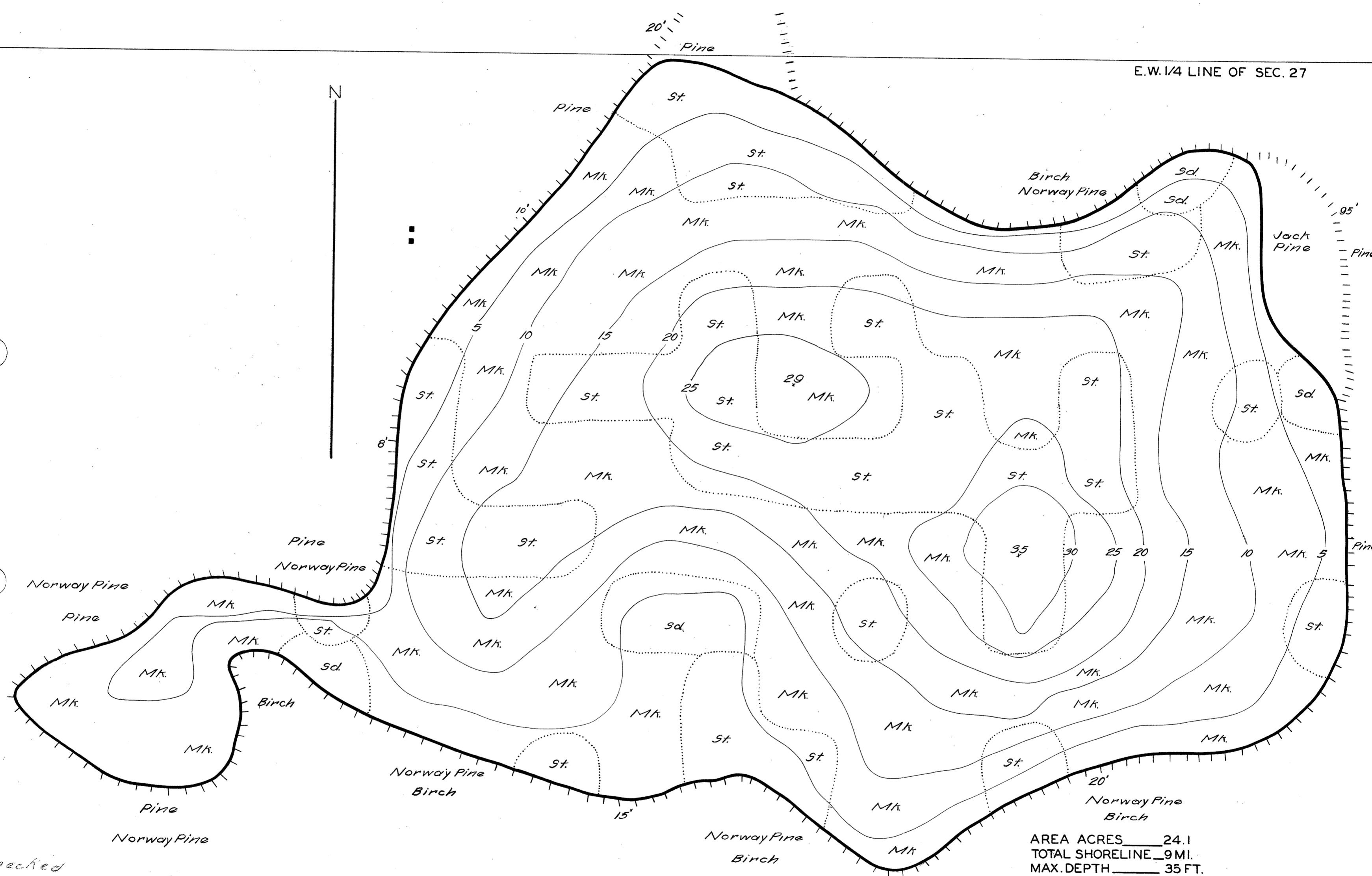

AREA ACRES 24.1
TOTAL SHORELINE 9 MI.
MAX. DEPTH 35 FT.

SCALE 1 INCH EQUALS 100 FT.
0 10 20 30 40 50

Checked
EMK.
W.P.S.
9/3/1994

DATE AUG. 28 1941
COMPILED BY _____
TRACED BY W.T.Z. (W.P.A.)
SOURCE OF INFORMATION
CCC CAMP BRULE ACT. 23 77S PROJ. 119
W.P.A. LAKE SURVEY PROJECT
JAN. 1941
SOUNDINGS AT 100 FT INTERVALS

DATES OF MAP REVISION _____

WORK AGENCY C.C.C.

LAKE IMPROVEMENT RECORD	
TYPE	DATE
○ BRUSH REFUGES	_____
— SAPLING TANGLES	_____
□ SPAWNING BOXES	_____
* MINNOW SPAWNERS	_____
TOTAL	_____

- LEGEND
- WEED BEDS
 - ROCKY SHOALS
 - SD. SAND
 - CL. CLAY
 - GR. GRAVEL
 - MK. MUCK
 - DWELLING
 - ABANDONED DWELLING
 - RESORT
 - STEEP SLOPE

Source: Wisconsin Department of Natural Resources 608-266-2621
Loon Lake - Douglas County, Wisconsin DNR Lake Map
Aug. 1941 Historical Lake Map Not for Navigation
A Public Document - Please Identify the Source when using it.