

LAKE SURVEY MAP

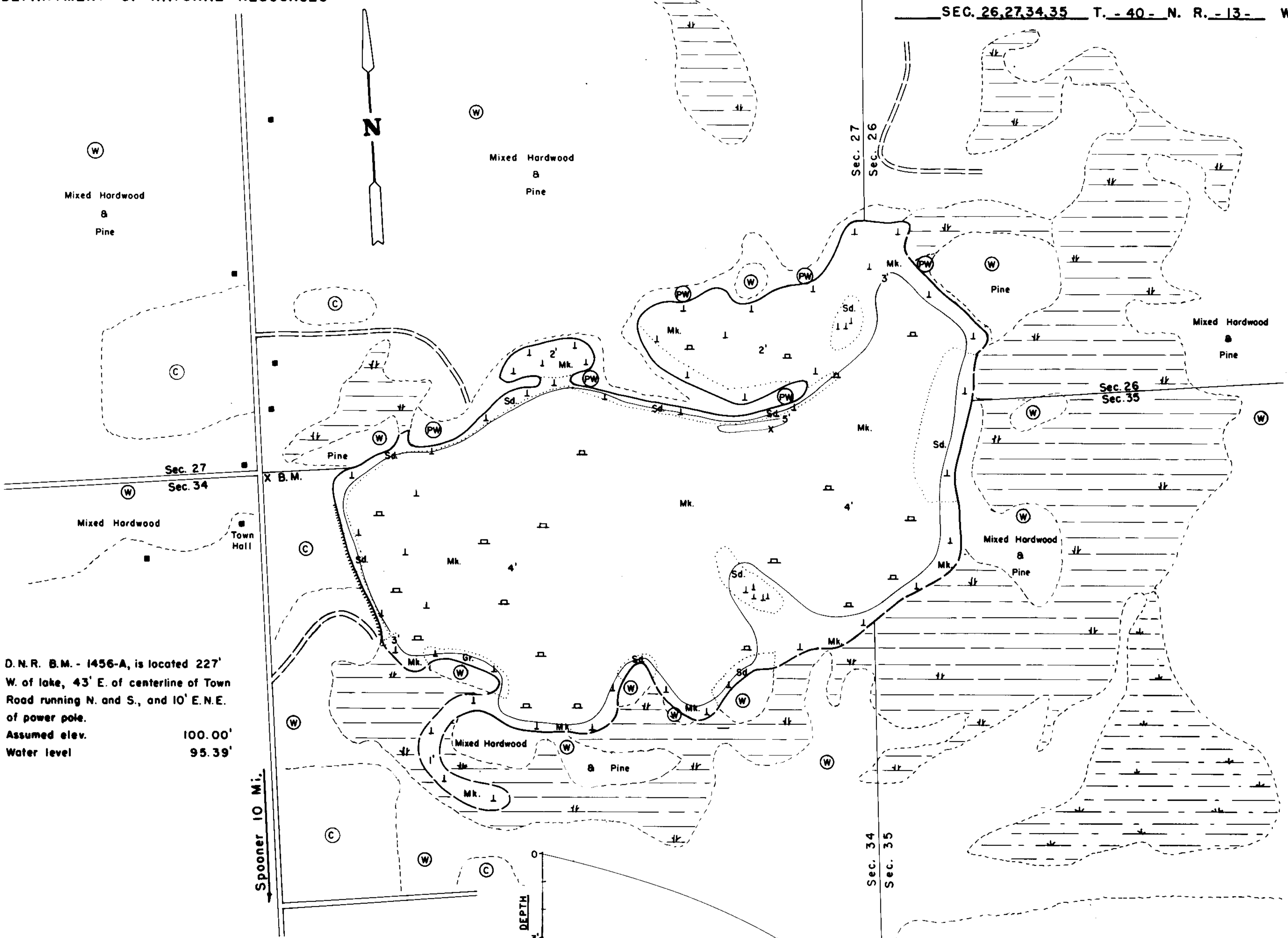

D.N.R. B.M. - 1456-A, is located 227' W. of lake, 43' E. of centerline of Town Road running N. and S., and 10' E.N.E. of power pole.
Assumed elev. 100.00'
Water level 95.39'

EQUIPMENT RANGE POLE MAPPED MAY 1969
MONTH YEAR
LAKE BOTTOM SYMBOLS

- TOPOGRAPHIC SYMBOLS**
- (B) Brush
 - (PW) Partially wooded
 - (W) Wooded
 - (C) Cleared
 - (P) Pastured
 - (A) Agricultural
 - B.M. Bench Mark
 - Dwelling
 - Resort
 - Camp
 - ||||| Steep slope
 - ~ Indefinite shoreline
 - Marsh
 - Spring
 - Intermittent stream
 - Permanent inlet
 - Permanent outlet
 - Dam
 - D.N.R. State owned land

- P. Peat
- Mk. Muck
- C. Clay
- M. Marl
- Sd. Sand
- St. Silt
- Gr. Gravel
- R. Rubble
- Br. Bedrock
- B Boulders
- Stumps & Snags
- Rock danger to navigation
- T Submergent vegetation
- ↓ Emergent vegetation
- ↑ Floating vegetation
- ↕ Brush shelters

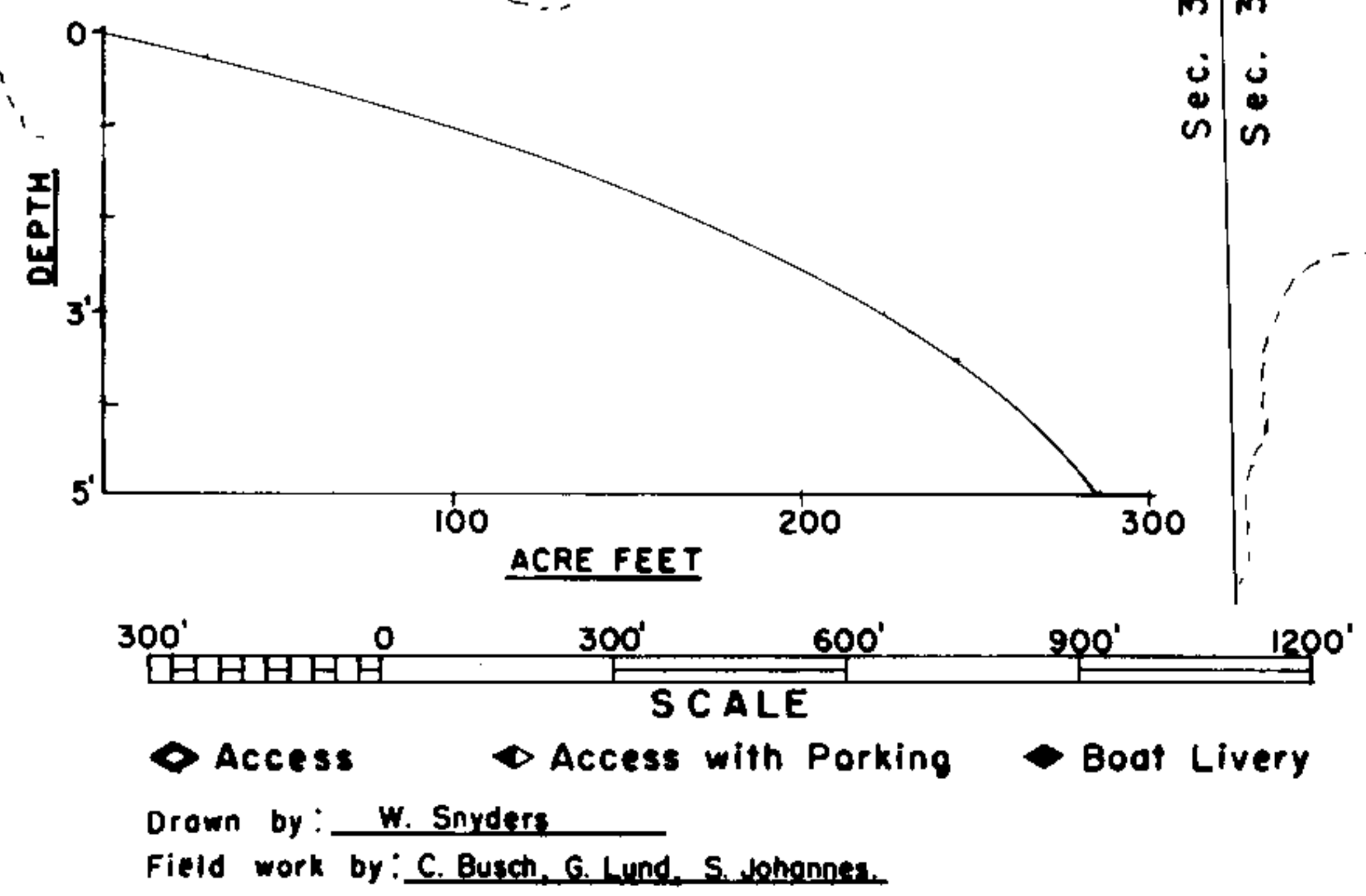

Species of Fish	Winterkill		
	Abundant	Common	Present
Muskie			
N. Pike		X	
Walleye			
L.M. Bass			
S.M. Bass			
Panfish		X	
Trout			

WATER AREA 86.7 ACRES
UNDER 3 FT. 27.2 %
OVER 20 FT. 0 %
MAX. DEPTH 5 FEET.
TOTAL ALK. 13 P.P.M.
VOLUME 287.9 ACRE FT.
SHORELINE 2.15 MILES

Source: Wisconsin Department of Natural Resources 608-266-2621
Jerry Lake - Washburn County, Wisconsin DNR Lake Map
Date – May 1969 - Historical Lake Map - Not for Navigation
A Public Document - Please Identify the Source when using it.