

LAKE SURVEY MAP

HENDERSON LAKE
BAYFIELD COUNTY
SEC. 33 T. 45 N. R. 9 W.

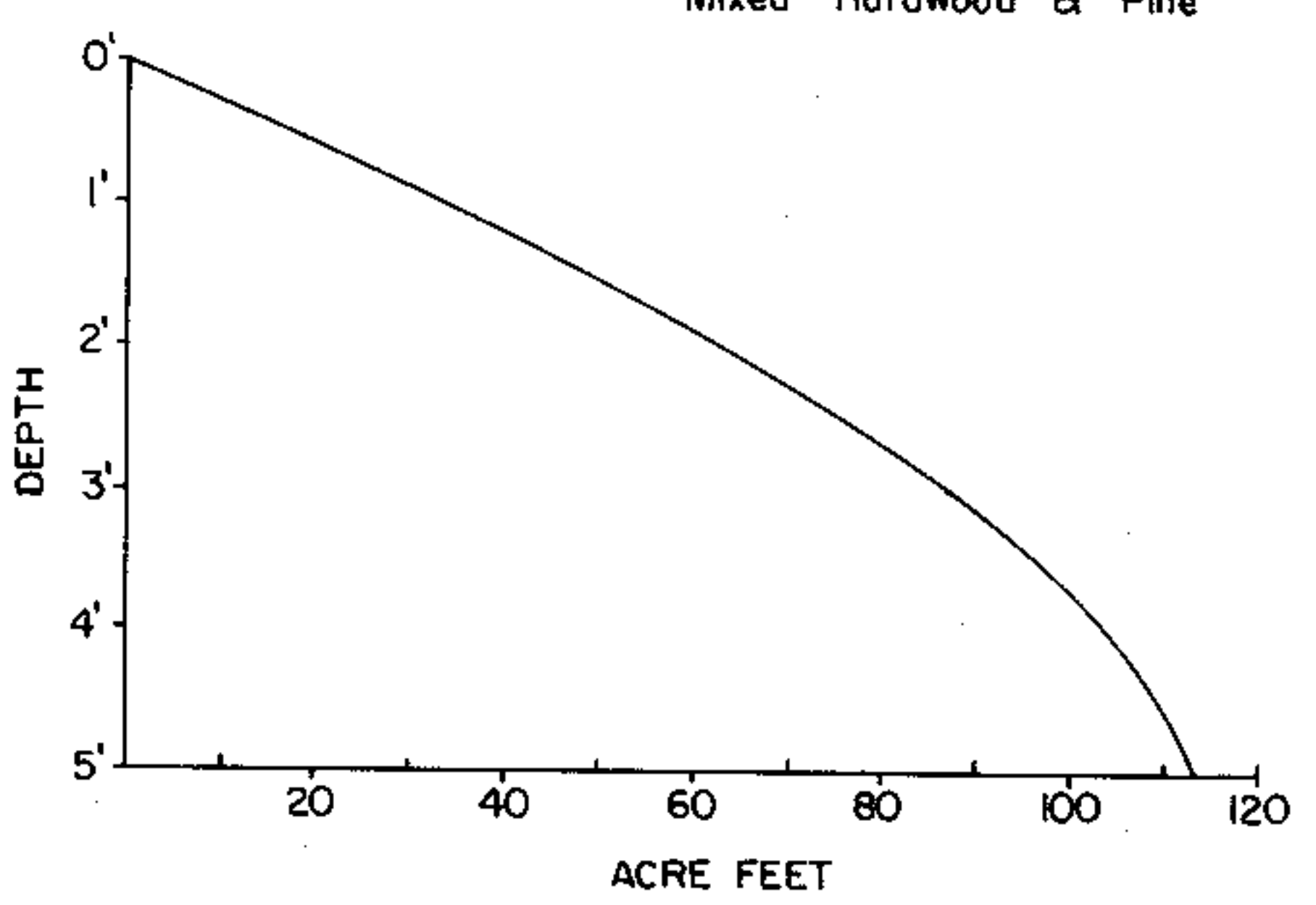

Drummond 12 miles

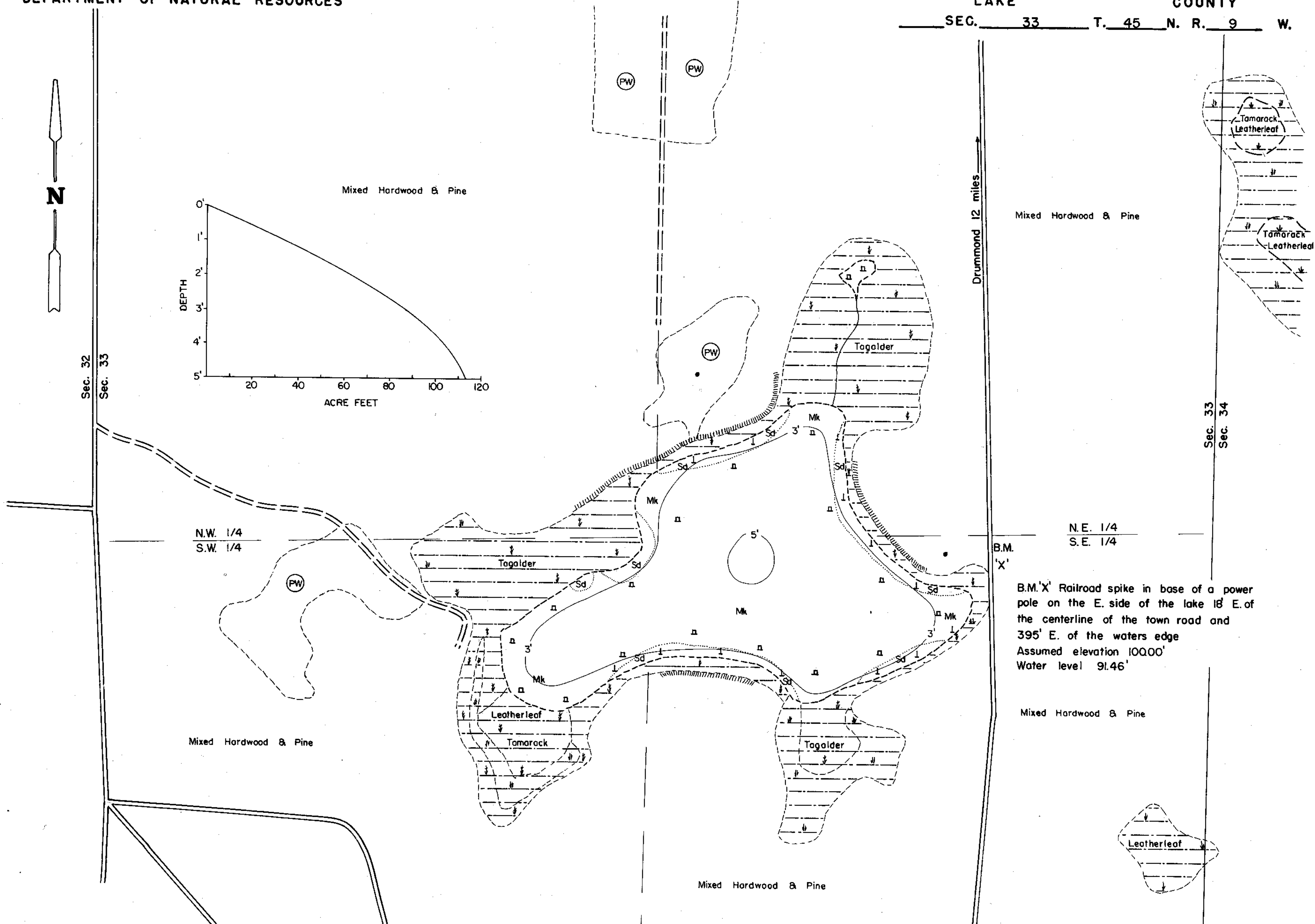

B.M. 'X'
B.M. 'X' Railroad spike in base of a power pole on the E. side of the lake 18' E. of the centerline of the town road and 395' E. of the waters edge
Assumed elevation 10000'
Water level 91.46'

EQUIPMENT RECORDING SONAR MAPPED MAY 1972

- | TOPOGRAPHIC SYMBOLS | | LAKE BOTTOM SYMBOLS | |
|-----------------------|----------------------------|---------------------|-----------------------------|
| (B) Brush | Steep slope | P. Peat | B Boulders |
| (PW) Partially wooded | ----- Indefinite shoreline | Mk. Muck | o Stumps & Snags |
| (W) Wooded | Marsh | C. Clay | o Rock danger to navigation |
| (C) Cleared | o Spring | M. Marl | T Submergent vegetation |
| (P) Pastured | --- Intermittent stream | Sd. Sand | I Emergent vegetation |
| (A) Agricultural | ==== Permanent inlet | St. Silt | F Floating vegetation |
| B.M. Bench Mark | ==== Permanent outlet | Gr. Gravel | u Brush shelters |
| ■ Dwelling | ∩ Dam | R. Rubble | |
| □ Resort | D.N.R. State owned land | Br. Bedrock | |



◆ Access ◀ Access with Parking ◆ Boat Livery

Drawn by: C. Holt
Field work by: C. Busch, G. Lund, I. Sather

SPECIES OF FISH	Abundance		
	Abundant	Common	Present
Muskie			
N. Pike			
Walleye			
L.M. Bass			X
S.M. Bass			
Panfish	X		
Trout			

WATER AREA 33.1 ACRES
 UNDER 3 FT. 25 %
 OVER 20 FT. 0 %
 MAX. DEPTH 5 FEET.
 TOTAL ALK. 50 P.P.M.
 VOLUME 113 ACRE FT.
 SHORELINE 1.06 MILES

Source: Wisconsin Department of Natural Resources 608-266-2621
Henderson Lake – Bayfield County, Wisconsin DNR Lake Map
Date - May 1972 - Historical Lake Map - Not for Navigation
A Public Document - Please Identify the Source when using it.