

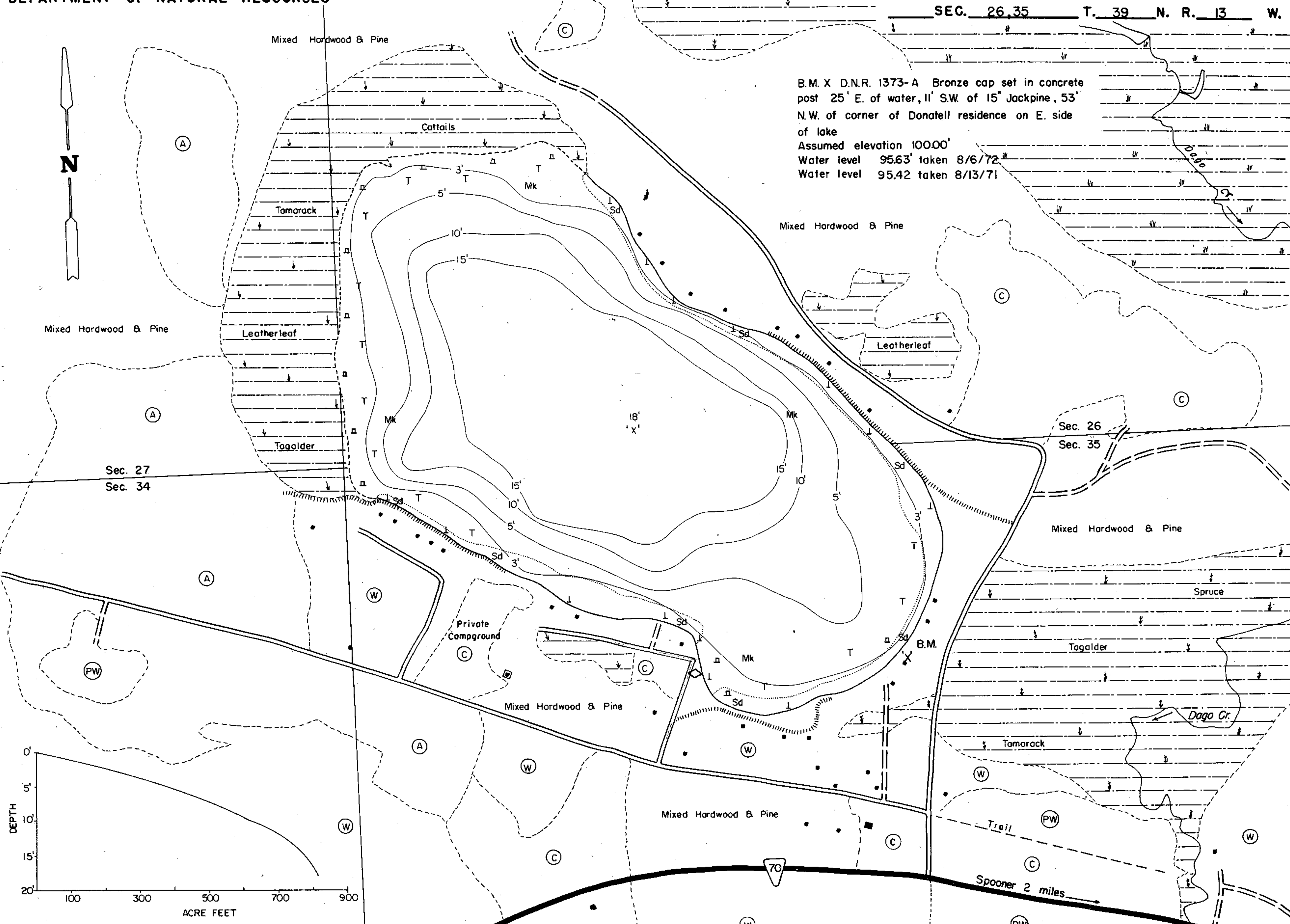

B.M. X D.N.R. 1373-A Bronze cap set in concrete post 25' E. of water, 11' SW. of 15' Jackpine, 53' N.W. of corner of Donatelli residence on E. side of lake  
Assumed elevation 10000'  
Water level 95.63' taken 8/6/72  
Water level 95.42 taken 8/13/71



EQUIPMENT RECORDING SONAR MAPPED AUG 1971  
MONTH YEAR

- TOPOGRAPHIC SYMBOLS**
- (B) Brush
  - (PW) Partially wooded
  - (W) Wooded
  - (C) Cleared
  - (P) Pastured
  - (A) Agricultural
  - B.M. Bench Mark
  - Dwelling
  - Resort
  - Camp
  - ||||| Steep slope
  - - - Indefinite shoreline
  - Marsh
  - Spring
  - Intermittent stream
  - Permanent inlet
  - Permanent outlet
  - Dam
  - D.N.R. State owned land

- LAKE BOTTOM SYMBOLS**
- P. Peat
  - Mk. Muck
  - C. Clay
  - M. Marl
  - Sd. Sand
  - St. Silt
  - Gr. Gravel
  - R. Rubble
  - Br. Bedrock
  - B Boulders
  - Stumps & Snags
  - Rock danger to navigation
  - T Submergent vegetation
  - Emergent vegetation
  - Floating vegetation
  - Brush shelters



Access Access with Parking Boat Livery

Drawn by: C. Holt  
Field work by: C. Busch, G. Lund, L. Sather

SPECIES OF FISH	Abundance		
	Abundant	Common	Present
Muskie			
N. Pike	X		
Walleye			X
L.M. Bass			X
S.M. Bass			X
Panfish	X		
Trout			

WATER AREA 90.7 ACRES  
UNDER 3 FT. 15.8 %  
OVER 20 FT. 0 %  
MAX. DEPTH 18 FEET.  
TOTAL ALK. 26 P.P.M.  
VOLUME 816 ACRE FT.  
SHORELINE 1.53 MILES

Source: Wisconsin Department of Natural Resources 608-266-2621  
Cyclone Lake - Washburn County, Wisconsin DNR Lake Map  
Date – Oct 1968 - Historical Lake Map - Not for Navigation  
A Public Document - Please Identify the Source when using it.