

LAKE SURVEY MAP

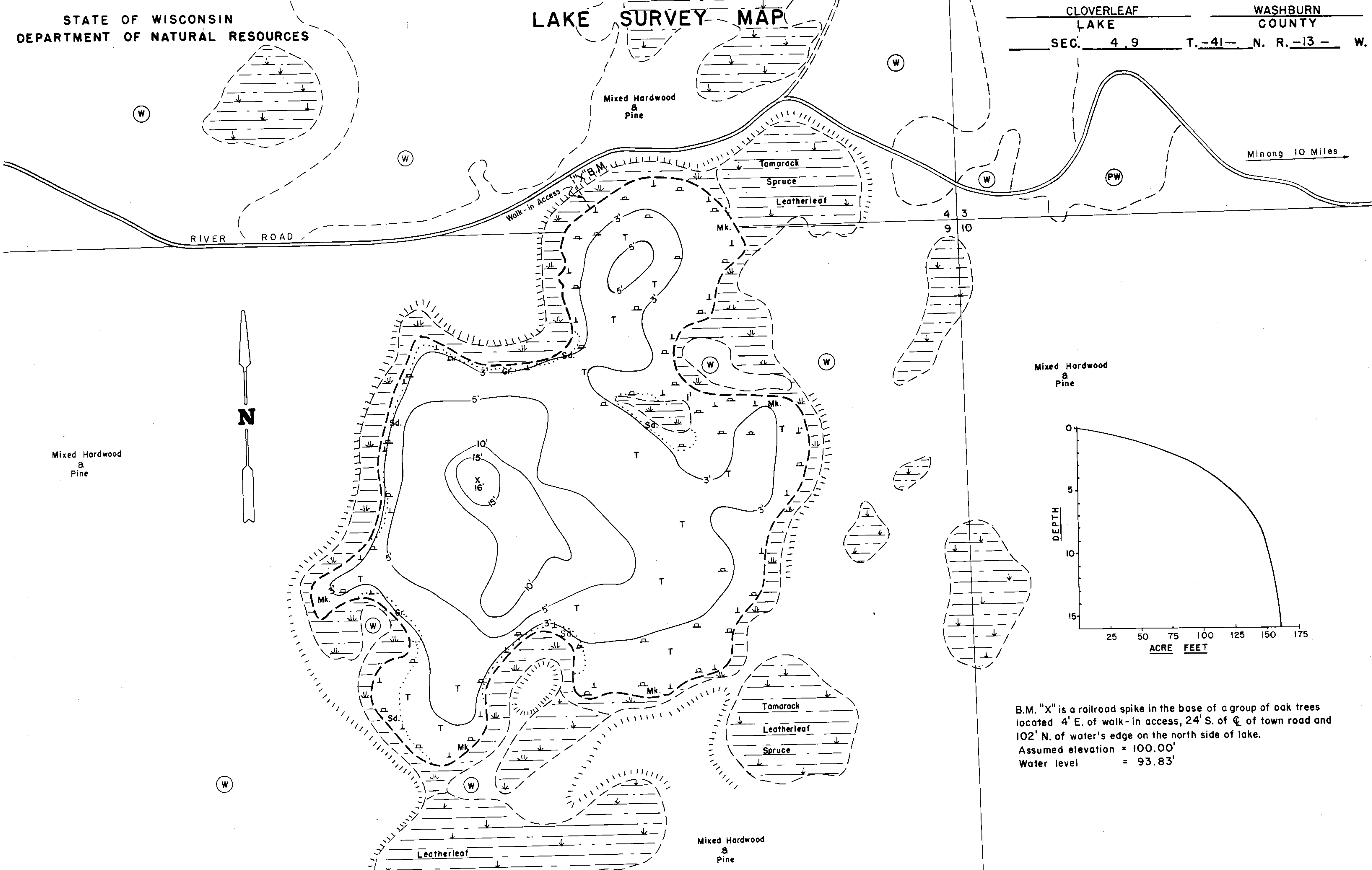

Mixed Hardwood & Pine

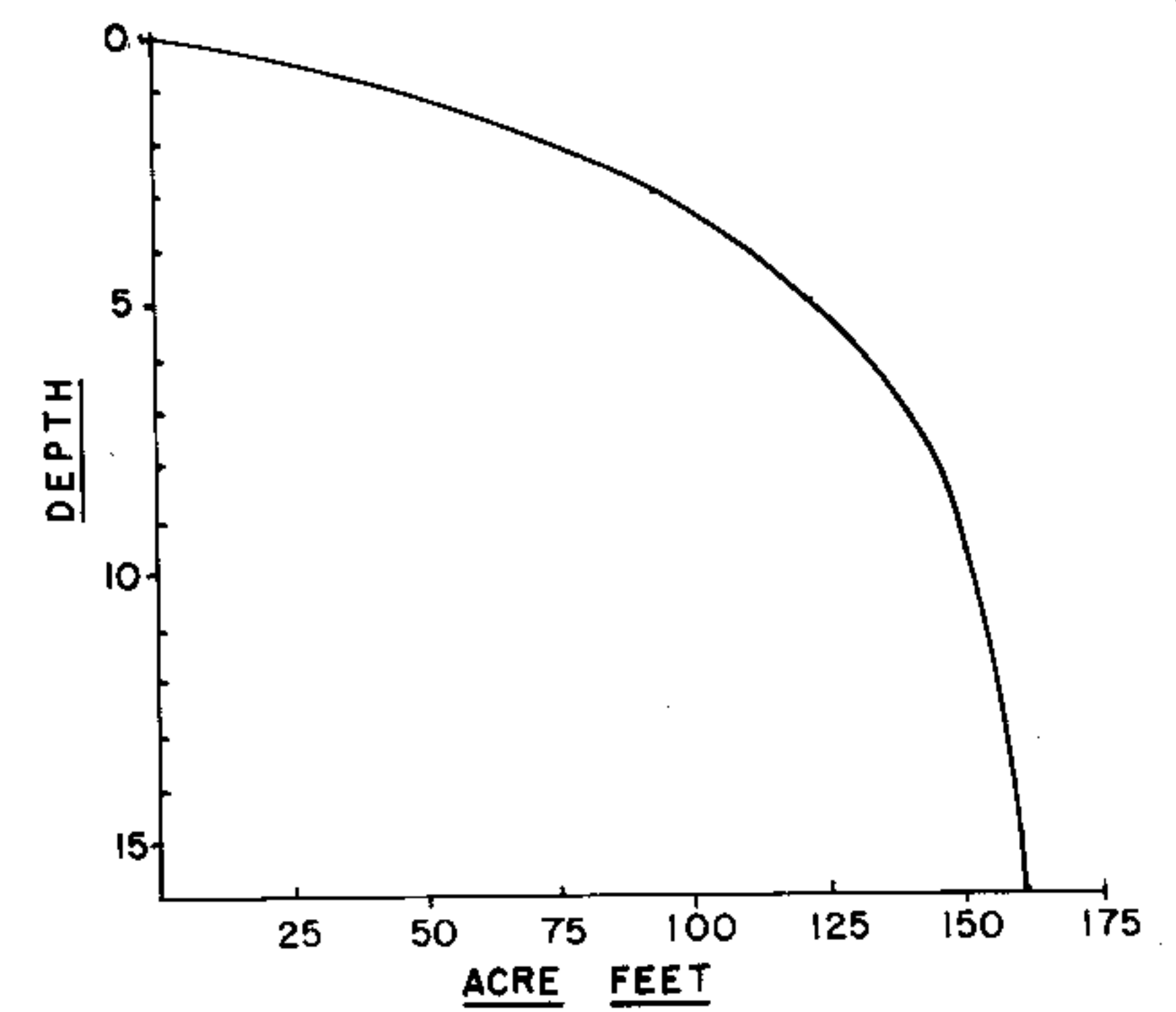

B.M. "X" is a railroad spike in the base of a group of oak trees located 4' E. of walk-in access, 24' S. of @ of town road and 102' N. of water's edge on the north side of lake.
Assumed elevation = 100.00'
Water level = 93.83'

EQUIPMENT RECORDING SONAR MAPPED SEPT. 1976

TOPOGRAPHIC SYMBOLS		MONTH	YEAR	LAKE BOTTOM SYMBOLS
(B) Brush	Steep slope	SEPT.	1976	T Tamarack
(PW) Partially wooded	- - - Indefinite shoreline			P Peat
(W) Wooded	Marsh			Mk. Muck
(C) Cleared	Spring			C. Clay
(P) Pastured	Intermittent stream			M. Marl
(A) Agricultural	Permanent inlet			Sd. Sand
B.M. Bench Mark	Permanent outlet			Sl. Silt
Dwelling	Dam			Gr. Gravel
Resort	D.N.R. State owned land			R. Rubble
Camp				Br. Bedrock
				B Boulders
				Stumps & Snags
				Rock danger to navigation
				T Submergent vegetation
				Emergent vegetation
				Floating vegetation
				Brush shelters



Access Access with Parking Boat Livery

Drawn by: R. Williams
Field work by: C. Busch, K. Cable, L. Sather

SPECIES OF FISH	Abundance	
	Abundant	Common
Muskie		
N. Pike		
Walleye		
L.M. Bass	X	
S.M. Bass		
Panfish	X	
Trout		

WATER AREA 36.3 ACRES
 UNDER 3 FT. 35 %
 OVER 20 FT. 0 %
 MAX. DEPTH 16 FEET.
 TOTAL ALK. 6 P.P.M.
 VOLUME 159.6 ACRE FT.
 MAIN SHORELINE 1.3 MI.
 ISLAND SHORELINE 0 MI.

Source: Wisconsin Department of Natural Resources 608-266-2621
Cloverleaf Lake - Washburn County, Wisconsin DNR Lake Map
Date – Sep 1976 - Historical Lake Map - Not for Navigation
A Public Document - Please Identify the Source when using it.