

B.M.'X' D.N.R. 1615-A Bronze cap set in concrete post 102' N. of lake, 11' W. of E. boundary of landing and 31' S.E. of sign at public landing
Assumed Elevation 100.00'
Water Elevation 92.98'

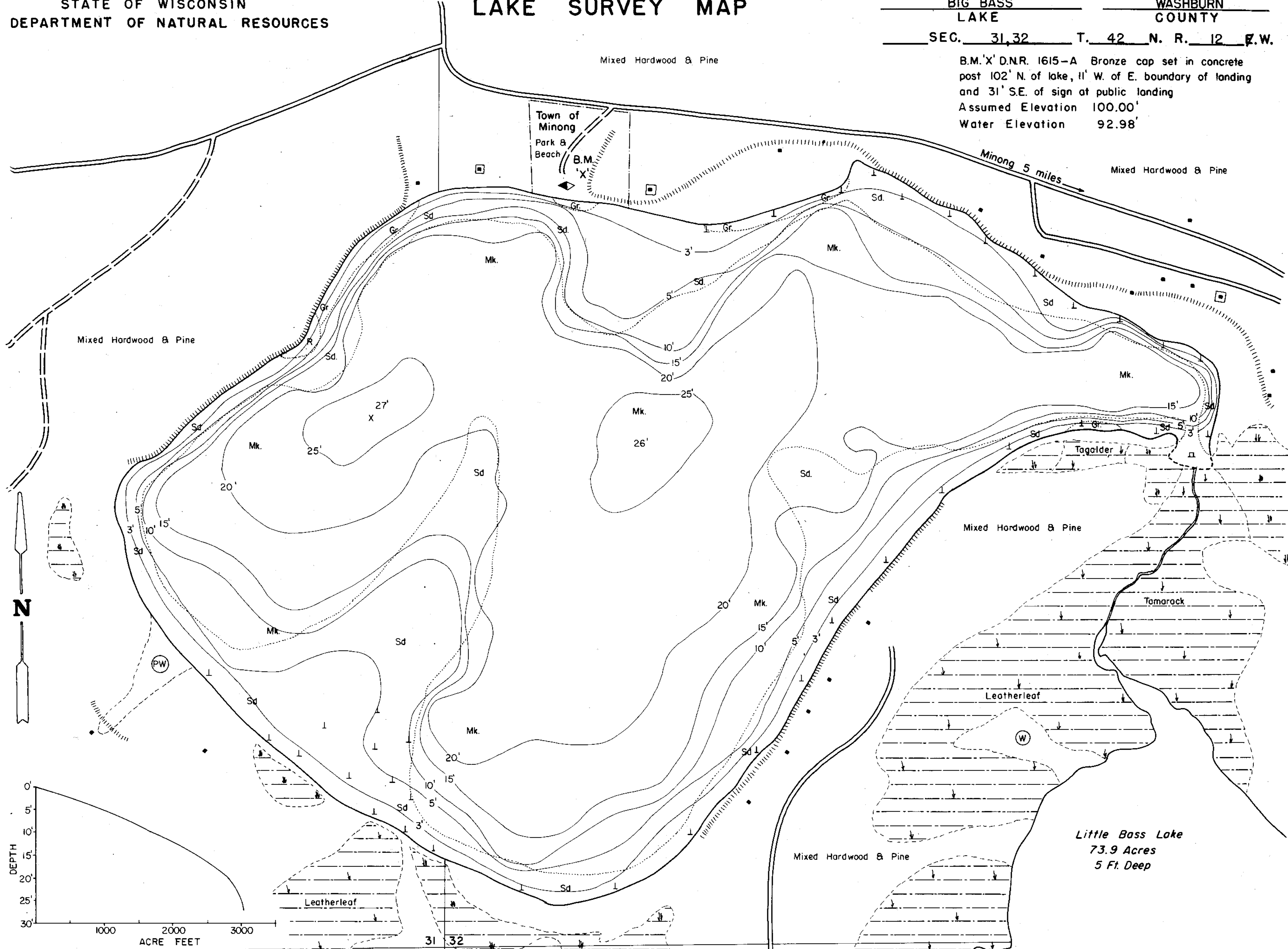

Little Bass Lake
73.9 Acres
5 Ft. Deep

EQUIPMENT RECORDING SONAR MAPPED

MONTH YEAR
AUG 1970

- TOPOGRAPHIC SYMBOLS**
- (B) Brush
 - (PW) Partially wooded
 - (W) Wooded
 - (C) Cleared
 - (P) Pastured
 - (A) Agricultural
 - B.M. Bench Mark
 - Dwelling
 - Resort
 - Camp
 - ||||| Steep slope
 - Indefinite shoreline
 - Marsh
 - Spring
 - Intermittent stream
 - Permanent inlet
 - Permanent outlet
 - Dam
 - D.N.R. State owned land

- LAKE BOTTOM SYMBOLS**
- P. Peat
 - Mk. Muck
 - C. Clay
 - M. Marl
 - Sd. Sand
 - St. Silt
 - Gr. Gravel
 - R. Rubble
 - Br. Bedrock
 - B Boulders
 - Stumps & Snags
 - Rock danger to navigation
 - Submergent vegetation
 - Emergent vegetation
 - Floating vegetation
 - Brush shelters



Access Access with Parking Boat Livery

Drawn by: C. Holt
Field work by: C. Busch, C. Stocks, L. Sather

SPECIES OF FISH	ABUNDANCE		
	Abundant	Common	Present
Muskie			
N. Pike	X		
Walleye	X		
L. M. Bass			X
S. M. Bass			
Panfish	X		
Trout			

WATER AREA 202.8 ACRES
UNDER 3 FT. 7 %
OVER 20 FT. 34 %
MAX. DEPTH 27 FEET.
TOTAL ALK. 33 P.P.M.
VOLUME 3015.2 ACRE FT.
SHORELINE 2.44 MILES

Source: Wisconsin Department of Natural Resources 608-266-2621
Big Bass Lake - Washburn County, Wisconsin DNR Lake Map
Date – Aug 1970 - Historical Lake Map - Not for Navigation
A Public Document - Please Identify the Source when using it.