

LAKE SURVEY MAP

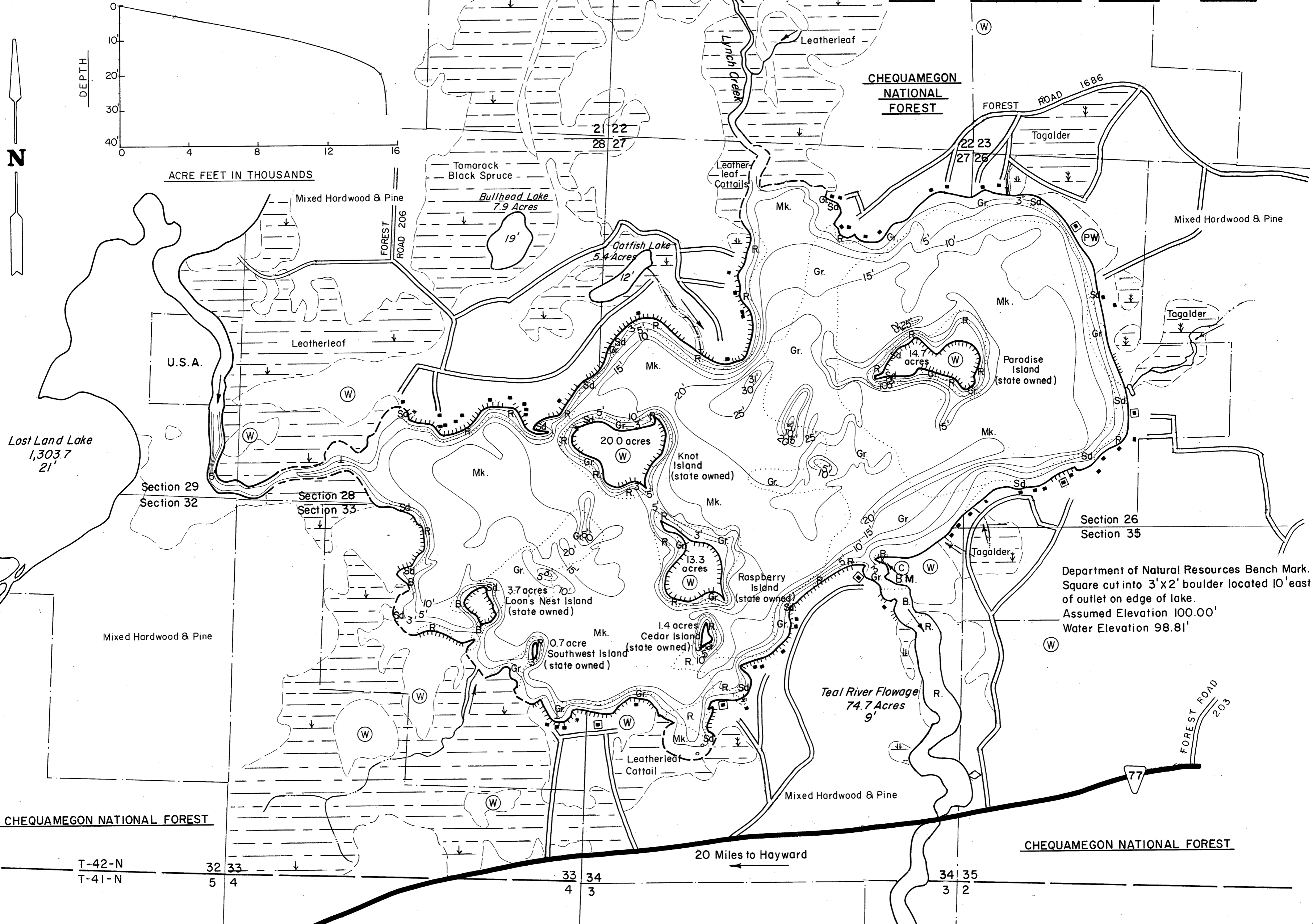

Department of Natural Resources Bench Mark.
Square cut into 3'x2' boulder located 10' east
of outlet on edge of lake.
Assumed Elevation 100.00'
Water Elevation 98.81'

EQUIPMENT RECORDING SONAR MAPPED MAY 1969

- TOPOGRAPHIC SYMBOLS**
- (B) Brush
 - (PW) Partially wooded
 - (W) Wooded
 - (C) Cleared
 - (P) Pastured
 - (A) Agricultural
 - B.M. Bench Mark
 - Dwelling
 - Resort
 - Camp
 - ||||| Steep slope
 - - - Indefinite shoreline
 - Marsh
 - Spring
 - Intermittent stream
 - Permanent inlet
 - Permanent outlet
 - Dam
 - D.N.R. State owned land

- LAKE BOTTOM SYMBOLS**
- P. Peat
 - Mk. Muck
 - C. Clay
 - M. Marl
 - Sd. Sand
 - St. Silt
 - Gr. Gravel
 - R. Rubble
 - Br. Bedrock
 - B Boulders
 - Stumps & Snags
 - Rock danger to navigation
 - Submergent vegetation
 - Emergent vegetation
 - Floating vegetation
 - Brush shelters

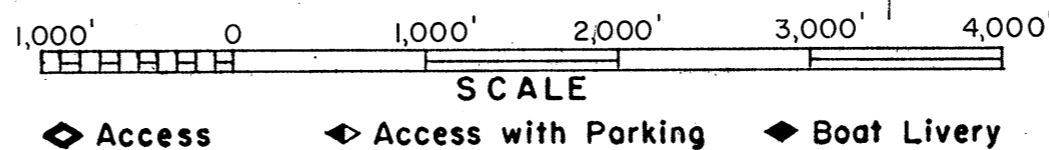

◆ Access ◆ Access with Parking ◆ Boat Livery
 Drawn by: J. Roth
 Field work by: C. Busch, C. Belter, S. Johannes

SPECIES OF FISH	ABUNDANCE		
	Abundant	Common	Present
Muskie	X		
N. Pike			
Walleye	X		
L.M. Bass		X	
S.M. Bass			
Panfish	X		
Trout			
Sturgeon			X

WATER AREA 1,048.9 ACRES
 UNDER 3 FT. 1 %
 OVER 20 FT. 9 %
MAX. DEPTH 31 FEET.
TOTAL ALK. 30 P.P.M.
VOLUME 15,387.9 ACRE FT.
SHORELINE 11.8 MILES
 8.8 MILES OF SHORELINE
 EXCLUDING ISLANDS

Source: Wisconsin Department of Natural Resources 608-266-2621
Teal Lake – Sawyer County, Wisconsin DNR Lake Map
Date – May 1969 - Historical Lake Map - Not for Navigation
A Public Document - Please Identify the Source when using it.