

LAKE SURVEY MAP

LAKE LOVEJOY
 SECTION 30
 TOWNSHIP 41 N
 RANGE 7 W
 TOWN OF ROUND LAKE
 COUNTY SAWYER

FORM FH-17

WISCONSIN CONSERVATION DEPARTMENT
 BIOLOGY DIVISION
 LAKE AND STREAM IMPROVEMENT SECTION

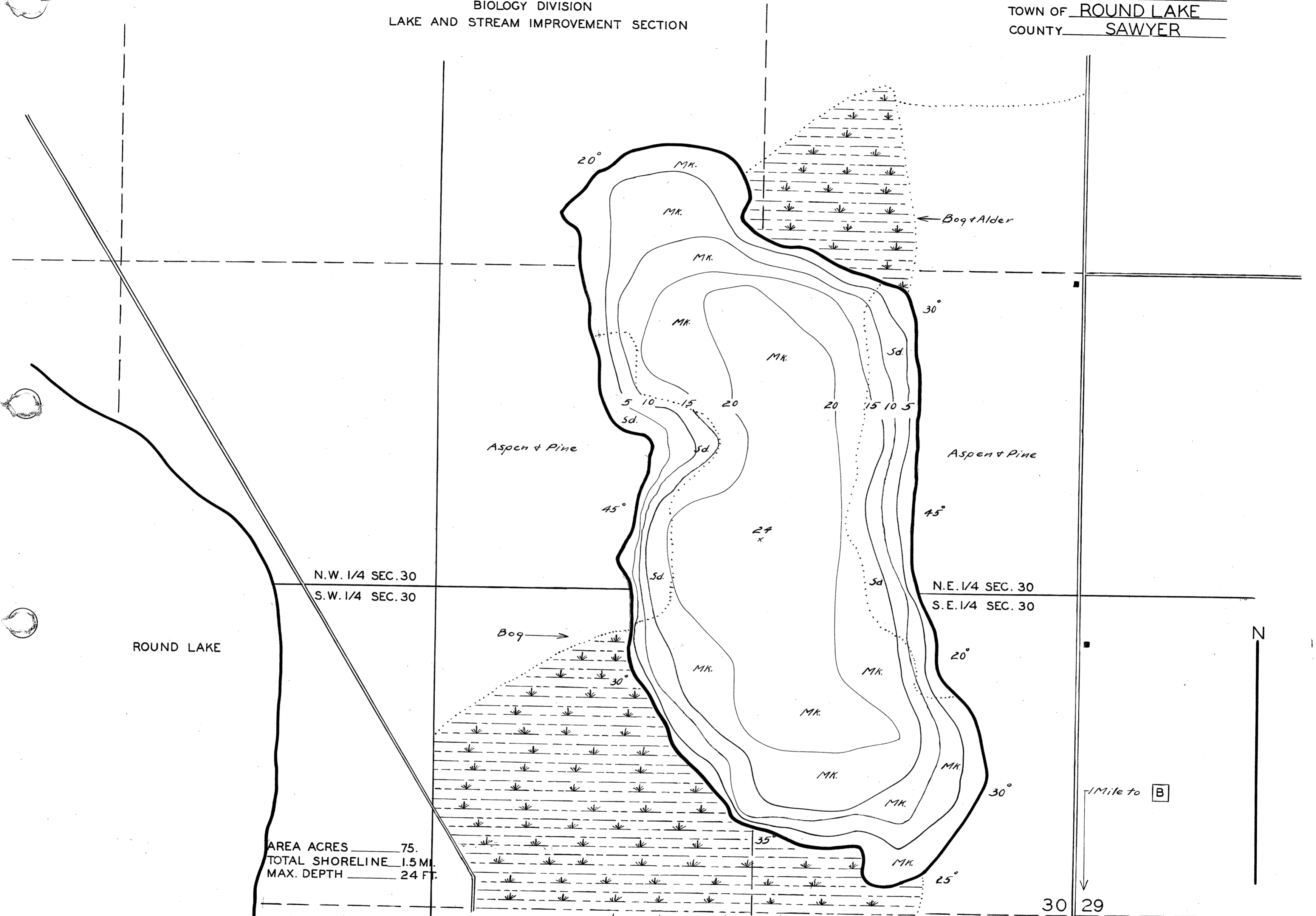

AREA ACRES 75.
 TOTAL SHORELINE 1.5 MI.
 MAX. DEPTH 24 FT.

DATE August 5 1941
 COMPILED BY _____
 TRACED BY EMK (W.P.A.)
 SOURCE OF INFORMATION W.P.A. Lake Survey Project
 SOUNDINGS At 300 Ft. Intervals
 DATES OF MAP REVISION _____
 WORK AGENCY W. P. A.

LAKE IMPROVEMENT RECORD	
TYPE	DATE
BRUSH REFUGES	_____
SAPLING TANGLES	_____
SPAWNING BOXES	_____
MINNOW SPAWNERS	_____
TOTAL	_____

SCALE 1 inch Equals 300 Ft.

- LEGEND
- WEED BEDS
 - ROCKY SHOALS
 - Sd. SAND
 - Cl. CLAY
 - Gr. GRAVEL
 - M.K. MUCK
 - DWELLING
 - ABANDONED DWELLING
 - RESORT

Checked
 W.H.S.
 EMK
 8/6/41

Source: Wisconsin Department of Natural Resources 608-266-2621
Lovejoy Lake – Sawyer County, Wisconsin DNR Lake Map
Date – Aug 1941 - Historical Lake Map - Not for Navigation
A Public Document - Please Identify the Source when using it.