

Sheet 1  
Sheet 2

EQUIPMENT RECORDING SONAR MAPPED SEPT 1973  
MONTH YEAR  
LAKE BOTTOM SYMBOLS

TOPOGRAPHIC SYMBOLS		LAKE BOTTOM SYMBOLS	
(B) Brush	Steep slope	P. Peat	B Boulders
(PW) Partially wooded	- - - Indefinite shoreline	Mk. Muck	⊙ Stumps & Snags
(W) Wooded	⊘ Marsh	C. Clay	⊘ Rock danger to navigation
(C) Cleared	⊙ Spring	M. Marl	T Submergent vegetation
(P) Pastured	⊘ Intermittent stream	Sd. Sand	⊘ Emergent vegetation
(A) Agricultural	⊘ Permanent inlet	St. Silt	⊘ Floating vegetation
B.M. Bench Mark	⊘ Permanent outlet	Gr. Gravel	⊘ Brush shelters
■ Dwelling	⊘ Dam	R. Rubble	
■ Resort	⊘ D.N.R. State owned land	Br. Bedrock	
⊘ Camp			



◆ Access    ◆ Access with Parking    ◆ Boat Livery

Drawn by: G.Thuesen  
Field work by: C.Busch, K.Cable, L.Sather

SPECIES OF FISH	Abundance		
	Abundant	Common	Present
Muskie	X		
N. Pike			X
Walleye		X	
L.M. Bass			X
S.M. Bass			X
Panfish			X
Trout			

WATER AREA 676.1 ACRES  
UNDER 3 FT. 17 %  
OVER 20 FT. .03 %  
MAX. DEPTH 22 FEET.  
TOTAL ALK. 52 P.P.M.  
VOLUME 6025.6 ACRE FT.  
MAIN SHORELINE 10.42 MI.  
ISLAND SHORELINE .57 MI.

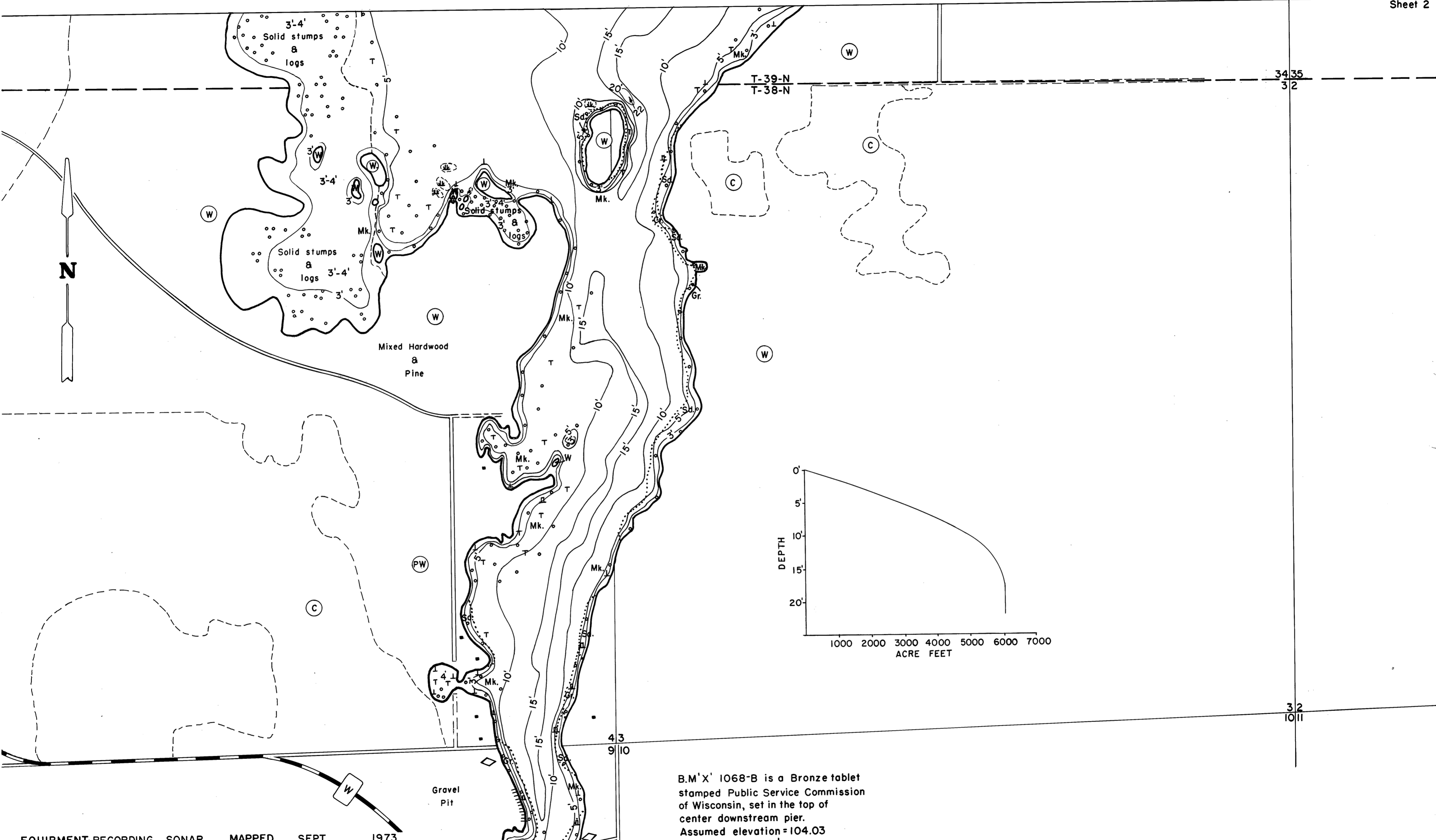

B.M' X' 1068-B is a Bronze tablet stamped Public Service Commission of Wisconsin, set in the top of center downstream pier. Assumed elevation=104.03 Water level=101.61'

EQUIPMENT-RECORDING SONAR MAPPED SEPT 1973

- | TOPOGRAPHIC SYMBOLS   |                            | LAKE BOTTOM SYMBOLS |                             |
|-----------------------|----------------------------|---------------------|-----------------------------|
| (B) Brush             | Steep slope                | P. Peat             | B Boulders                  |
| (PW) Partially wooded | - - - Indefinite shoreline | Mk. Muck            | o Stumps & Snags            |
| (W) Wooded            | Marsh                      | C. Clay             | ⋯ Rock danger to navigation |
| (C) Cleared           | Spring                     | M. Marl             | T Submergent vegetation     |
| (P) Pastured          | Intermittent stream        | Sd. Sand            | ⊥ Emergent vegetation       |
| (A) Agricultural      | Permanent inlet            | St. Silt            | ⊢ Floating vegetation       |
| B.M. Bench Mark       | Permanent outlet           | Gr. Gravel          | ⊕ Brush shelters            |
| ■ Dwelling            | Dam                        | R. Rubble           |                             |
| □ Resort              | D.N.R. State owned land    | Br. Bedrock         |                             |
| □ Camp                |                            |                     |                             |



◆ Access    ◆ Access with Parking    ◆ Boat Livery

Drawn by: G.Thuesen  
Field work by: C.Busch, K.Cable, L.Sather

SPECIES OF FISH	Abundance		
	Abundant	Common	Present
Muskie	X		
N. Pike			X
Walleye		X	
L.M. Bass			X
S.M. Bass			X
Panfish			X
Trout			

WATER AREA 676.1 ACRES  
UNDER 3 FT. 17 %  
OVER 20 FT. .03 %  
MAX. DEPTH 22 FEET.  
TOTAL ALK. 52 P.P.M.  
VOLUME 6025.6 ACRE FT.  
MAIN SHORELINE 10.42 MI.  
ISLAND SHORELINE .57 MI.

Source: Wisconsin Department of Natural Resources 608-266-2621  
Lake Winter – Sawyer County, Wisconsin DNR Lake Map  
Date – Sep 1973 - Historical Lake Map - Not for Navigation  
A Public Document - Please Identify the Source when using it.