

LAKE SURVEY MAP

FIRESIDE LAKES RUSK COUNTY
SEC. 23, 26, 27 T. -33- N. R. -8- W.

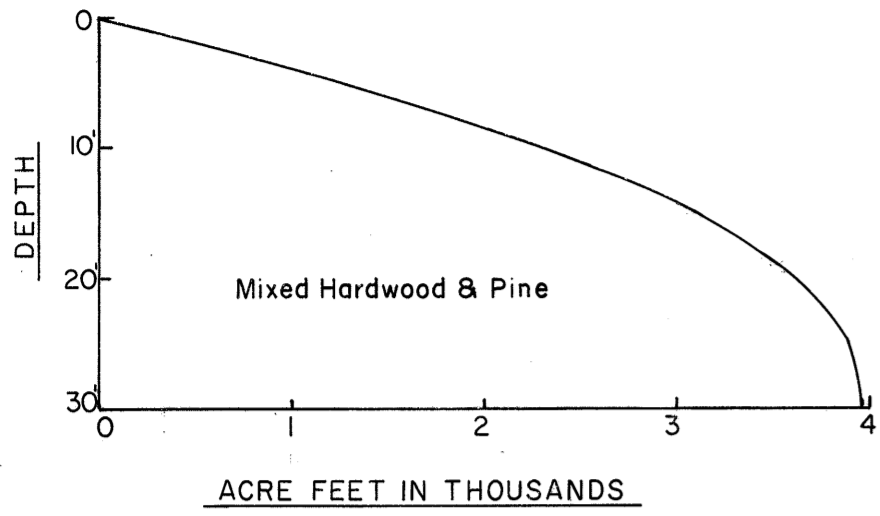

Mixed Hardwood & Pine

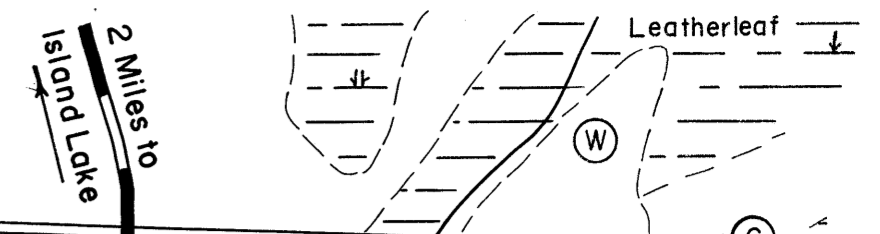

Department of Natural Resources Bench Mark 1497-A.
Railroad spike in 14" elm tree located 143' north of public access, 84' west of fence, and 10' south of centerline of road to private cabins.
Assumed Elevation 100.00'
Water Elevation 90.76'

EQUIPMENT RECORDING SONAR MAPPED MAY 1969

TOPOGRAPHIC SYMBOLS		LAKE BOTTOM SYMBOLS	
(B) Brush	Steep slope	P. Peat	B Boulders
(PW) Partially wooded	- - - Indefinite shoreline	Mk. Muck	o Stumps & Snags
(W) Wooded	Marsh	C. Clay	⊗ Rock danger to navigation
(C) Cleared	o Spring	M. Marl	T Submergent vegetation
(P) Pastured	- - - Intermittent stream	Sd. Sand	⊥ Emergent vegetation
(A) Agricultural	==== Permanent inlet	St. Silt	⊥ Floating vegetation
B.M. Bench Mark	==== Permanent outlet	Gr. Gravel	⊥ Brush shelters
■ Dwelling	⊥ Dam	R. Rubble	
□ Resort	D.N.R. State owned land	Br. Bedrock	
⊠ Camp			

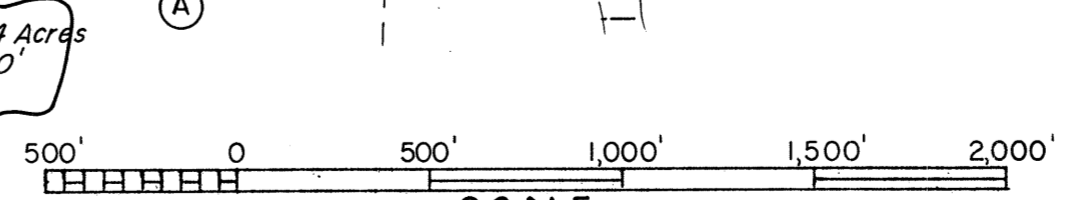

◆ Access ◆ Access with Parking ◆ Boat Livery

Drawn by: J. Roth
Field work by: C. Busch, C. Belter, S. Johannes

SPECIES OF FISH	Abundance		
	Abundant	Common	Present
Muskie		X	
N. Pike	X		
Walleye	X		
L.M. Bass	X		
S.M. Bass	X		
Panfish	X		
Trout			

WATER AREA 301.8 ACRES
 UNDER 3 FT. 18 %
 OVER 20 FT. 26 %
 MAX. DEPTH 30 FEET.
 TOTAL ALK. 52 P.P.M.
 VOLUME 3,971.6 ACRE FT.
 SHORELINE 3.84 MILES

Source: Wisconsin Department of Natural Resources 608-266-2621
Fireside Lakes (Rice Lake and Mud Lake) – Rusk County, Wisconsin DNR Lake Map
Date – May 1969 - Historical Lake Map - Not for Navigation
A Public Document - Please Identify the Source when using it.