

32 33  
 5 4

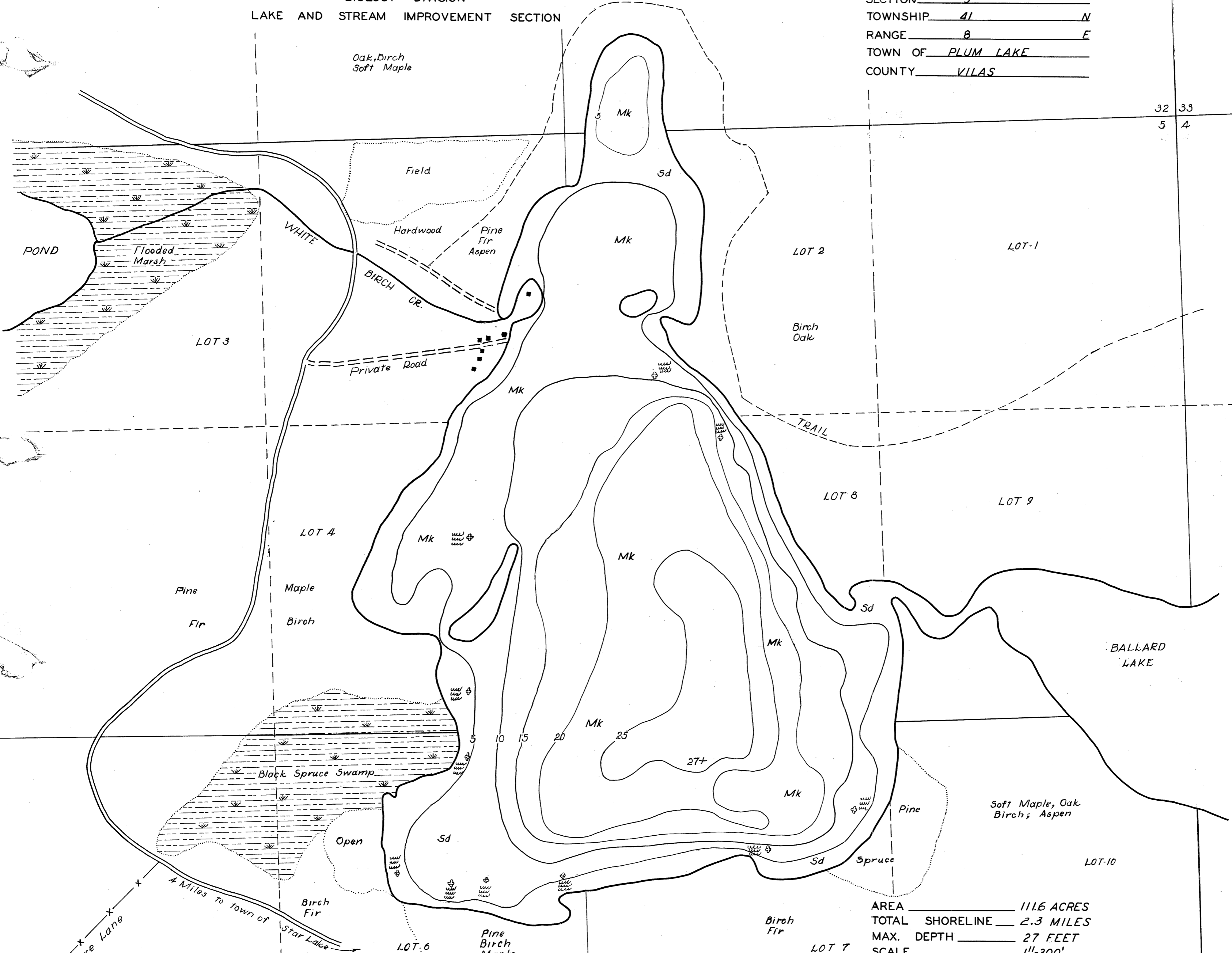

AREA 111.6 ACRES  
 TOTAL SHORELINE 2.3 MILES  
 MAX. DEPTH 27 FEET  
 SCALE 1"=300'

DATE MAY 1941  
 COMPILED BY \_\_\_\_\_  
 TRACED BY R.W. C.C.C.  
 SOURCE OF INFORMATION CAMP CRYSTAL LAKE-LAKE SURVEY PROJECT  
AERIAL PHOTOGRAPH-FL 17, B-7-9  
 SOUNDINGS 300' INTERVALS  
 DATES OF MAP REVISION \_\_\_\_\_  
 WORK AGENCY C.C.C.

LAKE IMPROVEMENT RECORD

TYPE	DATE	1936		
⊕ BRUSH REFUGES	<u>17</u>			
∞ SAPLING TANGLES	<u>176</u>			
□ SPAWNING BOXES				
* MINNOW SPAWNERS				
TOTAL	<u>193</u>			

LEGEND

- ⊕ WEED BEDS
- ⊙ ROCKY SHOALS
- Sd SAND
- Cl CLAY
- Gr GRAVEL
- Mk MUCK
- DWELLING
- ABANDONED DWELLING
- ▣ RESORT

Source: Wisconsin Department of Natural Resources 608-266-2621  
White Birch Lake – Vilas County, Wisconsin DNR Lake Map  
Date – May 1941 - Historical Lake Map - Not for Navigation  
A Public Document - Please Identify the Source when using it.